

RESOLUTION NO. 91-193

RESOLUTION OF THE BOARD OF COUNTY COMMISSIONERS
OF THE COUNTY OF ST. JOHNS, STATE OF FLORIDA,
VACATING A PORTION OF THE PLAT OF JULINGTON CREEK, UNIT NINE
AS MORE FULLY DESCRIBED BELOW

WHEREAS, a petition has been filed by qualified land owners to vacate a portion of a certain subdivision plat hereinafter described; and,

WHEREAS, Notice of the Public Hearing has been duly published and Proof of Publication has been filed with this Board; and,

WHEREAS, it appears that there are no objections and the facts contained in the petition are true,

NOW THEREFORE, IN CONSIDERATION OF THE PREMISES, BE IT RESOLVED BY THE BOARD OF COUNTY COMMISSIONERS OF ST. JOHNS COUNTY, FLORIDA, AS FOLLOWS:

1. That the following described portion of the plat of Julington Creek, Unit Nine, to wit:

SEE EXHIBIT "A", ATTACHED HERETO AND BY REFERENCE MADE A PART HEREOF.

be and the same is hereby vacated and all streets situated therein which have not become highways necessary for use by the traveling public are hereby vacated and abandoned and this Board hereby renounces and disclaims any right of the County and the Public in and to the above described property, easements and streets situated therein, such property, easements and streets being returned into acreage.

2. That a certified copy of this resolution shall be filed in the offices of the Clerk of the Circuit Court and duly recorded in the public records of St. Johns County, Florida.

3. That the applicant shall pay all recording costs.

DATED this 10th day of December, 1991.



BOARD OF COUNTY COMMISSIONERS
OF ST. JOHNS COUNTY

By: Fred Bishby
Chairman

ATTEST: CARL "BUD" MARKEL, CLERK

By: Gwenne Carter
Deputy Clerk

NORTH
EAST
FLORIDA

SURVEYORS

1900 CORPORATE SQUARE BLVD. / JACKSONVILLE, FLORIDA 32216 / (904) 721-3066

A PART OF JULINGTON CREEK UNIT NINE

NFS # 91208.04

NOVEMBER 21, 1991

A PART OF JULINGTON CREEK UNIT NINE, AS RECORDED IN MAP BOOK 18, PAGES 77 THROUGH 121 INCLUSIVE OF THE PUBLIC RECORDS OF ST. JOHNS COUNTY, FLORIDA, BEING A COMPOSITE OF THE FOLLOWING LOTS, BLOCKS, TRACTS AND ROADWAYS AS FOLLOWS: LOTS 37 THROUGH 54 AND LOTS 61 THROUGH 68, BLOCK 221, TOGETHER WITH ALL OF BLOCKS 226, 227 AND 228, TOGETHER WITH LOTS 4 THROUGH 29, BLOCK 229, TOGETHER WITH ALL OF BLOCK 230, TOGETHER WITH LOTS 3 THROUGH 19, BLOCK 231, TOGETHER WITH LOTS 1 THROUGH 6, BLOCK 233, ALL OF BLOCKS 234, 239 AND 240, TOGETHER WITH LOTS 18 THROUGH 29, BLOCK 241, TOGETHER WITH LOTS 5 THROUGH 29, BLOCK 242, TOGETHER WITH LOTS 1 THROUGH 13, BLOCK 253, TOGETHER WITH PART OF TRACT "B", TOGETHER WITH ALL OF TRACTS "L", "N", "O" AND "P", TOGETHER WITH A PART OF TRACTS "C" AND "F" (WI), TOGETHER WITH A PART OF TRACTS G-4, TOGETHER WITH ALL OF TRACTS G-5, G-6, G-7, G-8, G-9, G-10, G-11, G-12, G-13, G-14, G-15 AND G-16, TOGETHER WITH A PART OF TRACT G-17, TOGETHER WITH ALL OF TRACT G-18, TOGETHER WITH A PART OF TRACTS G-19 AND G-20, TOGETHER WITH ALL OF TRACTS G-29, G-30, G-31, G-32, G-33, G-34 AND G-35, TOGETHER WITH ALL OF WINDFLOWER CIRCLE, BASIL BRANCH AND WINDFLOWER CIRCLE CONNECTOR, TOGETHER WITH A PART OF MAYAPPLE BRANCH AND PERIWINKLE PLACE, TOGETHER WITH ALL OF BUTTERFLY BRANCH, LAVENDER LOOP, TOGETHER WITH A PART OF PENNYCRESS PLACE AND SENECIO BRANCH EAST, TOGETHER WITH ALL OF VENUS COURT, ALL MORE PARTICULARLY DESCRIBED AS FOLLOWS: FOR A POINT OF BEGINNING COMMENCE AT THE NORTHWEST CORNER OF SAID TRACT "L", SAID CORNER LYING ON THE SOUTHERLY RIGHT-OF-WAY LINE OF DURBIN CREEK BOULEVARD BY JULINGTON CREEK UNIT FIVE AS RECORDED IN MAP BOOK 17, PAGES 1 THROUGH 21 INCLUSIVE OF SAID CURRENT PUBLIC RECORDS (A 200 FOOT RIGHT-OF-WAY BY PLAT); SAID POINT LYING ON A CURVE, SAID CURVE BEING CONCAVE NORTHERLY, HAVING A RADIUS OF 2700.00 FEET; THENCE EASTERLY ALONG SAID SOUTHERLY RIGHT-OF-WAY LINE AND ALONG THE ARC OF SAID CURVE AN ARC DISTANCE OF 218.97 FEET, SAID ARC BEING SUBTENDED BY A CHORD BEARING OF SOUTH 87°40'36" EAST, AND A CHORD DISTANCE OF 218.91 FEET TO THE POINT OF TANGENCY OF SAID CURVE; THENCE DUE EAST CONTINUING ALONG SAID SOUTHERLY RIGHT-OF-WAY LINE, A DISTANCE OF 175.37 FEET, TO THE POINT OF CURVE OF A CURVE, CONCAVE SOUTHERLY, HAVING A RADIUS OF 2500.00 FEET; THENCE EASTERLY CONTINUING ALONG SAID SOUTHERLY RIGHT-OF-WAY LINE AND ALONG THE ARC OF SAID CURVE AN ARC DISTANCE OF 886.12 FEET, SAID ARC BEING SUBTENDED BY A CHORD BEARING OF SOUTH 79°50'45" EAST, AND A CHORD DISTANCE OF 881.49 FEET TO A POINT ON SAID CURVE; THENCE SOUTH 47°40'39" EAST LEAVING SAID SOUTHERLY RIGHT-OF-WAY LINE, A DISTANCE OF 113.15 FEET; THENCE SOUTH 30°08'29" EAST, A DISTANCE OF 433.84 FEET; THENCE SOUTH 33°19'52" EAST, A DISTANCE OF 304.85 FEET; THENCE SOUTH 36°15'14" EAST, A DISTANCE OF 92.00 FEET; THENCE SOUTH 37°27'52" EAST, A

MEMBER AMERICAN CONGRESS ON SURVEYING AND MAPPING
MEMBER FLORIDA SOCIETY OF PROFESSIONAL LAND SURVEYORS

EXHIBIT "A"

DISTANCE OF 92.98 FEET; THENCE SOUTH 38°57'06" EAST, A DISTANCE OF 39.62 FEET; THENCE SOUTH 51°32'47" EAST, A DISTANCE OF 410.00 FEET; THENCE SOUTH 34°02'23" EAST, A DISTANCE OF 92.06 FEET; THENCE SOUTH 08°47'06" EAST, A DISTANCE OF 144.00 FEET; THENCE SOUTH 68°23'39" EAST, A DISTANCE OF 45.46 FEET; THENCE NORTH 85°24'44" EAST, A DISTANCE OF 100.00 FEET, TO A POINT LYING ON A CURVE, SAID CURVE BEING CONCAVE NORTHEASTERLY, HAVING A RADIUS OF 687.07 FEET; THENCE SOUTHEASTERLY ALONG THE ARC OF SAID CURVE AN ARC DISTANCE OF 197.27 FEET, SAID ARC BEING SUBTENDED BY A CHORD BEARING OF SOUTH 12°48'44" EAST, AND A CHORD DISTANCE OF 196.59 FEET TO THE POINT OF TANGENCY OF SAID CURVE; THENCE SOUTH 21°02'15" EAST, A DISTANCE OF 111.40 FEET TO THE POINT OF CURVE OF A CURVE, CONCAVE NORTHEASTERLY, HAVING A RADIUS OF 366.04 FEET; THENCE SOUTHEASTERLY ALONG THE ARC OF SAID CURVE AN ARC DISTANCE OF 439.40 FEET, SAID ARC BEING SUBTENDED BY A CHORD BEARING OF SOUTH 55°25'37" EAST, AND A CHORD DISTANCE OF 413.49 FEET TO THE POINT OF TANGENCY OF SAID CURVE; THENCE SOUTH 89°48'59" EAST, A DISTANCE OF 255.00 FEET; THENCE SOUTH 00°11'01" WEST, A DISTANCE OF 130.00 FEET; THENCE SOUTH 89°48'59" EAST, A DISTANCE OF 45.26 FEET; THENCE SOUTH 00°11'01" WEST, A DISTANCE OF 190.00 FEET; THENCE SOUTH 89°48'59" EAST, A DISTANCE OF 44.77 FEET; THENCE SOUTH 00°11'01" WEST, A DISTANCE OF 745.00 FEET; THENCE NORTH 89°48'59" WEST, A DISTANCE OF 159.21 FEET; THENCE SOUTH 18°09'55" WEST, A DISTANCE OF 38.42 FEET; THENCE SOUTH 32°23'08" WEST, A DISTANCE OF 276.68 FEET; THENCE SOUTH 57°36'52" EAST, A DISTANCE OF 135.86 FEET TO A POINT OF CURVE OF A CURVE, SAID CURVE BEING CONCAVE NORTHEASTERLY, HAVING A RADIUS OF 1344.58 FEET; THENCE SOUTHEASTERLY ALONG THE ARC OF SAID CURVE AN ARC DISTANCE OF 157.33 FEET, SAID ARC BEING SUBTENDED BY A CHORD BEARING OF SOUTH 60°58'00" EAST, AND A CHORD DISTANCE OF 157.24 FEET TO A POINT ON SAID CURVE; THENCE SOUTH 25°40'53" WEST, A DISTANCE OF 130.25 FEET; THENCE SOUTH 64°22'41" EAST ALONG A LINE TO ITS INTERSECTION WITH THE WESTERLY RIGHT-OF-WAY LINE OF FLORA BRANCH BOULEVARD BY JULINGTON CREEK UNIT EIGHT AS RECORDED IN MAP BOOK 18, PAGES 33 THROUGH 51 INCLUSIVE OF SAID PUBLIC RECORDS (A 200 FOOT RIGHT-OF-WAY BY PLAT), A DISTANCE OF 304.25 FEET TO A POINT LYING ON A CURVE, SAID CURVE BEING CONCAVE WESTERLY, HAVING A RADIUS OF 2100.00 FEET; THENCE SOUTHWESTERLY ALONG SAID WESTERLY RIGHT-OF-WAY LINE AND ALONG THE ARC OF SAID CURVE AN ARC DISTANCE OF 96.64 FEET, SAID ARC BEING SUBTENDED BY A CHORD BEARING OF SOUTH 12°17'28" WEST, AND A CHORD DISTANCE OF 96.63 FEET TO THE POINT OF COMPOUND CURVE; THENCE SOUTHWESTERLY ALONG SAID RIGHT-OF-WAY LINE AND ALONG A CURVE SAID CURVE BEING CONCAVE NORTHWESTERLY, HAVING A RADIUS OF 1300.00 FEET, AN ARC DISTANCE OF 938.26 FEET, SAID ARC BEING SUBTENDED BY A CHORD BEARING OF SOUTH 34°17'09" WEST, AND A CHORD DISTANCE OF 918.03 FEET TO A POINT OF COMPOUND CURVE, THENCE SOUTHWESTERLY ALONG SAID RIGHT-OF-WAY LINE AN ALONG THE ARC OF A CURVE, SAID CURVE BEING CONCAVE NORTHERLY, HAVING A RADIUS OF 2099.86 FEET; THENCE SOUTHWESTERLY ALONG THE NORTHERLY RIGHT-OF-WAY LINE OF SAID FLORA BRANCH BOULEVARD AND THE ARC OF SAID CURVE AN ARC DISTANCE OF 2210.14 FEET, SAID ARC BEING SUBTENDED BY A CHORD

BEARING OF SOUTH 85°06'52" WEST, AND A CHORD DISTANCE OF 2109.53 FEET TO THE POINT OF TANGENCY OF SAID CURVE; THENCE NORTH 64°43'59" WEST CONTINUING ALONG SAID NORTHERLY RIGHT-OF-WAY LINE, A DISTANCE OF 601.65 FEET; THENCE NORTH 06°00'47" WEST LEAVING SAID RIGHT-OF-WAY LINE, A DISTANCE OF 150.00 FEET; THENCE NORTH 76°42'44" WEST, A DISTANCE OF 157.94 FEET TO A POINT LYING ON A CURVE, SAID CURVE BEING CONCAVE WESTERLY, HAVING A RADIUS OF 339.25 FEET; THENCE NORTHEASTERLY ALONG THE ARC OF SAID CURVE AN ARC DISTANCE OF 114.28 FEET, SAID ARC BEING SUBTENDED BY A CHORD BEARING OF NORTH 03°38'15" EAST, AND A CHORD DISTANCE OF 113.74 FEET TO THE POINT OF TANGENCY OF SAID CURVE; THENCE NORTH 06°00'47" WEST, A DISTANCE OF 381.24 FEET TO THE POINT OF TANGENCY OF A CURVE, CONCAVE SOUTHWESTERLY, HAVING A RADIUS OF 365.97 FEET; THENCE NORTHWESTERLY ALONG THE ARC OF SAID CURVE AN ARC DISTANCE OF 191.58 FEET, SAID ARC BEING SUBTENDED BY A CHORD BEARING OF NORTH 21°00'35" WEST, AND A CHORD DISTANCE OF 189.40 FEET TO THE END OF SAID CURVE; THENCE NORTH 53°59'38" EAST; A DISTANCE OF 145.60 FEET; THENCE NORTH 38°30'02" WEST, A DISTANCE OF 358.41 FEET; THENCE NORTH 18°23'05" WEST, A DISTANCE OF 140.73 FEET; THENCE NORTH 03°16'28" EAST, A DISTANCE OF 30.05 FEET; THENCE SOUTH 89°14'12" WEST, A DISTANCE OF 192.12 FEET; THENCE NORTH 00°45'48" WEST, A DISTANCE OF 121.08 FEET; THENCE SOUTH 89°14'12" WEST, A DISTANCE OF 164.83 FEET; THENCE NORTH 00°28'51" WEST ALONG A WEST LINE OF SAID JULINGTON CREEK UNIT NINE AND ITS SOUTHERLY PROJECTION THEREOF, A DISTANCE OF 1352.56 FEET TO THE NORTHEAST CORNER OF SECTION 5, TOWNSHIP 5 SOUTH, RANGE 27 EAST; THENCE NORTH 65°37'06" WEST, A DISTANCE OF 842.74 FEET; THENCE NORTH 57°54'06" WEST, A DISTANCE OF 148.09 FEET; THENCE NORTH 15°49'39" EAST, A DISTANCE OF 212.72 FEET TO A POINT LYING ON A CURVE, SAID CURVE BEING CONCAVE NORTHERLY, HAVING A RADIUS OF 330.00 FEET; THENCE NORTHEASTERLY ALONG THE ARC OF SAID CURVE AN ARC DISTANCE OF 185.18 FEET, SAID ARC BEING SUBTENDED BY A CHORD BEARING OF NORTH 89°06'36" EAST, AND A CHORD DISTANCE OF 182.76 FEET TO THE POINT OF REVERSE CURVE, THENCE SOUTHEASTERLY ALONG THE ARC OF A CURVE SAID CURVE BEING CONCAVE SOUTHWESTERLY HAVING A RADIUS OF 25.00 FEET AN ARC DISTANCE OF 33.65 FEET, SAID ARC BEING SUBTENDED BY A CHORD BEARING OF SOUTH 68°24'40" EAST, AND A CHORD DISTANCE OF 31.16 FEET TO THE POINT OF TANGENCY OF SAID CURVE; THENCE SOUTH 29°51'23" EAST, A DISTANCE OF 67.49 FEET; THENCE NORTH 60°08'37" EAST, A DISTANCE OF 60.00 FEET; THENCE NORTH 29°51'23" WEST, A DISTANCE OF 44.88 FEET; THENCE NORTH 56°25'49" EAST, A DISTANCE OF 112.74 FEET; THENCE SOUTH 46°49'05" EAST, A DISTANCE OF 90.00 FEET; THENCE SOUTH 84°46'09" EAST, A DISTANCE OF 61.25 FEET; THENCE NORTH 41°56'43" EAST, A DISTANCE OF 67.63 FEET; THENCE NORTH 00°08'37" EAST, A DISTANCE OF 615.00 FEET; THENCE NORTH 06°29'42" EAST, A DISTANCE OF 86.80 FEET; THENCE NORTH 28°47'18" WEST, A DISTANCE OF 60.75 FEET; THENCE NORTH 77°14'24" WEST, A DISTANCE OF 66.18 FEET; THENCE NORTH 12°34'07" WEST, A DISTANCE OF 120.00 FEET; THENCE NORTH 19°57'03" WEST, A DISTANCE OF 60.39 FEET; THENCE NORTH 14°17'45" WEST, A DISTANCE OF 190.18 FEET; THENCE SOUTH 73°26'53" EAST, A DISTANCE OF 11.42 FEET; THENCE SOUTH

77°09'07" EAST, A DISTANCE OF 489.24 FEET; THENCE SOUTH 57°37'51" EAST, A DISTANCE OF 303.56 FEET; THENCE SOUTH 55°55'54" EAST, A DISTANCE OF 302.40 FEET; THENCE SOUTH 51°20'01" EAST, A DISTANCE OF 328.10 FEET; THENCE SOUTH 46°55'31" EAST, A DISTANCE OF 150.00 FEET; THENCE SOUTH 34°24'46" WEST, A DISTANCE OF 860.87 FEET; THENCE SOUTH 15°37'03" EAST, A DISTANCE OF 295.05 FEET; THENCE SOUTH 22°42'11" WEST, A DISTANCE OF 270.48 FEET; THENCE SOUTH 62°17'49" EAST, A DISTANCE OF 180.00 FEET; THENCE SOUTH 23°52'36" WEST, A DISTANCE OF 283.15 FEET; THENCE SOUTH 62°20'12" EAST, A DISTANCE OF 720.00 FEET; THENCE SOUTH 04°16'03" WEST, A DISTANCE OF 1007.85 FEET; THENCE SOUTH 06°00'47" EAST, A DISTANCE OF 370.00 FEET; THENCE SOUTH 34°45'40" EAST, A DISTANCE OF 450.85 FEET; THENCE SOUTH 59°25'15" EAST, A DISTANCE OF 511.08 FEET; THENCE NORTH 60°38'32" EAST, A DISTANCE OF 367.15 FEET; THENCE NORTH 17°52'43" WEST, A DISTANCE OF 325.73 FEET; THENCE NORTH 03°34'35" EAST, A DISTANCE OF 160.31 FEET; THENCE NORTH 29°30'41" EAST, A DISTANCE OF 609.02 FEET; THENCE DUE NORTH, A DISTANCE OF 380.00 FEET; THENCE NORTH 87°00'00" EAST, A DISTANCE OF 350.00 FEET; THENCE NORTH 17°00'00" WEST, A DISTANCE OF 395.00 FEET; THENCE NORTH 74°55'12" EAST, A DISTANCE OF 130.46 FEET; THENCE NORTH 24°37'25" WEST, A DISTANCE OF 264.01 FEET; THENCE NORTH 39°48'20" WEST, A DISTANCE OF 546.71 FEET; THENCE NORTH 63°26'06" WEST, A DISTANCE OF 290.69 FEET; THENCE NORTH 38°05'20" WEST, A DISTANCE OF 470.11 FEET; THENCE NORTH 30°57'50" WEST, A DISTANCE OF 583.10 FEET; THENCE NORTH 40°48'54" WEST, A DISTANCE OF 290.69 FEET; THENCE NORTH 48°17'21" WEST, A DISTANCE OF 616.20 FEET; THENCE DUE NORTH, A DISTANCE OF 307.88 FEET, TO THE POINT OF BEGINNING

CONTAINING BY COMPUTATIONS BY NORTHEAST FLORIDA SURVEYORS ON NOVEMBER 21, 1991, 245.33 ACRES MORE OR LESS.

JULINGTON CREEK UNIT NINE

A PORTION OF SECTION 36 AND A PORTION OF SECTION 35, TOWNSHIP 17N, RANGE 15W, COUNTY OF POLK, FLORIDA. THIS PLAN IS A PARTIAL PLAT VACATION OF UNIT NINE OF JULINGTON CREEK UNIT NINE. THE AREA TO BE VACATED IS SHOWN BY HATCHING.

EXHIBIT "A"
 PARTIAL PLAT VACATION
 OF UNIT NINE

 AREA TO BE VACATED

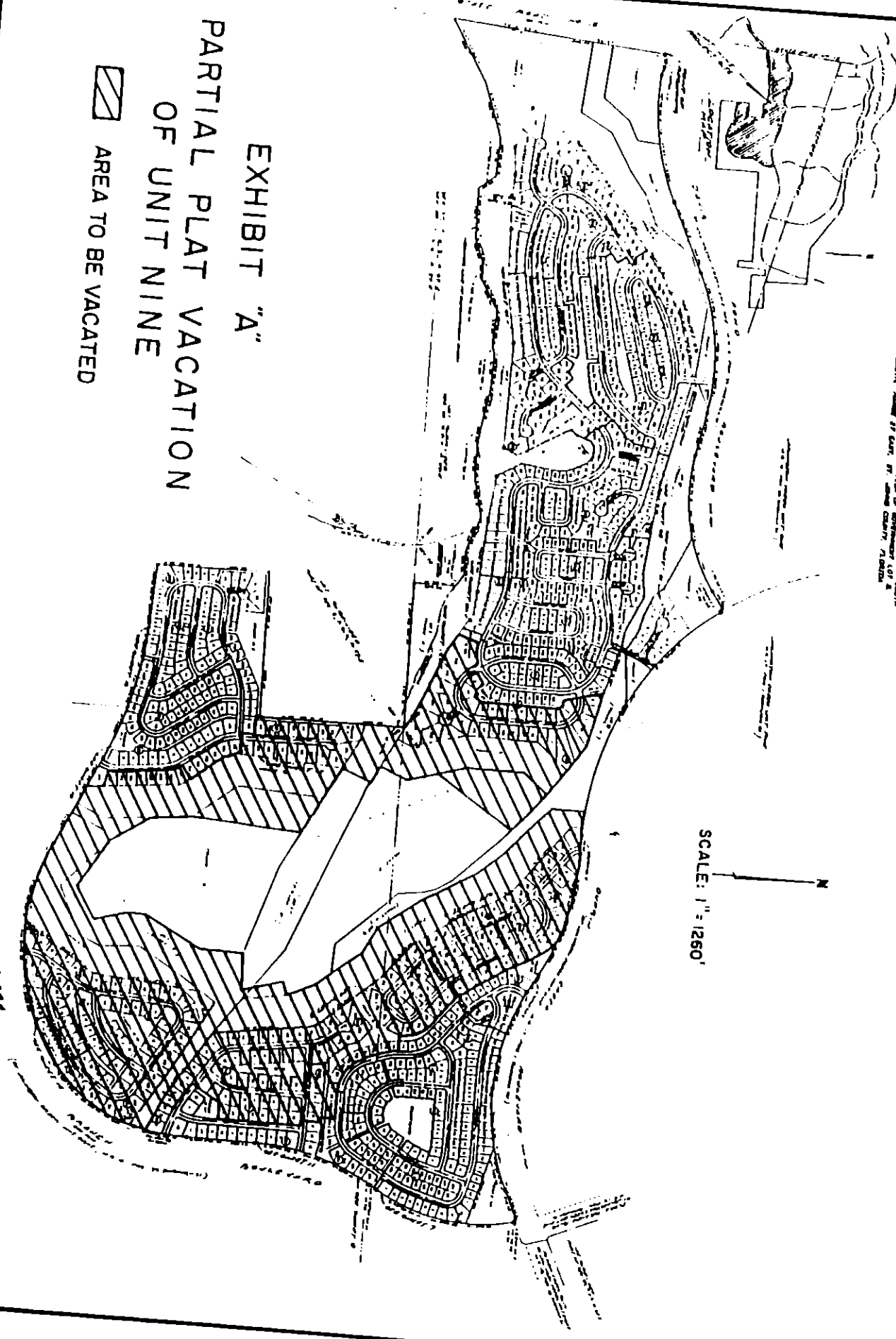

PREPARED BY:
 NORTHWEST FLORIDA SURVEYORS
 3000 CORPORATE SQUARE S.W.
 JACKSONVILLE, FLORIDA 32216

The St. Augustine Record

PUBLISHED EVERY AFTERNOON MONDAY THROUGH FRIDAY, SATURDAY AND SUNDAY MORNING
ST. AUGUSTINE AND ST. JOHNS COUNTY, FLORIDA

STATE OF FLORIDA,
COUNTY OF ST. JOHNS

Before the undersigned authority personally appeared _____
SHERRY L. RAUCH

_____ who on oath says that she is
ACCOUNTING CLERK _____ of the St. Augustine Record, a

daily newspaper published at St. Augustine in St. Johns County, Florida: that
the attached copy of advertisement, being a _____
NOTICE OF PUBLIC HEARING

_____ in the matter of _____
JULINGTON CREEK UNIT NINE

_____ in the _____ Court,
was published in said newspaper in the issues of _____
December 5 and 9, 1991

Affiant further says that the St. Augustine Record is a newspaper published
at St. Augustine, in said St. Johns County, Florida, and that the said
newspaper has heretofore been continuously published in said St. Johns Coun-
ty, Florida, each day and has been entered as second class mail matter at the
post office in the City of St. Augustine, in said St. Johns County, Florida, for a
period of one year next preceding the first publication of the attached copy of
advertisement; and affiant further says that she has neither paid nor promised
any person, firm or corporation any discount, rebate, commission or refund
for the purpose of securing the advertisement for publication in the said
newspaper.

Sworn to and subscribed before me _____
this 9th _____ day of _____ December
A.D. 19 91

Zoe Ann Johns
(SEAL) _____ Notary Public
8/22/93

Sherry L. Rauch
Zoe Ann Johns

NOTICE OF PUBLIC HEARING
 ON PETITION TO VACATE A PORTION OF
 THE PLAT OF JULINGTON CREEK, UNIT NINE
 TAKE NOTICE, that the Board of County Commissioners of St. Johns County, Florida, upon petition of qualified land owners will hold a public hearing at 1:30 p.m., on December 10, 1991, in the County Auditorium of the St. Johns County Administration Building, 4020 Lewis Speedway, (County Road 16-A) and U.S. Highway 1 North, St. Augustine, to consider and determine whether it will vacate the following described portion of the Plat of Julington Creek, Unit Nine;
 EXHIBIT "A"

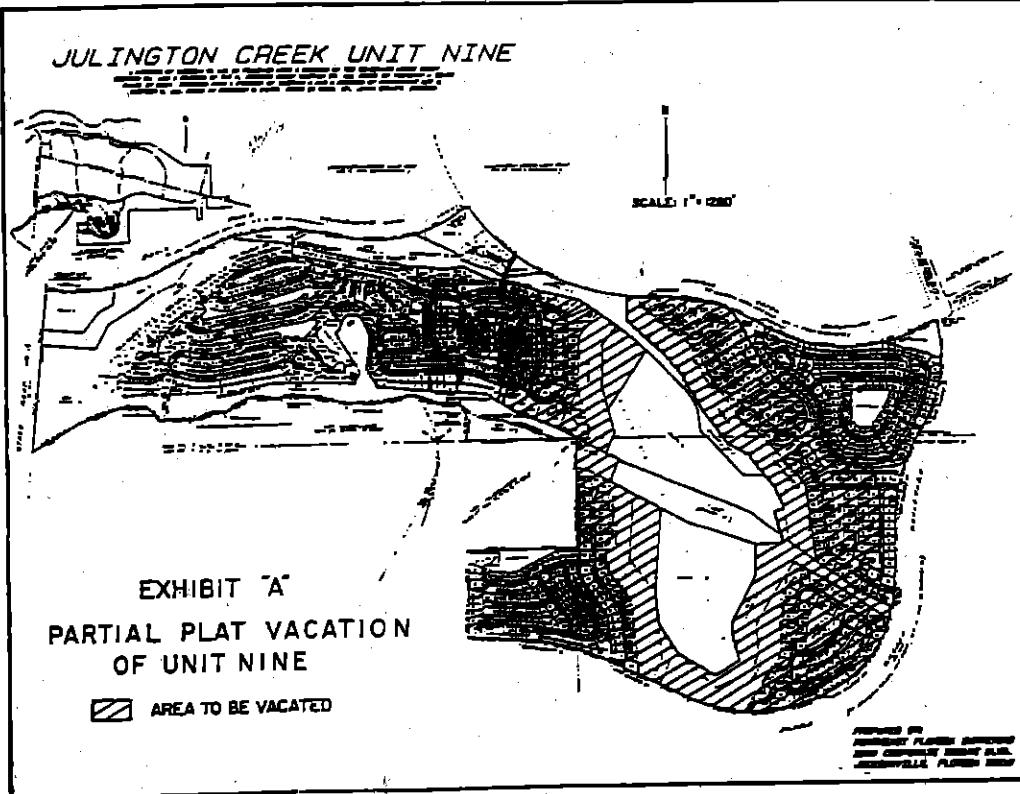

EXHIBIT "A"
 PARTIAL PLAT VACATION
 OF UNIT NINE
 [Hatched Box] AREA TO BE VACATED

A PART OF JULINGTON CR IN MAP BOOK 18, PAGES 77 T PUBLIC RECORDS OF ST. JOI COMPOSITE OF THE FOLLO AND ROADWAYS AS FOLLO LOTS 61 THROUGH 88, BLOC BLOCKS 226, 227 AND 228, TOI 29, BLOCK 229, TOGETHER W ER WITH LOTS 3 THROUGH 19, BLOCK 231, TOGETHER WITH LOTS 1 THROUGH 6, BLOCK 233, ALL OF BLOCKS 234, 239 AND 240, TOGETHER WITH LOTS 18 THROUGH 29, BLOCK 241, TOGETHER WITH LOTS 5 THROUGH 29, BLOCK 242, TOGETHER WITH LOTS 1 THROUGH 13, BLOCK 253, TOGETHER WITH PART OF TRACT "B", TOGETHER WITH ALL OF TRACTS "L", "N", "O" AND "P", TOGETHER WITH A PART OF TRACTS "C" AND "F" (WI), TOGETHER WITH A PART OF TRACTS G-4, TOGETHER WITH ALL OF TRACTS G-5, G-6, G-7, G-8, G-9, G-10, G-11, G-12, G-13, G-14, G-15 AND G-16, TOGETHER WITH A PART OF TRACT G-17, TOGETHER WITH ALL OF TRACT G-18, TOGETHER WITH A PART OF TRACTS G-19 AND G-20, TOGETHER WITH ALL OF TRACTS G-29, G-30, G-31, G-32, G-33, G-34 AND G-35, TOGETHER WITH ALL OF WINDFLOWER CIRCLE, BASIL BRANCH AND WINDFLOWER CIRCLE CONNECTOR, TOGETHER WITH A PART OF MAYAPPLE BRANCH AND PERIWINKLE PLACE, TOGETHER WITH ALL OF BUTTERFLY BRANCH, LAVENDER LOOP, TOGETHER WITH A PART OF PENNYCRESS PLACE AND SENEIO BRANCH EAST, TOGETHER WITH ALL OF VENUS COURT, ALL MORE PARTICULARLY DESCRIBED AS FOLLOWS: FOR A POINT OF BEGINNING COMMENCE AT THE NORTHWEST CORNER OF SAID TRACT "L", SAID CORNER LYING ON THE SOUTHERLY RIGHT-OF-WAY LINE OF DURBIN CREEK BOULEVARD BY JULINGTON CREEK UNIT FIVE, AS RECORDED IN MAP BOOK 17, PAGES 1 THROUGH 21 INCLUSIVE OF SAID CURRENT PUBLIC RECORDS (A 200 FOOT RIGHT-OF-WAY BY PLAT); SAID POINT LYING ON A CURVE SAID CURVE BEING CONCAVE NORTHERLY, HAVING A RADIUS OF 2700.00 FEET; THENCE EASTERLY ALONG SAID SOUTHERLY RIGHT-OF-WAY LINE AND ALONG THE ARC OF SAID CURVE AN ARC DISTANCE OF 218.97 FEET, SAID ARC BEING SUBTENDED BY A CHORD BEARING OF SOUTH 87°40'36" EAST, AND A CHORD DISTANCE OF 218.91 FEET TO THE POINT OF TANGENCY OF SAID CURVE; THENCE DUE EAST CONTINUING ALONG SAID SOUTHERLY RIGHT-OF-WAY LINE, A DISTANCE OF 175.37 FEET TO THE POINT OF CURVE OF A CURVE, CONCAVE SOUTHERLY, HAVING A RADIUS OF 2500.00 FEET; THENCE EASTERLY CONTINUING ALONG SAID SOUTHERLY RIGHT-OF-WAY LINE AND ALONG THE ARC OF SAID CURVE AN ARC DISTANCE OF 886.12 FEET, SAID ARC BEING SUBTENDED BY A CHORD BEARING OF SOUTH 79°30'46" EAST, AND A CHORD DISTANCE OF 881.49 FEET TO A POINT ON SAID CURVE; THENCE SOUTH 47°40'39" EAST LEAVING SAID SOUTHERLY RIGHT-OF-WAY LINE, A DISTANCE OF 113.15 FEET; THENCE SOUTH 30°08'29" EAST, A DISTANCE OF 43.84 FEET; THENCE SOUTH 33°19'52" EAST, A DISTANCE OF 304.85 FEET; THENCE SOUTH 36°15'14" EAST, A DISTANCE OF 92.00 FEET; THENCE SOUTH 37°27'52" EAST, A DISTANCE OF 92.98 FEET; THENCE SOUTH 38°57'06" EAST, A DISTANCE OF 29.62 FEET; THENCE SOUTH 51°32'47" EAST, A DISTANCE OF 410.00 FEET; THENCE SOUTH 34°02'23" EAST, A DISTANCE OF 92.06 FEET; THENCE SOUTH 08°47'06" EAST, A DISTANCE OF 244.00 FEET; THENCE SOUTH 68°23'39" EAST, A DISTANCE OF 45.46 FEET; THENCE NORTH 85°24'44" EAST, A DISTANCE OF 100.00 FEET, TO A POINT LYING ON A CURVE, SAID CURVE BEING CONCAVE NORTHEASTERLY, HAVING A RADIUS OF 687.07 FEET; THENCE SOUTHEASTERLY ALONG THE ARC OF SAID CURVE AN ARC DISTANCE OF 197.27 FEET, SAID ARC BEING SUBTENDED BY A CHORD BEARING OF SOUTH 12°48'24" EAST, AND A CHORD DISTANCE OF 196.59 FEET TO THE POINT OF TANGENCY OF SAID CURVE; THENCE SOUTH 21°02'15" EAST, A DISTANCE OF 111.40 FEET TO THE POINT OF CURVE OF A CURVE, CONCAVE NORTHEASTERLY, HAVING A RADIUS OF 366.04 FEET; THENCE SOUTHEASTERLY ALONG THE ARC OF SAID CURVE AN ARC DISTANCE OF 439.40 FEET, SAID ARC BEING SUBTENDED BY A CHORD BEARING OF SOUTH 55°25'37" EAST, AND A CHORD DISTANCE OF 413.49 FEET TO THE POINT OF TANGENCY OF SAID CURVE; THENCE SOUTH 89°48'59" EAST, A DISTANCE OF 255.00 FEET; THENCE SOUTH 00°11'01" WEST, A DISTANCE OF 130.00 FEET; THENCE SOUTH 89°48'59" EAST, A DISTANCE OF 45.25 FEET; THENCE SOUTH 00°11'01" WEST, A DISTANCE OF 190.00 FEET; THENCE SOUTH 89°48'59" EAST, A DISTANCE OF 44.77 FEET; THENCE SOUTH 00°11'01" WEST, A DISTANCE OF 745.00 FEET; THENCE NORTH 89°48'59" WEST, A DISTANCE OF 159.21 FEET; THENCE SOUTH 18°09'55" WEST, A DISTANCE OF 38.42 FEET; THENCE SOUTH 32°23'08" WEST, A DISTANCE OF 276.68 FEET; THENCE SOUTH 57°36'52" EAST, A DISTANCE OF 135.86 FEET TO A POINT OF CURVE OF A CURVE, SAID CURVE BEING CONCAVE NORTH

A PART OF JULINGTON CREEK UNIT NINE
 NFS # 81288.04
 November 21, 1991

THE NORTHERLY RANCH BOULEVARD DISTANCE OF 2210.14 A CHORD BEARING DISTANCE OF 2109.53 OF SAID CURVE; UNING ALONG SAID FEET; THENCE NORTH 06°00'47" WEST LEAVING SAID RIGHT-OF-WAY WAY LINE, A DISTANCE OF 150.00 FEET; THENCE NORTH 76°42'44" WEST, A DISTANCE OF 157.94 FEET TO A POINT LYING ON A CURVE, SAID CURVE BEING CONCAVE WESTERLY, HAVING A RADIUS OF 339.25 FEET; THENCE NORTHEASTERLY ALONG THE ARC OF SAID CURVE AN ARC DISTANCE OF 114.28 FEET, SAID ARC BEING SUBTENDED BY A CHORD BEARING OF NORTH 03°38'15" EAST, AND A CHORD DISTANCE OF 113.74 FEET TO THE POINT OF TANGENCY OF SAID CURVE; THENCE NORTH 06°00'47" WEST, A DISTANCE OF 381.24 FEET TO THE POINT OF CURVE OF A CURVE, CONCAVE SOUTHWESTERLY, HAVING A RADIUS OF 365.97 FEET; THENCE NORTHWESTERLY ALONG THE ARC OF SAID CURVE AN ARC DISTANCE OF 191.58 FEET, SAID ARC BEING SUBTENDED BY A CHORD BEARING OF NORTH 21°00'35" WEST, AND A CHORD DISTANCE OF 189.40 FEET TO THE END OF SAID CURVE; THENCE NORTH 53°59'38" EAST, A DISTANCE OF 144.40 FEET; THENCE NORTH 38°30'02" WEST, A DISTANCE OF 358.41 FEET; THENCE NORTH 18°23'05" WEST, A DISTANCE OF 190.23 FEET; THENCE NORTH 03°16'28" EAST, A DISTANCE OF 30.65 FEET; THENCE SOUTH 89°14'12" WEST, A DISTANCE OF 192.12 FEET; THENCE NORTH 00°45'48" WEST, A DISTANCE OF 121.48 FEET; THENCE SOUTH 89°14'12" WEST, A DISTANCE OF 164.10 FEET; THENCE NORTH 00°28'51" WEST ALONG A WEST LINE OF SAID JULINGTON CREEK UNIT NINE AND ITS SOUTHERLY PROJECTION THEREOF, A DISTANCE OF 1352.56 FEET TO THE NORTHEAST CORNER OF SECTION 5, TOWNSHIP 5 SOUTH, RANGE 27 EAST; THENCE NORTH 65°37'06" WEST, A DISTANCE OF 842.74 FEET; THENCE NORTH 57°54'06" WEST, A DISTANCE OF 148.09 FEET; THENCE NORTH 15°49'39" EAST, A DISTANCE OF 212.72 FEET TO A POINT LYING ON A CURVE, SAID CURVE BEING CONCAVE NORTHERLY, HAVING A RADIUS OF 330.00 FEET; THENCE NORTHEASTERLY ALONG THE ARC OF SAID CURVE AN ARC DISTANCE OF 185.18 FEET, SAID ARC BEING SUBTENDED BY A CHORD BEARING OF NORTH 89°04'36" EAST, AND A CHORD DISTANCE OF 182.76 FEET TO THE POINT OF REVERSE CURVE, THENCE SOUTHEASTERLY ALONG THE ARC OF A CURVE SAID CURVE BEING CONCAVE SOUTHWESTERLY HAVING A RADIUS OF 25.00 FEET AN ARC DISTANCE OF 33.65 FEET, SAID ARC BEING SUBTENDED BY A CHORD BEARING OF SOUTH 68°24'40" EAST, AND A CHORD DISTANCE OF 31.16 FEET TO THE POINT OF TANGENCY OF SAID CURVE; THENCE SOUTH 29°51'23" EAST, A DISTANCE OF 67.49 FEET; THENCE NORTH 60°08'37" EAST, A DISTANCE OF 60.00 FEET; THENCE NORTH 29°51'23" WEST, A DISTANCE OF 44.88 FEET; THENCE NORTH 56°25'49" EAST, A DISTANCE OF 112.74 FEET; THENCE SOUTH 48°49'05" EAST, A DISTANCE OF 90.00 FEET; THENCE NORTH 84°46'09" EAST, A DISTANCE OF 61.25 FEET; THENCE NORTH 41°56'43" EAST, A DISTANCE OF 67.43 FEET; THENCE NORTH 00°08'37" EAST, A DISTANCE OF 615.00 FEET; THENCE NORTH 04°29'42" EAST, A DISTANCE OF 86.80 FEET; THENCE NORTH 28°47'18" WEST, A DISTANCE OF 60.75 FEET; THENCE NORTH 77°14'24" WEST, A DISTANCE OF 66.18 FEET; THENCE NORTH 12°34'07" WEST, A DISTANCE OF 120.00 FEET; THENCE NORTH 19°57'03" WEST, A DISTANCE OF 60.39 FEET; THENCE NORTH 14°17'45" WEST, A DISTANCE OF 190.10 FEET; THENCE SOUTH 73°26'53" EAST, A DISTANCE OF 11.42 FEET; THENCE SOUTH 77°09'07" EAST, A DISTANCE OF 489.24 FEET; THENCE SOUTH 57°37'51" EAST, A DISTANCE OF 303.56 FEET; THENCE SOUTH 55°55'54" EAST, A DISTANCE OF 302.40 FEET; THENCE SOUTH 51°20'01" EAST, A DISTANCE OF 328.10 FEET; THENCE SOUTH 46°55'31" EAST, A DISTANCE OF 150.00 FEET; THENCE SOUTH 34°24'46" WEST, A DISTANCE OF 840.87 FEET; THENCE SOUTH 15°37'03" EAST, A DISTANCE OF 295.05 FEET; THENCE SOUTH 22°42'11" WEST, A DISTANCE OF 270.48 FEET; THENCE SOUTH 62°17'49" EAST, A DISTANCE OF 180.00 FEET; THENCE SOUTH 23°52'36" WEST, A DISTANCE OF 283.15 FEET; THENCE SOUTH 62°20'12" EAST, A DISTANCE OF 720.00 FEET; THENCE SOUTH 04°16'03" WEST, A DISTANCE OF 1007.85 FEET; THENCE SOUTH 06°00'47" EAST, A DISTANCE OF 370.00 FEET; THENCE SOUTH 34°45'40" EAST, A DISTANCE OF 450.85 FEET; THENCE SOUTH 59°25'15" EAST, A DISTANCE OF 511.08 FEET; THENCE NORTH 60°38'32" EAST, A DISTANCE OF 367.15 FEET; THENCE NORTH 17°52'43" WEST, A DISTANCE OF 325.73 FEET; THENCE NORTH 03°34'35" EAST, A DISTANCE OF 160.31 FEET; THENCE NORTH 29°30'41" EAST, A DISTANCE OF 609.02 FEET; THENCE DUE NORTH, A DISTANCE OF 380.00 FEET; THENCE NORTH 87°00'00" EAST, A DISTANCE OF 350.00 FEET; THENCE NORTH 17°00'00" WEST, A DISTANCE OF 395.00 FEET; THENCE NORTH 74°55'12" EAST, A DISTANCE OF 130.46 FEET; THENCE NORTH 24°37'25" WEST, A DISTANCE OF 244.01 FEET; THENCE NORTH 39°48'20" WEST, A DISTANCE OF 546.71 FEET; THENCE NORTH 68°26'06" WEST, A DISTANCE OF 290.69 FEET; THENCE NORTH 38°05'20" WEST, A DISTANCE OF 470.11 FEET; THENCE NORTH 30°57'50" WEST, A DISTANCE OF 583.10 FEET; THENCE NORTH 40°48'54" WEST, A DISTANCE OF 290.69 FEET; THENCE NORTH 48°17'21" WEST, A DISTANCE OF 616.20 FEET; THENCE DUE NORTH, A DISTANCE OF 307.88 FEET, TO THE POINT OF BEGINNING.

EASTERLY, HAVING A RADIUS OF 1344.58 FEET; THENCE SOUTHEASTERLY ALONG THE ARC OF SAID CURVE AN ARC DISTANCE OF 157.33 FEET, SAID ARC BEING SUBTENDED BY A CHORD BEARING OF SOUTH 60°58'00" EAST, AND A CHORD DISTANCE OF 157.24 FEET TO A POINT ON SAID CURVE; THENCE SOUTH 25°40'53" WEST, A DISTANCE OF 130.25 FEET; THENCE SOUTH 64°22'41" EAST ALONG A LINE TO ITS INTERSECTION WITH THE WESTERLY RIGHT-OF-WAY LINE OF FLORA BRANCH BOULEVARD BY JULINGTON CREEK UNIT EIGHT AS RECORDED IN MAP BOOK 18, PAGES 33 THROUGH 51 INCLUSIVE OF SAID PUBLIC RECORDS (A 200 FOOT RIGHT-OF-WAY BY PLAT); A DISTANCE OF 305.25 FEET TO A POINT LYING ON A CURVE, SAID CURVE BEING CONCAVE WESTERLY, HAVING A RADIUS OF 2100.00 FEET; THENCE SOUTHWESTERLY ALONG SAID WESTERLY RIGHT-OF-WAY LINE AND ALONG THE ARC OF SAID CURVE AN ARC DISTANCE OF 96.64 FEET, SAID ARC BEING SUBTENDED BY A CHORD BEARING OF SOUTH 12°17'28" WEST, AND A CHORD DISTANCE OF 96.63 FEET TO THE POINT OF COMPOUND CURVE; THENCE SOUTHWESTERLY ALONG SAID RIGHT-OF-WAY LINE AND ALONG A CURVE SAID CURVE BEING CONCAVE NORTHWESTERLY, HAVING A RADIUS OF 1300.00 FEET, AN ARC DISTANCE OF 938.26 FEET, SAID ARC BEING SUBTENDED BY A CHORD BEARING OF SOUTH 34°17'08" WEST, AND A CHORD DISTANCE OF 918.83 FEET TO A POINT OF COMPOUND CURVE, THENCE SOUTHWESTERLY ALONG SAID RIGHT-OF-WAY LINE AND ALONG THE ARC OF A CURVE, SAID CURVE BEING CONCAVE NORTHERLY, HAVING A RADIUS OF 2099.86

FEET; THENCE NORTH 06°00'47" WEST LEAVING SAID RIGHT-OF-WAY WAY LINE, A DISTANCE OF 150.00 FEET; THENCE NORTH 76°42'44" WEST, A DISTANCE OF 157.94 FEET TO A POINT LYING ON A CURVE, SAID CURVE BEING CONCAVE WESTERLY, HAVING A RADIUS OF 339.25 FEET; THENCE NORTHEASTERLY ALONG THE ARC OF SAID CURVE AN ARC DISTANCE OF 114.28 FEET, SAID ARC BEING SUBTENDED BY A CHORD BEARING OF NORTH 03°38'15" EAST, AND A CHORD DISTANCE OF 113.74 FEET TO THE POINT OF TANGENCY OF SAID CURVE; THENCE NORTH 06°00'47" WEST, A DISTANCE OF 381.24 FEET TO THE POINT OF CURVE OF A CURVE, CONCAVE SOUTHWESTERLY, HAVING A RADIUS OF 365.97 FEET; THENCE NORTHWESTERLY ALONG THE ARC OF SAID CURVE AN ARC DISTANCE OF 191.58 FEET, SAID ARC BEING SUBTENDED BY A CHORD BEARING OF NORTH 21°00'35" WEST, AND A CHORD DISTANCE OF 189.40 FEET TO THE END OF SAID CURVE; THENCE NORTH 53°59'38" EAST, A DISTANCE OF 144.40 FEET; THENCE NORTH 38°30'02" WEST, A DISTANCE OF 358.41 FEET; THENCE NORTH 18°23'05" WEST, A DISTANCE OF 190.23 FEET; THENCE NORTH 03°16'28" EAST, A DISTANCE OF 30.65 FEET; THENCE SOUTH 89°14'12" WEST, A DISTANCE OF 192.12 FEET; THENCE NORTH 00°45'48" WEST, A DISTANCE OF 121.48 FEET; THENCE SOUTH 89°14'12" WEST, A DISTANCE OF 164.10 FEET; THENCE NORTH 00°28'51" WEST ALONG A WEST LINE OF SAID JULINGTON CREEK UNIT NINE AND ITS SOUTHERLY PROJECTION THEREOF, A DISTANCE OF 1352.56 FEET TO THE NORTHEAST CORNER OF SECTION 5, TOWNSHIP 5 SOUTH, RANGE 27 EAST; THENCE NORTH 65°37'06" WEST, A DISTANCE OF 842.74 FEET; THENCE NORTH 57°54'06" WEST, A DISTANCE OF 148.09 FEET; THENCE NORTH 15°49'39" EAST, A DISTANCE OF 212.72 FEET TO A POINT LYING ON A CURVE, SAID CURVE BEING CONCAVE NORTHERLY, HAVING A RADIUS OF 330.00 FEET; THENCE NORTHEASTERLY ALONG THE ARC OF SAID CURVE AN ARC DISTANCE OF 185.18 FEET, SAID ARC BEING SUBTENDED BY A CHORD BEARING OF NORTH 89°04'36" EAST, AND A CHORD DISTANCE OF 182.76 FEET TO THE POINT OF REVERSE CURVE, THENCE SOUTHEASTERLY ALONG THE ARC OF A CURVE SAID CURVE BEING CONCAVE SOUTHWESTERLY HAVING A RADIUS OF 25.00 FEET AN ARC DISTANCE OF 33.65 FEET, SAID ARC BEING SUBTENDED BY A CHORD BEARING OF SOUTH 68°24'40" EAST, AND A CHORD DISTANCE OF 31.16 FEET TO THE POINT OF TANGENCY OF SAID CURVE; THENCE SOUTH 29°51'23" EAST, A DISTANCE OF 67.49 FEET; THENCE NORTH 60°08'37" EAST, A DISTANCE OF 60.00 FEET; THENCE NORTH 29°51'23" WEST, A DISTANCE OF 44.88 FEET; THENCE NORTH 56°25'49" EAST, A DISTANCE OF 112.74 FEET; THENCE SOUTH 48°49'05" EAST, A DISTANCE OF 90.00 FEET; THENCE NORTH 84°46'09" EAST, A DISTANCE OF 61.25 FEET; THENCE NORTH 41°56'43" EAST, A DISTANCE OF 67.43 FEET; THENCE NORTH 00°08'37" EAST, A DISTANCE OF 615.00 FEET; THENCE NORTH 04°29'42" EAST, A DISTANCE OF 86.80 FEET; THENCE NORTH 28°47'18" WEST, A DISTANCE OF 60.75 FEET; THENCE NORTH 77°14'24" WEST, A DISTANCE OF 66.18 FEET; THENCE NORTH 12°34'07" WEST, A DISTANCE OF 120.00 FEET; THENCE NORTH 19°57'03" WEST, A DISTANCE OF 60.39 FEET; THENCE NORTH 14°17'45" WEST, A DISTANCE OF 190.10 FEET; THENCE SOUTH 73°26'53" EAST, A DISTANCE OF 11.42 FEET; THENCE SOUTH 77°09'07" EAST, A DISTANCE OF 489.24 FEET; THENCE SOUTH 57°37'51" EAST, A DISTANCE OF 303.56 FEET; THENCE SOUTH 55°55'54" EAST, A DISTANCE OF 302.40 FEET; THENCE SOUTH 51°20'01" EAST, A DISTANCE OF 328.10 FEET; THENCE SOUTH 46°55'31" EAST, A DISTANCE OF 150.00 FEET; THENCE SOUTH 34°24'46" WEST, A DISTANCE OF 840.87 FEET; THENCE SOUTH 15°37'03" EAST, A DISTANCE OF 295.05 FEET; THENCE SOUTH 22°42'11" WEST, A DISTANCE OF 270.48 FEET; THENCE SOUTH 62°17'49" EAST, A DISTANCE OF 180.00 FEET; THENCE SOUTH 23°52'36" WEST, A DISTANCE OF 283.15 FEET; THENCE SOUTH 62°20'12" EAST, A DISTANCE OF 720.00 FEET; THENCE SOUTH 04°16'03" WEST, A DISTANCE OF 1007.85 FEET; THENCE SOUTH 06°00'47" EAST, A DISTANCE OF 370.00 FEET; THENCE SOUTH 34°45'40" EAST, A DISTANCE OF 450.85 FEET; THENCE SOUTH 59°25'15" EAST, A DISTANCE OF 511.08 FEET; THENCE NORTH 60°38'32" EAST, A DISTANCE OF 367.15 FEET; THENCE NORTH 17°52'43" WEST, A DISTANCE OF 325.73 FEET; THENCE NORTH 03°34'35" EAST, A DISTANCE OF 160.31 FEET; THENCE NORTH 29°30'41" EAST, A DISTANCE OF 609.02 FEET; THENCE DUE NORTH, A DISTANCE OF 380.00 FEET; THENCE NORTH 87°00'00" EAST, A DISTANCE OF 350.00 FEET; THENCE NORTH 17°00'00" WEST, A DISTANCE OF 395.00 FEET; THENCE NORTH 74°55'12" EAST, A DISTANCE OF 130.46 FEET; THENCE NORTH 24°37'25" WEST, A DISTANCE OF 244.01 FEET; THENCE NORTH 39°48'20" WEST, A DISTANCE OF 546.71 FEET; THENCE NORTH 68°26'06" WEST, A DISTANCE OF 290.69 FEET; THENCE NORTH 38°05'20" WEST, A DISTANCE OF 470.11 FEET; THENCE NORTH 30°57'50" WEST, A DISTANCE OF 583.10 FEET; THENCE NORTH 40°48'54" WEST, A DISTANCE OF 290.69 FEET; THENCE NORTH 48°17'21" WEST, A DISTANCE OF 616.20 FEET; THENCE DUE NORTH, A DISTANCE OF 307.88 FEET, TO THE POINT OF BEGINNING.

CONTAINING BY COMPUTATIONS BY NORTHEAST FLORIDA SURVEYORS ON NOVEMBER 21, 1991, 243.33 ACRES MORE OR LESS.

All parties having any interest in said matter will be afforded an opportunity to be heard at the public hearing.
 If a person decides to appeal any decision made by the Board of County Commissioners with respect to any matter considered at the meeting or hearing, he will need a record of the proceedings, and for such record he may need to ensure that a verbatim record of the proceedings is made, which record includes the testimony and evidence upon which the appeal is to be based.
 This notice is published pursuant to the provisions of Section 177.10(4), Florida Statutes.
 DATED this 3rd day of December, 1991.
 BOARD OF COUNTY COMMISSIONERS OF ST. JOHNS COUNTY, FLORIDA
 CARL "BUD" MARKEL, ITS CLERK
 By Irma C. Pacelli
 Deputy Clerk
 L267 Dec. 5, 9, 1991