

RESOLUTION NO. 92-139

A RESOLUTION OF THE BOARD OF COUNTY COMMISSIONERS OF ST. JOHNS COUNTY, FLORIDA ESTABLISHING THE RATES OF THE THOMPSON-BAILEY ROAD MSBU NON AD VALOREM ASSESSMENTS LEVIED PURSUANT TO ST. JOHNS COUNTY ORDINANCE 91-51, AS AMENDED, AND ADOPTING THE ANNUAL NON AD VALOREM ASSESSMENT ROLL PERTAINING THERETO.

BE IT RESOLVED by the Board of County Commissioners of St. Johns County, Florida as follows:

Section 1. The rates or amounts of the Thompson-Bailey Road MSBU non ad valorem special assessments levied pursuant to St. Johns County ordinance 91-51, as amended, (the "Ordinance") are hereby established and set at the total rate (amount) of \$225.00 (plus interest at 7.5% per year on the unpaid balance) for each acre or fraction thereof (the "unit of measurement") of land located within the Thompson-Bailey Road MSBU and at the total rate (amount) of \$15.00 (plus interest at 7.5% per year on the unpaid balance) for each front foot of land (the "unit of measure") within the MSBU that is adjacent to the portions of Roads to be paved described on Exhibit A attached hereto.

The total "acreage" special assessment shall be applied and charged at the yearly rate of \$25.49 per acre or fraction thereof per year (which yearly rate includes interest) for 15 consecutive years commencing November 1992. The total "front foot" special assessment shall be applied and charged at the yearly rate of \$1.70 per front foot (as described above) per year (which yearly rate

includes interest) for 15 consecutive years commencing November 1992. Both such special assessments will be collected each of those 15 years pursuant to Florida Statute 197.3632 in the manner and at the times that ad valorem taxes are collected. The unpaid principal balances plus any accrued interest may be paid in full at the option of the parcel owner prior to the due date of the last scheduled installments.

Section 2. The non ad valorem assessment roll attached hereto is hereby adopted as the St. Johns County Thompson-Bailey Road MSBU non ad valorem assessment roll. The amounts of the rates shown therein shall be controlled by this resolution as it may be amended from time to time.

Section 3. By September 15, 1992 and by September 15 each year thereafter, the County Administrator shall certify the Thompson-Bailey Road MSBU non ad valorem assessment roll, with such additions, reductions authorized by section 11 of the Ordinance, and deletions each year as are appropriate, on compatible electronic medium to the St. Johns County tax collector with the dollar amounts of the Thompson-Bailey Road MSBU non ad valorem assessments due that year for each parcel posted thereon.

Section 4. Notwithstanding anything to the contrary above, pursuant to section 13 of the Ordinance and in order to accomplish the purposes of the MSBU set forth in Section 2, parcels containing

acreage that do not consist of an acre or an integer multiple thereof shall be assessed for the fractional acreage portion of such parcel on a pro rata basis.

PASSED AND ADOPTED BY THE BOARD OF COUNTY COMMISSIONERS OF ST. JOHNS COUNTY, FLORIDA this 25th day of August, 1992.

BOARD OF COUNTY COMMISSIONERS  
OF ST. JOHNS COUNTY, FLORIDA

By: Fred Brinkhoff  
Its Chairman - Fred Brinkhoff

ATTEST: CARL "BUD" MARKEL, CLERK

By: Yvonne Carter  
Deputy Clerk



EXHIBIT A

The portions of the Roads to be paved are described as follows:

Portion of Powell Road to be paved

A STRIP OF LAND 60.00 FEET IN WIDTH IN SECTION 40, TOWNSHIP 7 SOUTH, RANGE 29 EAST, ST. JOHNS COUNTY, FLORIDA. MORE FULLY DESCRIBED AS FOLLOWS:

COMMENCING AT THE NORTHWEST CORNER OF SECTION 42, TOWNSHIP 7 SOUTH, RANGE 29 EAST, (THE NORTHERLY LINE OF SAID SECTION 42 HAVING A BEARING OF NORTH 68 DEGREES 00 MINUTES EAST FROM SAID NORTHWEST CORNER); THENCE SOUTH 71 DEGREES 18 MINUTES 00 SECONDS WEST 1,320.00 FEET; THENCE NORTH 21 DEGREES 17 MINUTES 00 SECONDS WEST 60.07 FEET TO THE POINT OF BEGINNING AT THE SOUTH END OF THE HEREIN DESCRIBED STRIP OF LAND; THENCE CONTINUING NORTH 21 DEGREES 17 MINUTES 00 SECONDS WEST 1,548.57 FEET; THENCE NORTH 71 DEGREES 43 MINUTES 12 SECONDS EAST 60.07 FEET; THENCE SOUTH 21 DEGREES 17 MINUTES 00 SECONDS EAST 1,541.67 FEET; THENCE SOUTH 71 DEGREES 18 MINUTES 00 SECONDS WEST, ACROSS THE SOUTH END OF SAID STRIP OF LAND 60.07 FEET TO THE POINT OF BEGINNING.

Portion of Thompson-Bailey Road to be paved

A STRIP OF LAND 60 FEET IN WIDTH IN SECTION 42, TOWNSHIP 7 SOUTH, RANGE 29 EAST; ST. JOHNS COUNTY, FLORIDA, LYING 30 FEET ON EACH SIDE OF THE FOLLOWING DESCRIBED CENTER LINE: COMMENCING AT THE NORTHWEST CORNER OF SECTION 42, TOWNSHIP 7 SOUTH, RANGE 29 EAST; THENCE NORTH 82 DEGREES 44 MINUTES WEST ON THE WESTERLY LINE OF A COUNTY ROAD 30.47 FEET; THENCE SOUTH 71 DEGREES 18 MINUTES WEST 2366.00 TO THE POINT ON THE WEST LINE OF SECTION 40 AND THE END OF SAID STRIP OF LAND.

# The St. Augustine Record

PUBLISHED EVERY AFTERNOON MONDAY THROUGH FRIDAY, SATURDAY AND SUNDAY MORNING  
ST. AUGUSTINE AND ST. JOHNS COUNTY, FLORIDA

STATE OF FLORIDA,  
COUNTY OF ST. JOHNS

Before the undersigned authority personally appeared \_\_\_\_\_  
SHERRY L. RAUCH \_\_\_\_\_ who on oath says that she is  
ACCOUNTING CLERK \_\_\_\_\_ of the St. Augustine Record, a  
daily newspaper published at St. Augustine in St. Johns County, Florida: that  
the attached copy of advertisement, being a \_\_\_\_\_  
NOTICE OF HEARING \_\_\_\_\_  
\_\_\_\_\_ in the matter of \_\_\_\_\_  
THOMPSON-BAILEY ROAD \_\_\_\_\_  
\_\_\_\_\_ in the \_\_\_\_\_ Court,  
was published in said newspaper in the issues of \_\_\_\_\_  
JULY 24, 1992 \_\_\_\_\_

Affiant further says that the St. Augustine Record is a newspaper published  
at St. Augustine, in said St. Johns County, Florida, and that the said  
newspaper has heretofore been continuously published in said St. Johns County,  
Florida, each day and has been entered as second class mail matter at the  
post office in the City of St. Augustine, in said St. Johns County, Florida, for a  
period of one year next preceding the first publication of the attached copy of  
advertisement; and affiant further says that she has neither paid nor promised  
any person, firm or corporation any discount, rebate, commission or refund  
for the purpose of securing the advertisement for publication in the said  
newspaper.

*Sherry L. Rauch*

Sworn to and subscribed before me Zoe Ann Johns

this 27th day of July

A.D. 19 92

*Zoe Ann Johns*  
(SEAL) 8122193 Notary Public

**COPY OF ADVERTISEMENT**

**NOTICE OF ST. JOHNS COUNTY COMMISSION HEARING TO ESTABLISH THE THOMPSON-BAILEY ROAD MSBU NON AD VALOREM ASSESSMENT RATES AND TO ADOPT A NON AD VALOREM ASSESSMENT ROLL FOR SUCH ASSESSMENTS.**

NOTICE IS HEREBY GIVEN that on Tuesday, the 25th day of August, 1992 at 5:01 o'clock p.m. the Board of County Commissioners of St. Johns County, Florida will hold a public hearing in the County Auditorium of the County Administration Building at 4020 Lewis Speedway, St. Augustine, Florida to establish the rates of the Thompson-Bailey Road MSBU non ad valorem assessments levied pursuant to St. Johns County Ordinance 91-51 as amended at \$225.00 (plus interest at 7 1/2% per year on the unpaid balance) for each acre or fraction thereof of land located within the Thompson-Bailey Road MSBU and at \$15.00 (plus interest at 7 1/2% per year on the unpaid balance) for each front foot of land within the MSBU that is adjacent to the portion of the Roads to be paved. The assessments are payable at the option of the parcel owner in 15 consecutive equal annual installments of principal and interest. Additionally, at such hearing the Board of County Commissioners will adopt a non ad valorem assessment roll for such assessments pursuant to Florida Statute 197.3632.

The purpose of the assessments is to fund the costs including debt, of Road acquisition, Drainage Improvements and Road Improvements as described in the Ordinance.

All lands located within the Thompson-Bailey Road MSBU depicted in the map in this notice are subject to the \$225.00 per acre or fraction thereof assessment. Additionally, all lands adjacent to the highlighted portions of Powell Road and Thompson-Bailey Road as depicted in such map are subject to the \$15.00 per front foot assessment.

The \$225.00 (plus interest at 7 1/2% per year on the unpaid balance) per acre or fraction thereof assessment will be applied at the rate of \$25.49 per acre or fraction thereof per year for 15 consecutive years commencing November 1992. Likewise, the \$15.00 (plus interest at 7 1/2% per year on the unpaid balance) per front foot assessment will be applied at the rate of \$1.9549 per front foot per year for 15 consecutive years commencing November 1992. Each of said assessments will be subject to all collection provisions pertaining to ad valorem taxes. The unpaid principal balances plus any accrued interest may be paid in full at the option of the parcel owner prior to the due date of the last scheduled installments.

The assessments will be collected by the tax collector. All affected property owners have the right to appear at the public hearing and the right to file written objections with the St. Johns County Board of County Commissioners at 4020 Lewis Speedway, St. Augustine, Florida 32095 within 20 days of the publication of this notice.

IF A PERSON DECIDES TO APPEAL ANY DECISION MADE BY THE BOARD OF COUNTY COMMISSIONERS WITH RESPECT TO ANY MATTER CONSIDERED AT THE HEARING, SUCH PERSON WILL NEED A RECORD OF THE PROCEEDINGS, AND FOR SUCH PURPOSES SUCH PERSON MAY NEED TO ENSURE THAT A VERBATIM RECORD OF THE PROCEEDINGS IS MADE, WHICH RECORD INCLUDES THE TESTIMONY AND EVIDENCE UPON WHICH THE APPEAL IS TO BE BASED.

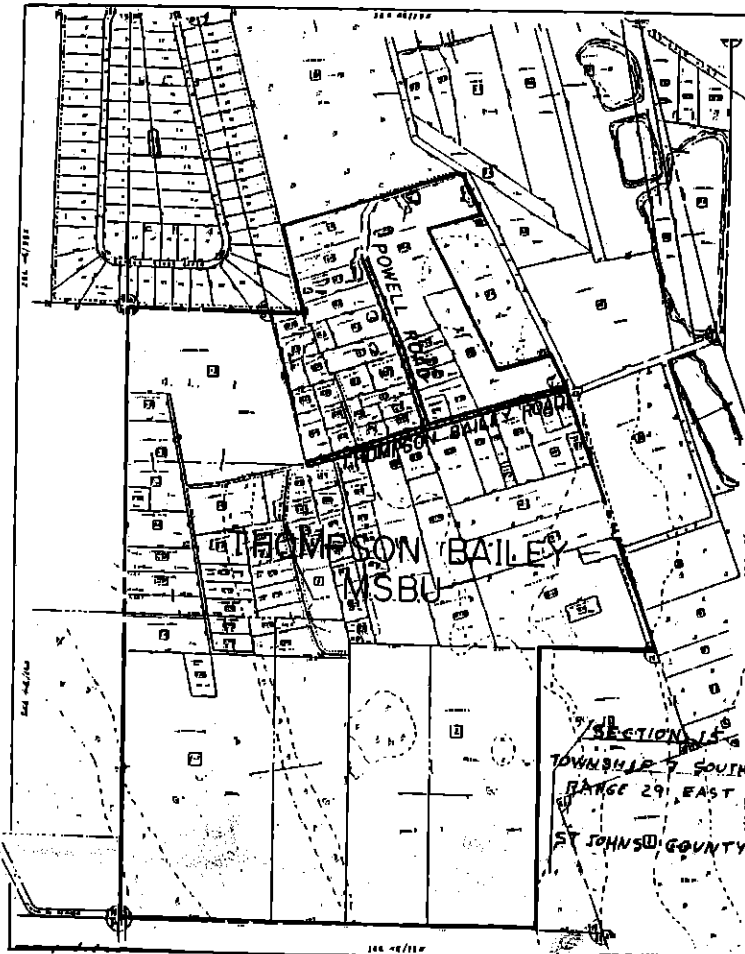

BOARD OF COUNTY COMMISSIONERS  
OF ST. JOHNS COUNTY, FLORIDA  
By Yvonne Carter  
Deputy Clerk  
L640 July 24, 1992