

#17
Creeks

RESOLUTION OF THE BOARD OF
COUNTY COMMISSIONERS
ST. JOHNS COUNTY, STATE OF FLORIDA

APPROVING A MAJOR MODIFICATION TO
PUD ORDINANCE NUMBER 82-14
ALSO KNOWN AS JULINGTON CREEK PUD
AND RESOLUTION 87-66-FINAL DEVELOPMENT PLAN
FOR TRACT 7, UNIT ONE, JULINGTON CREEK
KNOWN AS JULINGTON SQUARE

BE IT RESOLVED BY: THE BOARD OF COUNTY COMMISSIONERS OF
ST. JOHNS COUNTY, FLORIDA:

SECTION 1. Pursuant to the request of Nael Hannoush on behalf
of Nael Hannoush for Major Modification to PUD and Final
Development Plan for Tract 7, Unit One, Julington Creek,
hereinafter the "PUD" and "FDP", the following modification
has been considered by the St. Johns County Planning and
Zoning Agency and Board of County Commissioners:

The Conversion of 2500 square feet of approved 66,120
square feet of retail space for Julington Square to
a child day care center, which is located within an
existing vacant portion of the Julington Square Shopping
Center at the corner of State Road 13 and Racetrack
Road, in accordance with Exhibits "A" and "B" attached
hereto.

SECTION 2. The property is located on Tract "F", Julington
Creek Unit One as recorded in Map Book 16, page 35 of the
public records of St. Johns County, Fla.

SECTION 3. Said Major Modification is hereby approved in accordance with the application identified in Sections 1 and 2, and all exhibits attached hereto.

PASSED AND ADOPTED THIS 24th DAY OF March 1992.

BOARD OF COUNTY COMMISSIONERS:
ST. JOHNS COUNTY, FLORIDA

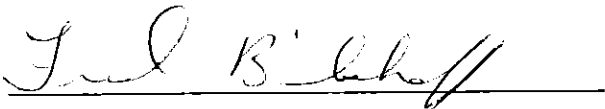

ITS CHAIRMAN

ATTEST: Carl "BUD" Markel
Clerk of Courts

BY: 
Its clerk

File

CHILDHOOD DAYCARE CENTER
445 SR 13
JACKSONVILLE, FL 32259

March 12, 1992

Mr. Don Bement
St. Johns County
Planning and Zoning Department
P.O. Drawer 349
St. Augustine, FL 32085-0349

Subject: Childhood Day Care Center

Dear Mr. Bement:

As we discussed in our meeting, attached please find a copy of the revised site plan. Two parking spaces were deleted. Curbs will be installed to isolate the unused area resulting in the deletion of parking spaces. Chain link fence will receive a decorative filler strip.

I trust we have met the requirements to represent this case to the Board of County Commissioners on March 19, 1992.

Thank you for your help in this matter.

Sincerely,



Nael Hannoush

Exhibit A to Resolution

RACETRACK ROAD

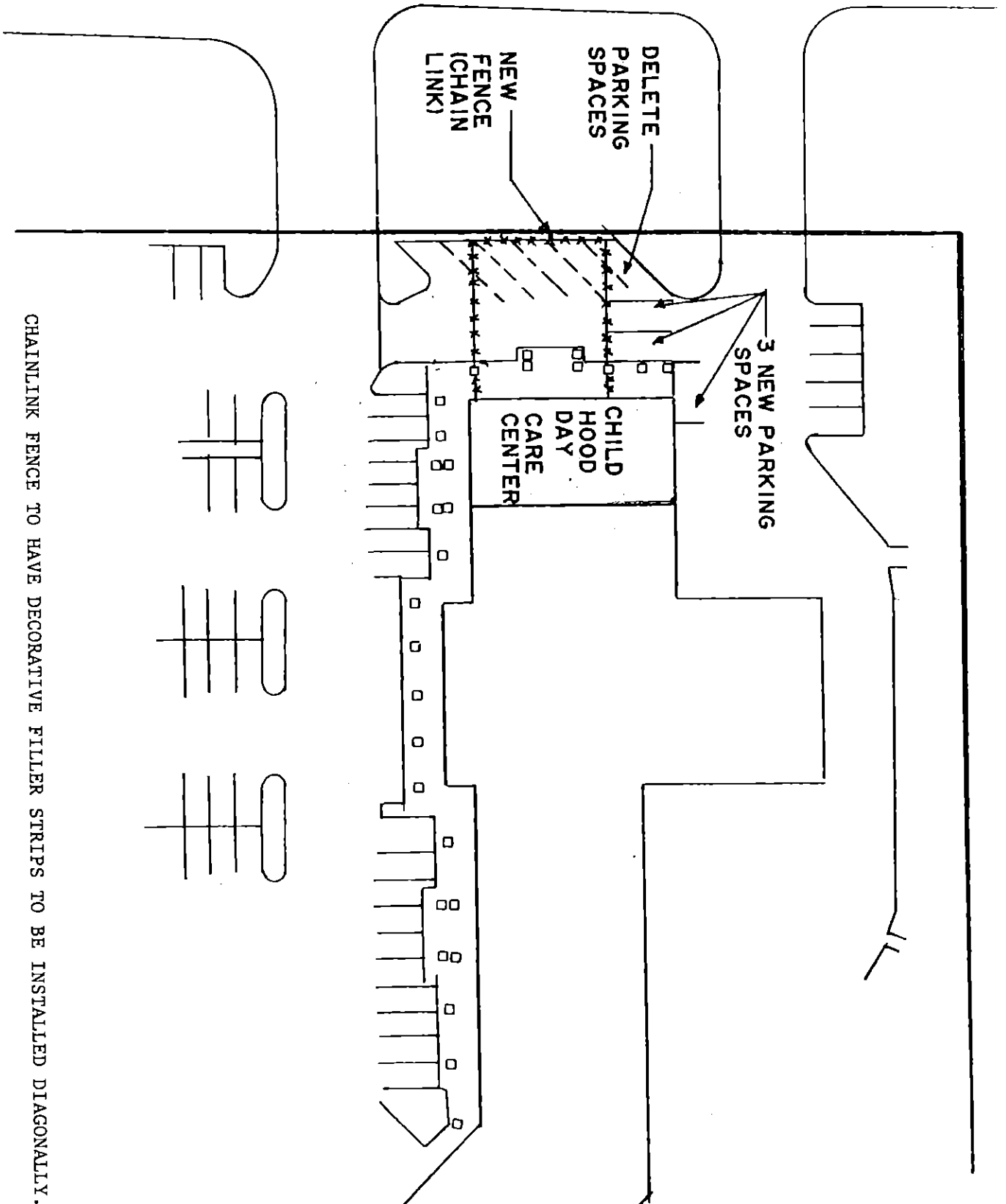

Exhibit B to Resolution

SITE PLAN

SCALE 1" = 50'

REVISED 3-12-92