

RESOLUTION NO. 94-171

A RESOLUTION BY THE BOARD OF COUNTY COMMISSIONERS OF ST. JOHNS COUNTY, FLORIDA APPROVING TRANSFER OF CERTAIN UN-OPENED COUNTY RIGHT OF WAY MORE FULLY DESCRIBED BELOW, TO THE STATE OF FLORIDA DEPARTMENT OF TRANSPORTATION FOR CONSTRUCTION OF RETENTION AREAS REQUIRED FOR THE FOUR LANE IMPROVEMENT PROJECT OF STATE ROAD 1A.

WHEREAS, the State of Florida Department of Transportation purposes to construct or improve State Road No. 1A, Section No. 78040-2509, in St. Johns County, Florida; and

WHEREAS, it is necessary that certain lands now owned by St. Johns County be acquired by the State of Florida Department of Transportation; and

WHEREAS, said property is not needed for County purposes; and

WHEREAS, the St. Johns County Board of County Commissioners has determined that it is in the best interest of St. Johns County to deed a portion of un-opened County right-of-way to the Florida Department of Transportation for construction of retention areas required for the four lane improvement project of State Road 1A as shown in Exhibit B; and

WHEREAS, the State of Florida Department of Transportation has made application to St. Johns County to execute and deliver to the State of Florida Department of Transportation a County deed in favor of the State of Florida Department of Transportation, conveying all rights, title and interest that said County has in and to the said lands required for transportation purposes.

NOW THEREFORE BE IT RESOLVED by the Board of County Commissioners of St. Johns County, Florida as follows:

Section 1. The application of the State of Florida Department of Transportation for a county deed is for transportation purposes which is in the public or community interest and for the public welfare, and the land needed for transportation and other purposes is not needed for County purposes.

Section 2. A County deed in favor of the State of Florida Department of Transportation conveying all rights, title and interest of St. Johns County, without warranty of title or warranty of method of conveyance, in and to the land described thereon for transportation and other road purposes shall be executed by the Chairman of the Board of County Commissioners. Consideration shall be \$1.00. A copy of the proposed County Deed is attached to this Resolution as Exhibit A.

Section 3. A certified copy of this Resolution shall be forwarded forthwith to the State of Florida Department of Transportation District Two, Eminent Domain Department, Post Office Box 1089, 1901 South Marion Street, Lake City, Florida 32056-1089.

Section 4. The County deed transferring the property to the State of Florida Department of Transportation shall be duly recorded in the official public records of St. Johns County, Florida.

PASSED AND ADOPTED this 13 day of September, 1994.

BOARD OF COUNTY COMMISSIONERS
OF ST. JOHNS COUNTY, FLORIDA

By: Deann Roberts
Its Chairman

ATTEST: Carl "Bud" Markel, Clerk

By: Ima Paeette
Deputy Clerk

03-BSD.03- June 16, 1994

This instrument prepared by
or under the direction of:
Kenneth S. Davis, Senior Attorney
Florida Department of Transportation
Post Office Box 1089
Lake City, Florida 32056-1089

PARCEL NO. 104.1
SECTION 78040-2509
STATE ROAD A1A
(Anastasia Boulevard)
COUNTY OF St. Johns

Rec-13⁰⁰
Sur-200
Doc-.70¢

COUNTY DEED

THIS DEED, made this 13 day of September, 1994,
by ST. JOHNS COUNTY, FLORIDA, a political subdivision of the State
of Florida, grantor, to the STATE OF FLORIDA DEPARTMENT OF
TRANSPORTATION, 1901 South Marion Street, Post Office Box 1089,
Lake City, Florida 32056-1089, grantee: (Wherever used herein the
terms "grantor" and "grantee" include all the parties to this
instrument and the heirs, legal representatives and assigns of
individuals, and the successors, and assigns of organizations).

WITNESSETH: That the grantor, for and in consideration of the
sum of One Dollar (\$1.00) and other valuable considerations,
receipt and sufficiency being hereby acknowledged, hereby grants,
bargains, sells, aliens, remises, releases, conveys and confirms
unto the grantee, all that certain land situate in St. Johns
County, Florida, viz:

A parcel of land in Seminole Avenue and Magnolia Avenue in Sections
15 and 22, Township 8 South, Range 30 East, being more particularly
described as follows:

BEGIN at the Southwest corner of Lot 1, Block 21, Biera Mar
Subdivision, as recorded in Map Book 3, Page 69, of the public
records of St. Johns County, Florida, said corner being the
intersection of the Easterly right of way line of Seminole Avenue
(a 40.00 foot right of way) with the Northerly right of way line of
Magnolia Avenue; thence North 10°30'49" West along the West line of
Lots 1, 2, 3, 4, and 5, of said Block 21 and along said Easterly
right of way line, a distance of 249.45 feet; thence South
79°31'56" West, a distance of 40.00 feet to a point on the Westerly
right of way line of Seminole Avenue; thence South 10°30'49" East
along said Westerly right of way line, a distance of 949.39 feet,
to a point on the Northerly right of way line of Palmetto Avenue (a
50 foot right of way); thence North 79°23'17" East along said
Northerly right of way line of Palmetto Avenue, a distance of 40.00
feet to a point on the Easterly right of way line of Seminole
Avenue; thence North 10°30'49" West along the West line of Block 22
of said Biera Mar Subdivision and along said Easterly right of way
line, a distance of 649.84 feet to the Northwest corner of said
Block 22 said corner being on the Southerly right of way line of
Magnolia Avenue; thence North 79°23'17" East along said Southerly
right of way line and along the North line of Lot 11 of said Block
22, a distance of 100.93 feet to a point on the Westerly right of
way line of S.R. A1A (Anastasia Boulevard) (a 100 foot right of
way); thence North 12°06'12" West along said Westerly right of way
line, a distance of 50.02 feet to a point on the Northerly right of
way line of said Magnolia Avenue and on the South line of Lot 1 of
said Block 21; thence South 79°23'17" West along said Northerly
right of way line and along said South line, a distance of 99.55
feet to the POINT OF BEGINNING,

Containing 0.987 acres more or less.

Recorded in Public Records, St. Johns County, FL
Clerk # 94031473 O.R. 1073 PG 1706 09:48AM 09-21-94
Recording 13.00 Surcharge 2.00 Doc Stamp 0.70

TOGETHER with all tenements, hereditaments and appurtenances thereto belonging or in anywise appertaining.

TO HAVE AND TO HOLD, the same in fee simple forever.

IN WITNESS WHEREOF, the said grantor has caused these presents to be executed in its name by its Board of County Commissioners acting by the Chairperson or Vice-Chairperson of said Board, the day and year aforesaid.

ATTEST: Inna Paetta
Clerk (or Deputy Clerk)

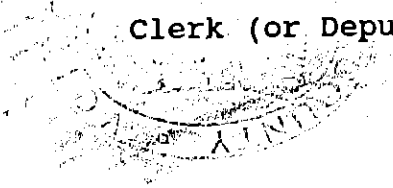

St. Johns County, Florida

By Its Board of County Commissioners

BY: Allen Roberts

Its Chairperson
(or Vice-Chairperson)

STATE OF FLORIDA

COUNTY OF St Johns

The foregoing instrument was acknowledged before me this 15th day of September, 1994, by Allen Roberts

Chairperson (or Vice-Chairperson), who is personally known to me ~~or~~ ~~who has produced~~ as identification.

Patricia DeGrande

Notary Public in and for the County and State last aforesaid.
My Commission Expires: 1-26-96



PATRICIA DEGRANDE
MY COMMISSION # CC 175632 EXPIRES
January 26, 1996
BONDED THRU TRICY FAIR INSURANCE, INC.

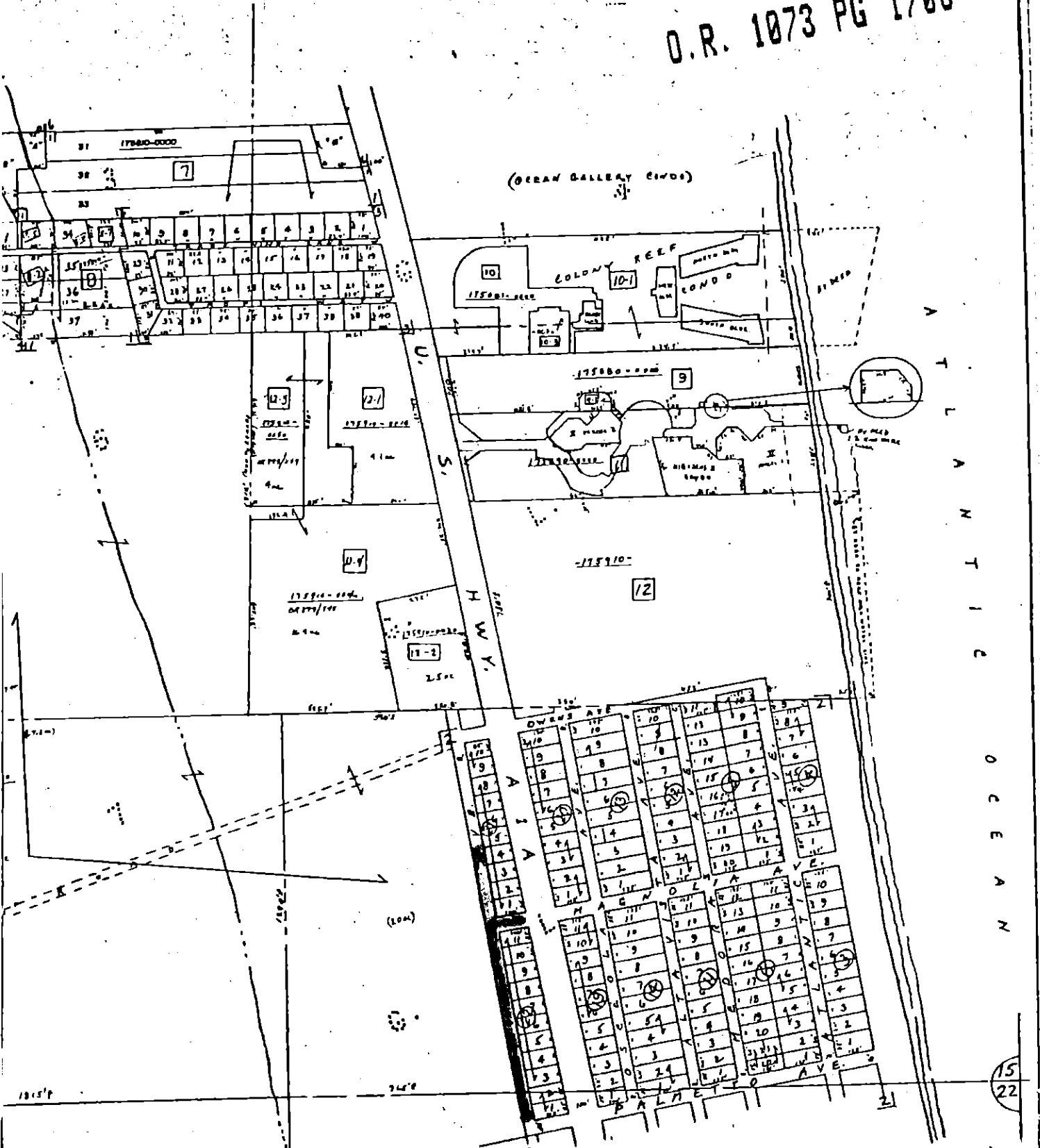

SEE 5F/22N

OVERLAYS AERIAL #167A (3/4)

MAP IS FOR ASSESSMENT PURPOSES ONLY. ST. JOHNS COUNTY PROPERTY APPRAISER DOES NOT CLAIM RESPONSIBILITY FOR "SURVEY" ACCURACY.

ASSESSMENT MAP		SECTION	TOWNSHIP	RANGE	SHEET NUMBER
ST. JOHNS COUNTY, FLORIDA		5/4 15	8S	30E	
OFFICE OF PROPERTY APPRAISER		SCALE	REVISIONS		5F/155
		1" = 200'	3/16/79 DPA		