

RESOLUTION NO. 96- 117  
RESOLUTION OF THE BOARD OF COUNTY  
COMMISSIONERS OF ST. JOHNS COUNTY, FLORIDA  
APPROVING A SUBDIVISION PLAT FOR  
TURTLE SHORES WEST UNIT TWO

WHEREAS, Chartwell Communities Group XXXI, Inc., a Florida Corporation, as Owner, has applied to the Board of County Commissioners of St. Johns County, Florida, for approval to record a subdivision plat know as Turtle Shores West Unit Two.

NOW, THEREFORE BE IT RESOLVED BY THE BOARD OF COUNTY COMMISSIONERS OF ST. JOHNS COUNTY, FLORIDA, as follows:

Section 1. The above-described subdivision plat and its dedicated areas depicted thereon are conditionally approved and accepted by the Board of County Commissioners of St. Johns County, Florida subject to Sections 2, 4, and 5.

Section 2. The Construction Bond is set in the amount of \$ 264,909.30 and shall be delivered to the Clerk of Courts and approved by him prior to recording the plat.

Section 3. A Warranty Bond is not required.

Section 4. The approval and acceptance described in Section 1 shall not take effect until the Clerk has received a title opinion, certificate, or policy pertaining to the real property that is the subject of the aforementioned subdivision plat which opinion, certificate or policy is in a form acceptable to the County Attorney or Assistant County Attorney.

Section 5. The approval and acceptance described in Section 1 shall not take effect until the plat has been signed by each of the following departments, person or offices:

- a) Chairman or Vice-Chairman of the Board of County Commissioners of St. Johns County, Florida;

- b) Office of the County Attorney;
- c) County Planning and Zoning Department; and
- d) Clerk of Courts.

The Clerk shall not sign or accept the Plat for recording until it has been signed by each of the above persons or entities described in a) through c) above. If the plat is not signed and accepted by the Clerk for recording within 14 days from the date hereof, then the above-described conditional approval shall automatically terminate. If the plat is signed by the Clerk on or before such time, the conditions described herein shall be deemed to have been met.

ADOPTED by the Board of County Commissioners of St. Johns County, Florida, this  
9th day of July, 1996.

BOARD OF COUNTY COMMISSIONERS  
OF ST. JOHNS COUNTY, FLORIDA

BY: *Donald Jordan*  
Its Chair - Donald Jordan

ATTEST: Carl "Bud" Markel

*Patricia De Grande*

Deputy Clerk



# TURTLE SHORES WEST

A PORTION OF SECTION 18, TOWNSHIP 6 SOUTH, RANGE 30 EAST, ST. JOHNS COUNTY, FLORIDA.

GENERAL NOTE  
 BEARINGS SHOWN HEREON ARE BASED ON THE SCHEMATIC PLANS OF THE PLATS OF THE PLATS OF THE PUBLIC RECORDS IN THE PUBLIC RECORDS OF ST. JOHNS COUNTY, FLORIDA. THE BEARINGS SHOWN HEREON ARE BASED ON THE SCHEMATIC PLANS OF THE PLATS OF THE PUBLIC RECORDS IN THE PUBLIC RECORDS OF ST. JOHNS COUNTY, FLORIDA. THE BEARINGS SHOWN HEREON ARE BASED ON THE SCHEMATIC PLANS OF THE PLATS OF THE PUBLIC RECORDS IN THE PUBLIC RECORDS OF ST. JOHNS COUNTY, FLORIDA.

THE BEARINGS SHOWN HEREON ARE BASED ON THE SCHEMATIC PLANS OF THE PLATS OF THE PUBLIC RECORDS IN THE PUBLIC RECORDS OF ST. JOHNS COUNTY, FLORIDA. THE BEARINGS SHOWN HEREON ARE BASED ON THE SCHEMATIC PLANS OF THE PLATS OF THE PUBLIC RECORDS IN THE PUBLIC RECORDS OF ST. JOHNS COUNTY, FLORIDA. THE BEARINGS SHOWN HEREON ARE BASED ON THE SCHEMATIC PLANS OF THE PLATS OF THE PUBLIC RECORDS IN THE PUBLIC RECORDS OF ST. JOHNS COUNTY, FLORIDA.

LEGEND  
 3 DENOTES A 1/2" CONCRETE MONUMENT WITH A BRASS DISK STAMPED WITH THE PERMANENT REFERENCE MONUMENT  
 8 DENOTES A 1/2" BRASS DISK STAMPED WITH THE PERMANENT REFERENCE MONUMENT CONTROL POINT

ABBREVIATIONS USED IN THIS PLAT  
 C CENTERLINE  
 P.C. POINT OF CURVATURE  
 P.T. POINT OF TANGENCY  
 P.M. PERMANENT MONUMENT  
 P.S. POINT OF SIGHT  
 S.P. SIGHT POINT

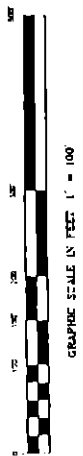

PREPARED BY  
 HENRY J. MILLER & ASSOCIATES  
 1000 N. W. 10th Street  
 Ft. Lauderdale, Florida

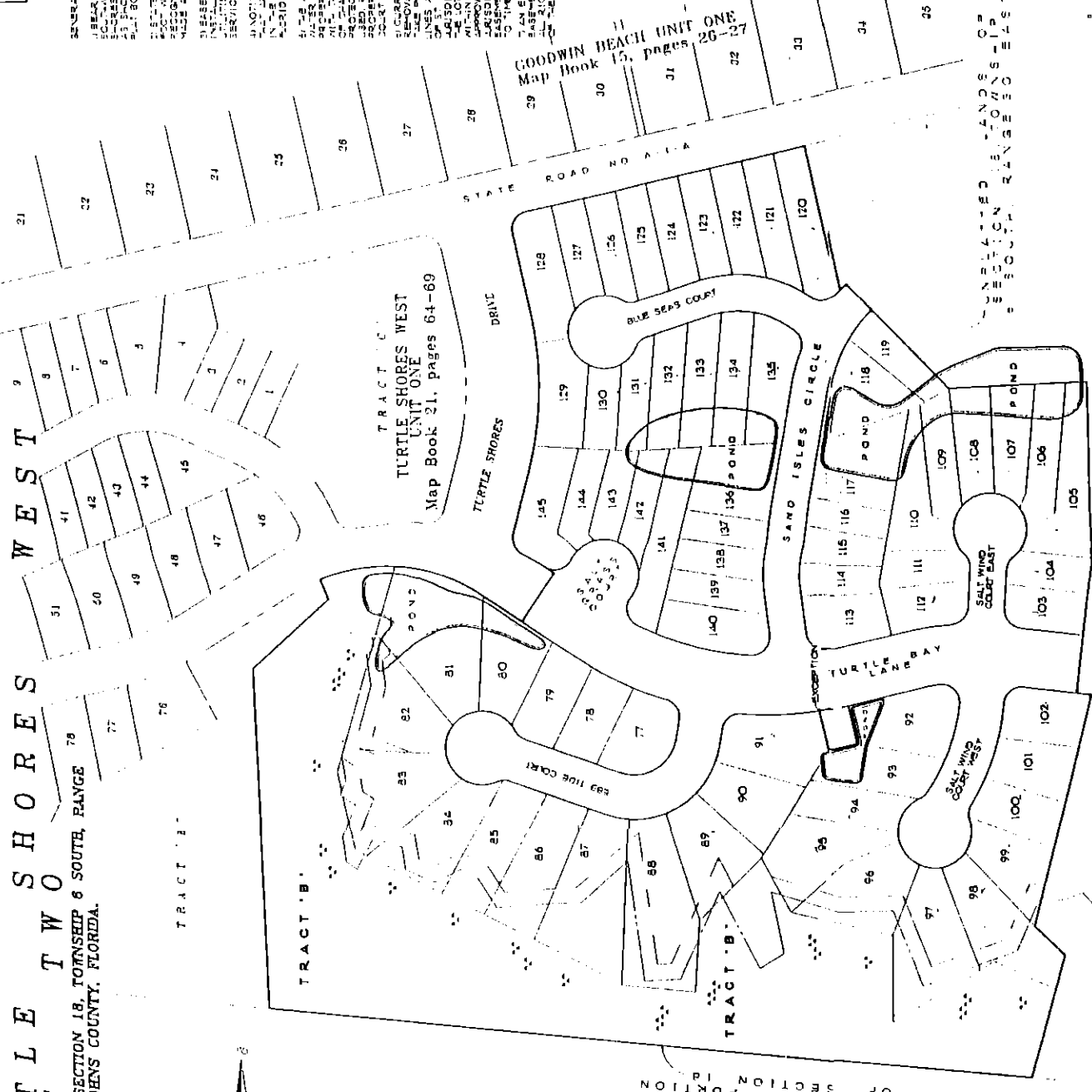

GOODWIN BEACH UNIT ONE  
 Map Book 15, pages 26-27

UNRESERVED PORTION OF SECTION 18