

**RESOLUTION NO 98-32**

**A RESOLUTION OF THE BOARD OF COUNTY  
COMMISSIONERS OF ST. JOHN COUNTY, FLORIDA  
RENAMING A STREET FROM South Vistana Drive to  
Front Nine Drive**

WHEREAS, an application has been duly made to the Board of County Commissioners to rename **South Vistana Drive to Front Nine Drive**.

WHEREAS, the procedure outlined in resolution #92-65 has been followed by the petitioners; and

WHEREAS, it is found to be in the public interest to rename this street as requested on furtherance of the public health, safety and welfare;

NOW THEREFORE BE IT RESOLVED By the Board of County Commissioners as follows:

Section 1. The petition to rename **South Vistana Drive to Front Nine Drive** and shall here after be known by that name.

Section 2. The E 9-1-1 Coordinator is instructed to take whatever steps are necessary to rename the street and to notify the Property Appraiser's Office of this change.

Section 3. The petitioner shall notify, in writing, all residents affected by this resolution.

PASSED AND ADOPTED by the Board of County Commissioners of St. Johns County, Florida, this 10th day of February 1998.

BOARD OF COUNTY COMMISSIONERS  
OF ST JOHNS COUNTY, FLORIDA

By: Moses A. Floyd  
CHAIRMAN

ATTEST: Cheryl Strickland, Clerk

By: Yvonne Carter  
Deputy Clerk

*Handwritten notes:*  
4-1-1 - P. Dequino  
Bill 30  
K... 700  
Sur - 150

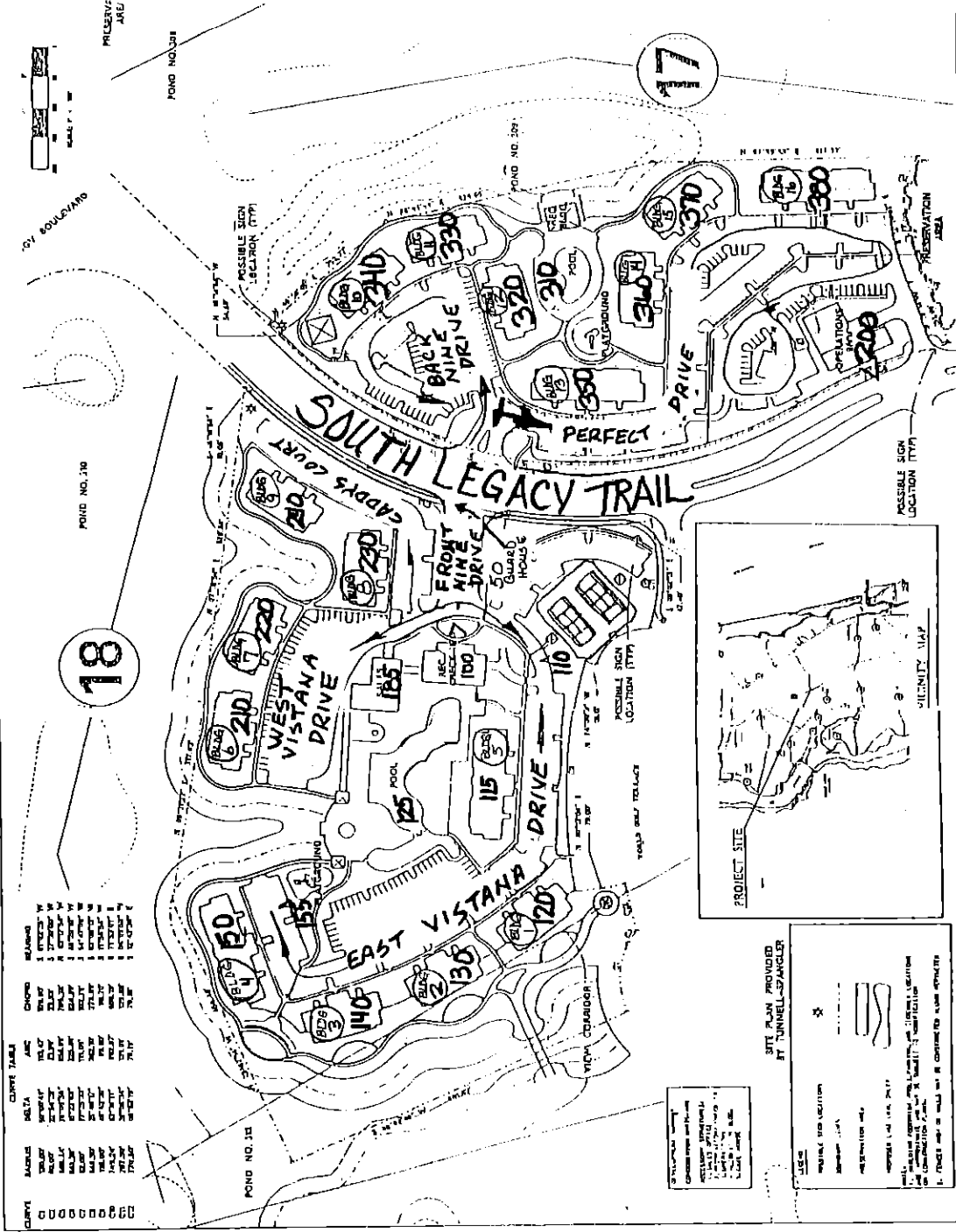

**LEGEND**

SYMBOL	DESCRIPTION
—	PROPERTY LINE
—	EXISTING DRIVE
—	PROPOSED DRIVE
—	EXISTING WALKWAY
—	PROPOSED WALKWAY
—	EXISTING SIDEWALK
—	PROPOSED SIDEWALK
—	EXISTING CONCRETED DRIVE
—	PROPOSED CONCRETED DRIVE
—	EXISTING CONCRETED SIDEWALK
—	PROPOSED CONCRETED SIDEWALK
—	EXISTING CONCRETED DRIVE AND SIDEWALK
—	PROPOSED CONCRETED DRIVE AND SIDEWALK
—	EXISTING CONCRETED DRIVE AND SIDEWALK WITH CURB
—	PROPOSED CONCRETED DRIVE AND SIDEWALK WITH CURB
—	EXISTING CONCRETED DRIVE AND SIDEWALK WITH CURB AND SIDEWALK
—	PROPOSED CONCRETED DRIVE AND SIDEWALK WITH CURB AND SIDEWALK
—	EXISTING CONCRETED DRIVE AND SIDEWALK WITH CURB AND SIDEWALK AND SIDEWALK
—	PROPOSED CONCRETED DRIVE AND SIDEWALK WITH CURB AND SIDEWALK AND SIDEWALK
—	EXISTING CONCRETED DRIVE AND SIDEWALK WITH CURB AND SIDEWALK AND SIDEWALK AND SIDEWALK
—	PROPOSED CONCRETED DRIVE AND SIDEWALK WITH CURB AND SIDEWALK AND SIDEWALK AND SIDEWALK
—	EXISTING CONCRETED DRIVE AND SIDEWALK WITH CURB AND SIDEWALK AND SIDEWALK AND SIDEWALK AND SIDEWALK
—	PROPOSED CONCRETED DRIVE AND SIDEWALK WITH CURB AND SIDEWALK AND SIDEWALK AND SIDEWALK AND SIDEWALK
—	EXISTING CONCRETED DRIVE AND SIDEWALK WITH CURB AND SIDEWALK AND SIDEWALK AND SIDEWALK AND SIDEWALK AND SIDEWALK
—	PROPOSED CONCRETED DRIVE AND SIDEWALK WITH CURB AND SIDEWALK AND SIDEWALK AND SIDEWALK AND SIDEWALK AND SIDEWALK
—	EXISTING CONCRETED DRIVE AND SIDEWALK WITH CURB AND SIDEWALK AND SIDEWALK AND SIDEWALK AND SIDEWALK AND SIDEWALK AND SIDEWALK
—	PROPOSED CONCRETED DRIVE AND SIDEWALK WITH CURB AND SIDEWALK AND SIDEWALK AND SIDEWALK AND SIDEWALK AND SIDEWALK AND SIDEWALK
—	EXISTING CONCRETED DRIVE AND SIDEWALK WITH CURB AND SIDEWALK AND SIDEWALK AND SIDEWALK AND SIDEWALK AND SIDEWALK AND SIDEWALK AND SIDEWALK
—	PROPOSED CONCRETED DRIVE AND SIDEWALK WITH CURB AND SIDEWALK AND SIDEWALK AND SIDEWALK AND SIDEWALK AND SIDEWALK AND SIDEWALK AND SIDEWALK

**NOTES**

1. ALL DIMENSIONS ARE IN FEET AND INCHES.
2. ALL DRIVE AND SIDEWALK DIMENSIONS ARE TO THE CENTERLINE UNLESS OTHERWISE NOTED.
3. ALL DRIVE AND SIDEWALK DIMENSIONS ARE TO THE CENTERLINE UNLESS OTHERWISE NOTED.
4. ALL DRIVE AND SIDEWALK DIMENSIONS ARE TO THE CENTERLINE UNLESS OTHERWISE NOTED.
5. ALL DRIVE AND SIDEWALK DIMENSIONS ARE TO THE CENTERLINE UNLESS OTHERWISE NOTED.
6. ALL DRIVE AND SIDEWALK DIMENSIONS ARE TO THE CENTERLINE UNLESS OTHERWISE NOTED.
7. ALL DRIVE AND SIDEWALK DIMENSIONS ARE TO THE CENTERLINE UNLESS OTHERWISE NOTED.
8. ALL DRIVE AND SIDEWALK DIMENSIONS ARE TO THE CENTERLINE UNLESS OTHERWISE NOTED.
9. ALL DRIVE AND SIDEWALK DIMENSIONS ARE TO THE CENTERLINE UNLESS OTHERWISE NOTED.
10. ALL DRIVE AND SIDEWALK DIMENSIONS ARE TO THE CENTERLINE UNLESS OTHERWISE NOTED.

**SITE PLAN PROVIDED BY TUNNELL-SPANGLER**

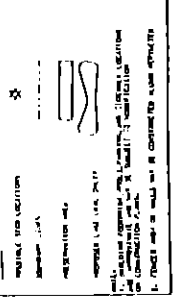

DATE: JUNE 1998	PROJECT NO: 960303	DRAWN BY: [Name]	CHECKED BY: [Name]	SCALE: 1" = 40'	SHEET NO.:		SHEET TOTAL:		
					17	18	17	18	
DESIGNED BY: [Name]					CHECKED BY: [Name]				
DRAWN BY: [Name]					CHECKED BY: [Name]				
PROJECT TITLE: VISTANA					PROJECT NO: 960303				
DATE: JUNE 1998					SCALE: 1" = 40'				
DRAWN BY: [Name]					CHECKED BY: [Name]				
PROJECT TITLE: VISTANA					PROJECT NO: 960303				
DATE: JUNE 1998					SCALE: 1" = 40'				
DRAWN BY: [Name]					CHECKED BY: [Name]				
PROJECT TITLE: VISTANA					PROJECT NO: 960303				
DATE: JUNE 1998					SCALE: 1" = 40'				
DRAWN BY: [Name]					CHECKED BY: [Name]				
PROJECT TITLE: VISTANA					PROJECT NO: 960303				

**THE VILLAS AT  
WORD GOLF VILLAGE  
FOR  
VISTANA, INC.**

**BHR**  
BESSENT, HAMMACI & RUCKMAN, INC.  
CONSULTING AND DESIGN ENGINEERS

**DATE:**  
JUNE 1998  
**PROJECT NO.:**  
960303

VISTANA