

RESOLUTION NO.2000- 40

RESOLVED, that the Board of County Commissioners of St. Johns County, Florida, in the County Auditorium of St. Johns County Administration Building, on May 9, 2000, at 1:30 P.M. upon petition of qualified land owners, will consider the advisability of exercising the power granted to it by Section 336.09, Florida Statutes 1985, and determine whether it will vacate, abandon, discontinue and close portions of certain streets, alleyways or roads described as follows:

A PORTION OF RAMONA STREET AS SET FORTH, SHOWN AND DESCRIBED ON PLAT OF ST. JOHNS SEAVIEW PARK, UNIT 3, ACCORDING TO MAP BOOK 5, PAGE 50 OF THE PUBLIC RECORDS OF ST. JOHNS COUNTY, FLORIDA, EXTENDING FROM THE WESTERLY INTERSECTION OF RAMONA STREET WITH THE EASTERLY RIGHT-OF-WAY LINE OF PONCE DE LEON BOULEVARD (A1A BYPASS) AND RUNNING EASTERLY TO THE EASTERLY BOUNDARY LINE OF LOT 10, BLOCK 1 OF SAID ST. JOHNS SEAVIEW PARK, UNIT 3 AND BORDERED ON THE NORTH BY LOT 10, BLOCK 1 OF SAID ST. JOHNS SEAVIEW PARK, UNIT 3 AND BORDERED ON THE SOUTH BY LOT 1, BLOCK 6 OF SAID ST. JOHNS SEAVIEW PARK, UNIT 3, INCLUDING THE PROPERTY WITHIN SUCH DESCRIPTION DESIGNATED "PARK" ON SAID PLAT OF ST. JOHNS SEAVIEW PARK, UNIT 3.

and the notice required by Section 336.10, Florida Statutes 1985, is hereby authorized and directed to be published.

Further, notice of the time, date, and place of the public hearing shall be promptly mailed by certified mail - return receipt requested, to each of the persons and entities at their addresses as described in the Title Opinion letter by Edgar W. McCurry, dated March 20, 1997 and attached to the petition to vacate.

The petitioner shall perform such mailings and shall provide the Clerk with proof of same five days before the scheduled hearing date.

ADOPTED this 11th day of April, 2000.

BOARD OF COUNTY COMMISSIONERS
OF ST. JOHNS COUNTY, FLORIDA

BY: James E. Bryant

Chairman

ATTEST: CHERYL STRICKLAND, CLERK

BY: Patricia A. Grande
Deputy Clerk

SEE 4 A/21 S

D61350-

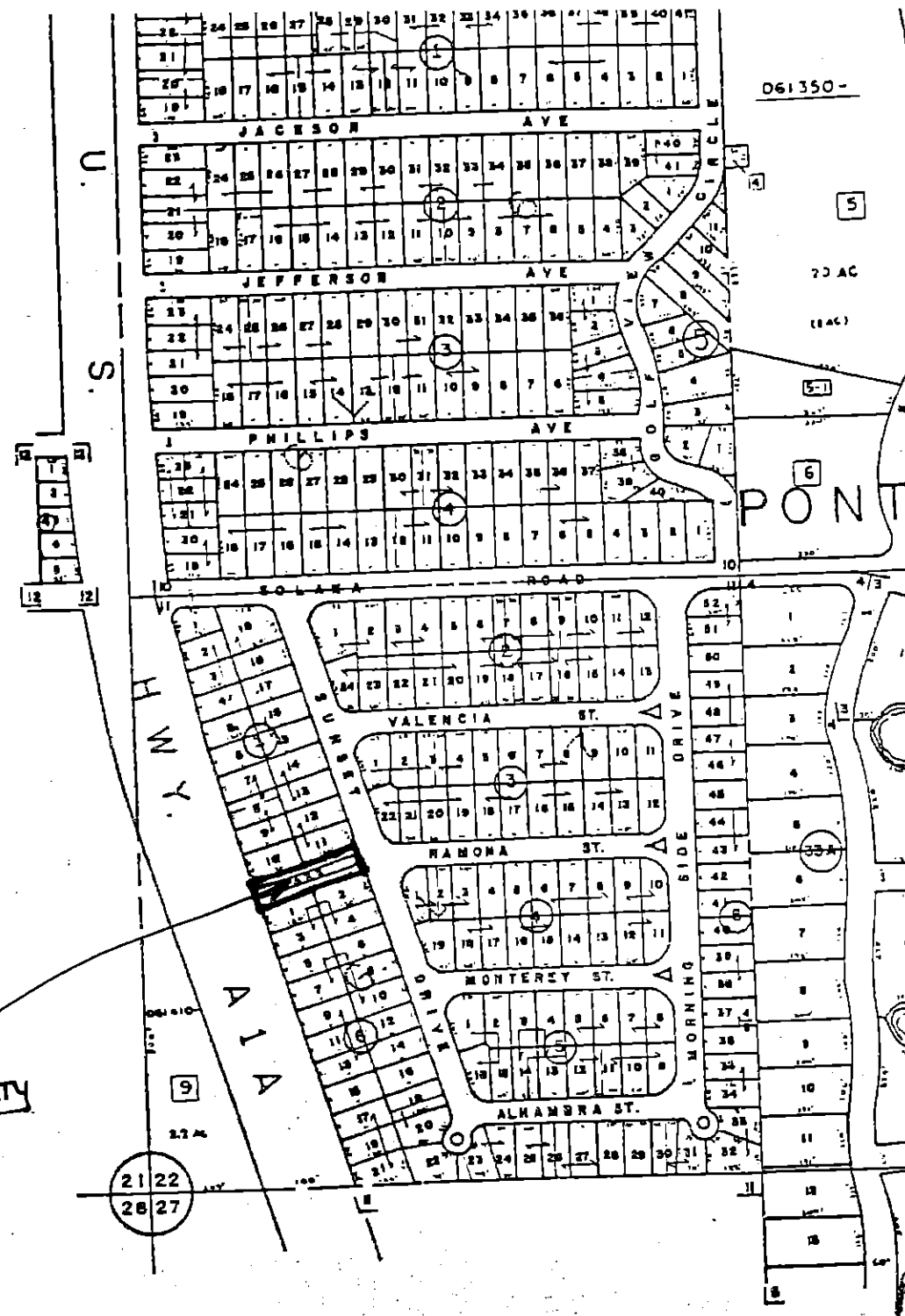

SUBJECT PROPERTY

21 22
28 27

SUBDIVISION				INDEX			
NO.	NAME	MB.	PG.	NO.	NAME	MB.	PG.
1	FORTE VEDRA -- B.L.K. 9, 36, TR. A B.L.K. 9	6	31	7	FORTE VEDRA -- B.L.K. 31	6	31
2	" " -- B.L.K. 34, 35A, 36, 38	6	18	8	" " -- B.L.K. 11, 12, 13, 14, 15, TR. A	6	8
3	" " -- B.L.K. 38	10	78	9	" " -- B.L.K. 9, 36	3	48
4	" " -- B.L.K. 39, 39A	11	38	10	ST. JOHN'S BEAUFORT -- UNIT I	6	88
5	" " -- B.L.K. 37, 38A	11	83	11	" " -- UNIT III	6	51
6	" " -- B.L.K. 22, 23, 24	10	73	12	" " -- UNIT II	6	51