

RESOLUTION NO. 2001-98

A RESOLUTION OF THE BOARD OF COUNTY COMMISSIONERS OF ST. JOHNS COUNTY, FLORIDA, APPROVING TRANSFER OF CERTAIN COUNTY OWNED RIGHT-OF-WAYS TO THE STATE OF FLORIDA DEPARTMENT OF TRANSPORTATION FOR THE IMPROVEMENTS TO STATE ROAD NO. 207.

WHEREAS, the State of Florida Department of Transportation proposes to construct and improve State Road No. 207, Section No. 78050-2531, in St. Johns County, Florida; and

WHEREAS, it is necessary that portions of County owned rights-of-way, as described in the County Deed attached hereto as Exhibit "A" incorporated by reference and made a part hereof; and

WHEREAS, said property is not needed for County purposes; and

WHEREAS, the State of Florida Department of Transportation has made an application to St. Johns County to execute and deliver to the State of Florida Department of Transportation a County Deed in favor of the State of Florida Department of Transportation, conveying all rights, title and interest that said County has in and to the said lands required for transportation purposes.

NOW, THEREFORE BE IT RESOLVED BY THE BOARD OF COUNTY COMMISSIONERS OF ST. JOHNS COUNTY, FLORIDA, as follows:

Section 1. The application of the State of Florida Department of Transportation for this conveyance is for transportation purposes, which are in the public or community interest and for public welfare. The Subject Property is not needed for County purposes.

Section 2. The County Deed, attached herein as Exhibit "A", in favor of the State of Florida Department of Transportation conveys all rights, title and interest of St. Johns County, without warranty of title or warranty of method of conveyance, in and to the land described thereon for transportation and other road purposes, shall be executed by the Chairman of the Board of County Commissioners. Consideration shall be \$10.00.

Section 3. A certified copy of this Resolution shall be forwarded forthwith to the State of Florida Department of Transportation, Post Office Box 1089, Lake City, Florida 32056-1089

Section 4. The County Deed transferring the property to the State of Florida Department of Transportation shall be duly recorded in the Official Records of St. Johns County, Florida.

PASSED AND ADOPTED, this 15th day of May, 2001.

**BOARD OF COUNTY COMMISSIONERS
ST. JOHNS COUNTY, FLORIDA.**

By: Mary F. Kohnke
Mary F. Kohnke, Chairman

ATTEST: Cheryl Strickland, Clerk

Patricia DeGrande
Deputy Clerk

COUNTY DEED

THIS DEED, made without warranty of title or warranty of method of conveyance, this 17th day of May, 2001, by **ST. JOHNS COUNTY, FLORIDA**, a political subdivision of the State of Florida, County Administration Building, 4020 Lewis Speedway, St. Augustine, Florida, 32095, Grantor; to **FLORIDA DEPARTMENT OF TRANSPORTATION**, whose address is Post Office Box 6669 M.S. 2814 Jacksonville, Florida. 32236-6669. Grantee: (Wherever used herein the terms Grantor and Grantee include all the parties to this instrument and the heirs, legal representatives and assigns of individuals, and the successors, and assigns of organizations).

WITNESSETH:

That the Grantor, for and in consideration of the sum of \$10.00 and other good and valuable considerations, receipt and sufficiency being hereby acknowledged, hereby grants, bargains, sells, forever unto said Grantees, all that certain land situate, lying and being in the County of St. Johns, State of Florida and more particularly described in Exhibit "A" attached hereto and made a part hereof. Pursuant to Florida law Section 125.411(3) F.S., this deed conveys only the interest in said land the Grantor has as of the date of conveyance.

TOGETHER with all tenements, hereditaments and appurtenances thereto belonging or in anywise appertaining.

THIS COUNTY DEED is subject to the following non-exclusive list of exceptions:

- a. Special taxes and assessments, confirmed or unconfirmed, for improvements not yet completed, if any;
- b. Any state of facts which a good and accurate survey or inspection of the premises might reveal;
- c. Federal, State, local government (County and City), development, construction, zoning and building laws or ordinances, rules, regulations and resolutions;
- d. Rights, if any, of the public in any portion of the premises which may fall within any public street, way or alley;
- e. All acts of the Grantee occurring prior to, or subsequent to, the date of this instrument;
- f. Agreements, conditions, covenants, reservations, restrictions, and servitude of record;

IN WITNESS WHEREOF the said Grantor has caused these presents to be executed in its name by its Board of County Commissioners acting by the Chairman of said Board, the day and year aforesaid.

**BOARD OF COUNTY COMMISSIONERS
ST. JOHNS COUNTY, FLORIDA**

By: Mary F. Kohnke
Mary F. Kohnke, Chairman

ATTEST: CHERYL STRICKLAND, CLERK

By: Cheryl Strickland
Deputy Clerk

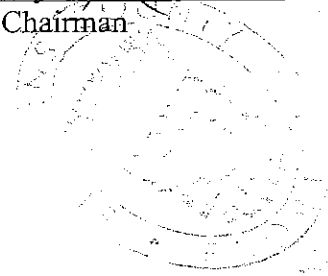

**STATE OF FLORIDA
COUNTY OF ST. JOHNS**

The foregoing instrument was acknowledged before me this 17th day of May, 2001, by Mary F. Kohnke, Chairman, who is personally known to me, or who has produced _____ as identification.

Patricia De Grande
Notary Public in and for the County and
State of Florida
Commission expires: 01-26-04

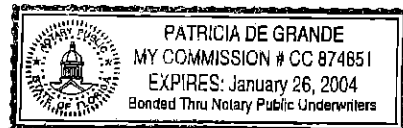
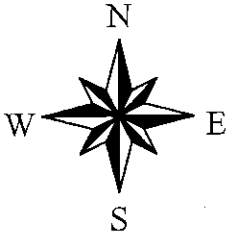

Exhibit "A" to County Deed

Part "A"

A part of Section 17, Township 8 South, Range 29 East, of St. Johns County, Florida, Being described as follows:

Commence at the intersection of the existing Southerly Right of Way line of Seventh Street, (a 12.192 meter (40.00 foot) Right of Way per plat of VERMONT HEIGHTS, as recorded in Map Book 5, Page 29, of the current public records of said county), with the existing Easterly Right of Way line of an un-named street, (a 17.069 meter (56.00 foot) Right of Way as shown on the Florida Department of Transportation Right of Way Map Section 78050-2531); Thence South $00^{\circ}26'48''$ East, along said existing Easterly Right of Way line, a distance of 51.333 meters (168.42 feet) to the Point of Beginning; Thence continue South $00^{\circ}26'48''$ East, along said existing Easterly Right of Way line, a distance of 12.247 meters (40.18 feet) to an intersection with the existing Northerly Right of Way line of State Road 207, (a 30.480 meter (100.00 foot) Right of Way as shown on the Florida Department of Transportation Right of Way Map Section 78050-2531); Thence South $62^{\circ}38'19''$ West, along said existing Northerly Right of Way line of State Road 207, a distance of 19.142 meters (62.80 feet) to an intersection with the existing Westerly Right of Way line of said un-named street;



Vermont Heights Subdivision

Subject Property:
Part A

State Road 207



FDOT Request: 40.18' X 62.80'
Part A of Unnamed Street
Section 17, Twnshp 8, South Rng 29 East
as recorded in Map Book 5, Page 29

- Par_0829.shp
- Section-Township-RangePlss.shp
- Hydro_min.shp
- Hydro_maj.shp
- County.shp



PREPARED BY:
ST. JOHNS COUNTY
REAL ESTATE DIVISION

© 2004 MERRILL Data provided herein are from multiple sources with varying degrees of accuracy. This map therefore should be used for estimate purposes only. The St. Johns Real Estate Division disclaims all responsibility for the accuracy or completeness of the data shown.

Part "B"

Exhibit "A" to County Deed

A part of Section 17, Township 8 South, Range 29 East, of St. Johns County, Florida, Being described as follows:

Commence at the intersection of the existing Southerly Right of Way line of Seventh Street, (a 12.192 meter (40.00 foot) Right of Way per plat of VERMONT HEIGHTS, as recorded in Map Book 5, Page 29, of the current public records of said county), with the existing Westerly Right of Way line of Rhode Island Avenue, (a 12.192 meter (40.00 foot) Right of Way per said plat of VERMONT HEIGHTS); Thence South 27°21'41" East, along said existing Westerly Right of Way line of Rhode Island Avenue, a distance of 45.773 meters (150.17 feet) to the Point of Beginning; Thence continue South 27°21'41" East, along said existing Westerly Right of Way line of Rhode Island Avenue, a distance of 10.920 meters (35.83 feet) to an intersection with the existing Northerly Right of Way line of State Road 207, (a 30.480 meter (100.00 foot) Right of Way as shown on the Florida Department of Transportation Right of Way Map Section 78050-2531); Thence North 62°38'19" East, along said existing Northerly Right of Way line of State Road 207, a distance of 12.192 meters (40.00 feet) to an intersection with the existing Easterly Right of Way line of said Rhode Island Avenue; Thence North 27°21'41" West, along said existing Easterly Right of Way line of Rhode Island Avenue, a distance of 10.920 meters (35.83 feet); Thence South 62°38'19" West, a distance of 12.192 meters (40.00 feet) to the Point of Beginning.

Containing 133.1 square meters (1,433 square feet), more or less.

Vermont Heights Subdivision

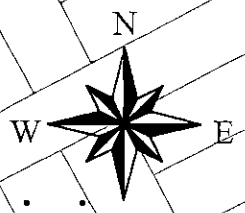

Rhode Island Ave.

Subject Property

State Road 207

200 0 200 400 Feet

FDOT Request: 40.0' X 35.83'
Part B: Rhode Island Ave and SR 207
Section 17, Township 8 South, Range 29 East
as recorded in Map Book 5, Page 29

- Par_0829.shp
- Section-Township-RangePlss.shp
- Hydro_min.shp
- Hydro_maj.shp
- County.shp

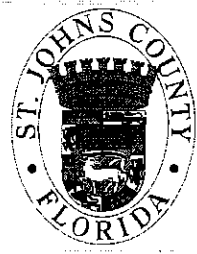

PREPARED BY:
ST. JOHNS COUNTY
REAL ESTATE DIVISION

DISCLAIMER: Data provided herein is from multiple sources with varying degrees of accuracy. This map is for informational purposes only. The St. Johns County Real Estate Division disclaims all responsibility for the accuracy or completeness of the data shown.

Exhibit "A" to County Deed

Part "C"

A part of Section 17, Township 8 South, Range 29 East, of St. Johns County, Florida, Being described as follows:

Commence at the intersection of the existing Southerly Right of Way line of Seventh Street, (a 12.192 meter (40.00 foot) Right of Way per plat of VERMONT HEIGHTS, as recorded in Map Book 5, Page 29, of the current public records of said county), with the existing Westerly Right of Way line of Vermont Boulevard, (a 24.384 meter (80.00 foot) Right of Way per said plat of VERMONT HEIGHTS); Thence South 27°21'41" East, along said existing Westerly Right of Way line of Vermont Boulevard, a distance of 45.733 meters (150.17 feet) to the Point of Beginning; Thence continue South 27°21'41" East, along said existing Westerly Right of Way line of Vermont Boulevard, a distance of 10.920 meters (35.83 feet) to an intersection with the existing Northerly Right of Way line of State Road 207, (a 30.480 meter (100.00 foot) Right of Way as shown on the Florida Department of Transportation Right of Map Section 78050-2531); Thence North 62°38'19" East, along said existing Northerly Right of Way line of State Road 207, a distance of 24.384 meters (80.00 feet) to an intersection with the existing Easterly Right of Way line of said Vermont Boulevard; Thence North 27°21'41" West, along said existing Easterly Right of Way line of Vermont Boulevard, a distance of 10.920 meters (35.83 feet); Thence South 62°38'19" West, a distance of 24.384 meters (80.00 feet) to the Point of Beginning.

Containing 266.3 square meters (2,866 square feet), more or less.

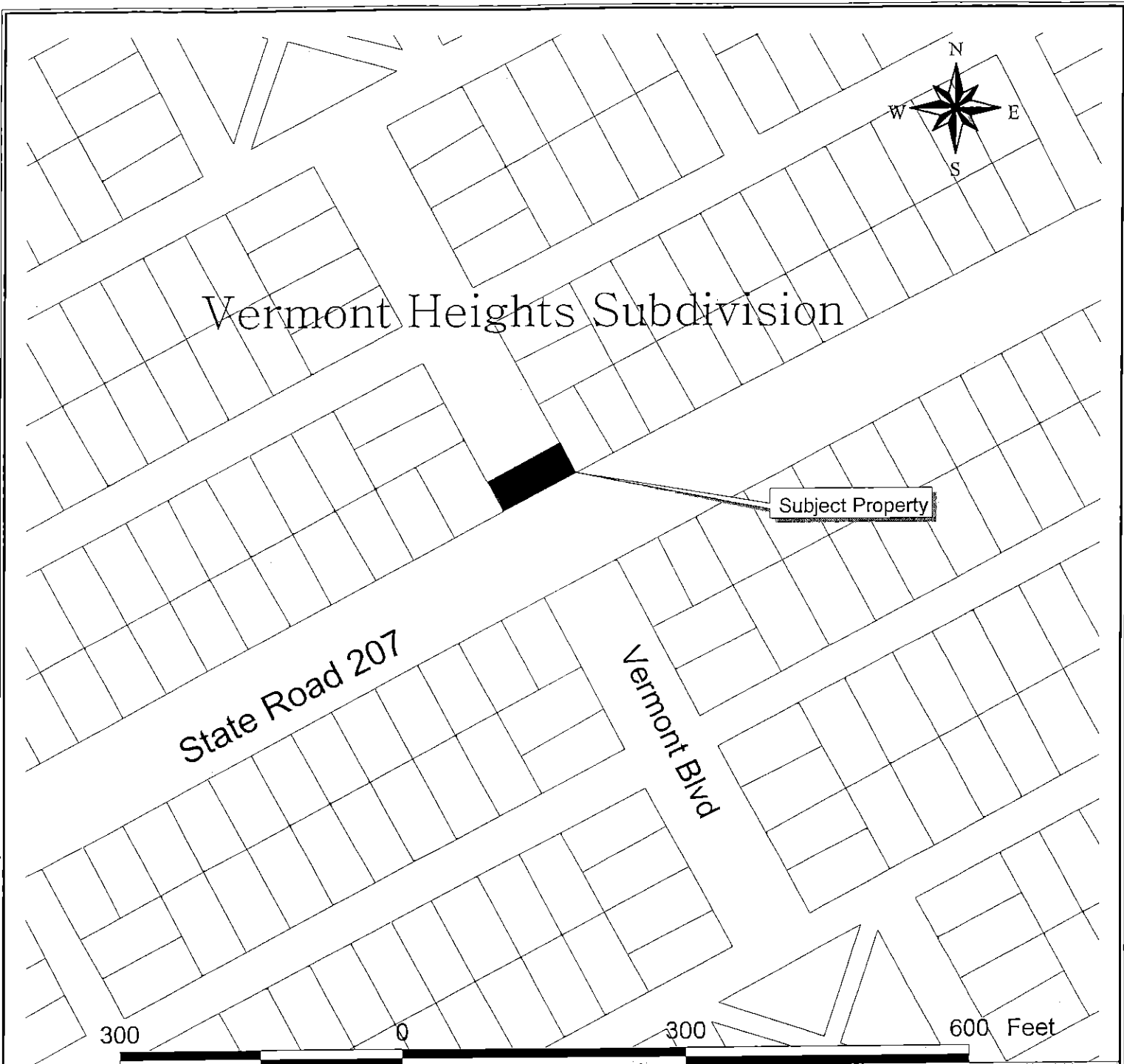

Vermont Heights Subdivision

Subject Property

State Road 207

Vermont Blvd

300 0 300 600 Feet

FDOT Request: 35.83 ft X 80.0 ft
Part C of intersection of SR 207 and Vermont Blvd
Section 17, Township 8, South, Range 29 East
as recorded in Map Book 5, Page 29

- Par_0829.shp
- Section-Township+Range Plus.shp
- Hydro_min.shp
- Hydro_max.shp
- County.shp

DISCLAIMER: Data provided here is from multiple sources with varying degrees of accuracy. This map is for informational purposes only. The St. Johns Real Estate Division disclaims all responsibility for the accuracy or completeness of the data shown.



PREPARED BY:
ST. JOHNS COUNTY
REAL ESTATE DIVISION

Exhibit "A" to County Deed

Part "D"

A part of Section 17, Township 8 South, Range 29 East, of St. Johns County, Florida, Being described as follows:

Commence at the intersection of the existing Southerly Right of Way line of Seventh Street, (a 12.192 meter (40.00 foot) Right of Way per plat of VERMONT HEIGHTS, as recorded in Map Book 5, Page 29, of the current public records of said county), with the existing Westerly Right of Way line of New Hampshire Avenue, (a 12.192 meter (40.00 foot) Right of Way per said plat of VERMONT HEIGHTS); Thence South 27°21'41" East, along said existing Westerly Right of Way line of New Hampshire Avenue, a distance of 40.573 meters (133.11 feet) to the Point of Beginning; Thence continue South 27°21'41" East, along said existing Westerly Right of Way line of New Hampshire Avenue, a distance of 16.120 meters (52.89 feet) to an intersection with the existing Northerly Right of Way line of State Road 207, (a 30.480 meter (100.00 foot) Right of Way as shown on the Florida Department of Transportation Right of Map Section 78050-2531); Thence North 62°38'19" East, along said existing Northerly Right of Way line of State Road 207, a distance of 12.192 meters (40.00 feet) to an intersection with the existing Easterly Right of Way line of said New Hampshire Avenue; Thence North 27°21'41" West, along said existing Easterly Right of Way line of New Hampshire Avenue, a distance of 16.120 meters (52.89 feet); Thence South 62°38'19" West, a distance of 12.192 meters (40.00 feet) to the Point of Beginning.

Containing 196.5 square meters (2,115 square feet), more or less.

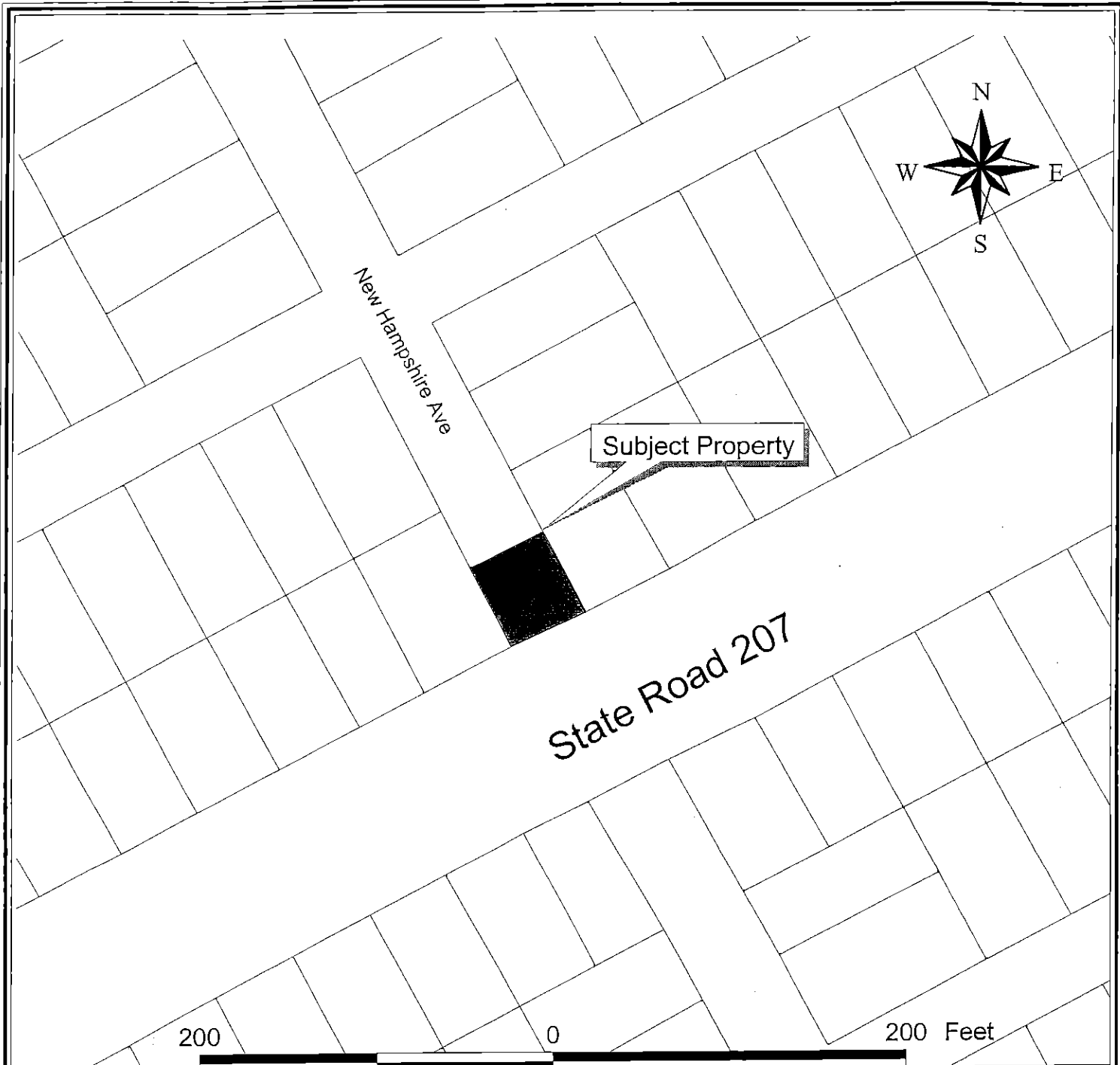

FDOT Request: 52.89' X 40.0'
Part D Intersection of New Hampshire and SR 207
Section 17, Twnshp 8 South, Range 29 East
as recorded in Map Book 5, Page 29

- Par_0829.shp
- Section-Township-RangePlus.shp
- Hydro_min.shp
- Hydro_maj.shp
- County.shp

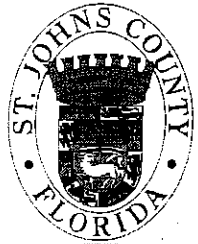

PREPARED BY:
ST. JOHNS COUNTY
 REAL ESTATE DIVISION

DISCLAIMER: Data provided herein is for informational purposes only. It is not intended to be used for any other purpose. The State of Florida Real Estate Division disclaims all responsibility for the accuracy or completeness of the data shown.

Exhibit "A" to County Deed

Part "E"

A part of Section 17, Township 8 South, Range 29 East, of St. Johns County, Florida, Being described as follows:

Commence at the intersection of the existing Southerly Right of Way line of Seventh Street, (a 12.192 meter (40.00 foot) Right of Way per plat of VERMONT HEIGHTS, as recorded in Map Book 5, Page 29, of the current public records of said county), with the existing Westerly Right of Way line of Maine Avenue, (a 12.192 meter (40.00 foot) Right of Way per said plat of VERMONT HEIGHTS); Thence South 27°21'41" East, along said existing Westerly Right of Way line of Maine Avenue, a distance of 41.201 meters (135.17 feet) to the Point of Beginning; Thence continue South 27°21'41" East, along said existing Westerly Right of Way line of Maine Avenue, a distance of 15.492 meters (50.83 feet) to an intersection with the existing Northerly Right of Way line of State Road 207, (a 30.480 meter (100.00 foot) Right of Way as shown on the Florida Department of Transportation Right of Way Map Section 78050-2531); Thence North 62°38'19" East, along said existing Northerly Right of Way line of State Road 207, a distance of 12.192 meters (40.00 feet) to an intersection with the existing Easterly Right of Way line of said Maine Avenue; Thence North 27°21'41" West, along said existing Easterly Right of Way line of Maine Avenue, a distance of 15.492 meters (50.83 feet); Thence South 62°38'19" West, a distance of 12.192 meters (40.00 feet) to the Point of Beginning.

Containing 188.9 square meters (2,033 square feet), more or less.

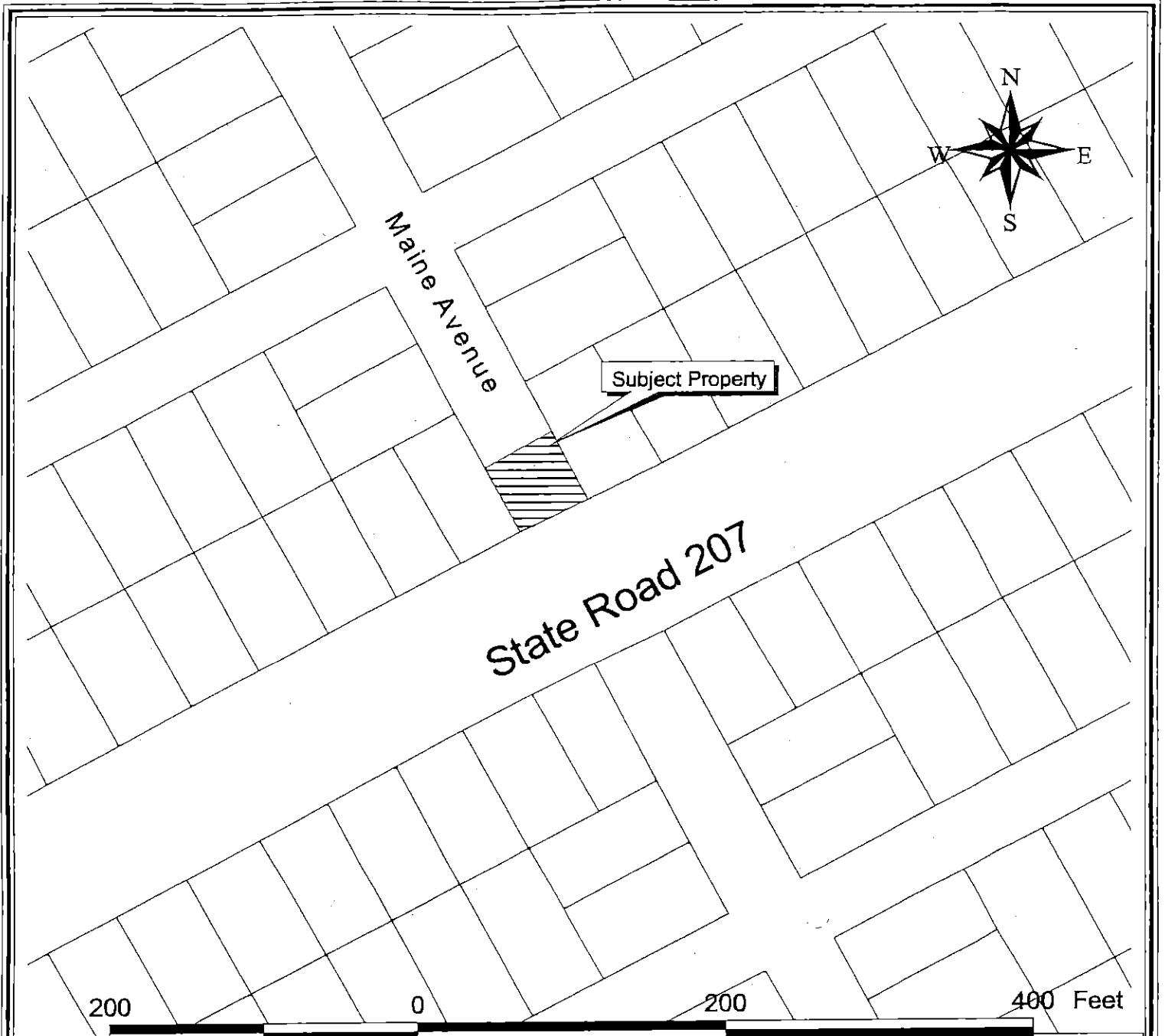

FDOT Request: 40.0' X 50.83'
Part E: intersection of Maine Ave and SR 207
Section 17, Twnshp 8 South, Range 29 East
as recorded in Map Book 5, Page 29

- Par_0829.shp
- Section-Township-RangePlus.shp
- Hydro_min.shp
- Hydro_maj.shp
- County.shp

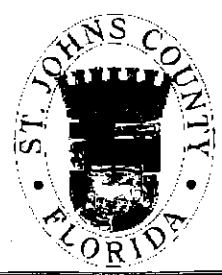

DISCLAIMER: Data provided herein are from multiple sources with varying degrees of accuracy. This map therefore should be used for general purposes only. The St. Johns Real Estate Division disclaims all responsibility for the accuracy or completeness of the data shown.

PREPARED BY:
ST. JOHNS COUNTY
 REAL ESTATE DIVISION

Exhibit "A" to County Deed

Part "F"

A part of Section 17, Township 8 South, Range 29 East, of St. Johns County, Florida, Being described as follows:

Commence at the intersection of the existing Southerly Right of Way line of Seventh Street, (a 12.192 meter (40.00 foot) Right of Way per plat of VERMONT HEIGHTS, as recorded in Map Book 5, Page 29, of the current public records of said county), with the existing Westerly Right of Way line of an un-named street, (a 12.192 meter (40.00 foot) Right of Way as shown on the Florida Department of Transportation Right of Way Map Section 78050-2531); Thence South 00°28'48" West, along said existing Westerly Right of Way line, a distance of 51.765 meters (169.83 feet) to the Point of Beginning; Thence continue South 00°28'48" West, along said existing Westerly Right of Way line, a distance of 12.350 meters (40.52 feet) to an intersection with the existing Northerly Right of Way line of State Road 207, (a 30.480 meter (100.00 foot) Right of Way as shown on the Florida Department of Transportation Right of Way Map Section 78050-2531); Thence North 62°38'19" East, along said existing Northerly Right of Way line of State Road 207, a distance of 13.788 meters (45.24 feet) to an intersection with the existing Easterly Right of Way line of said un-named street; Thence North 00°28'48" East, along last said existing Easterly Right of Way line, a distance of 12.350 meters (40.52 feet); Thence South 62°38'19" West, a distance of 13.788 meters (45.24 feet) to the Point of Beginning.

Containing 150.6 square meters (1,621 square feet), more or less.

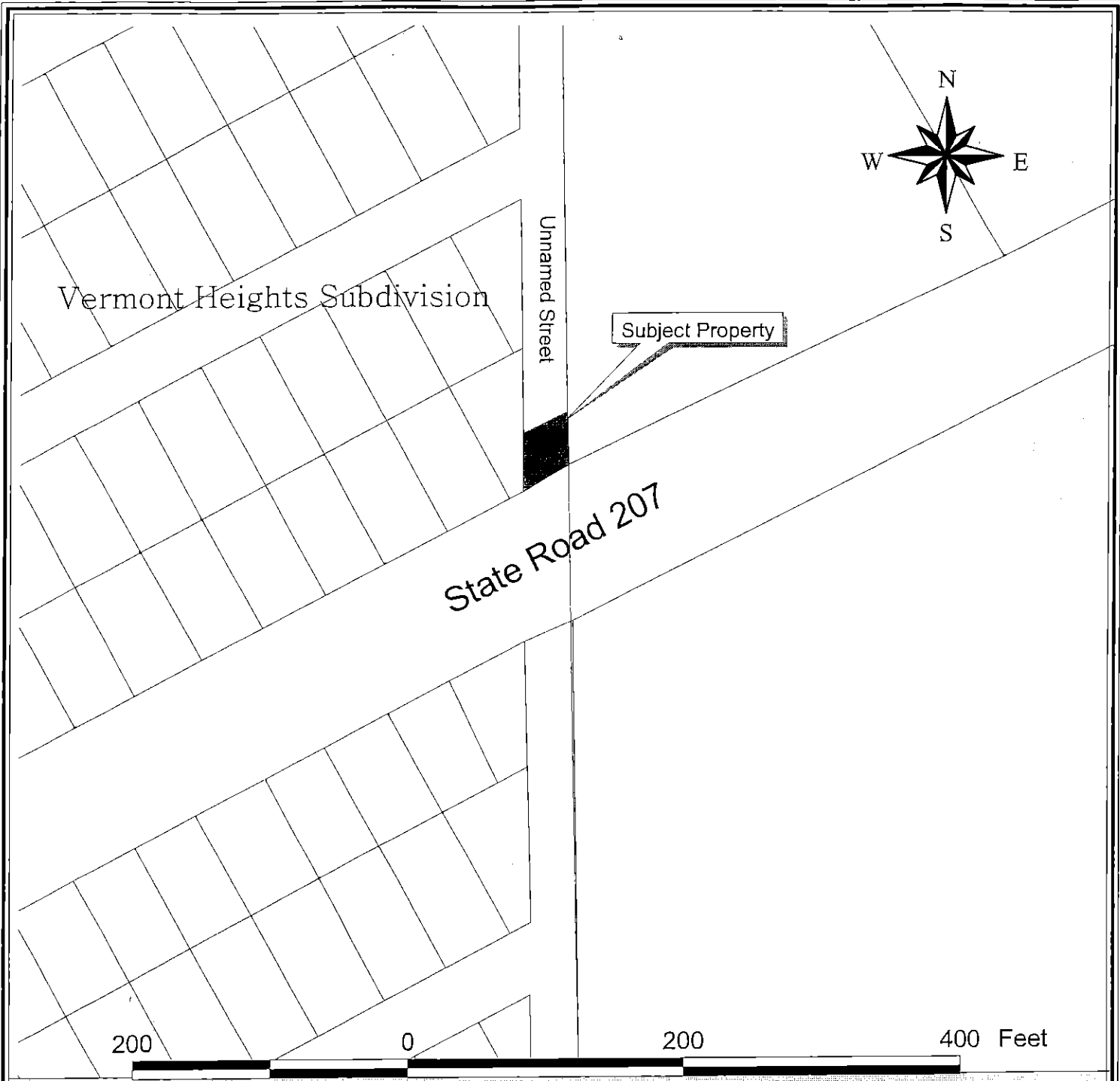

FDOT Request: 45.24' X 40.52'
Part F of SR 207 and Unnamed Street
Section 17, Township 8 South, Range 29 East
as recorded in Map Book 5, Page 29

- Par_0829.shp
- Section-Township-RangePlss.shp
- Hydro_min.shp
- Hydro_maj.shp
- County.shp

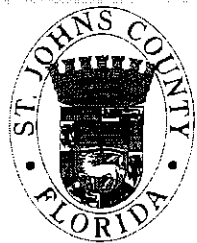

DISCLAIMER: Data provided herein are from multiple sources with varying degrees of accuracy. This map therefore should be used for informational purposes only. The St. Johns County Real Estate Division disclaims all responsibility for the accuracy or completeness of the data shown.

PREPARED BY:
ST. JOHNS COUNTY
 REAL ESTATE DIVISION