

RESOLUTION NO. 2003- 03
RESOLUTION OF THE BOARD OF COUNTY
COMMISSIONERS OF ST. JOHNS COUNTY, FLORIDA
APPROVING A SUBDIVISION PLAT FOR
JULINGTON CREEK PLANTATION PARCEL 81 PHASE 2

WHEREAS, JULINGTON CREEK VENTURES, LLP, a LIMITED LIABILITY PARTNERSHIP, have applied to the Board of County Commissioners of St. Johns County, Florida for approval to record a subdivision plat known as Julington Creek Plantation Parcel 81 Phase 2.

NOW, THEREFORE BE IT RESOLVED BY THE BOARD OF COUNTY COMMISSIONERS OF ST. JOHNS COUNTY, FLORIDA, as follows:

Section 1. The above-described subdivision plat and its dedicated areas depicted thereon are conditionally approved and accepted by the Board of County Commissioners of St. Johns County, Florida subject to Sections 2, 3, 4, and 5.

Section 2. A Construction Band has been filed with the Clerk of Courts in the amount of \$184,736.78.

Section 3. A Maintenance Bond in the amount of \$71,443.78 will be required. The maintenance bond language will be that required by the ordinance in effect at the time the maintenance bond is provided.

Section 4. The approval and acceptance described in Section 1 shall not take effect until the Clerk has received a title opinion, certificate, or policy pertaining to the real property that is the subject of the aforementioned subdivision plat which opinion, certificate or policy is in a form acceptable to the County Attorney or Assistant County Attorney.

Section 5. The approval and acceptance described in Section 1 shall not take effect until the plat has been signed by each of the following departments, person or offices:

- a) Chairman or Vice-Chairman of the Board of County Commissioners of St. Johns County, Florida;
- b) Office of the County Attorney;
- c) County Planning and Zoning Department;
- d) Office of the County Surveyor; and
- e) Clerk of Courts.

The Clerk shall not sign or accept the Plat for recording until it has been signed by each of the above persons or entities described in a) through d) above. If the plat is not signed and accepted by the Clerk for recording within 14 days from the date hereof, then the above-described conditional approval shall automatically terminate. If the plat is signed by the Clerk on or before such time, the conditions described herein shall be deemed to have been met.

ADOPTED by the Board of County Commissioners of St. Johns County, Florida, this 7th day of January, 2003.

BOARD OF COUNTY COMMISSIONERS
OF ST. JOHNS COUNTY, FLORIDA

BY: James E. Bryant
James E. Bryant, Its Chair

ATTEST: Cheryl Strickland

Patricia A. Strickland
Deputy Clerk

RENDITION DATE 01-09-03

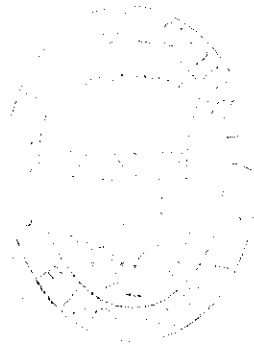

JULINGTON CREEK PLANTATION PARCEL 81 PHASE 2

BEING A PORTION OF LANDS LYING PARTLY IN SECTIONS 28 AND PARTLY IN THE JAMES JAMES DONATION, SECTION 49, TOWNSHIP 4 SOUTH, RANGE 27 EAST, ST. JOHNS COUNTY, FLORIDA.

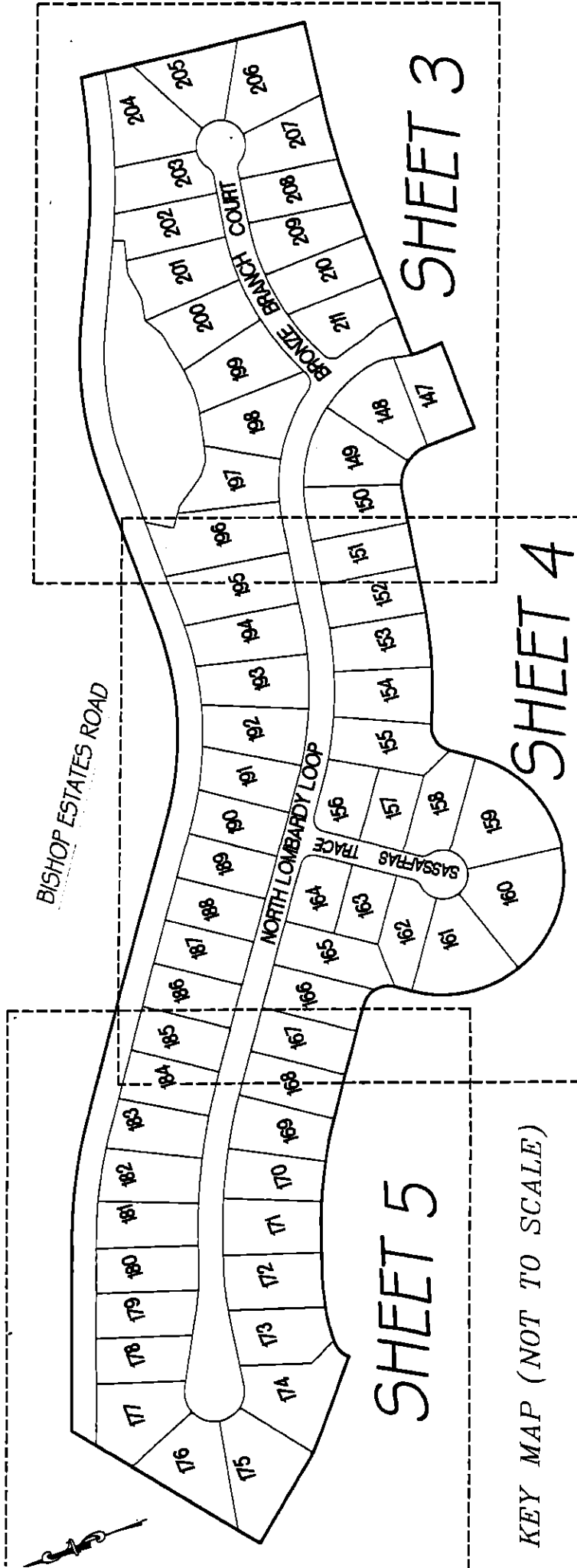

KEY MAP (NOT TO SCALE)

GENERAL NOTES:

- 1) BEARINGS SHOWN HEREON REFER TO N62°00'00"W FOR THE N'LY LINE

LEGEND:

- PC-POINT OF CURVATURE
- PT-POINT OF TANGENCY
- A OR B-CHORDAL ANGLE
- R-W-RADIUS OF CURVATURE
- L-LENGTH OF TANGENT
- L-W-LENGTH OF CHORD