

RESOLUTION NO. 2010- 11

**A RESOLUTION BY THE BOARD OF COUNTY COMMISSIONERS OF ST. JOHNS COUNTY, FLORIDA, APPROVING AND AUTHORIZING THE TRANSFER OF FUNDING FROM THE TREE BANK FUND RESERVES TO FUND ST. JOHNS COUNTY COMPLEX LOW IMPACT DEVELOPMENT POND DEMONSTRATION PROJECT PERTAINING TO THE DEVELOPMENT OF CONSTRUCTION PLANS, CONSTRUCTION ACTIVITIES AND MAINTENANCE DURING THE ESTABLISHMENT PERIOD; AUTHORIZING THE COUNTY ADMINISTRATOR, OR DESIGNEE, TO EXECUTE ANY DOCUMENTS ASSOCIATED WITH THE DEMONSTRATION PROJECT; PROVIDING AN EFFECTIVE DATE**

**WHEREAS**, the transfer of \$15,000 dollars from the Tree Bank Fund Reserves for use in developing and installing Florida Friendly, low maintenance landscaping around the existing San Sebastian View stormwater pond at the St. Johns County Judicial Center Complex is desired; and

**WHEREAS**, the proposed project will highlight Low Impact Development and Florida Friendly Landscaping Principles and will provide a highly visible educational product for the community; and

**WHEREAS**, the proposed project will enhance stormwater water quality, provide additional wildlife habitat, promote water conservation and minimize current landscape maintenance demands at the St. Johns County Administration Complex; and

**WHEREAS**, the COUNTY has reviewed the estimated costs for design, construction and establishment, and has determined that the funding requested is sufficient to accomplish this task; and

**WHEREAS**, the transfer of Tree Bank Fund Reserves is for a project that is consistent and in accordance with the guidelines and provisions noted in the applicable provision of the Tree Bank Ordinance 2009-2; and

**WHEREAS**, engaging in the project is in the best interests of the County.

**NOW, THEREFORE, BE IT RESOLVED BY THE BOARD OF COUNTY COMMISSIONERS OF ST. JOHNS COUNTY, FLORIDA, AS FOLLOWS:**

**Section 1.** The above recitals are hereby incorporated into the body of this Resolution, and are adopted as Findings of Fact.

**Section 2.** The Board of County Commissioners authorizes the County Administrator, or designee, to execute any other paperwork associated with, or necessary to accomplish, the overall goal set forth as part of the subject project.

**Section 3.** The Board approves the transfer of the Tree Bank Fund Reserves, and authorizes its expenditure for the desired objective.

**Section 4.** To the extent that there are typographical or administrative errors that do not change the tenor, or concept of this Resolution, then this Resolution may be revised without subsequent approval of the Board of County Commissioners.

**Section 5.** This Resolution shall become effective immediately upon its adoption.

**PASSED AND ADOPTED** by the Board of County Commissioners of St. Johns County, Florida, this 19<sup>th</sup> day of January 2010.

**BOARD OF COUNTY COMMISSIONERS OF  
ST. JOHNS COUNTY, FLORIDA**

**ATTEST:**

*Clerk*  
Clerk

By: Pam Halterman  
Deputy Clerk

**BY:**

Ron Sanchez  
Ron Sanchez--Chair

RENDITION DATE 1/20/10



- JK Juvenile trees/vegetation
- CL Clearing, landscape
- CS Structure and/or plantings
- SC Structure and/or plantings
- CC Copied content
- MS Detail/sprinklers
- ES Erosion
- BA Backhoe/bulkhead
- SA Salsola americana
- EP Eriogonum fasciculatum
- MC Myrica caroliniana
- SC Scirpus americanus
- HD Helianthus divaricatus
- UP Urtica dioica
- CA Callitriche americana
- SP Spent attention

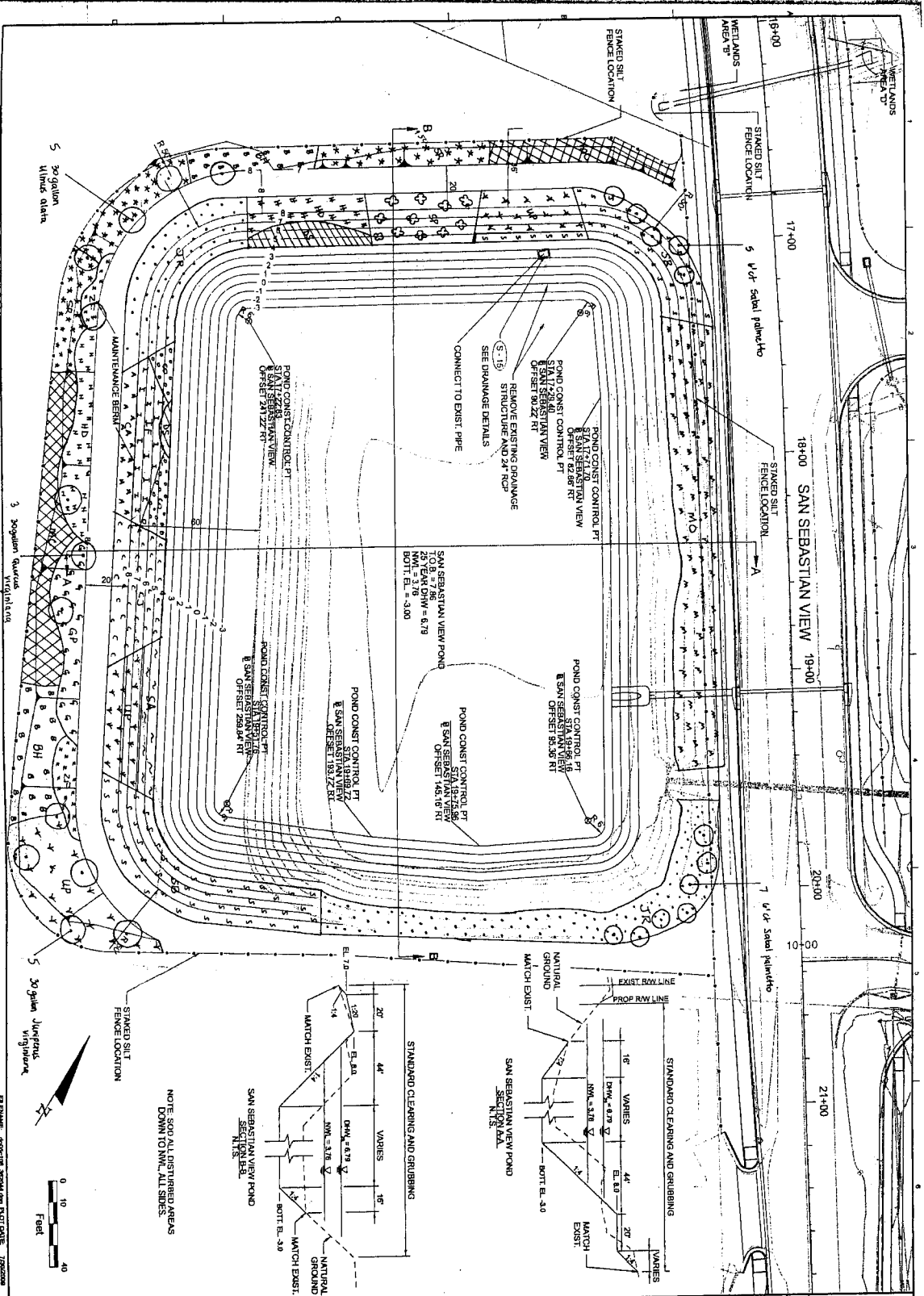

**CH2MHILL**

CIVIL  
**SAN SEBASTIAN VIEW POND PLAN SHEET**

8432 BAYMEADOWS RD. SUITE 300  
DADE COUNTY, FL 33148  
CERTIFICATE OF AUTHORIZATION NO. 000072  
CHRIS J. BURAN P.E. NO. 47087

ST. JOHNS COUNTY  
ST. JOHNS COUNTY, FLORIDA  
SAN SEBASTIAN VIEW / LEWIS SPEEDWAY

NO.	DATE	DESCRIPTION	APVR	N
NO.	DATE	REVISION	BY	APVD
DEGN	DR	CHK	APVD	

DATE: MAY 2008  
PROJECT: 20044  
SHEET: 18

SCALE: 1" = 40'

PROJECT: SAN SEBASTIAN VIEW POND DATE: 7/20/08

10% SUBMITTAL - MAY 2008

STATE OF FLORIDA: THIS DOCUMENT AND THE DESIGN AND DESIGN INFORMATION INCORPORATED HEREIN, AS AN INSTRUMENT OF PROFESSIONAL SERVICE, IS THE PROPERTY OF CH2M HILL AND IS NOT TO BE USED, IN WHOLE OR IN PART, FOR ANY OTHER PROJECT WITHOUT THE WRITTEN AUTHORIZATION OF CH2M HILL.