

RESOLUTION NO. 2011- 202

A RESOLUTION BY THE BOARD OF COUNTY COMMISSIONERS OF ST. JOHNS COUNTY, FLORIDA, APPROVING THE TERMS AND AUTHORIZING THE COUNTY ADMINISTRATOR, OR DESIGNEE, TO SUBMIT A LONG RANGE BEACH EROSION CONTROL BUDGET PLAN WITH THE DEPARTMENT OF ENVIRONMENTAL PROTECTION, BUREAU OF BEACHES AND COASTAL SYSTEMS.

WHEREAS, St. Johns County is currently working with the Army Corps of Engineers and FDEP on the St. Augustine Beach erosion control monitoring and maintenance of the constructed project and design of the next nourishment for the portion of beaches between ACOE markers R-137 and R-151; and,

WHEREAS, the Army Corps of Engineers (ACOE) is expected to appropriate funds for this project in the next fiscal year; and,

WHEREAS, St Johns County also anticipates sharing costs with the State of Florida under a State DEP Beaches and Coastal Systems grant; and,

WHEREAS, the State Department of Environmental Protection has begun a new grant cycle which will require submitting an annual application along with a ten-year budget plan; and,

WHEREAS, St. Johns County will continue to provide local cost share funding from the Category III Tourist Development Tax Budget, and

WHEREAS, St. Johns County will continue to serve as the local sponsor; and,

WHEREAS, the Florida Department of Environmental Protection Bureau of Beaches and Coastal Systems requires an annual contract for its local share, contingent upon annual appropriations by the legislature.

NOW, THEREFORE, BE IT RESOLVED BY THE BOARD OF COUNTY COMMISSIONERS OF ST. JOHNS COUNTY, FLORIDA, AS FOLLOWS:

Section (1). The above Recitals are incorporated by reference into the body of this Resolution and such Recitals are adopted as findings of fact.

Section (2). That a suggested 10-year budget plan for funding the State's portion of a beach nourishment project for the St. Augustine Beaches project be filed with the Florida Department of Environmental Protection, Bureau of Beaches and Coastal Systems (the "Department"), and

Section (3). That the County Administrator, or designee, is hereby authorized to submit a proposed 10-year State budget plan to the Department and to execute any necessary agreements concerning the beach projects with the Department; and,

Section (4). That the County Administrator's, or designee's, submission of any budget plan is subject to, and contingent upon, an annual budget appropriation by the Board of County Commissioners.

Section (5). To the extent that there are typographical and/or administrative errors and/or omissions that do not change the tone, tenor, or content of this Resolution, then this Resolution may be revised without subsequent approval of the Board of County Commissioners.

PASSED AND ADOPTED by the Board of County Commissioners of St. Johns County, State of Florida, this 19th day of July, 2011.

**BOARD OF COUNTY COMMISSIONERS OF
ST. JOHNS COUNTY, FLORIDA**

By: 
J. Ken Bryan -- Chair

ATTEST: Cheryl Strickland, Clerk

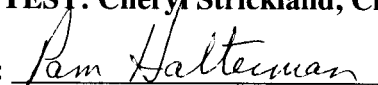
By: 
Deputy Clerk

RENDITION DATE 7/21/11



FY 2012-13 Local Government Funding Request

Project Name (Same as previous phase): St. Johns County Shore Protection Program; St. Johns County R-137 through R-151

Project Description: (Should be consistent year to year with annual updates. Include county, location with reference to range monuments, brief project history and upcoming beach activities.) The project consists of a multi-year federal commitment to design, construct and monitor beach restoration of the severely eroded beaches of Anastasia State Park and St. Augustine Beach. The scope focuses on the FDEP-designated critical erosion areas between R137 and R151 at the center of the County and just South of the St Augustine Inlet. The project is part of 50 year commitment to the US Army Corps of Engineers to renourish this segment of Beach.

Use of Requested Program Funds: Funds requested for FY2012–13 will support the design and construction phase of the next nourishment cycle of the project. The budgets requested included the State share paid this year by the County and the budget request in front of the Federal House and Senate at this time.

Federal Funding: The USACE 1998 General Reevaluation Report (GRR) constitutes the authorization document for this project. The US congress and Senate granted \$7,000,000 to this project to fund Design and construction of the storm related damage caused by T.S. Faye during the FY 2009-2010 period. The US Congress and Senate secured an additional \$350,000 for construction during the FY 2010-2011 legislation. The US Presidents Budget has secured an additional \$6,350,000 in appropriations for the Shore Protection Project for FY2011.

Local Commitment: The county has executed a project cost sharing agreement with the USACE for the 50-year project life. St. Johns County has funded the USACE for the design of the 2010 re-nourishment effort based on the Federal Funding cost share and continues to retain the services of the coastal engineering firm Taylor Engineering, Inc. to assist in project management, tracking, monitoring, and assistance with design and permitting and other related future activities. St. Johns County is obtaining local funding for the project from the Tourist Development Council, which provides a dedicated and scheduled funding source. The county includes funds necessary to construct and maintain the project in the county's capital improvement plan.

On recent projects, St. Johns County government has exhibited its professional capabilities to administer large-scale beach nourishment and shore protection projects.

With this funding request, St. Johns County has included a proposed resolution that states its support of the proposed project, willingness to serve as the local sponsor, and ability to provide the local cost share. The St. Johns County BCC will consider this resolution in July 2011. St. Johns County will furnish a copy of the approved resolution to the FDEP.

State Commitment: The state appropriated \$75,600 for project monitoring, beach tilling, and scarp removal in FY 2008-2009 as its cost share on an anticipated \$116,084 local sponsor commitment. Continuation of this federal project relies on the annual commitment from the FDEP and St. Johns County (local sponsor). The FDEP recommends the project in its draft Strategic Beach Management Plan for St. Johns County beaches. In addition, the project areas lie within FDEP-designated critical erosion areas.

Local Government Support

Does this sponsor have dedicated support staff whose sole priority is to manage beach erosion control activities? No

Name	Title	Email	Percent Commitment
Address 1:		Phone:	
Address 2:		Fax:	

Quarterly Report Compliance:

2011-2012	End Date	Report Sent	Compliant
Qtr 1 (Sept)	9/30/2010	10/20/11	Yes
Qtr 2 (Dec)	12/31/2010	1/19/11	Yes
Qtr 3 (Mar)	4/30/2011	5/20/11	Yes
Qtr4 (June)	7/31/2011	Present Qtr.	N/A

How will revenue for the local funding cost share be established? The county has executed a project cost sharing agreement with the USACE for the 50-year project life. St. Johns County has funded the USACE for the design of the 2011 re-nourishment effort based on the Federal Funding cost share and continues to retain the services of the coastal engineering firm Taylor Engineering, Inc. to assist in project management, tracking, monitoring, and assistance with design and permitting and other related future activities. St. Johns County is obtaining local funding for the project from the Tourist Development Council, which provides a dedicated and scheduled funding source. The county includes funds necessary to construct and maintain the project in the county's capital improvement plan.

Is the funding from a dedicated long term source for this project? Yes
 St. Johns County is obtaining local funding for the project from the Tourist Development Council, which provides a dedicated and long-term funding source.

In order to acquire funding, a resolution from the local governmental entity must be provided by the application deadline which declares:

- **Support from the sponsor for the proposed project**
- **Willingness to serve as the local sponsor**
- **Ability to provide the full local cost share**
- **Funding source**

Has the local sponsor resolution been attached to the application fulfilling all of these requirements? Yes

Has the State cost-shared in a feasibility or design phase of this project? Yes
 The Department entered into a cost-share agreement for funding of this project in 1995. The project is recommended in the Strategic Beach Management Plan and located in an area that has been designated as critically eroded shoreline by the Department.

Previous State Cost Share Percentage: (Monitoring -- 25%)
 The current project construction is funded with 80.5% Federal; 11.8% County and 7.7% State.

10-Year Project Schedule and 5-Year Estimated Budget

Does this project have Congressional Authorization? Yes

Does this project have a Federal Project Cooperative Agreement? Yes

What is the end date of the Federal Authorization? N/A

What is the Federal cost share available for this erosion control project? 80.5%

Schedule and Budget (Include estimated phases for 10 years and estimated project costs for 5 years.): Use only tasks Feasibility, Design, Construction and Monitoring

Year	Proposed Method	Description	Total Estimated Cost	Federal Cost Share	State Cost Share	Local Cost Share
2011/2012	Construction	Nourishment	\$16,574,650	\$13,870,000	\$1,066,714	\$1,637,936
	Monitoring		\$155,000	\$0	\$62,000	\$93,000
2012/2013	Monitoring		\$155,000	\$0	\$62,000	\$93,000
2013/2014	Monitoring		\$155,000	\$0	\$62,000	\$93,000
2014/2015	Monitoring		\$155,000	\$0	\$62,000	\$93,000
2015/2016	Construction	Nourishment	\$1,885,000	\$1,517,425	\$145,000	\$222,575
2016/2017	Construction	Nourishment	\$16,730,000	\$14,000,000	\$1,076,712	\$1,653,288
2017/2018	Monitoring		\$155,000	\$0	\$62,000	\$93,000
2018/2019	Monitoring		\$155,000	\$0	\$62,000	\$93,000
2019/2020	Monitoring		\$155,000	\$0	\$62,000	\$93,000
2020/2021	Monitoring		\$155,000	\$0	\$62,000	\$93,000

Mapping- Maps are provided as attachments.

Maps should be to scale at a minimum of 1"=200'

Mapping elements include:

- Project Boundary with critically eroded shoreline.
- Range monuments.
- Beach access and parking- primary and secondary, including access widths.
- Public lodging establishments- locations and length of property boundaries along project Shoreline.
- Local Comprehensive Plan designations of commercial and recreational facilities and associated property boundaries along the project shoreline.

What is the length of the project boundary in feet? 15,170

What is the length of commercial or recreational property fronting the project shoreline? 7,214.1

What is the percentage of project shoreline designated as commercial or recreational property? 47.55%

Current contract eligibility or proposed new eligibility _____

Eligibility: Access Points and Public Lodging Establishments:

Location/Name	Address	R- Mon	Type of Access	Width of Access/ Frontage	Total units or parking spaces	Public Parking Spaces	Eligible shoreline (ft)
Anastasia State Park	E of Anastasia Park Rd A1A	R137- R141	Primary		350	350	2640
Pope Road		R141	Secondary			65	
St Augustine Beach Front Resort	300 A1A Beach Blvd	R141					
Pier Park		R142	Primary		170	170	2640
Hampton Inn	430 A1A Beach Blvd	R142					
16 th Street						16	
15 th Street						44	
14 th Street						12	
13 th Street						24	
12 th Street						13	
11 th Street						34	
10 th Street						24	
9 th Street						0	
8 th Street						18	
7 th Street						22	
6 th Street						5	
5th Street		R145- R146	Secondary		56	56	1320
4 th Street						0	
3 rd Street						40	

2 nd Street						4	
1 st Street						22	
A Street		R146	Secondary		22	22	1320
The Beachcomber	2 A Street						
B Street						4	
House of Sun & Sea	2 B Street						
C Street						8	
D Street		R147				10	
E Street						8	
F Street		R148	Secondary		10	10	1056
La Fiesta Oceanside Inn & Suite	810 A1A Beach Blvd	R148					
Holiday Inn	860 A1A Beach Blvd	R149					
Maratea Beach Access	900 A1A Beach Blvd	R150			4	4	211

Additional Ranking Criteria

Will this project enhance or increase the longevity of a previously constructed project? How?

Yes. This project has been designed to utilize frequent Renourishment cycles of sand every five years to re-establish the down drift beaches from prolonged erosion.

Will this project nourish a previously restored shoreline? YES

What is the Rate of Erosion as determined by the Bureau? (ft/yr) -11ft/yr

Severity of Erosion:

Significant

Project Benefits:

Significant benefit to the local economy and tourism industry along with the storm protection of critical infrastructure.

Use of Innovative Applications of Existing Technologies:

Nourishment Interval (years):

Project Performance: Five

Is this project being planned or constructed in cooperation with another local government? Explain. No

Local Government
Department
Address 1
Address 2

Resort Condominium Name: _____
Resort Address: _____
DBPR License Number: _____

The referenced motel has a total of _____ units, of which _____ units are available to the public on a rental basis. Therefore, a total of _____ percent of the motel is available on a rental basis.

Signed:
Title:

Date

The above information was verbally provided by _____ on _____ (date).

Local Government
Department
Address 1
Address 2

Resort Condominium Name: _____
Resort Address: _____
DBPR License Number: _____

The referenced resort condominium has a total of _____ units, of which _____ are available to the public on a rental basis. Therefore, a total of _____ percent of the condominium is available on a rental basis.

Signed:
Title:

Date

The above information was verbally provided by _____ on _____ (date).

**Lodgings and Connected Businesses
(Commercial)**

Licensee Name	Establishment	Address	License Type	License No	Exp. Date	LF Beach Front	No. of Rooms
Craven Properties Ltd	St Augustine Beach Front Resort	300 A1A Beach Blvd	Motel	MOT6500253	6/1/2011	476.7	142
	St Augustine Beach Front Resort		Permanent Food	SEA6500254	6/1/2011		
Arvin Enterprises Inc	Hampton Inn	430 A1A Beach Blvd	Motel	MOT6501360	6/1/2012	178.7	100
	Hampton Inn		Permanent Food Service	SEA6501361	6/1/2012		
St Augustine Resort Inc	Holiday Inn	860 A1A Beach Blvd	Hotel	HOT6500300	6/1/2012	202.8	153
	Beach Garden Restaurant		Permanent Food Service	SEA6500314	6/1/2012		
810 Beach Inc	Beachfront Bed & Breakfast	810 A1A Beach Blvd	Bed & Breakfast	BNB6500124	6/1/2011	199	8
	La Fiesta Oceanside Inn & Suite		Motel	MOT6500011	6/1/2011	199	45
	Beachfront Bed & Breakfast		Permanent Food Service	SEA6501386	6/1/2011		
	Fiesta Falls Mini Golf		Permanent Food Service	NOS6501693	6/1/2011		
	La Fiesta Oceanside Inn & Suite		Permanent Food Service	NOS6501697	6/1/2011		
Steder, Patricia Beatrice	House of Sea & Sun	2 B Street	Bed & Breakfast	BNB6501391	6/1/2012	90.2	6
Chatauqua Beach Comber Inc	The Beachcomber	2 A Street	Permanent Food Service	SEA6500513	6/1/2012	47.7	NA
			Retail Beverage	BEV6500363	9/30/2011		

1394.1 454

Total LF Total Rms

(Recreational)	
Site	Beach Frontage (LF)
Anastasia State Park	4670
County Pier	630
City of St Aug Beach REC	520

5820 LF - Recreational

1394.1 LF - Commercial

7214.1 LF - Commercial and Recreational

SAINT JOHNS COUNTY BEACH NOURISHMENT
Eligible Shoreline Determination

	Public Access	Orig. Contract Parking Spaces	Current Year Parking Spaces	Roadside (RS) Lot Parking (LP)	Primary Beach Access	Secondary Beach Access	Eligible Shore Length
1	Anastasia State Park	350	350	LP	Y		2,640'
2	Pope Road	62	55	LP			
3	Pier Park	170	170	LP	Y		2640'
4	16th Street	28	16	RS			
5	15th Street	44	44	LP/RS			
6	14th Street	0	12	RS			
7	13th Street	23	24	RS			
8	12th Street	20	13	RS			
9	11th Street	42	34	LP			
10	10th Street	11	24	LP			
11	9th Street	0	0				
12	8th Street	33	18	LP/RS			
13	7th Street	20	22	RS			
14	6th Street	12	5	RS			
15	5th Street	34	56	RS		Y	1,320'
16	4th Street	50	0				
17	3rd Street	0	40	LP			
18	2nd Street	20	4	RS			
19	1st Street	0	22	LP			
20	A Street	63	22	LP		Y	1,320'
21	B Street	4	4	RS			
22	C Street	0	8	RS			
23	D Street	16	10	LP			
24	E Street	14	8	RS			
25	F Street	0	10	LP		Y	1,056'
26	Maratea Walkover	0	4	RS		Y	422.4'

1. Project Boundary: 600 Feet North of R137A to 600 Feet South of R151
2. Approximate Shoreline Length: 15,170 feet.

* Primary beach access containing 100 parking spaces and public restrooms (Shoreline 2640' to either side of access point eligible).

** Secondary beach access includes parking within 1320' of access point and shoreline is eligible at 52.8 feet per parking space up to 1320' to either side of access point.

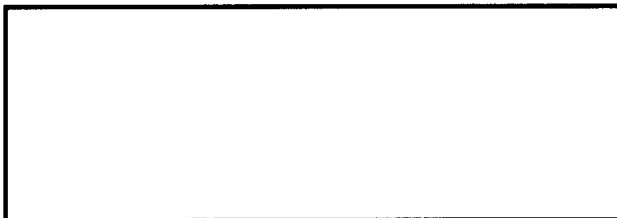

St. Johns County Beach Renourishment

St. Augustine Beach
Monuments
R 137 to R 151

- Legend**
- ▲ Ocean Monument
 - Beach Access Site
 - Beach Parking
 - 100' Ft. Distance From Beach
 - Flood 1 Month
 - Flood 3 Month
 - Flood 6 Month
 - Flood 9 Month
 - Flood 12 Month
 - Commercial
 - Recreational & Open Space
 - Multi-Family Residential
 - Single-Family Residential

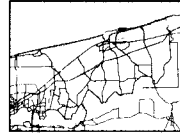

Project Location

Map Prepared: 07/2018

GIS
ST. JOHNS COUNTY
GEOGRAPHIC INFORMATION SYSTEMS

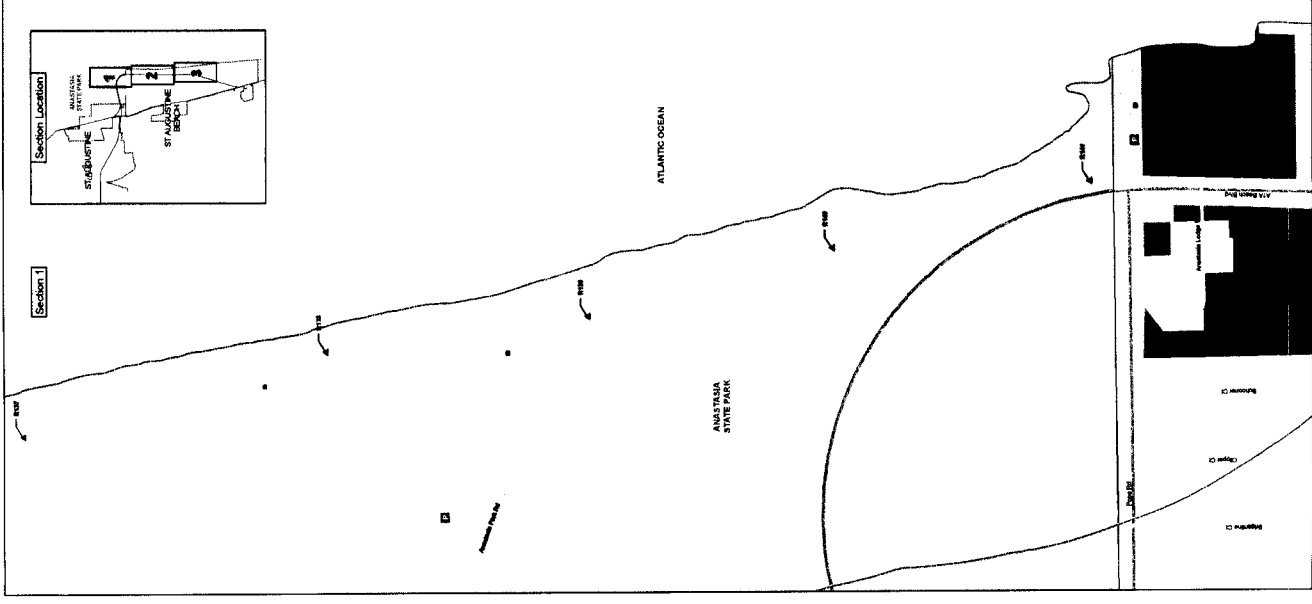
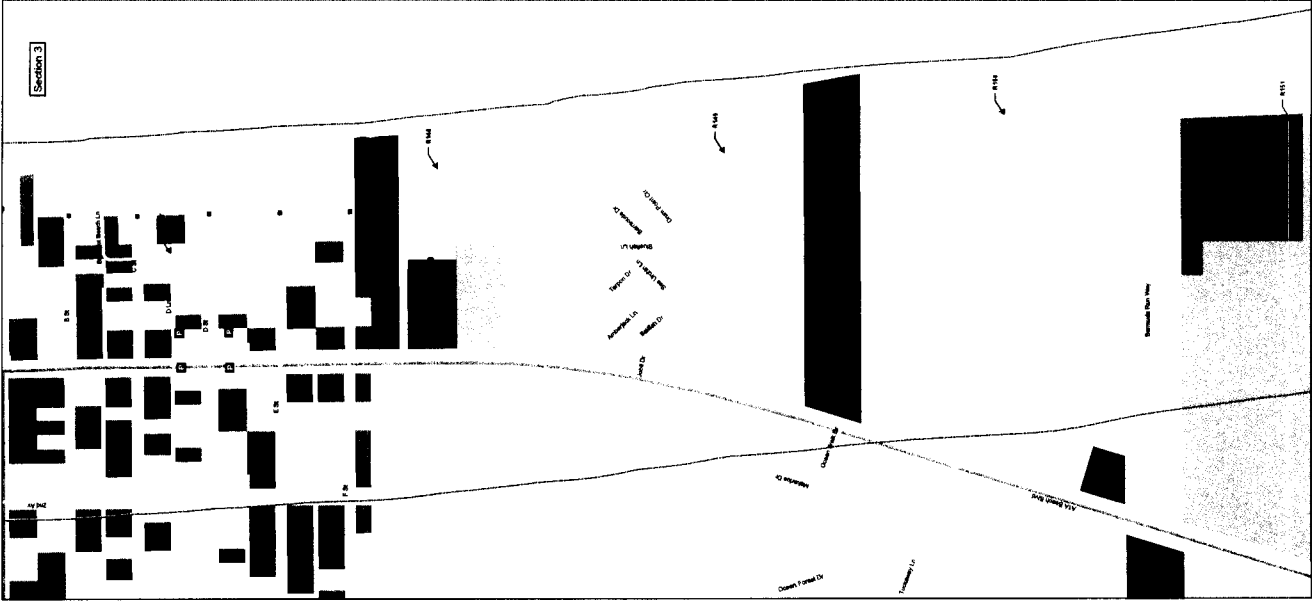



PREPARED BY
ST. JOHNS COUNTY
 GEOGRAPHIC INFORMATION SYSTEMS PROGRAM
 Map Printed: April 18, 2000



**ST. JOHNS COUNTY
 BEACH ACCESS (SOUTH)**

- TYPES OF ACCESS**
- PEDESTRIAN
 - VEHICLE
 - PARKS
 - STREET END
 - PARALLEL ROAD
 - UNDEVELOPED

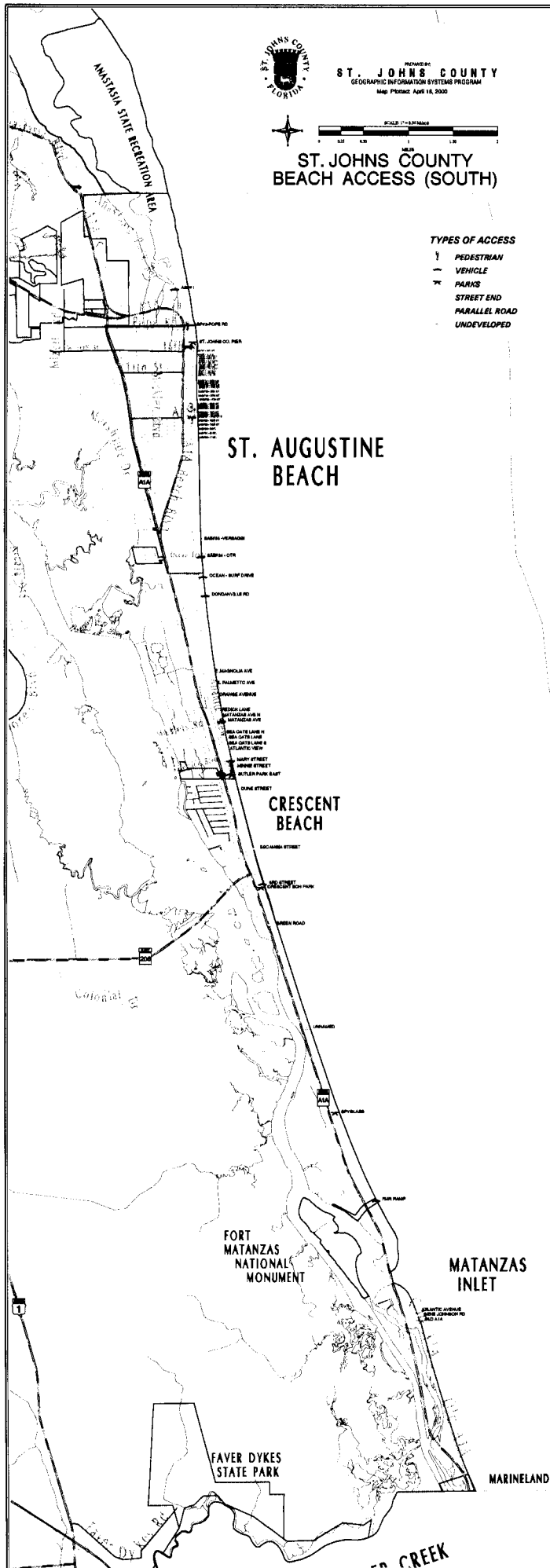

BEACH ACCESS POINTS

NUM	NAME	ADDRESS	TYPE	STATUS
108	ASP#1	E OF ANASTASIA PARK RD A1A	VEHICLE ACCESS	OPEN
109	ASP#2 POPE RD		PEDESTRIAN WALKOVER	OPEN
110	ST JEROME CO PIER		PUBLIC PARK	OPEN
111	SAB#1 16TH ST		STREET END	OPEN
112	SAB#2 15TH ST		STREET END	UNDEVELOPED
113	SAB#3 15TH ST S	430 A1A BEACH BLVD	STREET END	UNDEVELOPED
114	SAB#4 14TH ST	430 A1A BEACH BLVD	STREET END	UNDEVELOPED
115	SAB#5 14TH LANE		STREET END	UNDEVELOPED
116	SAB#6 13TH ST	BETWEEN 1 & 2 13TH ST	STREET END	UNDEVELOPED
117	SAB#7 13TH LANE		STREET END	UNDEVELOPED
118	SAB#8 12TH ST	BETWEEN 1 & 2	STREET END	UNDEVELOPED
119	SAB#9 12TH LANE	BETWEEN 1 & 2	STREET END	UNDEVELOPED
120	SAB#10 11TH ST	BETWEEN 1 & 2	STREET END WALKOVER	UNDEVELOPED
121	SAB#11 11TH LN	BETWEEN 1 & 2	STREET END	UNDEVELOPED
122	SAB#12 10TH ST	BETWEEN 1 & 2	STREET END	OPEN
123	SAB#13 9TH ST	BETWEEN 1 & 2	STREET END	UNDEVELOPED
124	SAB#14 9TH LN	BETWEEN 1 & 2	STREET END	UNDEVELOPED
125	SAB#15 8TH ST	BETWEEN 1 & 2	STREET END	UNDEVELOPED
126	SAB#16 8TH LN	BETWEEN 1 & 2	STREET END	UNDEVELOPED
127	SAB#17 7TH ST	BETWEEN 1 & 2	STREET END	UNDEVELOPED
128	SAB#18 6TH ST	BETWEEN 1 & 2	STREET END	UNDEVELOPED
129	SAB#19 5TH ST	BETWEEN 1 & 2	STREET END	UNDEVELOPED
130	SAB#20 4TH ST	BETWEEN 1 & 2	STREET END WALKOVER	OPEN
131	SAB#21 3RD ST	BETWEEN 1 & 2	STREET END FOOT PATH	OPEN
132	SAB#22 3RD LN	BETWEEN 1 & 2	PEDESTRIAN	UNDEVELOPED
133	SAB#23 2ND ST	BETWEEN 1 & 2	STREET END FOOT PATH	OPEN
134	SAB#24 1ST ST	BETWEEN 1 & 2	STREET END FOOT PATH	OPEN
135	SAB#25 1ST LN	BETWEEN 1 & 2	STREET END FOOT PATH	OPEN
136	SAB#26 "A" ST	BETWEEN 1 & 2	STREET END VEHICLE P	OPEN
137	SAB#27 "A" ST S		PEDESTRIAN	UNDEVELOPED
138	SAB#28 "B" ST	BETWEEN 1 & 2	STREET END FOOT PATH	OPEN
139	SAB#29 "C" ST	BETWEEN 1 & 2	STREET END FOOT PATH	OPEN
140	SAB#30 "D" ST	BETWEEN 1 & 2	STREET END FOOT PATH	OPEN
141	SAB#31 "E" ST	BETWEEN 1 & 2	STREET END FOOT PATH	OPEN
142	SAB#32 "F" ST	BETWEEN 1 & 2	STREET END WALKOVER	OPEN
143	SAB#33 VERNAGGI		STREET END FOOT PATH	OPEN
144	SAB#34 OTR		STREET END VEHICLE ACCESS	OPEN
145	OCEAN STRIP DRIVE		STREET END VEHICLE ACCESS	OPEN
146	DONOVANVILLE RD		STREET END VEHICLE ACCESS	OPEN
147	E MAGNOLIA AVE	BETWEEN 4698 & 5000 ATLANTIC	STREET END	OPEN
148	F PALMETTO AVE	BETWEEN 5096 & 7100 ATLANTIC	STREET END	OPEN
149	ORANGE AVENUE	S OF 5198 ATLANTIC VIEW	STREET END	OPEN
151	RIDER LANE	BETWEEN 5318 & 5330 ATLANTIC	STREET END	OPEN
152	MATANZAS AVEN	ACROSS FROM 5381	STREET END	OPEN
153	MATANZAS AVE		STREET END VEHICLE ACCESS	OPEN
154	SEA OATS LANE N	N OF 5480 ATLANTIC VIEW	STREET END	OPEN
155	SEA OATS LANE S	BETWEEN 5498 & 5500 ATLANTIC	STREET END	OPEN
156	SEA OATS LANE S	BETWEEN 5536 & 5548 ATLANTIC	STREET END	OPEN
157	ATLANTIC VIEW	BETWEEN 5578 & 5590 ATLANTIC	STREET END	OPEN
158	MARY STREET		STREET END VEHICLE ACCESS	OPEN
159	MARY STREET		PEDESTRIAN WALKOVER	OPEN
160	HUTLER PARK EAST		PUBLIC PARK	OPEN
161	DUNE STREET		STREET END	OPEN
162	ESCAMBIA STREET	S OF 10 DUNE STREET	STREET END	UNDEVELOPED
163	TRIST STREET		STREET END VEHICLE ACCESS	OPEN
164	CRESCENT BUSH PARK		PUBLIC PARK	OPEN
165	GREEN ROAD		STREET END WALKOVER	UNDEVELOPED
166	UNNAMED	S OF 7724 A1A SOUTH	UNDEVELOPED LOT	UNDEVELOPED
167	SPYGLASS	S OF 8200 A1A SOUTH	PUBLIC PARK	OPEN
168	EMER RAMP	8365 A1A SOUTH	PUBLIC PARK VEHICLE ACCESS	OPEN
169	ATLANTIC AVENUE		STREET END	OPEN
170	GENE JOHNSON RD		STREET END	OPEN
171	GRD A1A		PARALLEL ROAD	OPEN

