

RESOLUTION NO. 2019-13

A RESOLUTION BY THE BOARD OF COUNTY COMMISSIONERS OF ST. JOHNS COUNTY, FLORIDA, APPROVING THE TERMS, PROVISIONS, CONDITIONS, AND REQUIREMENTS OF AN AGREEMENT FOR TRAFFIC CONTROL ON DISTRICT ROADS BETWEEN ST. JOHNS COUNTY, THE ST. JOHNS COUNTY SHERIFF'S OFFICE, AND THE RIVERS EDGE COMMUNITY DEVELOPMENT DISTRICT AND AUTHORIZING THE COUNTY ADMINISTRATOR TO EXECUTE THE AGREEMENT ON BEHALF OF ST. JOHNS COUNTY.

WHEREAS, St. Johns County, Florida, a political subdivision of the State of Florida, the St. Johns County Sheriff's Office, and The Rivers Edge Community Development District desire to enter into the Agreement for Traffic Control on District Roads (hereinafter, "Agreement") in substantially the same form as attached to this Resolution; and

WHEREAS, the purpose of the Agreement is for traffic control jurisdiction for the Sheriff's Office to conduct traffic enforcement on private roads not owned and maintained by the County; and

WHEREAS, the Parties desire to enter into the Agreement to serve such purpose; and

WHEREAS, nothing in this agreement will be constructed as imposing any obligation or duty upon the County to provide maintenance, drainage, repair, construction, or reconstruction of any improvement on the district roads; and

WHEREAS, entering into the Agreement will serve a public purpose.

NOW, THEREFORE, BE IT RESOLVED BY THE BOARD OF COUNTY COMMISSIONERS OF ST. JOHNS COUNTY:

Section 1. The above recitals are hereby incorporated into the body of this resolution and are adopted as findings of fact.

Section 2. The Board of County Commissioners approves the terms, provisions, conditions, and requirements of the attached Agreement between the Parties and authorizes the County Administrator to execute the agreement on behalf of St. Johns County substantially in the same form as attached.

Section 3. If there are typographical or administrative errors or omissions that do not change the tone, tenor, or context of this resolution, this resolution may be revised without subsequent approval of the Board of County Commissioners.

Section 4. This resolution shall be effective upon adoption by the Board of County Commissioners.

PASSED AND ADOPTED by the Board of County Commissioners of St. Johns County, Florida, this 15 day of January 2019.

Attest:

Sam Halterman
Deputy Clerk

BOARD OF COUNTY COMMISSIONERS OF
ST. JOHNS COUNTY, FLORIDA

By:

Paul M. Waldron

Paul M. Waldron, Chair

RENDITION DATE 1/17/19

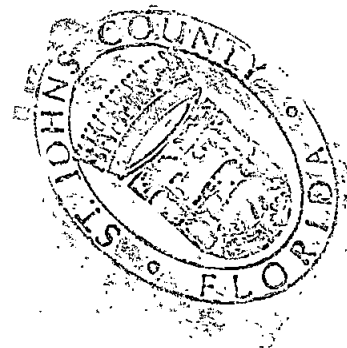

AGREEMENT FOR TRAFFIC CONTROL ON DISTRICT ROADS

This Agreement for Traffic Control on Public Roads located in the [NAME OF SPECIAL DISTRICT Rivers Edge Community Development District] ("District") is entered into by and between St. Johns County, Florida ("County"), a political subdivision of the State of Florida, the St. Johns County Sheriff's Office ("Sheriff"), and District, a local unit of special purpose government, established pursuant to Florida law, and located in St. Johns County, Florida.

WITNESSETH:

WHEREAS, District owns fee simple title to all the public roadways lying within the District (hereinafter "District Roads") more specifically described in Exhibit "A" which is attached hereto and incorporated herein; and

WHEREAS, pursuant to state statute, County does not have traffic control jurisdiction over District Roads such as those owned by District; and

WHEREAS, Florida Statute Section 316.006(3)(b) provides that a county may exercise jurisdiction over any District Roads if the County and the Special District owning such roads provide for County traffic control jurisdiction by a written agreement approved by the governing board of the county; and

WHEREAS, Florida Statute Section 316.006(3)(b) further provides that prior to entering into an agreement for traffic control jurisdiction over District Roads the governing board shall consult with the Sheriff; and

WHEREAS, District has requested that the County exercise traffic control jurisdiction upon certain District Roads identified herein; and

WHEREAS, the County and Sheriff are willing to exercise traffic control jurisdiction upon the District Roads; and

WHEREAS, Florida Statute Section 316.006(3)(b)(2) provides *inter alia* that no such agreement shall take effect prior to October 1 unless such provision is waived in writing by the sheriff of the county; and

WHEREAS, the Sheriff has waived this provision in writing.

NOW, THEREFORE, in consideration of the covenants and conditions herein, County and District hereby agree as follows:

1. The above recitals are true and correct, and are incorporated herein by reference and form a material part of this Agreement.

2. **Jurisdiction.** County agrees to exercise jurisdiction over traffic control upon the District Roads pursuant to the terms and conditions expressed in Florida Statute Section 316.006(3)(b) and subject to the terms and conditions specified in Exhibit "B."

3. **Traffic Study; Signage.** District shall establish the speed limit for the District Roads and shall be responsible for posting the speed limit by appropriate, DOT approved signage along said roads. (See Exhibit "B.")

4. **Authority in Addition to Existing Authority.** The County's exercise of traffic control jurisdiction pursuant to this Agreement shall be in addition to that authority presently exercised by County over the District Roads and nothing herein shall be construed to limit or remove any such authority. The County agrees to continue to provide such police and fire services as are required by law.

5. **Compensation.** District shall compensate Sheriff for the services performed under this Agreement that are reasonably determined by the Sheriff to exceed normal traffic enforcement activities, at an hourly rate reasonably determined by the Sheriff.

6. **Retainage of Revenues.** All revenue from the fines, costs and penalties imposed by the traffic citations issued for violation of traffic laws on the District Roads shall be apportioned in the manner set forth in applicable statutes.

7. **Liability not Increased.** Neither the existence of this Agreement nor anything contained herein shall give rise to any greater liability on the part of the County or Sheriff than that which the County or Sheriff would ordinarily be subjected to when providing its normal police services.

8. **Indemnification/Insurance.** To the fullest extent permitted by law, District shall indemnify, defend, and hold the County and Sheriff (including all of their officers, employees and agents) harmless from any loss, cost, damage or expense, including attorneys' fees, for any action arising out of, related to, or stemming from, either directly or indirectly, the enforcement activities provided through this Agreement, or the maintenance, repair and/or reconstruction of any roads, road drainage or signage. To ensure its ability to fulfill its obligation under this paragraph, District shall maintain General Liability insurance in the minimum amount of One Million dollars (\$1,000,000), and shall file with the County current certificates of the required insurance providing a 30-day advance written notice of cancellation. Such insurance shall (a) name the County and Sheriff as additional insureds as it relates to activities conducted pursuant to this contract and (b) be issued by companies authorized to do business under the laws of the State of Florida and acceptable to the County. Evidence (e.g., binder) of compliant insurance is attached as Exhibit "D."

9. **Road Maintenance.** Neither the existence of this Agreement nor anything contained

herein shall impose any obligation or duty upon the County to provide maintenance on and/or drainage of the District Roads. The maintenance, repair and construction or reconstruction of all roads, drainage and signage within the District shall at all times be solely and exclusively the responsibility of the District.

10. *Term.* The term of this Agreement shall be for one year, commencing on the date of the execution by the last of the two parties signing hereto, and this Agreement shall thereafter automatically continue for successive one year terms unless terminated by any party by thirty (30) days written notice to the other parties. The provisions of Paragraph 8 herein shall survive the termination of this Agreement.

11. *Entire Agreement.* This Agreement, including all Exhibits attached hereto, constitutes the entire understanding and agreement between the parties and may not be changed, altered, or otherwise modified except when reduced to writing and executed in the same manner, with approval by the Board of County Commissioners.

12. *Notice.* All notices to be given shall be in writing and sent by certified mail, return receipt requested, to the following addresses:

As to County: St. Johns County Administrator
4020 Lewis Speedway
St. Augustine, FL 32084

Copy to: St. Johns County Attorney's Office
4020 Lewis Speedway
St. Augustine, FL 32084

As to Sheriff: St. Johns County Sheriff's Office
4015 Lewis Speedway
St. Augustine, FL 32084

As to District: Rivers Edge CDD
c/o Governmental Mgmt Services
475 Town Place, Suite 114
St. Augustine, FL 32092
[Name and Mailing Address]

Copy to: Hopping, Green & Sams, P.A.
c/o District Counsel
119 S. Monroe St, Suite 300
Tallahassee, FL 32301
[Legal counsel (if known)]

13. *Counterparts.* This Agreement may be executed in any number of counterparts, each of which when executed and delivered shall be an original; however, all such counterparts together shall constitute but one and the same instrument. Signature and acknowledgement pages may be detached from the counterparts and attached to a single copy of this Agreement to physically form one document.

[REMAINDER OF PAGE INTENTIONALLY LEFT BLANK]

IN WITNESS WHEREOF, the parties have executed this Agreement on the dates indicated below.

COUNTY ADMINISTRATOR
ST. JOHNS COUNTY, FLORIDA

LEGALLY SUFFICIENT

Name
Date: _____

By: _____
Michael D. Wanchick, County Administrator

DATE: _____

ATTEST: Hunter S. Conrad, Clerk

By:

Deputy Clerk

ST. JOHNS COUNTY SHERIFF'S OFFICE
ST. JOHNS COUNTY, FLORIDA

By: _____
David B. Shoar, Sheriff

DATE: _____

DISTRICT

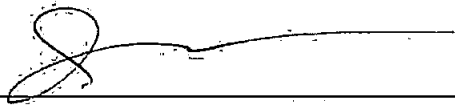
_____ (Signature)

By: Jason Sessions _____ (Print Name)

Title: RECDD, Chairman _____

Date: 10/17/18 _____

Witness

_____ (Signature)

Ryan Stilwell _____ (Print Name)

Witness

_____ (Signature)

ERNESTO J. TORRES _____ (Print Name)

EXHIBIT "A"
DISTRICT ROADS
Legal Description

PROSSER

County - Georgetown - City - Riverton
 1300 S. 14th Street, Suite 100
 Columbia, SC 29204-1527

Phone: 803.733.4143
 Fax: 803.733.4145

Website: www.prosser.com

Professional Engineer
 License No. 11000-00000
 Member 10048020

ROAD OWNERSHIP EXHIBIT

DATE: AUGUST 28, 2018
 PROJECT NO.: 1705041
 DESIGNED BY: JPC
 DRAWN BY: JPC
 SCALE: AS SHOWN

No.	Date	Revisions

TWO DIMENSIONS RELEASE FOR CONSTRUCTION UNLESS SO NOTED.

SCALE

RIVERTOWN ROAD OWNERSHIP

C1.0

SHEET

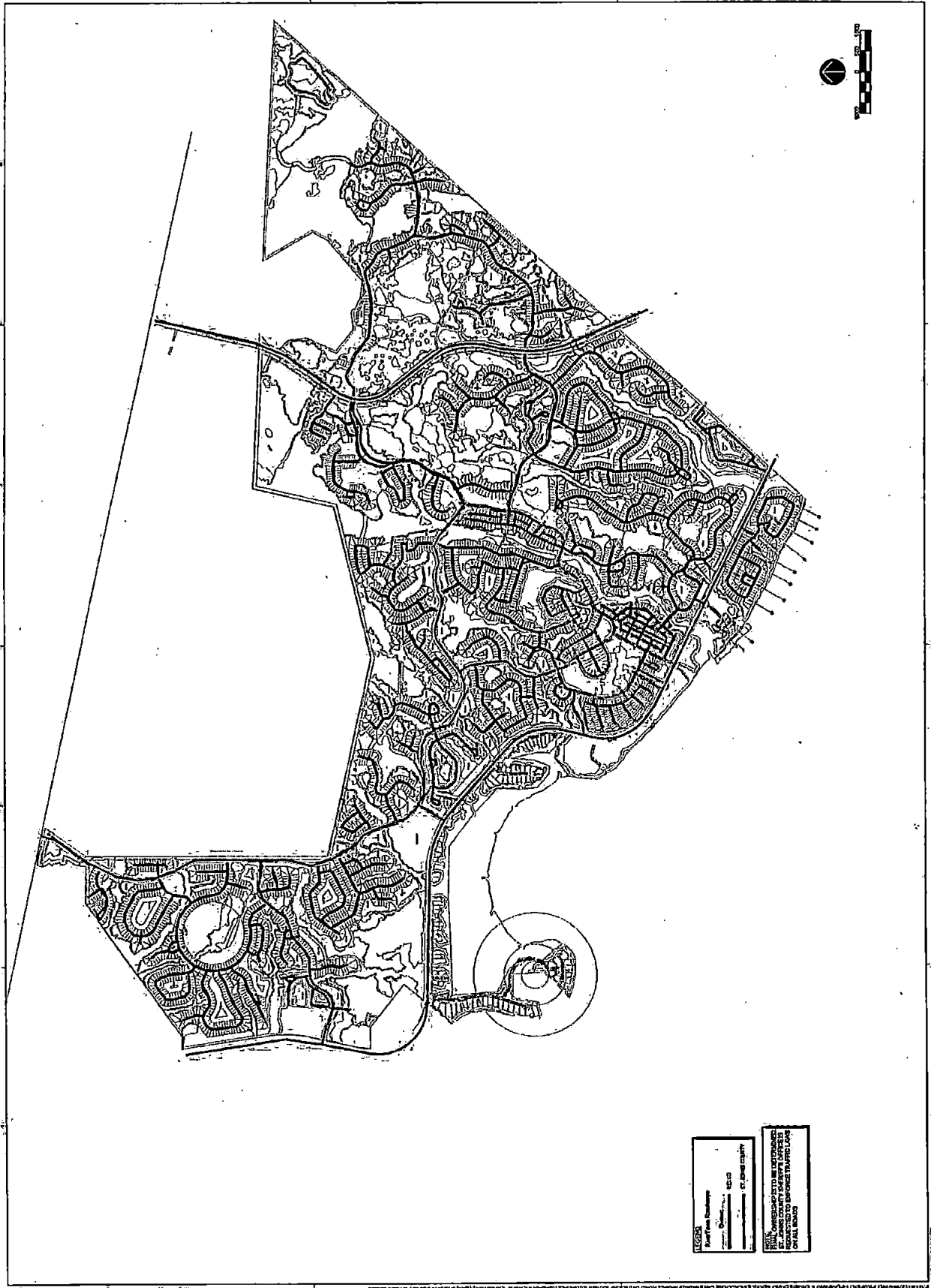

LEGEND

- Proposed Roadway
- Existing Roadway
- County Road
- City Road
- Other Road

THE INFORMATION ON THIS EXHIBIT IS INTENDED TO BE USED IN CONNECTION WITH THE MAIN EXHIBIT AND SHOULD NOT BE USED TO ESTABLISH OWNERSHIP OF ANY LAND OR INTEREST THEREIN.

THIS EXHIBIT PROVIDES INFORMATION FOR THE PURPOSE OF IDENTIFYING ROAD OWNERSHIP AND IS NOT TO BE USED FOR ANY OTHER PURPOSES. THE USER OF THIS EXHIBIT IS RESPONSIBLE FOR VERIFYING THE ACCURACY OF THE INFORMATION PROVIDED HEREON.

EXHIBIT "B"
TRAFFIC STUDY; SIGNAGE

The following procedures are intended to provide the applicant with sufficient information to meet the requirements of Paragraph 3 of the Agreement titled: Traffic Study; Signage.

SECTION I - SUBDIVISION SIGNING AND MARKING PLAN

The applicant should contact the Records Management Officer at (904) 209-0706 and request the as-built subdivision file from the official records. The original plans for the subdivision may not have signing and marking plan. *If a signing and marking plan does not exist, a provision to establish a plan will need to be included in the engineering scope of services.*

SECTION II - ENGINEERING SERVICES

A Professional Engineer registered in the State of Florida shall provide engineering services. The applicant should seek professional services of an engineering firm that has expertise in Traffic Engineering. The engineering firm that designed the subdivision may have expertise in this field. If not, the Traffic Operations Section will provide the applicant with a list of consulting firms known to have experience in Traffic Engineering. Fees for professional services and expenses associated with the requirements of Paragraph 3 of the agreement will be the responsibility of the applicant.

SECTION III - ENGINEERING STUDY

The Engineering Study will consist of a Traffic Study Outline, Traffic Study Report, and Certified Signing Plan. The Traffic Study Outline will contain the proposed study methods and standards to be employed by the consultant, and shall reference applicable sections of the Manual on Uniform Traffic Control Devices. Approval of the study outline by Traffic Operations must be obtained prior to proceeding with field investigations.

Speed Limits must be established in accordance with Chapter 316 of the Florida Statutes. The methodology for establishing speed limits can be found in the Manual of Speed Zoning for Highways, Roads and Streets in Florida, published by the Florida Department of Transportation. Study methods for establishing speed limits will also be including in the Traffic Study Outline.

Golf Cart Use

Certain streets may be designated for golf cart use after a determination is made by your engineer, and confirmed by the County Traffic Operations that golf carts may safely travel on or cross the public road or street, considering factors including speed, volume and character of motor vehicle traffic using the road or street. With the exception of speed limits, the study procedures for golf cart use will follow the engineering study requirements in Section II, Engineering Services and Section III, Engineering Study.

A certification statement will be printed on the Signing Plan (see format below), which shall be affixed with the seal and signature of a Professional Engineer, registered in the State of Florida.

Traffic Control Plan Certification

DISTRICT FINES EDGE CDD

This plan is an accurate representation of the type and location of each traffic control sign or device at the time of certification. Each sign or device shown herein has been field inspected and verified to be in conformance with the Manual on Uniform Traffic Control Devices. Speed limits as posted, have been established in accordance with Section 6.1.6.

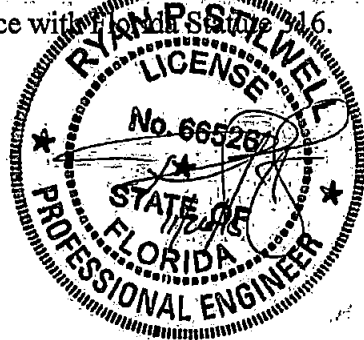

**Seal & Signature of
Professional Engineer**

FINAL SUBMITTAL

The applicant will submit the Certified Traffic Control Plan and Engineering Report to the Traffic Operations Section, 2470 Industry Center Road, St Augustine, Florida 32084. Following approval by the County Engineer, the applicant may proceed with completing the remaining requirements of the agreement.

If additional information or clarification is needed, please contact Greg Kennedy, Traffic Operations Manager at (904) 209-0178.



13901 Sutton Park Drive South, Suite 200
Jacksonville, Florida 32224-0119
p 904.739.3655 f 904.730.3413
www.prosserinc.com

August 22, 2017

Mr. Jay Brawley
St. Johns County
4040 Lewis Speedway
St. Augustine, FL 32084

RE: Revised Rivertown Golf Cart Study

Dear Mr. Brawley:

Thank you for the opportunity to provide this golf cart study to allow golf carts within County rights of way within Rivertown.

Background

This study is being submitted to conform with St John's County Ordinance 2010-48 to allow golf cart operation on certain roadways within Rivertown DRI. This study also identifies where golf carts will be allowed within the roadway with traditional vehicles, on paths within the right of way but outside the roadway, or not be allowed within the right of way.

Revision Note:

This revision is a field review with County staff. The following are revisions within this submittal:

1. Added crosswalk markings for any mid-block crossing
2. Added special emphasis markings for any trail/road crossing
3. Added crosswalk signage and markings at Sternwheel/Orange Branch Trail
4. Added R 4-11 at the end of the short trail northeast of the Rivertown Main Street/Orange Branch Trail roundabout

Criteria

St. John's County Ordinance 2010-48 requires a review of the roadways to consider the projected speed, volume, and character of motor vehicle traffic. Due to high speed limit (45 mph or greater), high projected volume, and character of Arterials (principal network for through traffic flow), this study does not recommend golf carts be allowed along SR 13. Due to high speed limit (45 mph), high projected volume, and character of Major Collectors (principal network for through traffic flow), this study does not recommend golf carts be allowed along CR 244. This study does recommend carts be allowed on paths within the right of way on Minor Collectors (distributor roadway serving traffic between Major Collectors and local roads) due to the low speed limit (25 mph), lower projected volume, and character of the roadway. This study recommends carts be allowed within the travel way on Local Roads (roadway used primarily for direct access to Residential and Commercial driveways, or abutting roads) due to the low speed limit (25 mph), low projected volume, and character of these roadways.

Design of golf cart signage and markings are consistent with MUTCD criteria and also based on previous projects within the County. It is envisioned that carts will be allowed to cross CR 244 at the signalized

Mr. Jay Brawley, St Johns County
Rivertown Golf Cart Study
May 16, 2017
Page 2

intersections, upon final design and permitting of the eastern connections intersections. Crossings of SR 13 are anticipated at the roundabout locations and are subject to FDOT permitting.

Existing Roads

A review of the projected conditions on existing roadways has been completed to consider the projected speed, volume, and character of motor vehicle traffic. The result of this review determines what roadways should be allowed to have golf carts and their location within the right of way. Lastly, this study determines if any signage or pavement markings are needed to allow golf carts. The existing and proposed signage and pavement markings can be found in Appendix A.

Future Roads

A review of the projected conditions on future roadways has been completed to consider the projected speed, volume, and character of motor vehicle traffic. The result of this review determines what roadways should be allowed to have golf carts and their location within the right of way. Since these roadways have not been designed, all details have not been determined. Significant projected intersections have been identified with typical details developed for review. These projected roadways have been identified on the map in Appendix B. Future road cart approval is conceptual, subject to final design approval at roadway permitting.

Results

This study and attached documents provide justification to allow golf carts on specified roadways in St John's County. It is envisioned that existing roadways would be allowed to have golf carts traverse the right of way upon installation of the identified signing and marking modifications. Future roadways will need to have permit approval through St Johns County development review with required signage. The results can be seen in graphical form in Appendix B and tabular form in Appendix C.

Thank you,

Austin Chapman
8/22/2017
Florida Professional Engineer #72474



APPENDIX A:
Existing Road Proposed Signing
and Pavement Markings

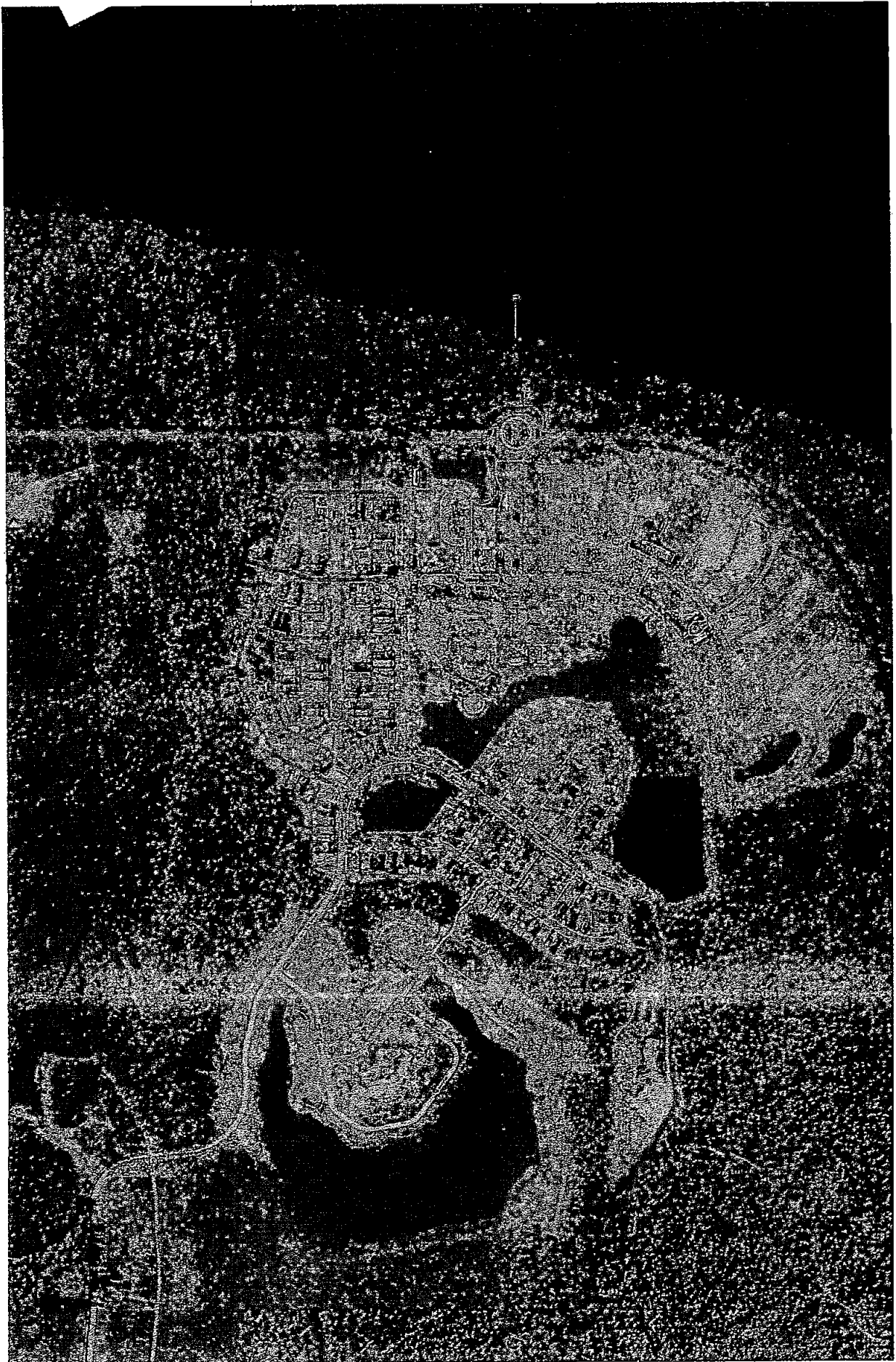



P:\FD\117091-60-RIVERTOWN EDGE CONSTRUCTION\Work Items\Civil Path Construction\DWG.dwg

2:49:01 PM

8/27/2017

TPA\jlan

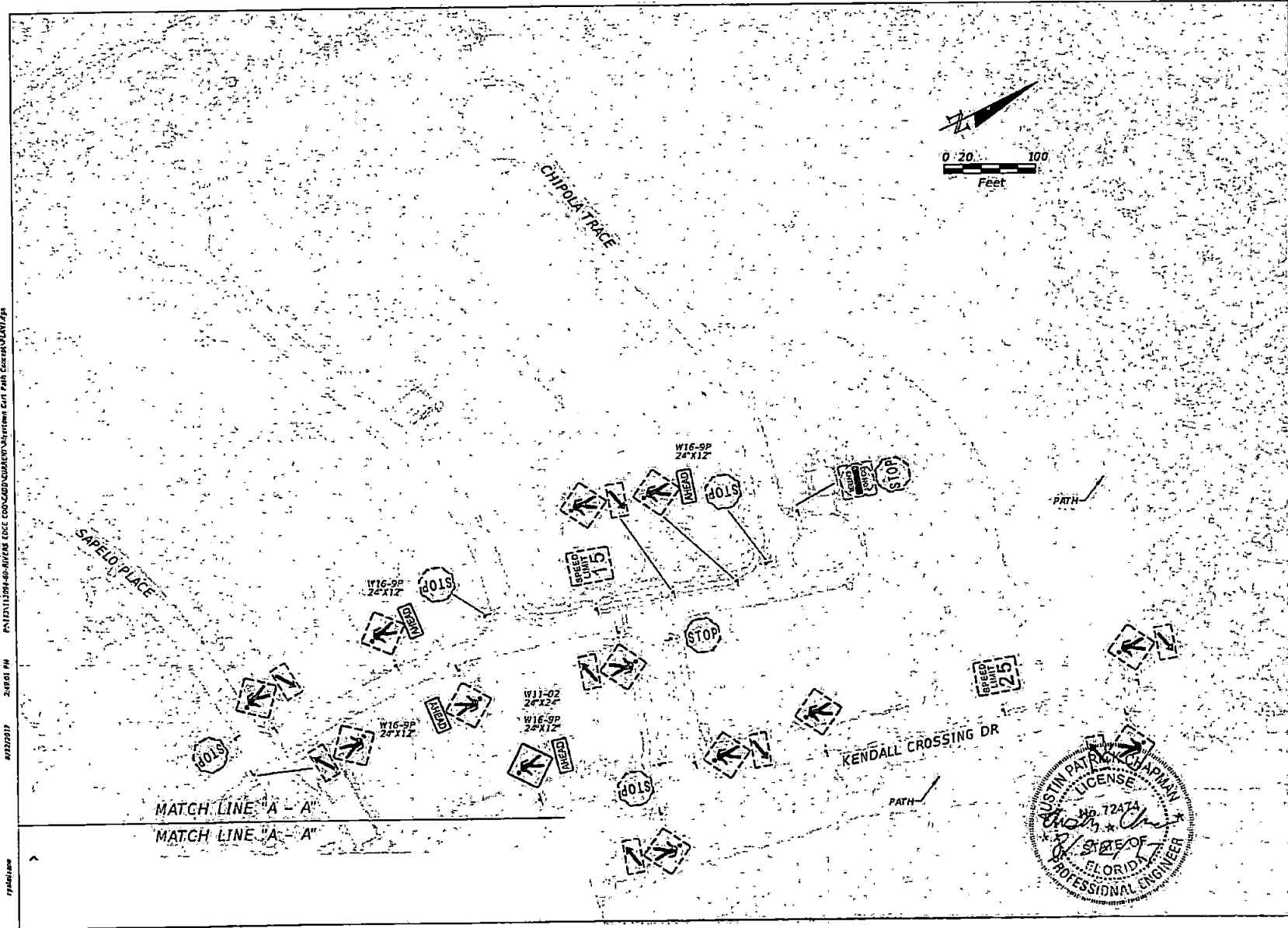

PROSSER
 Consulting - Management - Energy - Remediation

13701 Sutton Park Drive South, Suite 200
 Jacksonville, Florida 32224-0229

Office 904.779.3355
 Fax 904.779.5438
 www.prosserinc.com

Florida Certificate of Authorization
 Number: 00001052

**RIVERTOWN
 CART STUDY**

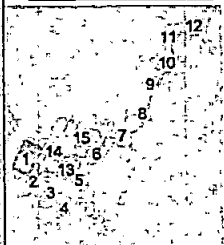

KEY MAP

DATE	08-11-2017	
PROJECT NO.	117091-60	
DESIGNED BY	JAC	
DRAWN BY	JPP	
SCALE	AS SHOWN	
No.	Date	Revision

THIS DRAWING NOT RELEASED FOR CONSTRUCTION UNLESS SO NOTED ABOVE

SHEET TITLE



Justin P. Chapman, P.E.
 8/27/2017
 1
 SHEET

PROSSER

Survey - Mapping - Erosion - Rehabilitation
 13301 Sutton Park Drive South, Suite 200
 Jacksonville, Florida 32224-0220

Phone 904.723.3635
 Fax 904.723.3413
 www.prosserinc.com

Florida Certificate of Authorization
 Number 05006250

**RIVERTOWN
 CART STUDY**

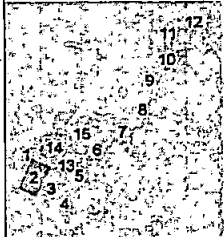

KEY MAP

DATE: 04-11-2017
 PROJECT NO.: 111702-04
 DESIGNED BY: LAM
 DRAWN BY: RFP
 SCALE: AS NOTED

No.	Date	Revision

THIS DRAWING NOT RELEASED FOR
 CONSTRUCTION UNLESS SO NOTED
 ABOVE

SHEET TITLE

Justin P. Chapman, P.E.
 No. 72474
 STATE OF FLORIDA
 PROFESSIONAL ENGINEER

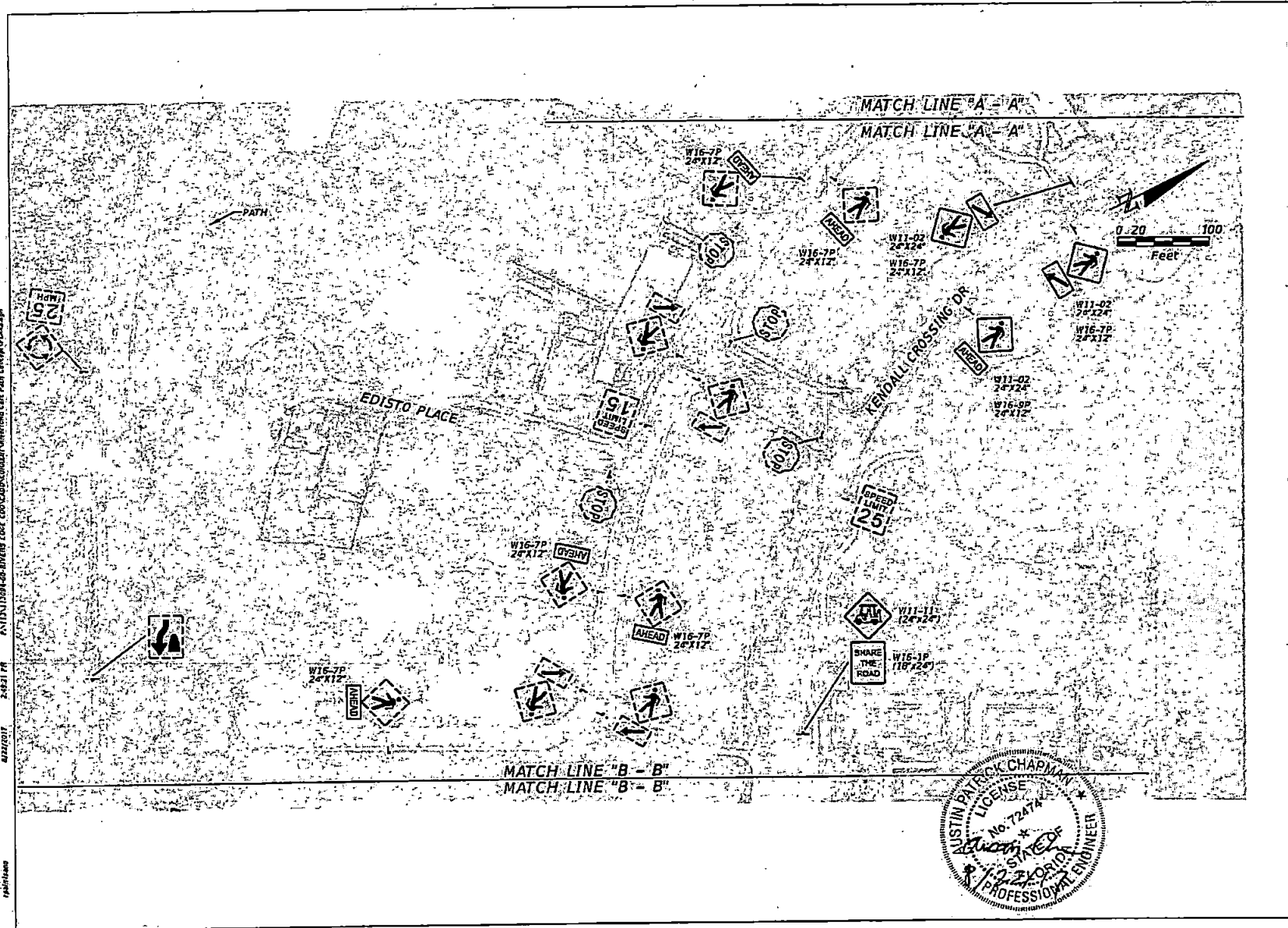

P:\111702\111702-04\REVISED\EDISTO PLACE AND KENDALL CROSSING DR\WATERMATS\Cart Path Drawing.dwg
 2-6-21 PM
 4/27/2017
 14811460

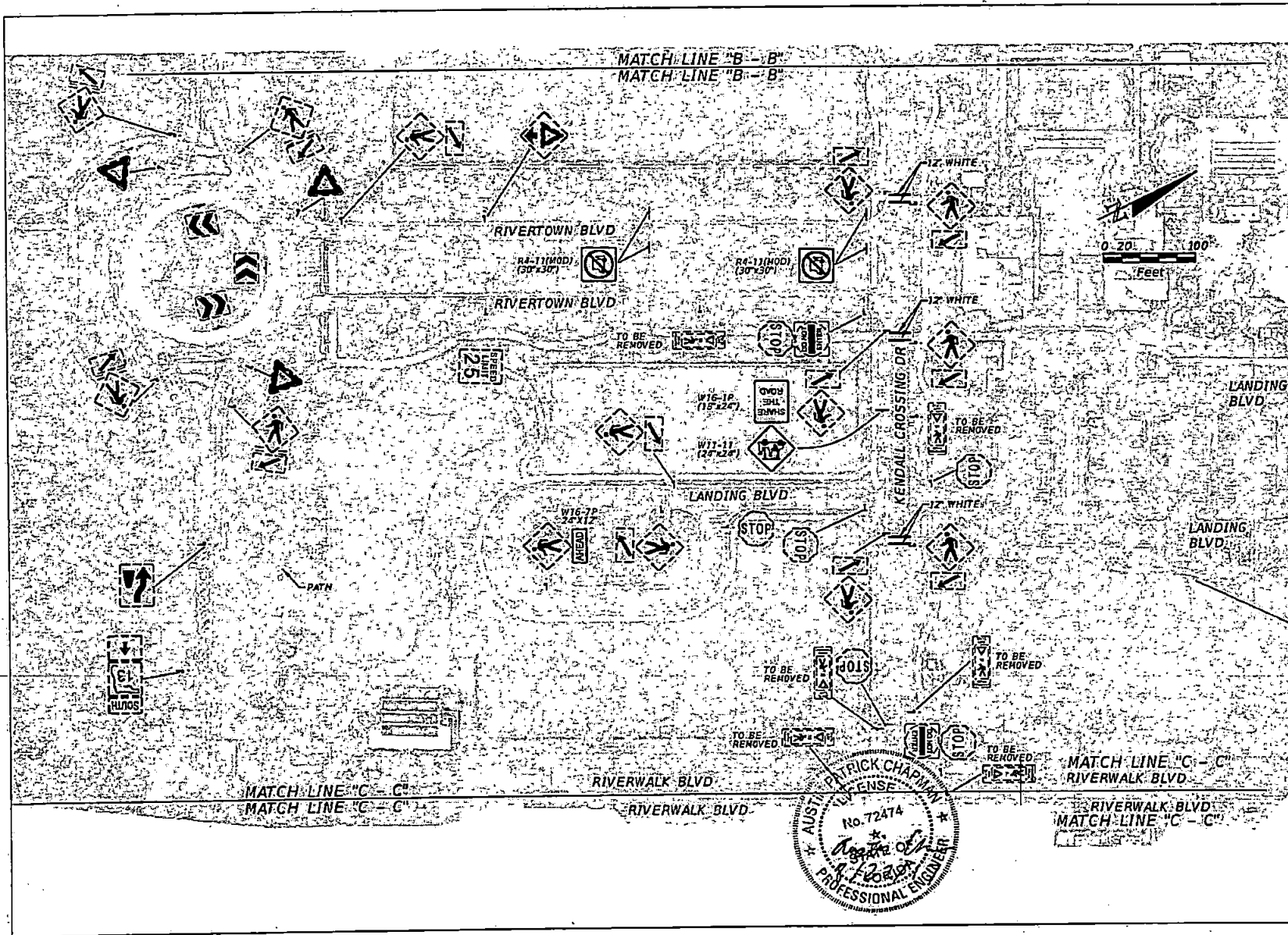

PROSSER
 Diversity - Management - Energy - Risk - Safety
 11701 Sutton Park Drive South, Suite 200
 Jacksonville, Florida 32224-0229
 Office 904.730.3555
 Fax 904.730.3413
 www.prosserinc.com
 Florida Certificate of Authorization
 Number: 00004050

RIVERTOWN CART STUDY

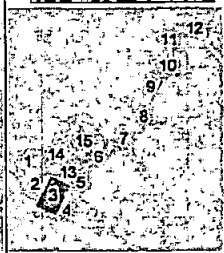

KEY MAP

DATE: 08-11-2007
 PROJECT NO.: 117024-ES
 DESIGNED BY: AJM
 DRAWN BY: JRP
 SCALE: 1" = 40' HORIZ

No.	Date	Content

THIS DRAWING NOT RELEASED FOR CONSTRUCTION UNLESS SO NOTED ABOVE

SHEET TITLE

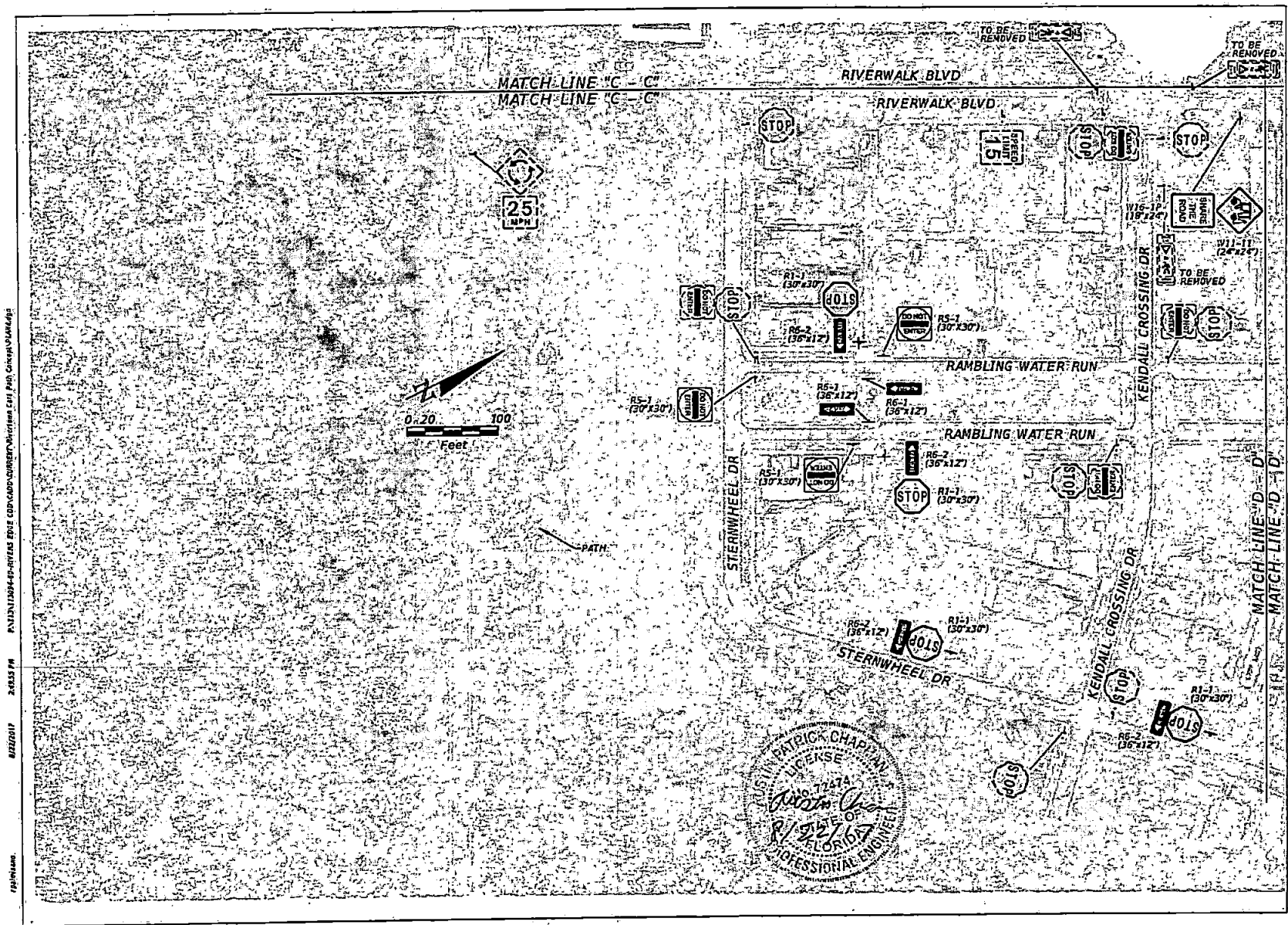

02/20/17 2:45:58 PM P:\12\1206\46-RIVERWALK DRIVE CONVERSION\REVISED\PLAN SET\PLAN SHEETS\MAPPING

PROSSER
 Community Management • Energy • Rehabilitation
 13701 Sutton Park Drive South, Suite 200
 Jacksonville, Florida 32224-0229
 Office 904.720.2835
 Fax 904.720.3413
 www.prosserinc.com
 Florida Certificate of Authorization
 Number: 0C00452

**RIVERTOWN
 CART STUDY**

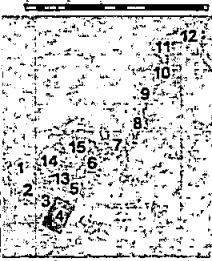

KEY MAP

DATE: 02-11-2017
 PROJECT NO.: 11206-14
 DESIGNED BY: JAC
 DRAWN BY: JTP
 SCALE: AS SHOWN

No.	Date	Revision

THIS DRAWING NOT RELEASED FOR CONSTRUCTION UNLESS SO NOTED ABOVE

SHEET TITLE

Keith P. Dechow, P.E.
 1/22/17
 PROFESSIONAL ENGINEER

4
SHEET



4222247
62233 24
15263 24
P:\152631-60-RIVERTOWN EDGE CONDO\CD\152631-60-RIVERTOWN Cart Path Concept\PLAN2.Plx

PROSSER
Company Management & Engineering
12901 Eaton Park Drive South, Suite 200
Jacksonville, Florida 32224-4225
Office: 904.733.2516
Fax: 904.733.3418
www.prosser.net.com
Florida Certificate of Architectural
Number: 02004023

**RIVERTOWN
CART STUDY**

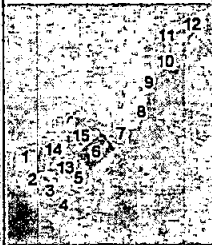

KEY MAP

DATE: 04-11-2017
PROJECT NO.: 152631-60
DESIGNED BY: LJEK
DRAWN BY: LJEK
SCALE: AS SHOWN

No.	Date	Revision

THIS DRAWING NOT RELEASED FOR
CONSTRUCTION UNLESS SO NOTED
ABOVE

SHEET TITLE



6
SHEET

02/22/2017 2:56:28 PM P:\11\11891\DWG\11891-000\11891-000.dwg User: jlm
 02/22/2017 2:56:28 PM P:\11\11891\DWG\11891-000\11891-000.dwg User: jlm

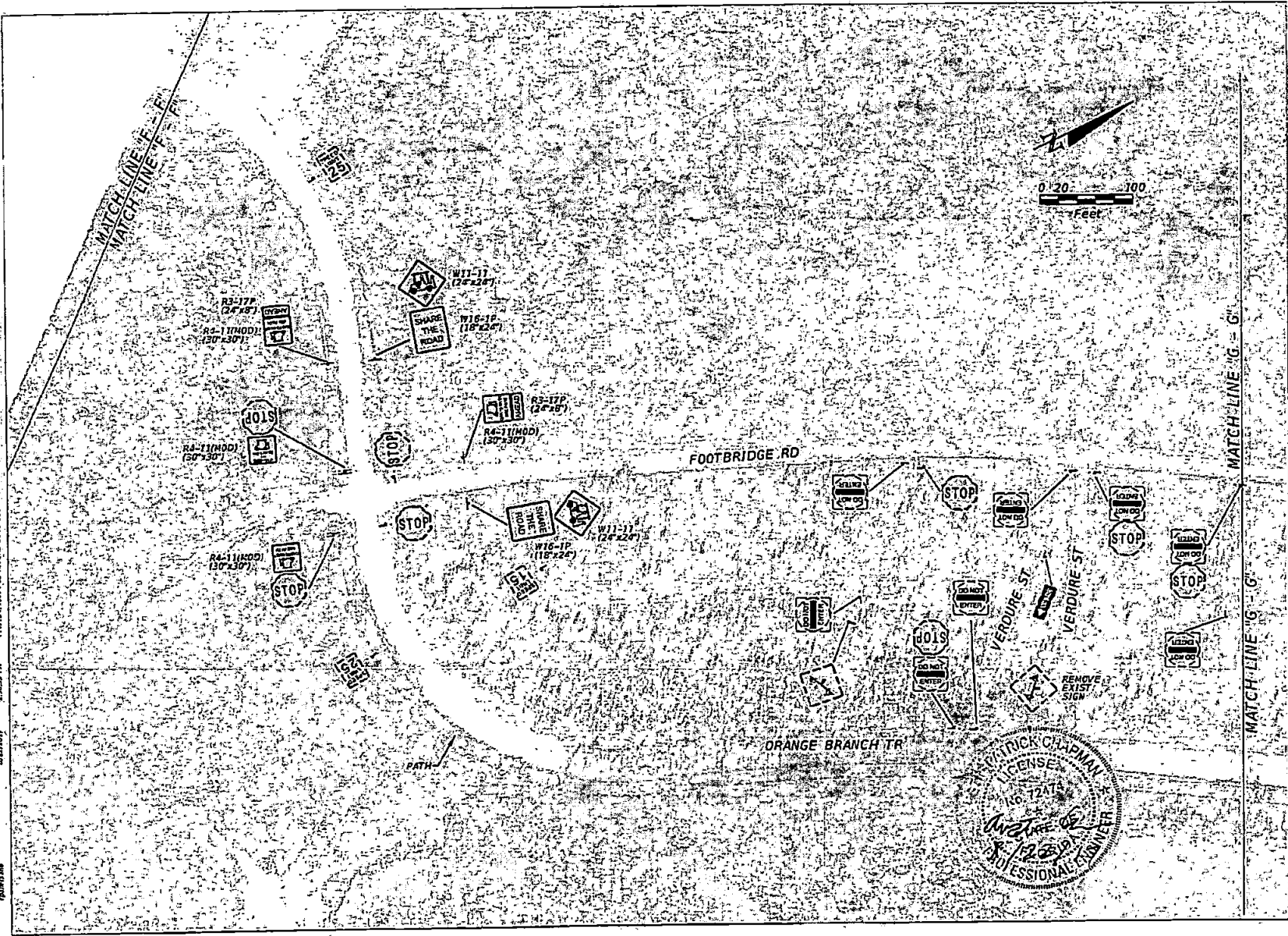

PROSSER
 Community Management - Energy - Rehabilitation
 13901 Dulles Park Drive South, Suite 200
 Jacksonville, Florida 32224-0220
 Office 904.728.3855
 Fax 904.720.3413
 www.prosserinc.com
 Florida Certificate of Accreditation
 Number 0004653

**RIVERTOWN
CART STUDY**

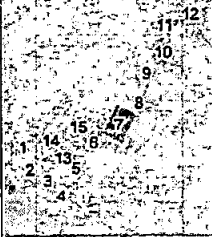

KEY MAP

DATE: 02-11-2017
 PROJECT NO.: 11891-000
 DESIGNED BY: JLM
 DRAWN BY: JLM
 SCALE: 1/8" = 1'-0"

No.	Date	Revisions

THIS DRAWING NOT RELEASED FOR CONSTRUCTION UNLESS SO NOTED ABOVE

SHEET TITLE



PROSSER

Community Development, Survey & Construction
11898 S. 110th St. Suite 200
Jacksonville, Florida 32214-5224

DATE: 04/23/15
BY: RAJ/SJS
www.prosser.com
Florida Certified Professional
Surveyor License No. 28683

RIVERTOWN CART STUDY

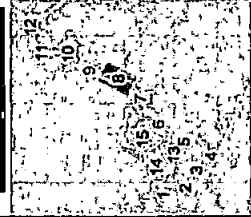

KEY MAP

DATE SUBMITTED:		
PROJECT NO. / LICENSE NO.:		
DESIGNED BY:	J.L.E.	
DRAWN BY:	J.L.E.	
SCALE:	AS SHOWN	
No.	Date	Description

THIS DRAWING IS NOT TO BE USED FOR ANY PURPOSES UNLESS AS SHOWN HEREON.

SHEET TITLE

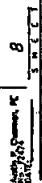

PROJECT: 11/12/04-06 RIVERS EDGE CONDO/CONCERN RIVERVIEW EAST PARK OVERSEER (11/12/04)

DATE: 02/22/07 3:16 PM

02/22/07

11/12/04

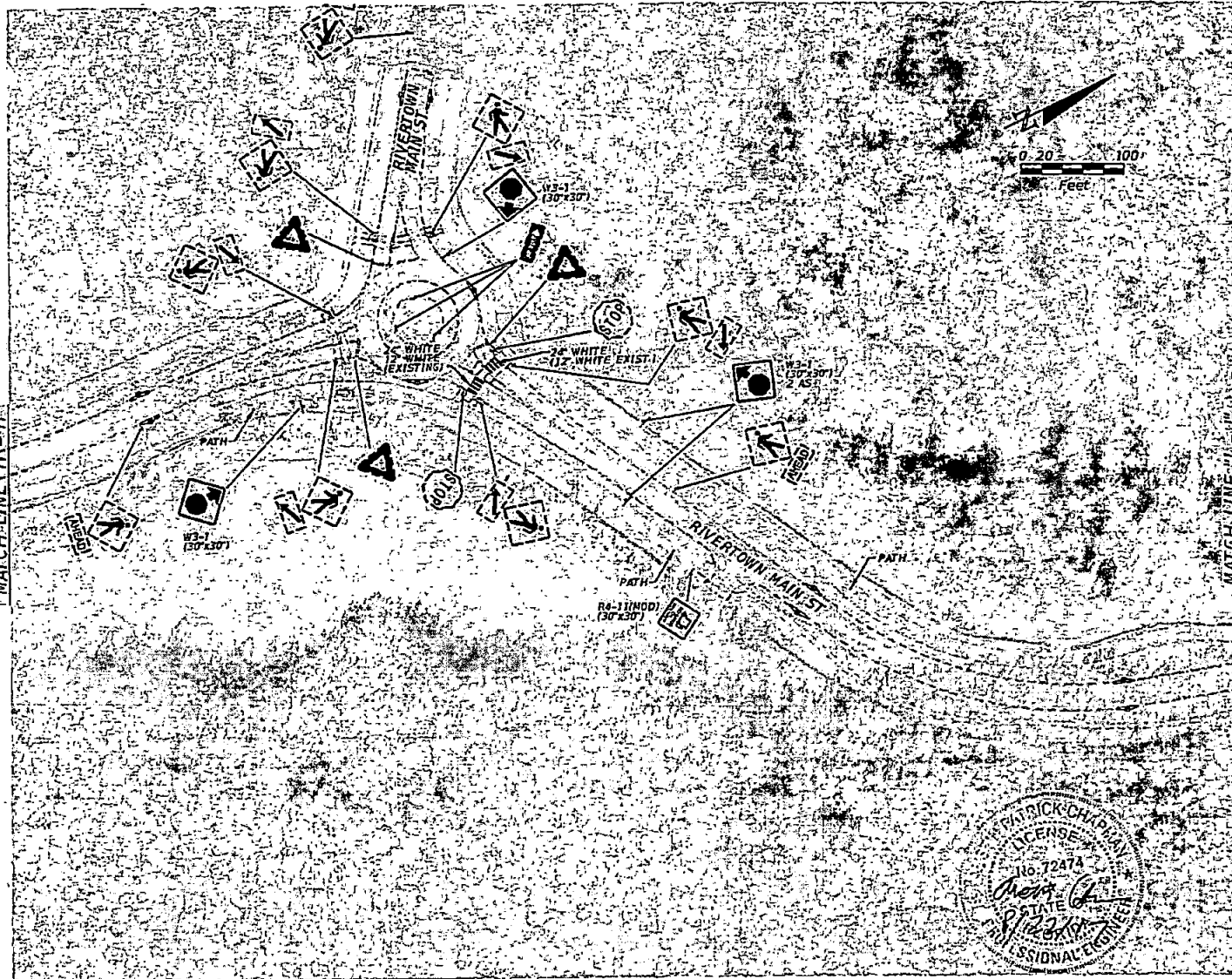

PROSSER
 CONSULTING ENGINEERS
 13231 Sutton Park Drive South, Suite 200
 Jacksonville, Florida 32226-0229
 Office: 904.776.8855
 Fax: 904.776.8475
 www.prosserinc.com
 Florida Certificate of Authorization
 Number: 00004073

**RIVERTOWN
 CART STUDY**

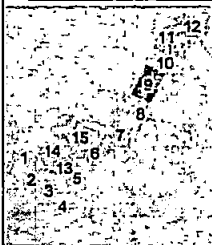

KEY MAP

DATE: 06-11-2007
 PROJECT NO.: 111204-06
 DESIGNED BY: JPC
 DRAWN BY: JPC
 SCALE: AS NOTED

Rev.	Date	Revised

THIS DRAWING NOT RELEASED FOR
 CONSTRUCTION UNLESS SO NOTED
 ABOVE.
 SHEET 07E



8/22/2017 1:51:23 PM P:\UN\112094-40-RIVERB EASE CAD\CADD\CADD\RiverTown Cart Path Concept\1010.dwg

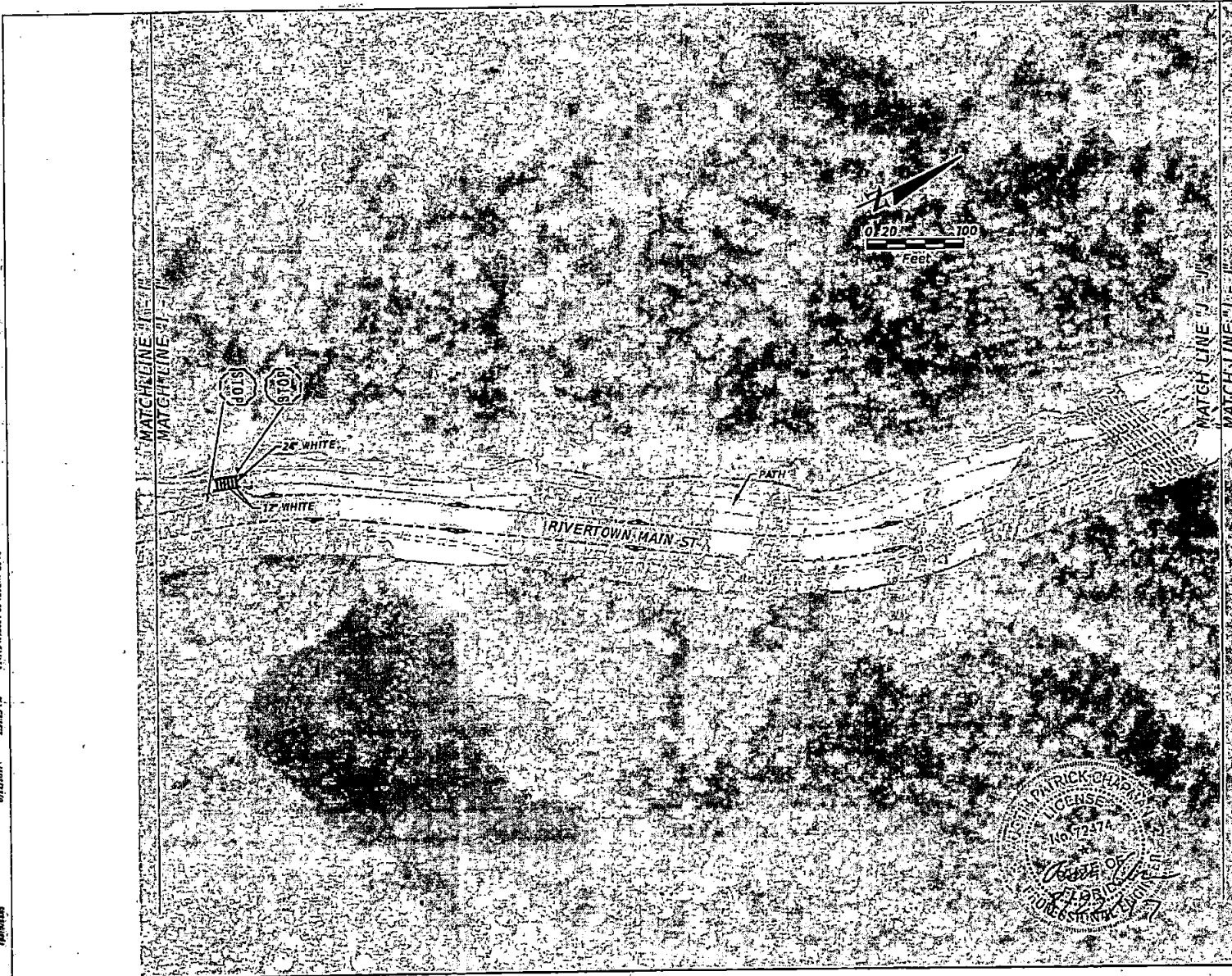

PROSSER

Community Management • Energy • Rehabilitation
 13701 Sutton Park Drive South, Suite 200
 Jacksonville, Florida 32224-0229
 Office 904.723.2855
 Fax 904.723.3413
 www.prosser.com
 Florida Certificate of Authorization
 No. 00004053

RIVERTOWN CART STUDY

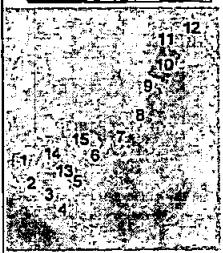

KEY MAP

DATE: 08-11-2017
 PROJECT NO.: 112094-08
 DESIGNED BY: JLF
 DRAWN BY: JLF
 SCALE: AS SHOWN

No.	Date	Revised

THIS DRAWING NOT RELEASED FOR CONSTRUCTION UNLESS SO NOTED ABOVE

SHEET TITLE



2/22/2017 2:41:37 PM P:\1717054-60-RTVELE EDGE CONSTRUCTION\RTV\RTV\1717054-60-RTV.dwg

rsb/ksm

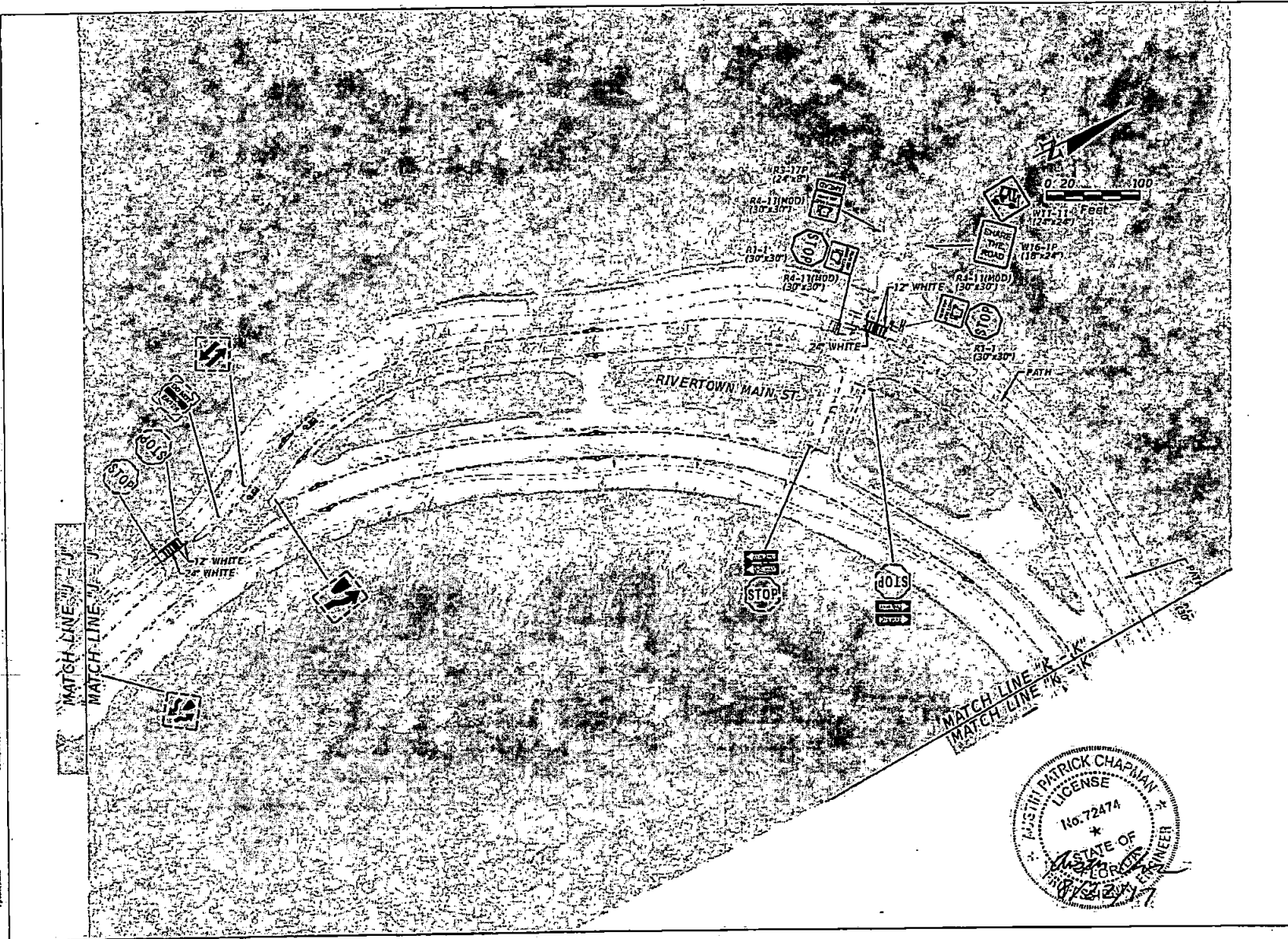

PROSSER
 Geospatial - Management - Energy - Remediation
 13901 Sunset Park Drive South, Suite 200
 Jacksonville, Florida 32224-0229
 Office 904.728.2355
 Fax 904.720.3413
 www.prosserinc.com
 Florida Certificate of Authorization
 Number: 00004950

**RIVERTOWN
 CART STUDY**

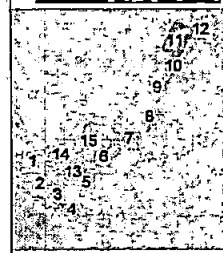

KEY MAP

DATE: 06-11-2017
 PROJECT NO: 1717054-60
 DESIGNED BY: ACP
 DRAWN BY: J.RP
 SCALE: AS SHOWN

No.	Date	Revision

THIS DRAWING NOT RELEASED FOR
 CONSTRUCTION UNLESS SO NOTED
 ABOVE

SHEET TITLE

11
 SHEET



PROSSER
Community - Management - Energy - Rehabilitation

11801 Sutton Park Drive South, Suite 200
Jacksonville, Florida 32224-0229

Office: 904.720.2254
Fax: 904.720.3419

www.prosserinc.com

Florida Certificate of Accreditation
Number: 10004029

**RIVERTOWN
CART STUDY**

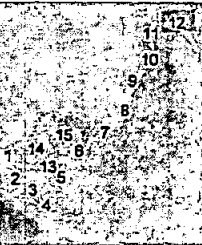

KEY MAP

DATE: 12-11-2017

PROJECT NO.: 111702-01

DESIGNED BY: L.A.S.

DRAWN BY: L.S.P.

SCALE: AS NOTED

No.	Date	Revision

THIS DRAWING NOT RELEASED FOR CONSTRUCTION UNLESS SO NOTED ABOVE

SHEET TITLE



Justin P. Chapman, P.E.
12/21/17

12
SHEET

SCALE: AS NOTED
DATE: 12-11-2017
PROJECT NO.: 111702-01
DESIGNED BY: L.A.S.
DRAWN BY: L.S.P.
SCALE: AS NOTED

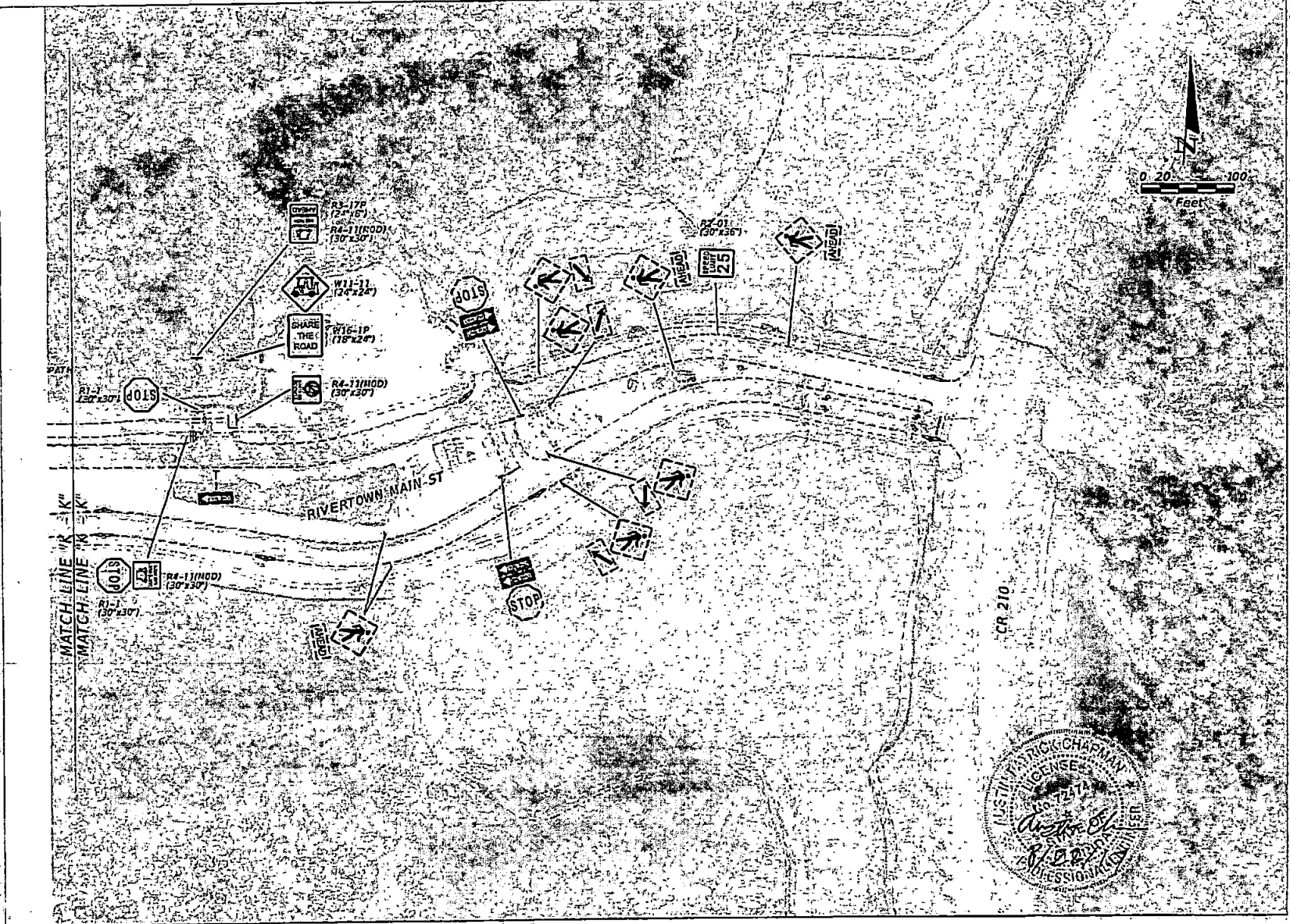

07/21/07 2:28:04 PM P:\11\11074-40 RIVERS EDGE CONDO\DOCUMENTS\Riverfront Cafe Main Concept\PLAN11.Plot

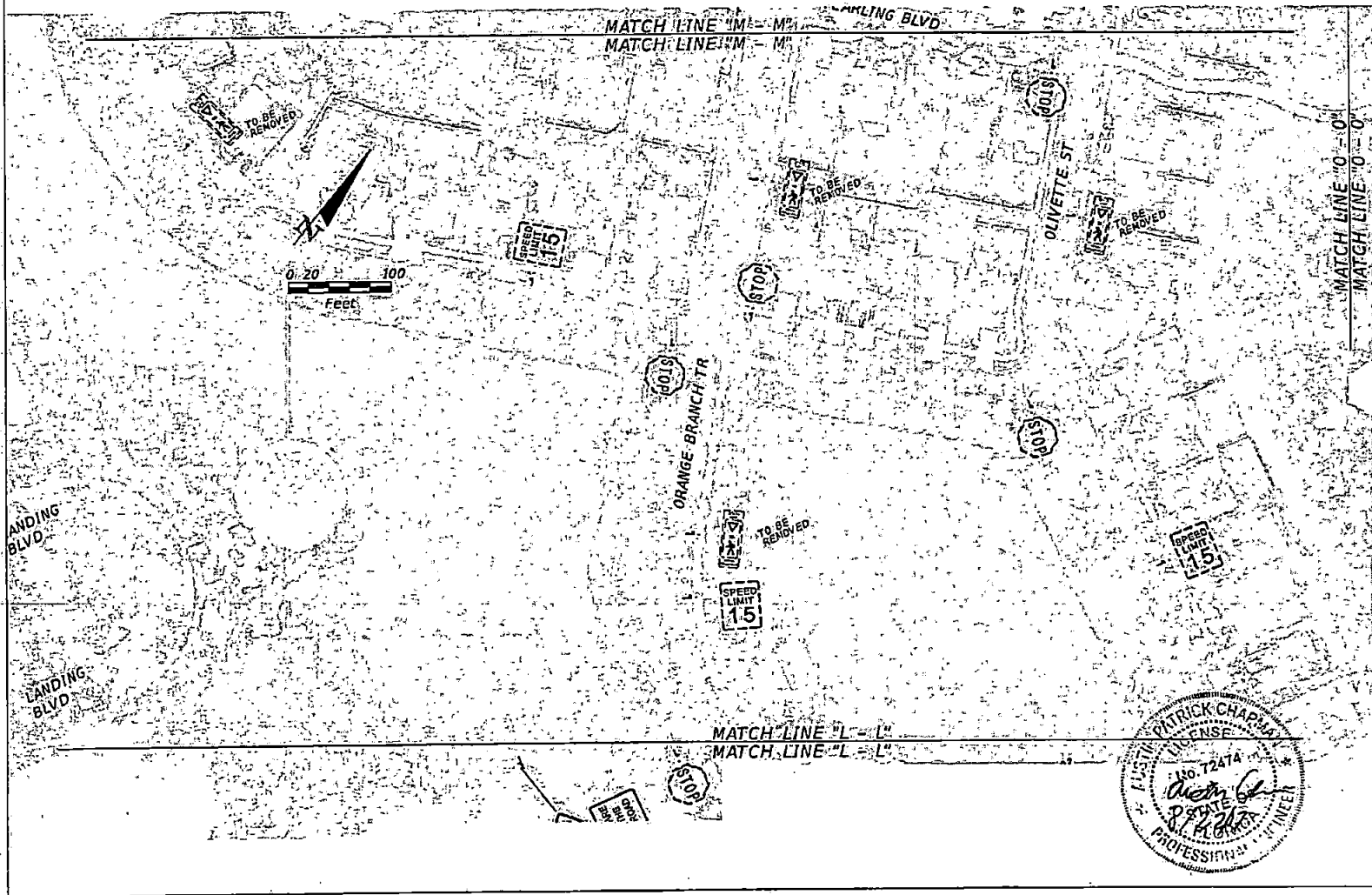

PROSSER
 Community • Management • Energy • Rehabilitation
 13701 Sutton Park Drive South, Suite 220
 Jacksonville, Florida 32224-0220
 Office 904.720.3455
 Fax 904.720.3413
 www.prosser.com
 Florida Certificate of Authorization
 Number: 00004082

**RIVERTOWN
 CART STUDY**

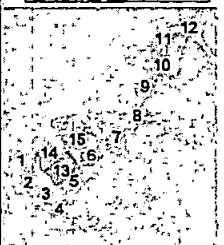

KEY MAP

DATE: 04-11-2017
 PROJECT NO.: 112024-BA
 DESIGNED BY: JPC
 DRAWN BY: JPP
 SCALE: AS NOTED

No.	Date	Revised

THIS DRAWING NOT RELEASED FOR
 CONSTRUCTION UNLESS SO NOTED
 ABOVE

SHEET TITLE



LARRY P. O'NEILL, PE
 CIVIL
 13
 SHEET

8/27/2017 1:52:18 PM P:\171\17096-60-ANNE'S EDC-CONDO-CONTRACT-GOVERNANCE-CONTRACT-PLAN-04-01-17\17096-60-ANNE'S EDC-CONDO-CONTRACT-GOVERNANCE-CONTRACT-PLAN-04-01-17.dwg

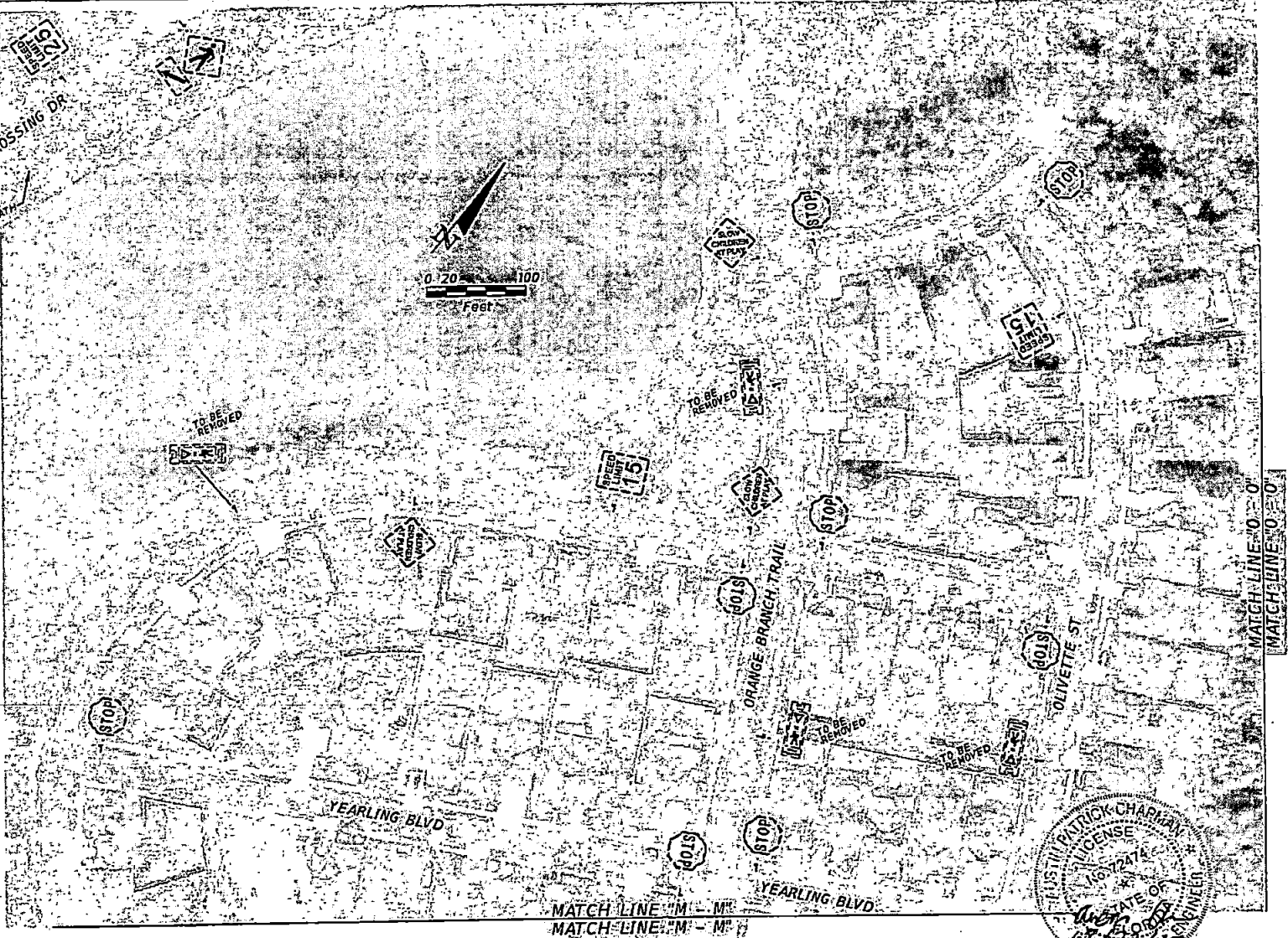

PROSSER
 Geacuity - Urban - Energy - Recreation
 13201 Sulfur Park Drive South, Suite 200
 Jacksonville, Florida 32214-0228
 Office: 904.773.3515
 Fax: 904.710.3413
 www.prosserinc.com
 Florida Certificate of Authorization
 Number: 00004550

**RIVERTOWN
 CART STUDY**

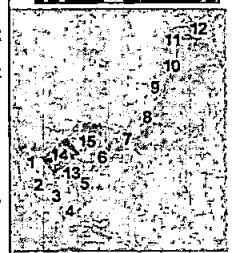

KEY MAP

DATE: 1/20/17-2017
 PROJECT NO.: 17096-60
 DESIGNED BY: AM
 DRAWN BY: JEP
 SCALE: AS SHOWN

No.	Date	Revision

THIS DRAWING NOT RELEASED FOR
 CONSTRUCTION UNLESS SO NOTED
 ABOVE

SHEET TITLE

P:\IN\1204-00-00\AS ES&E\00-CAD\CONTRACT\Documents For P&I\CONTRACTS\04-03-2017 - 23228 P&I - 23228 P&I - 23228 P&I.dwg

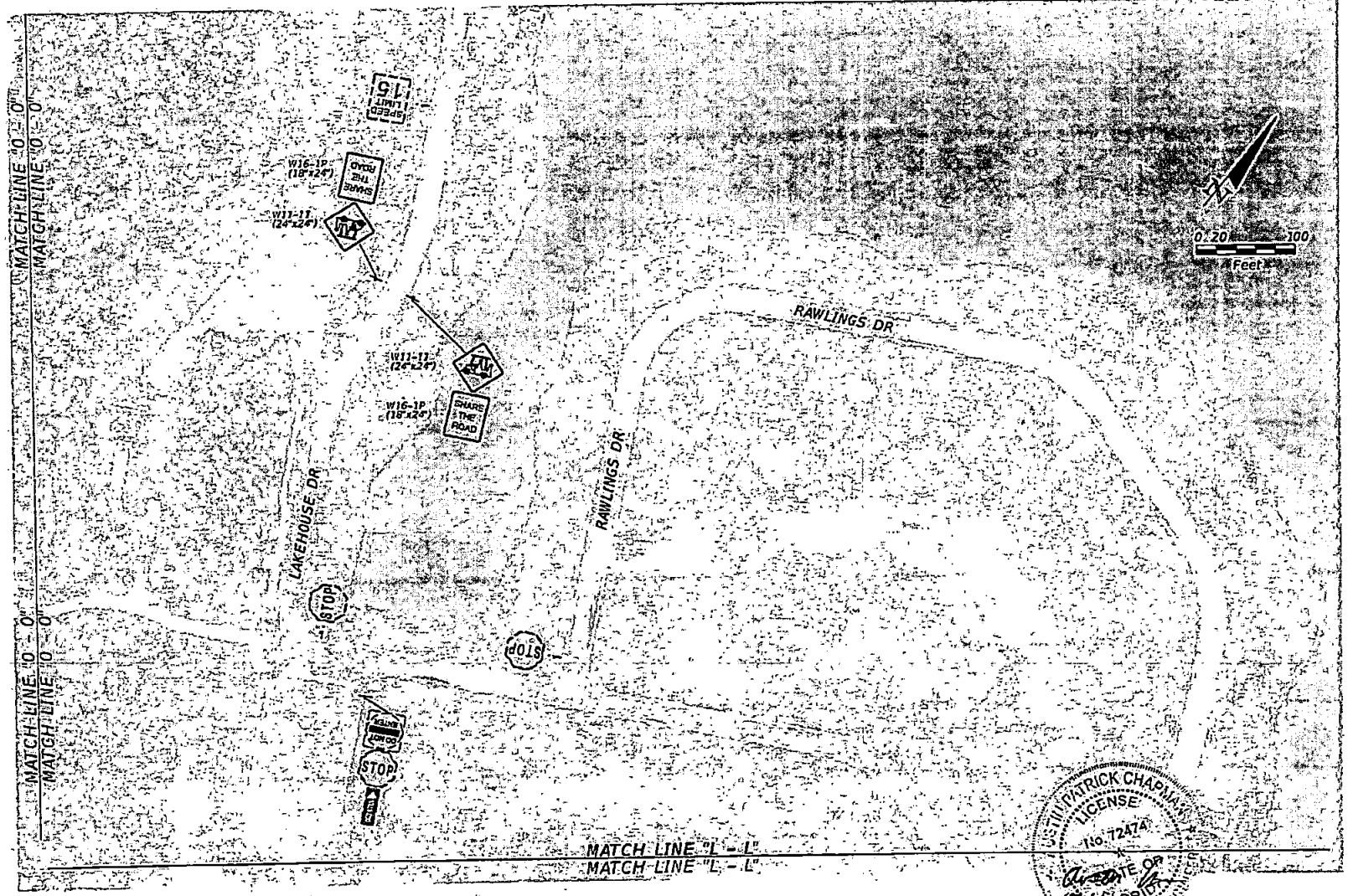

PROSSER
Community Management - Erosion Rehabilitation
13201 Sutton Park Drive South, Suite 200
Jacksonville, Florida 32224-0229
Office (904) 730-3555
Fax (904) 730-3413
www.prosserinc.com
Florida Certificate of Authorization
Number 12004-023

RIVERTOWN CART STUDY

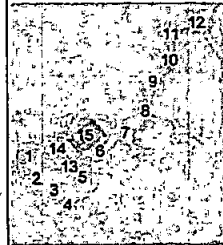

KEY MAP

DATE: 12-11-2017
 PROJECT NO.: 111004-04
 DESIGNED BY: JMS
 DRAWN BY: JEP
 SCALE: AS SHOWN

No.	Date	Revision

THIS DRAWING NOT RELEASED FOR CONSTRUCTION UNLESS SO NOTED ABOVE

SHEET TITLE

PATRICK CHAPMAN
LICENSE
11672474
STATE OF FLORIDA
PROFESSIONAL ENGINEER

APPENDIX B:
Projected Roadway Cart Law Map
Intersection Typical Signing and Marking

P:\1131309-01-RIVER-TOWN PROPERTY PLANNING & ENGINEERING SERVICES\CD01\CD01 CART EXHIBIT\2011-05-10 CD01 CART EXHIBIT.dwg 5/12/2011 3:34:18 PM

PROJECT NO.	1131309-01
DRAWING NO.	CD01
DATE	5/12/2011
SCALE	
DESIGNED BY	
CHECKED BY	
APPROVED BY	
LICENSE	

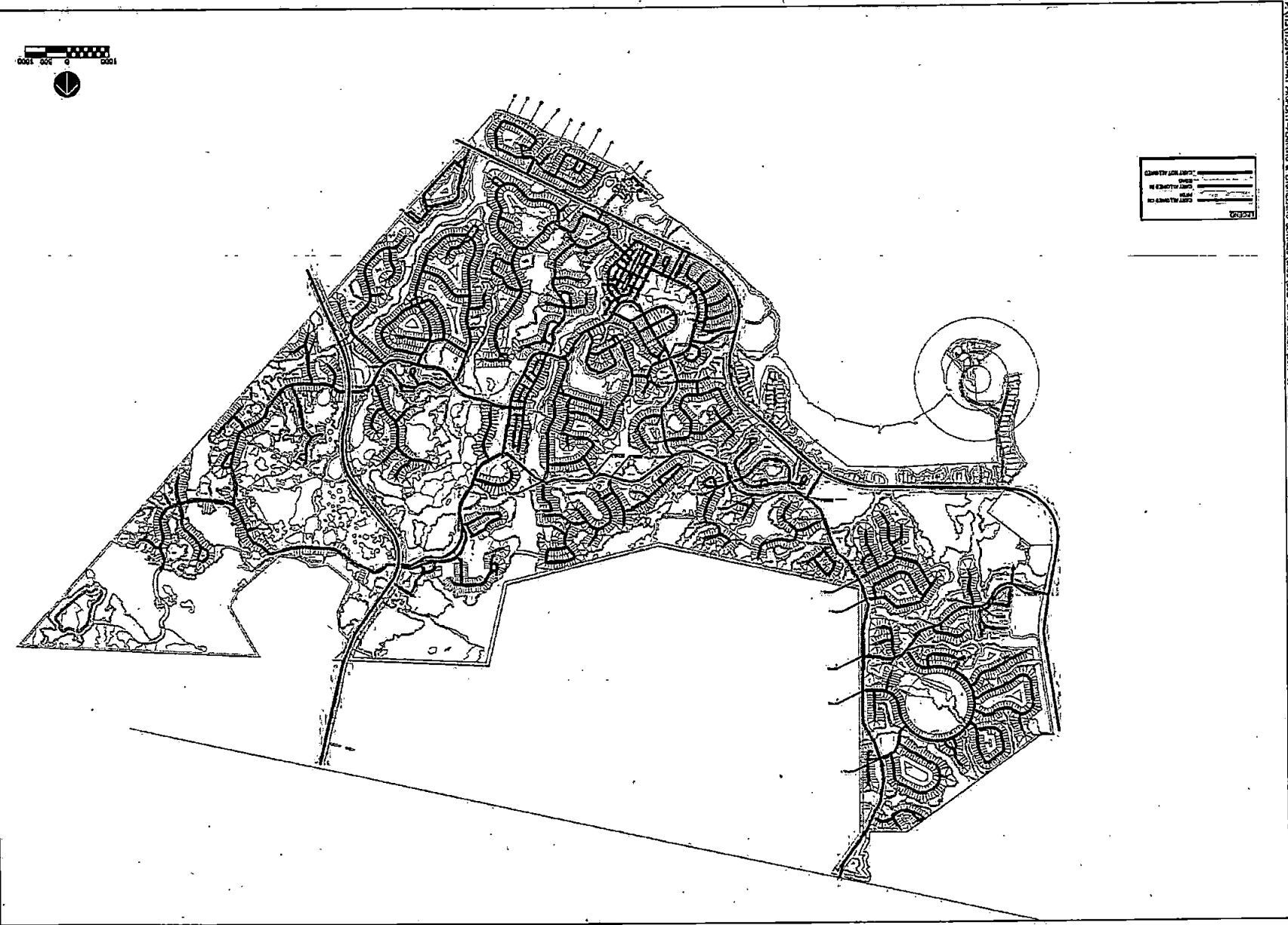

MAST:0
SHEET

GOLF CART EXHIBIT

PROJECT TITLE
AREA
THIS DRAWING WILL BE USED FOR
CONSTRUCTION UNLESS NOTED
OTHERWISE

DATE	DATE 2011
DRAWN BY	AK
CHECKED BY	AK
APPROVED BY	
PROJECT NO.	1131309-01
DRAWING NO.	CD01
DATE	5/12/2011
SCALE	
DESIGNED BY	
CHECKED BY	
APPROVED BY	
PROJECT TITLE	
AREA	
THIS DRAWING WILL BE USED FOR	
CONSTRUCTION UNLESS NOTED	
OTHERWISE	

GOLF CART EXHIBIT

PROSSER
CONSTRUCTION MANAGEMENT

1307 South Park Drive South, Suite 200
Alhambra, PA 19810-2222
OFFICE: 610.261.9555
FAX: 610.261.9170
www.prosser.com

Eastern Chapter of International
Franchise Development

RIVERTOWN
SOUTH PHOENIX

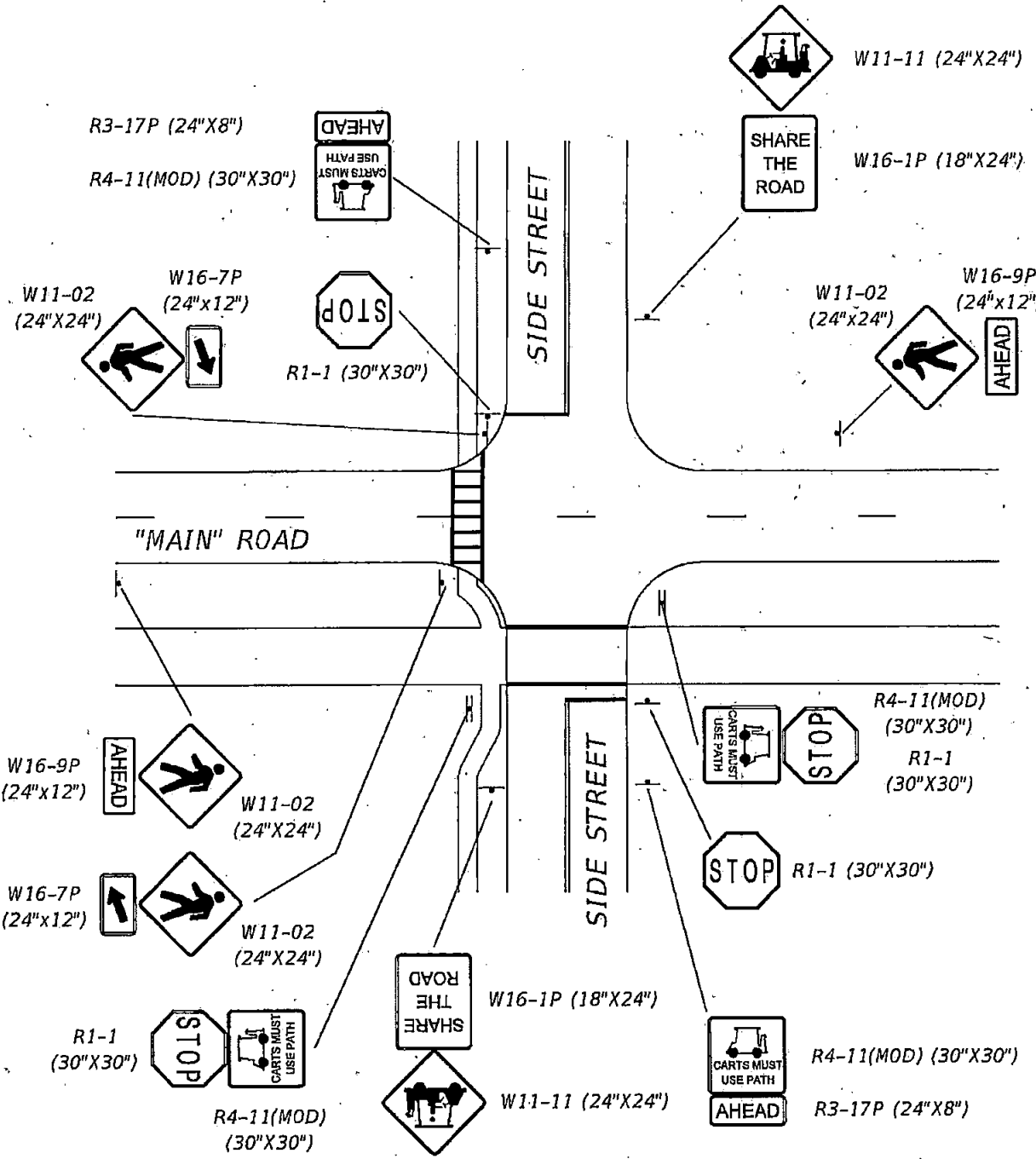

DETAIL 1

4 WAY CROSSING

FRONT OF SIGN

BACK OF SIGN

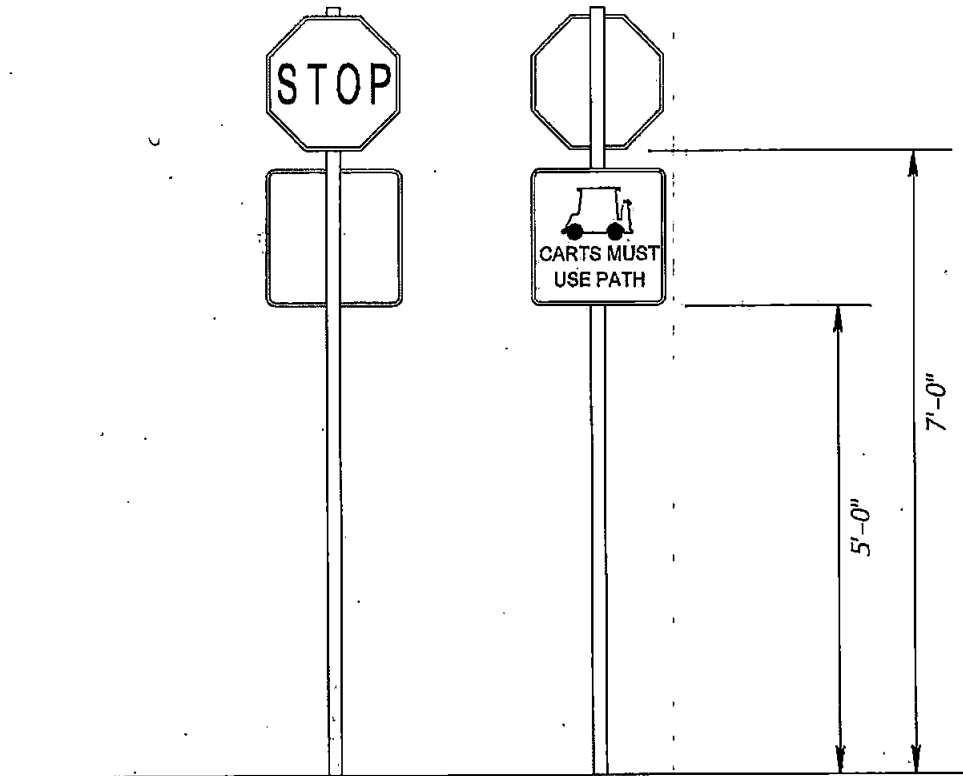

DETAIL 1A

MULTIPLE OPPOSING SIGNS

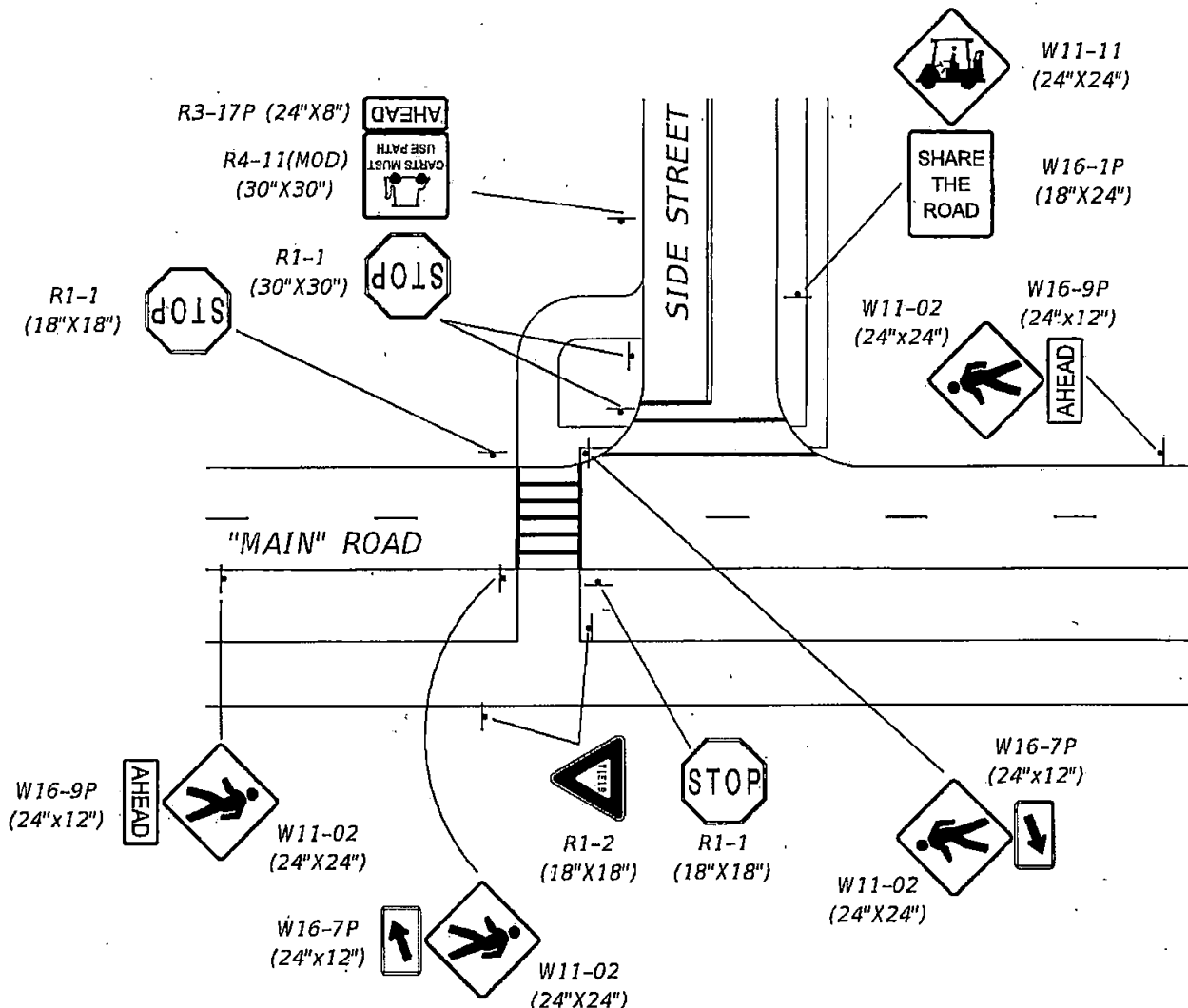

DETAIL 2
3 WAY CROSSING
(PATH OPPOSITE
SIDE STREET)

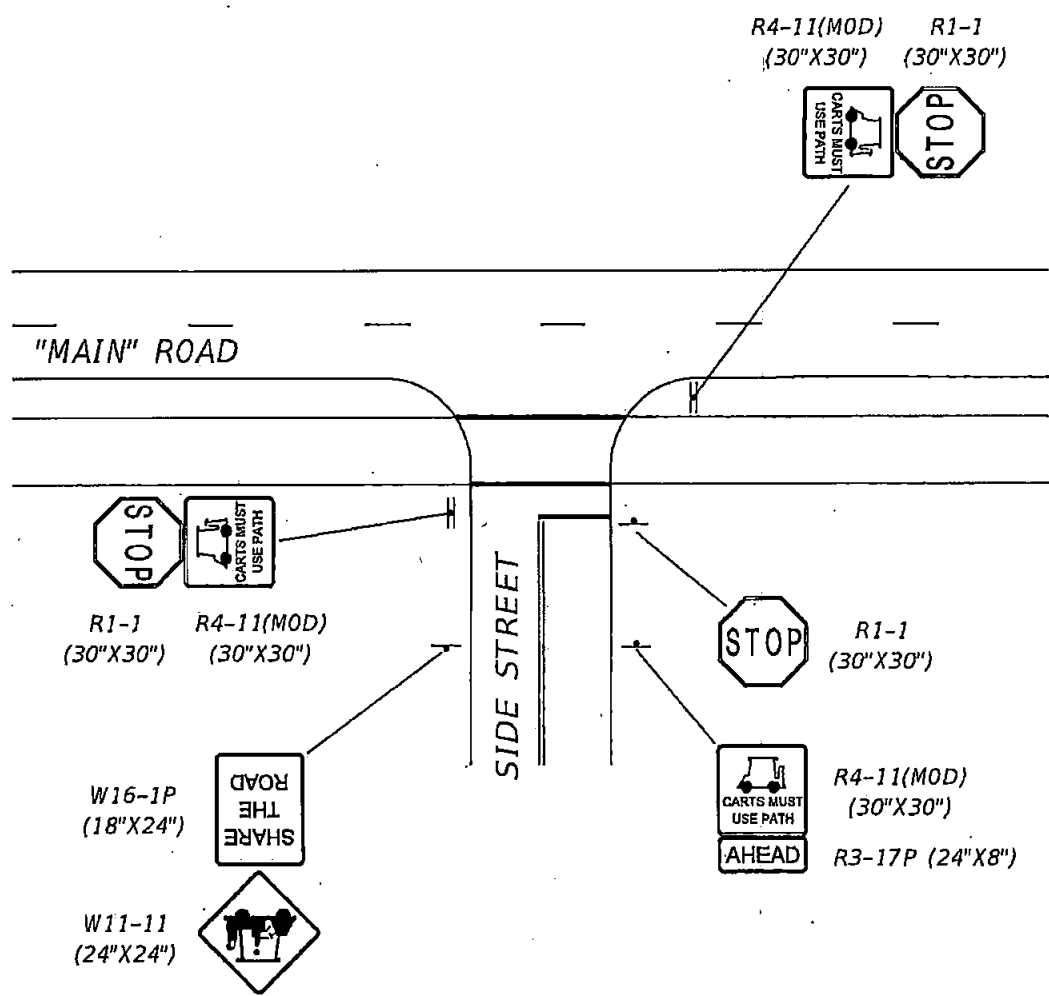

DETAIL 3
3 WAY CROSSING
(PATH ON SIDE STREET)

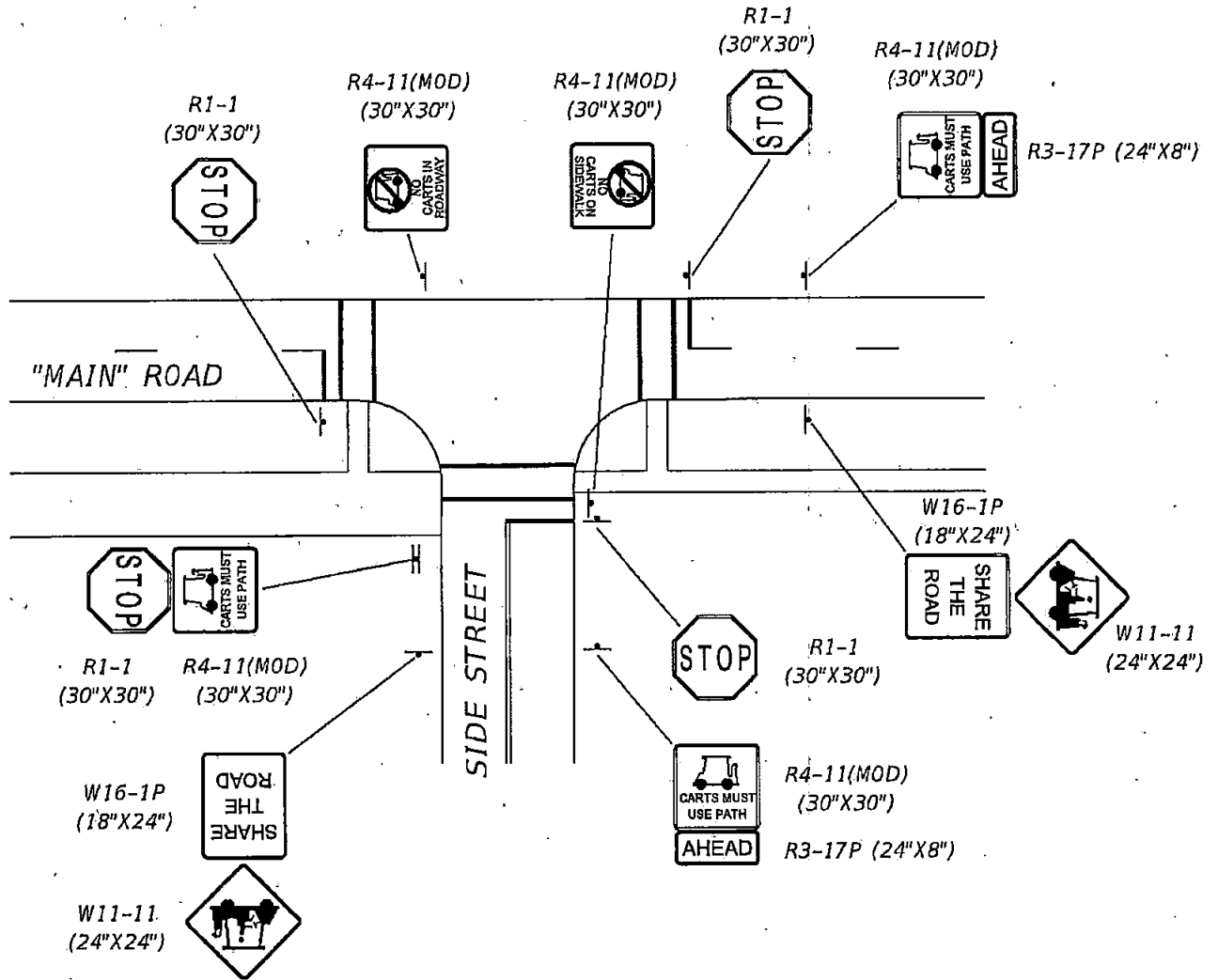

DETAIL 4

3 WAY CROSSING (CARTS ON ROADWAY)

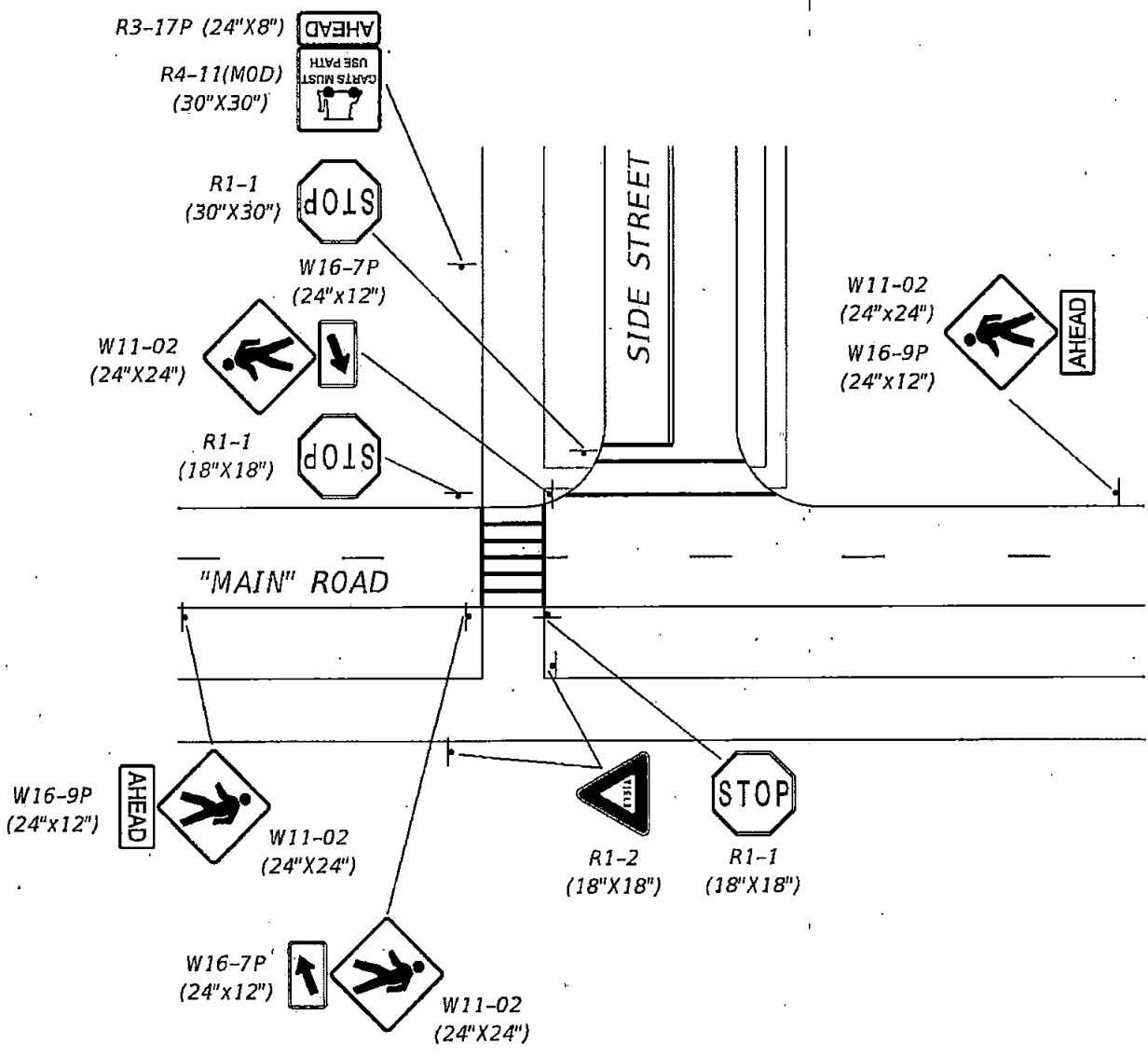

DETAIL 5
3 WAY CROSSING
(PATH OPPOSITE SIDE
STREET WITH PATH)

APPENDIX C:
List of Roads
Identifying Cart Law

ROAD NAMES	CARTS ON PATH /IN ROAD/NOT ALLOWED	TO/FROM
A	IN ROAD	ALL
A NORTH	IN ROAD	ALL
A SOUTH	IN ROAD	ALL
A WEST	IN ROAD	ALL
B	IN ROAD	ALL
C	IN ROAD	ALL
D	IN ROAD	ALL
E	IN ROAD	ALL
F	IN ROAD	ALL
G	IN ROAD	ALL
H	IN ROAD	ALL
I	IN ROAD	ALL
J	IN ROAD	ALL
K	IN ROAD	ALL
L	IN ROAD	ALL
M	IN ROAD	ALL
N	IN ROAD	ALL
O	IN ROAD	ALL
P	IN ROAD	ALL
Q	IN ROAD	ALL
R	IN ROAD	ALL
S	IN ROAD	ALL
T	IN ROAD	ALL
U	IN ROAD	ALL
V	IN ROAD	ALL
W	IN ROAD	ALL
X	IN ROAD	ALL
Y	IN ROAD	ALL
Z	NOT ALLOWED	ALL

ROAD NAMES		CARTS ON PATH /IN ROAD/NOT ALLOWED		TO/FROM
AA		IN ROAD		ALL
AB		IN ROAD		ALL
AC		IN ROAD		ALL
AD		IN ROAD		ALL
AE		IN ROAD		ALL
AF		IN ROAD		ALL
AG		IN ROAD		ALL
AH		IN ROAD		ALL
AI		IN ROAD		ALL
AJ		IN ROAD		ALL
AK		IN ROAD		ALL
AK SOUTH		IN ROAD		ALL
AL		IN ROAD		ALL
AM		IN ROAD		ALL
AN		IN ROAD		ALL
AO		IN ROAD		ALL
AP		IN ROAD		ALL
AQ		IN ROAD		ALL
AR		IN ROAD		ALL
AS		IN ROAD		ALL
AT		IN ROAD		ALL
AU		IN ROAD		ALL
AV		IN ROAD		ALL
AW		IN ROAD		ALL
AX		IN ROAD		ALL
AY		IN ROAD		ALL
AZ		IN ROAD		ALL

ROAD NAMES		CARTS ON PATH /IN ROAD/NOT ALLOWED		TO/FROM
BA		IN ROAD		ALL
BB		IN ROAD		ALL
BC		IN ROAD		ALL
BD		IN ROAD		ALL
BE		IN ROAD		ALL
BF		IN ROAD		ALL
BG		IN ROAD		ALL
BH		IN ROAD		ALL
BI		IN ROAD		ALL
BJ		IN ROAD		ALL
BK		IN ROAD		ALL
BL		IN ROAD		ALL
BM		IN ROAD		ALL
BN		IN ROAD		ALL
BO		IN ROAD		ALL
BP		IN ROAD		ALL
BQ		IN ROAD		ALL
BR		IN ROAD		ALL
BS		IN ROAD		ALL
BT		IN ROAD		ALL
BU		IN ROAD		ALL
BV		IN ROAD		ALL
BW		IN ROAD		ALL
BX		IN ROAD		ALL
BY		IN ROAD		ALL
BZ		IN ROAD		ALL

ROAD NAMES		CARTS ON PATH /IN ROAD/NOT ALLOWED		TO/FROM
CA		IN ROAD		ALL
CB		IN ROAD		ALL
CC		IN ROAD		ALL
CD		IN ROAD		ALL
CE		IN ROAD		ALL
CF		IN ROAD		ALL
CG		IN ROAD		ALL
CH		IN ROAD		ALL
CI		IN ROAD		ALL
CJ		IN ROAD		ALL
CK		IN ROAD		ALL
CL		IN ROAD		ALL
CM		IN ROAD		ALL
CN		IN ROAD		ALL
CO		IN ROAD		ALL
CP		IN ROAD		ALL
CQ		IN ROAD		ALL
CR		IN ROAD		ALL
CS		IN ROAD		ALL
CT		IN ROAD		ALL
CU		IN ROAD		ALL
CV		IN ROAD		ALL
CW		IN ROAD		ALL
CX		IN ROAD		ALL
CY		IN ROAD		ALL
CZ		IN ROAD		ALL

ROAD NAMES		CARTS ON PATH /IN ROAD/NOT ALLOWED		TO/FROM
DA		IN ROAD		ALL
DB		IN ROAD		ALL
DC		IN ROAD		ALL
DD		IN ROAD		ALL
DE		IN ROAD		ALL
DF		IN ROAD		ALL
DG		IN ROAD		ALL
DH		IN ROAD		ALL
DI		IN ROAD		ALL
DJ		IN ROAD		ALL
DK		IN ROAD		ALL
DL		IN ROAD		ALL
DM		IN ROAD		ALL
DN		IN ROAD		ALL
DO		IN ROAD		ALL
DP		IN ROAD		ALL
DQ		IN ROAD		ALL
DR		IN ROAD		ALL
DS		IN ROAD		ALL
DT		IN ROAD		ALL
DU		IN ROAD		ALL
DV		IN ROAD		ALL
DW		IN ROAD		ALL
DX		IN ROAD		ALL
DY		IN ROAD		ALL
DZ		IN ROAD		ALL

ROAD NAMES		CARTS ON PATH /IN ROAD/NOT ALLOWED		TO/FROM
EA		IN ROAD		ALL
EB		IN ROAD		ALL
EC		IN ROAD		ALL
ED		IN ROAD		ALL
EE		IN ROAD		ALL
EF		IN ROAD		ALL
EG		IN ROAD		ALL
EH		IN ROAD		ALL
EI		IN ROAD		ALL
EJ		IN ROAD		ALL
EK		IN ROAD		ALL
EL		IN ROAD		ALL
EM		IN ROAD		ALL
EN		IN ROAD		ALL
EO		IN ROAD		ALL
EP		IN ROAD		ALL
EQ		IN ROAD		ALL
ER		IN ROAD		ALL
ES		IN ROAD		ALL
ET		IN ROAD		ALL

ROAD NAMES		CARTS ON PATH /IN ROAD/NOT ALLOWED	TO/FROM
WATERFRONT DR.		IN ROAD	ALL
YEARLING BLVD.		IN ROAD	ALL
OLIVETTE ST.		IN ROAD	ALL
SECRET RIVER TRACE		IN ROAD	ALL
NARROWLEAF DR.		IN ROAD	ALL
CHERRY LAUREL PL.		IN ROAD	ALL
RAWLINGS DR.		IN ROAD	ALL
ORANGE BRANCH TRAIL		ON PATH	FROM: RIVERTOWN MAIN ST. TO: FOOTBRIDGE RD.
ORANGE BRANCH TRAIL		IN ROAD	FROM: FOOTBRIDGE RD. TO: KENDALL CROSSING DR.
ORANGE BRANCH TRAIL		ON PATH	FROM: KENDALL CROSSING DR. TO: RIVERTOWN MAIN ST.
RIVERTOWN MAIN ST.		ON PATH	ALL
KENDALL CROSSING DR.		IN ROAD	ALL
TARKLIN RD.		IN ROAD	ALL
ADLER PL.		IN ROAD	ALL
INDIAN GRASS DR.		IN ROAD	ALL
CABOT PL.		IN ROAD	ALL
BOX CAMP DR.		IN ROAD	ALL
CLOVERBROOK RD.		IN ROAD	ALL
KEENELAND RD.		IN ROAD	ALL
PINE BEACH DR.		IN ROAD	ALL
FOOTBRIDGE RD.		IN ROAD	ALL

ROAD NAMES	CARTS ON PATH /IN ROAD/NOT ALLOWED	TO/FROM
ALLEY T	IN ROAD	ALL
ALLEY S	IN ROAD	ALL
VENDURE ST.	IN ROAD	ALL
ALLEY R	IN ROAD	ALL
ALLEY P	IN ROAD	ALL
KEYSTONE CORNERS BLVD.	ON PATH	FROM:C.R. 244
		TO: ORANGE BRANCH TRAIL
KEYSTONE CORNERS BLVD.	IN ROAD	FROM: ORANGE BRANCH TRAIL
		TO: FOOTBRIDGE RD.
ALLEY M	IN ROAD	ALL
ALLEYK	IN ROAD	ALL
ALLEYL	IN ROAD	ALL
TWIN FLOWER PL.	IN ROAD	ALL
BROADLEAF LN.	IN ROAD	ALL
QUAILBERRY PL.	IN ROAD	ALL
ASHLAR DR.	IN ROAD	ALL
ELK GROVE LN.	IN ROAD	ALL
CALUMET DR.	IN ROAD	ALL
SORRELL CT.	IN ROAD	ALL
WHISTLING STRAITS DR.	IN ROAD	ALL
LANIER ST.	IN ROAD	ALL
MALLOW CT.	IN ROAD	ALL
STERNWHEEL DR.	IN ROAD	ALL
ALLEY 5P	IN ROAD	ALL
POTTER ST.	IN ROAD	ALL
MANTEO ST.	IN ROAD	ALL
ALLEY 4D	IN ROAD	ALL
ALLEY 3R	IN ROAD	ALL
ALLEY 3S	IN ROAD	ALL

ROAD NAMES	CARTS ON PATH /IN ROAD/NOT ALLOWED	TO/FROM
ALLEY 3X	IN ROAD	ALL
ALLEY 3Y	IN ROAD	ALL
RAMBLING WATER RUN	IN ROAD	ALL
ALLEY 3Q	IN ROAD	ALL
ALLEY 3V	IN ROAD	ALL
ALLEY 4B	IN ROAD	ALL
ALLEY 4A	IN ROAD	ALL
ALLEY 3B	IN ROAD	ALL
ALLEY 3Z	IN ROAD	ALL
ALLEY 3O	IN ROAD	ALL
BAYA ST.	IN ROAD	ALL
ALLEY 4C	IN ROAD	ALL
ALLEY HHHH	IN ROAD	ALL
ALLEY GGGG	IN ROAD	ALL
LANDING ST.	IN ROAD	ALL
CHIPOLA PL.	IN ROAD	ALL
BLACKWATER WAY	IN ROAD	ALL
SAPELO PL.	IN ROAD	ALL
COOSAW CT.	IN ROAD	ALL
EDISTO PL.	IN ROAD	ALL
PERDIDO ST.	IN ROAD	ALL

ROAD NAMES			TO/FROM
C.R. 244		NOT ALLOWED	ALL
S.R.-13		NOT ALLOWED	ALL
MA		ON PATH	FROM: RIVERTOWN MAIN ST. TO: SCHOOL ENTRY
MA		NOT ALLOWED	FROM: S.R.-13 TO: SCHOOL ENTRY
MB		ON PATH	FROM: RIVERTOWN MAIN ST. TO: SCHOOL ENTRY
MB		NOT ALLOWED	FROM: S.R.-13 TO: SCHOOL ENTRY
MC		IN ROAD	FROM: KENDALL CROSSING DR. TO: ROAD CZ
MC		NOT ALLOWED	FROM: S.R.-13 TO: ROAD CZ
RIVERTOWN BLVD.		NOT ALLOWED	ALL
RIVERWALK BLVD.		IN ROAD	ALL
RIVERGLADE RUN		NOT ALLOWED	ALL
SWAMP OAK TRAIL		IN ROAD	ALL
ZY		NOT ALLOWED	ALL
ZZ		NOT ALLOWED	ALL

EXHIBIT "C"
TRAFFIC CONTROL AGREEMENT
AFFIDAVIT

STATE OF FLORIDA
COUNTY OF ST. JOHNS

Before me the undersigned authority, personally appeared (print name)
Jason Sessions, who after being duly sworn, states as follows:

1. My name is (print name) Jason Sessions, my
position/title is (position/title with District/HOA) Chairman. I
base my statements in this affidavit on my personal knowledge.

2. To the best of my knowledge, all the roadways within the property
description attached as Exhibit A to the Traffic Control Agreement are owned by
(name of District/HOA) Rivers Edge CDD or SJC.

Further affiant sayeth not.

[Signature]
(affiant signature)

Subscribed and sworn (or affirmed) to me on (date) OCT 17, 2018, (print
name of affiant) JASON SESSIONS, who is personally known to me or
who has produced _____ as identification.

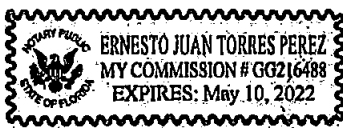

St Johns County
Notary Public, State of Florida

Ernesto J. Torres
ERNESTO J. TORRES
Print, type or stamp commissioned name of
Notary Public

Commission Number: GG216488
Commission Expires: May 10, 2022

EXHIBIT "D"
(ATTACH INSURANCE BINDER)



CERTIFICATE OF LIABILITY INSURANCE

DATE (MM/DD/YYYY)
10/29/2018

THIS CERTIFICATE IS ISSUED AS A MATTER OF INFORMATION ONLY AND CONFERS NO RIGHTS UPON THE CERTIFICATE HOLDER. THIS CERTIFICATE DOES NOT AFFIRMATIVELY OR NEGATIVELY AMEND, EXTEND OR ALTER THE COVERAGE AFFORDED BY THE POLICIES BELOW. THIS CERTIFICATE OF INSURANCE DOES NOT CONSTITUTE A CONTRACT BETWEEN THE ISSUING INSURER(S), AUTHORIZED REPRESENTATIVE OR PRODUCER, AND THE CERTIFICATE HOLDER.

IMPORTANT: If the certificate holder is an ADDITIONAL INSURED, the policy(ies) must have ADDITIONAL INSURED provisions or be endorsed. If SUBROGATION IS WAIVED, subject to the terms and conditions of the policy, certain policies may require an endorsement. A statement on this certificate does not confer rights to the certificate holder in lieu of such endorsement(s).

PRODUCER Egis Insurance & Risk Advisors 250 International Parkway Suite 260 Lake Mary FL 32746	CONTACT NAME: Kristina Rudez	
	PHONE (A/C, No, Ext): (321) 320-7885 FAX (A/C, No): E-MAIL ADDRESS: krudez@egisadvisors.com	
INSURED Rivers Edge Community Development District c/o Governmental Management Services 475 West Town Place, Suite 114 St. Augustine FL 32092	INSURER(S) AFFORDING COVERAGE	NAIC #
	INSURER A: Florida Insurance Alliance	
	INSURER B:	
	INSURER C:	
	INSURER D:	
	INSURER E:	

COVERAGES CERTIFICATE NUMBER: 18-19 Master Liab REVISION NUMBER:

THIS IS TO CERTIFY THAT THE POLICIES OF INSURANCE LISTED BELOW HAVE BEEN ISSUED TO THE INSURED NAMED ABOVE FOR THE POLICY PERIOD INDICATED. NOTWITHSTANDING ANY REQUIREMENT, TERM OR CONDITION OF ANY CONTRACT OR OTHER DOCUMENT WITH RESPECT TO WHICH THIS CERTIFICATE MAY BE ISSUED OR MAY PERTAIN, THE INSURANCE AFFORDED BY THE POLICIES DESCRIBED HEREIN IS SUBJECT TO ALL THE TERMS, EXCLUSIONS AND CONDITIONS OF SUCH POLICIES. LIMITS SHOWN MAY HAVE BEEN REDUCED BY PAID CLAIMS.

INSR LTR	TYPE OF INSURANCE	ADDL SUBR INSD WVD	POLICY NUMBER	POLICY EFF (MM/DD/YYYY)	POLICY EXP (MM/DD/YYYY)	LIMITS
A	<input checked="" type="checkbox"/> COMMERCIAL GENERAL LIABILITY <input type="checkbox"/> CLAIMS-MADE <input checked="" type="checkbox"/> OCCUR GEN'L AGGREGATE LIMIT APPLIES PER: <input type="checkbox"/> POLICY <input type="checkbox"/> PRO-JECT <input type="checkbox"/> LOC OTHER:	Y	100118551	10/01/2018	10/01/2019	EACH OCCURRENCE \$ 1,000,000 DAMAGE TO RENTED PREMISES (Ea occurrence) \$ Included MED EXP (Any one person) \$ 5,000 PERSONAL & ADV INJURY \$ Included GENERAL AGGREGATE \$ PRODUCTS - COM/PROP AGG \$ Included Employee Benefits Per \$ 1,000,000
A	AUTOMOBILE LIABILITY <input checked="" type="checkbox"/> ANY AUTO <input type="checkbox"/> OWNED AUTOS ONLY <input type="checkbox"/> SCHEDULED AUTOS <input checked="" type="checkbox"/> HIRED AUTOS ONLY <input checked="" type="checkbox"/> NON-OWNED AUTOS ONLY		100118551	10/01/2018	10/01/2019	COMBINED SINGLE LIMIT (Ea accident) \$ BODILY INJURY (Per person) \$ BODILY INJURY (Per accident) \$ PROPERTY DAMAGE (Per accident) \$
	UMBRELLA LIAB <input type="checkbox"/> OCCUR EXCESS LIAB <input type="checkbox"/> CLAIMS-MADE DED RETENTION \$					EACH OCCURRENCE \$ AGGREGATE \$
	WORKERS COMPENSATION AND EMPLOYERS' LIABILITY ANY PROPRIETOR/PARTNER/EXECUTIVE OFFICER/MEMBER EXCLUDED? (Mandatory in NH) If yes, describe under DESCRIPTION OF OPERATIONS below	Y/N	N/A			PER STATUTE <input type="checkbox"/> OTH-ER <input type="checkbox"/> E.L. EACH ACCIDENT \$ E.L. DISEASE - EA EMPLOYEE \$ E.L. DISEASE - POLICY LIMIT \$
A			100118551	10/01/2018	10/01/2019	

DESCRIPTION OF OPERATIONS / LOCATIONS / VEHICLES (ACORD 101, Additional Remarks Schedule, may be attached if more space is required)

Certificate Holder is Included as an Additional Insured per contract. Note: The most we will pay is further limited by the limitation set forth in Section 768.28(5), Florida Statutes (2010) or equivalent limitations of successor law which are applicable at the time of loss.

CERTIFICATE HOLDER St Johns County & St. Johns County Sheriff's Office 4015 Lewis Speedway St. Augustine FL 32084	CANCELLATION SHOULD ANY OF THE ABOVE DESCRIBED POLICIES BE CANCELLED BEFORE THE EXPIRATION DATE THEREOF, NOTICE WILL BE DELIVERED IN ACCORDANCE WITH THE POLICY PROVISIONS.
	AUTHORIZED REPRESENTATIVE 

© 1988-2015 ACORD CORPORATION. All rights reserved.