

RESOLUTION 2020 - 1060

A RESOLUTION OF THE BOARD OF COUNTY COMMISSIONERS OF ST. JOHNS COUNTY, FLORIDA, AMENDING THE FISCAL YEAR 2020 BUDGET TO RECEIVE UNANTICIPATED REVENUE; AND AUTHORIZING ITS APPROPRIATION AND EXPENDITURE BY THE ST. JOHNS COUNTY PARKS AND RECREATION DEPARTMENT

WHEREAS, the Parks and Recreation Department has established a process by which athletic organizations or individuals may propose modifications or improvements to County-owned recreation facilities; and

WHEREAS, the process involves submitting a Facility Modification form that includes a detailed description of the project, quotes for completion of the work and a donation of funding to complete the work; and

WHEREAS, as Ponte Vedra Baseball has donated \$13,200.00 to the County's Park Improvement Association Fee budget line to the FY20 General Fund; and

WHEREAS, a re-appropriation of the donated funds from the respective FY20 Park Improvement Association Fee budget line is necessary to complete the proposed modifications/improvements described herein.

NOW THEREFORE, BE IT RESOLVED by the Board of County Commissioners of St. Johns County, Florida, that:

1. The above recitals are incorporated by reference into the body of this Resolution, and such recitals are adopted as findings of fact.
2. The Board hereby authorizes the transfer of \$13,200.00 from 0001-34792, Park Improvement Association Fee and the appropriation of these funds to line 0080-55200, Operating Supplies for the purchase and installation of 400' of chainlink fence for the outfield at Davis Park Baseball Fields.
3. To the extent that there are typographical or administrative errors that do not change the tone, tenor or concept of this Resolution, then this Resolution may be revised without subsequent approval by the Board.

PASSED AND ADOPTED by the Board of County Commissioners of St. Johns County, State of Florida, this 5th day of May, 2020.

**BOARD OF COUNTY COMMISSIONERS
OF ST. JOHNS COUNTY, FLORIDA**

By: Jeb S. Smith
Jeb S. Smith, Chair

ATTEST: Brandon Patty

By: Pam Halteman
Deputy Clerk

Rendition Date: 5/7/20



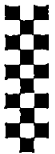

ATT
Eddie

WISEMAN FENCE & MORE, L.L.C.

P.O. Box 860166, St. Augustine, FL 32086
(904) 669-9741

P.O.#		PHONE		DATE		
		209-0333		2-1-2020		
NAME						
St John's Co Parks + Rec. Dept						
ADDRESS						
Davis PK						
SOLD BY	CASH	C.O.D.	CHARGE	ON ACCT.	MDSE. RETD.	PAID OUT
QTY.	DESCRIPTION				PRICE	AMOUNT
400'	APPROX 10' GA All galvanized Chain Link Fence with 5x12' DD GATE					\$13,200.00
					TOTAL	\$13,200.00

WOOD FENCE
STYLE _____
HEIGHT _____
GRADE _____

CHAIN LINK
HEIGHT 10'
GAUGE 6
TOP RAIL 1 5/8 S20
LINE POST 2 1/2 S40
CORNER POST 3" S40
END POST _____
GATE POST 4" S40
GATE FRAME 1 5/8 S20

- INSTALLATION INSTRUCTIONS**
- TOP OF FENCE TO FOLLOW GROUND
 - BE LEVEL WITH HIGHEST GRADE
 - FINISHED SIDE IN
 - FINISHED SIDE OUT
 - CLEARING
 - TREE ON LINE
 - BURIED CABLE
 - UNDERGROUND OBSTRUCTIONS
 - KNUCKLE TWIST
- OTHER (Explain) POST ON 8' CENTERS
coil wire on bottom

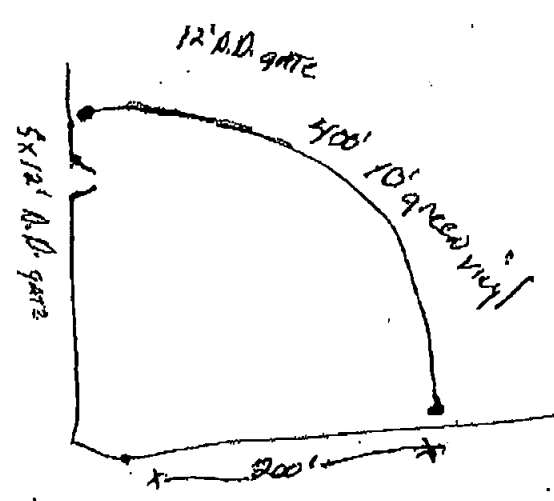

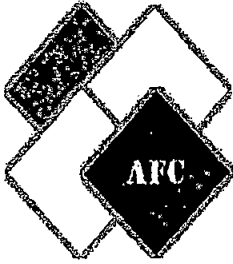

ARMSTRONG FENCE CO

Securing The Southeast

COMMERCIAL INDUSTRIAL RENT-A-FENCE RESIDENTIAL

March 18, 2020

FENCE QUOTE

To: ST JOHNS COUNTY PARKS AND RECREATION

Re: DAVIS PARK / FIELD #6 / OUTFIELD FENCE

Subject: FENCE QUOTE

Armstrong Fence Co a leader in perimeter security throughout the Southeastern United States intends to submit a bid for subject project. The scope of work is to furnish and install as per **PLANS AND SPECIFICATIONS** the following:

OUTFIELD FENCE:

- TO INCLUDE:
- 1) Provide and Install (370') of 10' tall green vinyl coated chain link fence with a top rail and bottom tension wire.
- 2) Provide and Install (1) 12'x5' double swing gate with an industrial drop rod assembly. 2" gate frame.
- 3) Chain link to be 6-gauge finish (9-gauge core), 2" mesh, knuckled on both ends.
- 4) Top rail to be 1 5/8" SCH-40, per specs.
- 5) Line posts to be 2 3/8" (or 2 1/2"), SCH-40, per specs.
- 6) Terminal/Corner posts to be 2 7/8" (or 3"), SCH-40, per specs.
- 7) Gate posts to be 2 7/8" (or 3"), SCH-40, per specs.
- 8) Bottom tension wire to be 7-gauge, per specs.
- 9) Line post to be set in 10"x36" concrete footers.
- 10) Corner/terminal posts to be set in 12"x48" concrete footers.
- 11) Line posts to be set/installed 8' on center, per specs.
- 12) Price includes the use of machinery in order to install fencing materials.

TOTAL BASE COST --\$14,980.36

- Add on cost for additional 1 5/8" SCH-40 middle rail - \$2,755.24 (RECOMMENDED)
- Add on cost for a poly cap fence top protector - \$2,359.88 (TYPICAL)

TOTAL COST WITH BOTH ADD ON'S --\$20,095.48

- This quote is only good through May 1st, 2020
- Standard Exclusions: Removal, Staking, Grading, Grounding, Clearing, Bollards, Intercom Devices, *Intercom Wiring & Conduits, High & Low Voltage Wiring / Conduits, Concrete* (other than post foundations), any other item not specifically listed, and Padlocks.

Accepted by

Date

Dylan Pate
Armstrong Fence Co
2795 US 1 South
St Augustine, FL, 32086
Phone: 904-287-8177
Cell: 904-508-2604
Email: dpate@armstrong-fence.com



Quote

Total Pages: 1

Co: St. Johns County Parks & Rec	Date: 4/3/2020
To: Mr. Jimmerson	From: Spencer -- Newsom Fence
Email: EJimmerson@sicfl.us	Re: Davis Park Field 6 -- Outfield Fence

Special Conditions: Proposal valid for 30 days. All fence pricing is based on a **clear and accessible fence line**, all grounding of fence, if required, by others at no cost to Newsom Fence unless stated in this quote. Not responsible for any unmarked irrigation lines. **Note: This quote based on our insurance coverages.**

Newsom Fence will install a 10' high green chain link outfield fence. The new outfield fence will tie into the existing fence along the foul lines. We will band off the existing fence to the new outfield fence.

This quote is based on the dimensions of the outfield fence being 210' and 190' down the lines and 220' in center field.

Newsom Fence will cut in a 12' wide double swing gate in the existing fence along the foul line as requested. The gate will have a lockable center drop bar. The material on the double swing gate will match the surrounding fence material along the foul line.

All the outfield fencing will be green. A top rail and bottom tension wire will be installed along the entire fence. The corner posts will be braced. All the posts will be set in concrete. All material will be full weight commercial grade.

- Chain Link Wire: 6 gauge vinyl coated finish w/ a 9 gauge galvanized core wire
- Top Rail: 1 5/8" diameter s40 weight
- Line Post: 2 1/2" diameter s40 weight
- Corner Post: 3" diameter s40 weight
- Brace Rail: 1 5/8" diameter s40 weight
- Bottom Tension Wire: 6 gauge spring coiled
- Tie Wires: vinyl coated 9 gauge galvanized steel

Total: \$16,000.00