

23

**AGENDA ITEM  
ST. JOHNS COUNTY BOARD OF COUNTY COMMISSIONERS**

*Deadline for Submission - Wednesday 9 a.m. – Thirteen Days Prior to BCC Meeting*

**5/7/2024**

**BCC MEETING DATE**

**TO:** Joy Andrews, County Administrator

**DATE:** April 8, 2024

**FROM:** Jaime Locklear, Director of Purchasing

**PHONE:** 904 209-0158

**SUBJECT OR TITLE:** Piggyback Florida Sheriff's Association Contract to Purchase Two (2) Ambulances

**AGENDA TYPE:** Consent Agenda, Contract, Resolution

**BACKGROUND INFORMATION:**

SJC Fire Rescue's FY24 budget includes funding for the purchase of two (2) ambulances to replace aging rescue units in the Fire Rescue Fleet. SJC Fire Rescue has requested to purchase two (2) 2025 Braun Chief XL Ford F550 4x2 gas ambulances. These Ambulances will replace Rescue 2 - 2018 Ram 4500, CV# 1955, which has 168686 miles, and Rescue 41 - 2018 Ram 4500, CV# 1956, which has 135996 miles. These two rescue units are in need of replacement due to the high mileage and they're positioned at two stations which see the longest drive times. The New Ambulances will be used and located at Fire Station #2 and Fire Station #14. The replaced units will be placed into Fire Rescue's spare fleet. The requested units are available under the Florida Sheriff's Association Contract #FSA23-VEF17.01, Specification Item #490. The SJC Purchasing Policy section 6.2.13, provides for the use of piggybacking in lieu of a competitive selection process, where such contracts are procured by an Entity using a full and open competitive selection process. Staff recommends Board approval to piggyback Florida Sheriff's Association Contract #FSA23-VEF17.0, for the purchase of the two (2) specified ambulances from Ten-8 Fire Equipment, Inc for a total purchase price of \$632,580.00 in accordance with the terms of the contract. A purchase order will be issued upon Board approval to execute the purchase.

**1. IS FUNDING REQUIRED?** Yes

**2. IF YES, INDICATE IF BUDGETED.** Yes

**IF FUNDING IS REQUIRED, MANDATORY OMB REVIEW IS REQUIRED:**

**INDICATE FUNDING SOURCE:** FY 24- Fire Rescue Department - Capital Vehicles (0048-56415)

**SUGGESTED MOTION/RECOMMENDATION/ACTION:**

Motion to adopt Resolution 2024-\_\_\_\_\_, authorizing the County Administrator, or designee, to piggyback Florida Sheriff's Association Contract #FSA23-VEF17.01, and to issue a purchase order for the purchase of two (2) ambulances, as specified herein, from Ten-8 Fire Equipment, Inc, for a total purchase price of \$632,580.00 in accordance with the terms of the contract.

**For Administration Use Only:**

**Legal:** Jalisa Ferguson 4/19/2024

**OMB:** ARM 4/22/2024

**Admin:** Colin Groff 4/22/2024

RESOLUTION NO. 2024 - \_\_\_\_\_

**A RESOLUTION BY THE BOARD OF COUNTY COMMISSIONERS OF ST. JOHNS COUNTY, FLORIDA, AUTHORIZING THE COUNTY ADMINISTRATOR, OR DESIGNEE, TO PIGGYBACK THE FLORIDA SHERIFF'S ASSOCIATION CONTRACT NO: FSA23-VEF17.0 AND TO EXECUTE A PURCHASE ORDER TO PURCHASE TWO (2) AMBULANCES, AS SPECIFIED, FROM TEN-8 FIRE EQUIPMENT, INC IN ACCORDANCE WITH THE TERMS OF THE CONTRACT.**

**RECITALS**

**WHEREAS**, SJC Fire Rescue budgeted in FY24 for the purchase of two (2) Braun Chief XL 4x2 gas ambulances and

**WHEREAS**, the County seeks to purchase two (2) Braun Chief XL Ford F-550 4x2 Gas Ambulances from Ten-8 Fire Equipment, Inc, under the Florida Sheriff's Association Contract No: FS23-VEF17.0, under specifications item # 490; and

**WHEREAS**, Section 6.2.13 of the St. Johns County Purchasing Policy, provides for the use of piggybacking in lieu of a competitive selection process, where such contracts are procured using a full and open competitive selection process, and

**WHEREAS**, staff has reviewed the Contract, which has been competitively procured and complies with SJC Purchasing Policy, and finds that piggybacking off the Contract for purchase of the ambulances serves a public purpose.

**NOW, THEREFORE BE IT RESOLVED BY THE BOARD OF COUNTY COMMISSIONERS OF ST. JOHNS COUNTY, FLORIDA**, as follows:

Section 1. The above Recitals are incorporated by reference into the body of this Resolution and such Recitals are adopted as finds of fact.

Section 2. The County Administrator, or designee, is hereby authorized to piggyback the Florida Sheriff's Association Contract No: FSA23-VEF17.0 for the purchase of two (2) specified ambulances.

Section 3. Upon Board approval, the County Administrator or designee is further authorized to issue a purchase order in the amount of \$632,580.00 to Ten-8 Fire Equipment, Inc. for the purchase.

Section 4. To the extent that there are typographical and/or administrative errors that do not change the tone, tenor, or concept of this Resolution, then this Resolution may be revised without subsequent approval by the Board of County Commissioners.

**PASSED AND ADOPTED** by the Board of County Commissioners of St. Johns County, Florida, on this \_\_\_\_\_ day of \_\_\_\_\_, 2024.

**BOARD OF COUNTY COMMISSIONERS OF ST. JOHNS COUNTY, FLORIDA**

By: \_\_\_\_\_  
Sarah Arnold, Chair

**ATTEST: Brandon J. Patty,**  
**Clerk of Circuit Court & Comptroller**

By: \_\_\_\_\_  
Deputy Clerk



**Equipment Proposal**

**Proposal # 5472-2**

This Equipment Proposal (the "Proposal") has been prepared by Ten-8 Fire & Safety, LLC ("Company") in response to the undersigned Customer's request for a proposal. This Proposal is comprised of the special terms set forth below, the Proposal Option List, Warranty, and Company's Purchasing Terms and Conditions. Through its signature below or other Acceptance (as defined below), Customer acknowledges having received, read and being bound by this Proposal, all attachments and Company's Purchasing Terms and Conditions.

**Date:** April 9, 2024 ("Proposal Date")

**Customer:** St Johns County Fire Rescue ("Customer")

**Customer Address:** 3657 Gaines Road St Augustine, FL 32804

Qty	Product Description & Options	Price
2	Braun Chief XL on F550 4x2 gas FSA23-VEF17.0 Item #490	\$305,993
	Options added to base. Per attached option list	\$10,297
**Commercial chassis price is an estimate; final price is net price charged by the chassis manufacturer.		<b>Total: \$632,580</b>

**Delivery Timing:** The Product described above in the Product Description and Options Section of this document will be built by and shipped from the manufacturer approximately **24** (months) after Company receives Customer's acceptance of this Proposal as defined below, subject to market and production conditions, Force Majeure, delays from the chassis manufacturer, changes to Order Specifications, or any other circumstances or cause beyond Company's or manufacturer's control.

**Other: Contingent upon receipt of chassis**

Unless accepted within **30** days from date of proposal, the right is reserved to withdraw this proposal.

ACCEPTANCE OF THIS PROPOSAL CREATES AN ENFORCEABLE BINDING AGREEMENT BETWEEN COMPANY AND CUSTOMER. "ACCEPTANCE" MEANS THAT CUSTOMER DELIVERS TO COMPANY: (A) A PROPOSAL SIGNED BY AN AUTHORIZED REPRESENTATIVE, OR (B) A PURCHASE ORDER INCORPORATING THIS PROPOSAL, WHICH IS DULY APPROVED, TO THE EXTENT APPLICABLE, BY CUSTOMER'S GOVERNING BOARD. ACCEPTANCE OF THIS PROPOSAL IS EXPRESSLY LIMITED TO THE TERMS CONTAINED IN THIS PROPOSAL AND COMPANY'S PURCHASING TERMS AND CONDITIONS. ANY ADDITIONAL OR DIFFERENT TERMS, WHETHER CONTAINED IN CUSTOMER'S FORMS OR OTHERWISE PRESENTED BY CUSTOMER AT ANY TIME, ARE HEREBY REJECTED.

**INTENDING TO CREATE A BINDING AGREEMENT**, Customer and Company have each caused this Proposal to be executed by their duly authorized representatives as of date of the last signature below.

**Customer:** St Johns County Fire Rescue

**Ten-8 Fire & Safety, LLC**

By: \_\_\_\_\_

By: 

Title: \_\_\_\_\_

Title: **Authorized Sales Representative**

Print: \_\_\_\_\_

Print: **Eric Wilcox**

Date: \_\_\_\_\_

Date: **4-9-24**

<u>Description</u>	<u>Part #</u>	<u>Price</u>
FENDERETTES - RUBBER	40-10-0104	\$ 357.00
BUSS BAR, 30AMP Install one (1) 30.	SR00169063	\$ 106.00
GRAPHICS PACKAGE PER LAYOUT Gr	SR00169064	\$ 3,971.00
PAINT, CAB AND MODULE / BUFFIN	SR00169077	\$ 4,792.00
OSS#2 COMPARTMENT. Compartme	SR00169082	\$ 140.00
MONITOR MOUNT, TECHNIMOUNT	SR00169089	\$ 163.00
INTERCOM SYSTEM - FIRE RESEARCH	SR00169091	\$ 1,183.00
GLOVE DISPENSER - (3) BOX - ABOVI	SR00169095	\$ 446.00
Install red LED strip lights on either	SR00169881	\$ 956.00
The front wall interior cabinet #1, fli	SR00170487	\$ 665.00
Add One (1) yellow anti-microbial as	SR00184645	\$ 345.00
CAMERA REAR VIEW - SINGLE SYSTE	30-10-0068	\$ 766.00
CAMERA PATIENT AREA SINGLE SYS	30-10-0069	\$ 766.00
CLOCK - FRANKLIN DIGITAL - REAR H	50-60-0099	\$ 1,045.00
HVAC - COMPRESSOR - SECONDARY HVAC_EC_02		\$ 2,826.00
INVERTER, VANNER - 1100 WATT, LI	30-10-0258	\$ 1,098.00
OSS #1 - EZ-O2 LIFT OXYGEN SYSTEM	OS1XL10P7	\$ 1,970.00
Change to Gas chassis	99-99-9999	\$ (11,298.00)
		\$ 10,297.00
F550 4x2 Diesel FSA item # 490		\$ 305,993.00
Total		\$316,290.00

## PURCHASING TERMS AND CONDITIONS

These Purchasing Terms and Conditions, together with the Equipment Proposal and all attachments (collectively, the “Agreement”) are entered into by and between Ten-8 Fire & Safety, LLC, a Florida company (“Company”) and Customer (as defined in Ten-8 Fire & Safety LLC’s Equipment Proposal document) and is effective as of the date specified in Section 3 of these Purchasing Terms and Conditions. Both Company and Customer may be referred throughout this document individually as a “party” or collectively as the “parties.”

### 1. Definitions.

- a. **“Acceptance”** has the same meaning set forth in Company’s Equipment Proposal.
- b. **“Company’s Equipment Proposal”** means the Equipment Proposal provided by Company and prepared in response to Customer’s request for proposal for a fire apparatus, associated equipment or an ambulance.
- c. **“Cooperative Purchasing Contract”** means an Agreement between Company and a public authority, including without limitation, a department, division, agency of a municipal, county or state government (“Public Authority”), that adopts or participates in an existing agreement between Company and another non-party customer (including, but not limited to such non-party customer’s equipment proposal, its applicable exhibits, attachments and purchasing terms and conditions), often referred to as a “piggyback arrangement,” which is expressly agreed to, in writing, by Company. Company has sole discretion to determine whether it will agree to such a Cooperative Purchasing Contract.
- d. **“Delivery”** means when Company delivers physical possession of the Product to Customer.
- e. **“Manufacturer”** means the Manufacturer of any Product.
- f. **“Prepayment Discount”** means the prepayment discounts, if any, specified in Company’s Equipment Proposal.
- g. **“Product”** means the fire apparatus and any associated equipment, or ambulance manufactured or furnished for Customer by Company pursuant to the Specifications.
- h. **“Purchase Price”** means the Total price set forth in the Quotation, adjusted for the final net price for the chassis charged by the original equipment manufacturer set forth in the final invoice submitted to the Company by the manufacturer.
- i. **“Purchasing Terms and Conditions”** means these Purchasing Terms and Conditions; however, if the Company’s Equipment Proposal or the Customer’s related Purchase Order states that it is governed by a Cooperative Purchasing Agreement, “Purchasing Terms and Conditions” shall mean those terms and conditions set forth in the applicable Cooperative Purchasing Agreement.
- j. **“Specifications”** means the general specifications, technical specifications, training, and testing requirements for the Product contained in Company’s Equipment Proposal and its Exhibit A (Proposal Option List or for ambulance sales, the Quotation, or Order Form, as applicable), prepared in response to Customer’s request for such a proposal.

2. Purpose. This Agreement sets forth the terms and conditions of Company’s sale of the Product to Customer.

3. Term of Agreement. This Agreement will become effective on the date of Acceptance as defined in Company’s Equipment Proposal (“Effective Date”) and, unless earlier terminated pursuant to the terms of this Agreement, it will terminate upon Delivery and payment in full of the Purchase Price.

4. Purchase and Payment. Customer agrees to pay Company the Purchase Price for the Product(s). The Purchase Price is in U.S. dollars. Where Customer opts for a Prepayment Discount that specifies that Customer will tender one or more prepayments to Company, Customer must provide each prepayment within the time frame specified in the Equipment Proposal in order to receive the Prepayment Discount for that prepayment installment. To the extent permitted by applicable law, Company may in its sole discretion charge a convenience fee if Customer elects to pay the Purchase Price by means of a credit card.

5. Representations and Warranties. Customer hereby represents and warrants to Company that the purchase of the Product(s) has been approved by Customer in accordance with applicable general laws and, as applicable, Customer’s charter, ordinances and other governing documents, and funding for the purchase has been duly budgeted and appropriated.

6. Cancellation/Termination.

- a. Fire Equipment and Apparatus Sales. In the event this Agreement is cancelled or terminated by Customer before completion, Company may charge Customer a cancellation fee. The following charge schedule is based on costs incurred by Manufacturer and Company for the Product, which may be applied and charged to Customer: (a) 12% of the Purchase Price after the order for the Product(s) is accepted and entered into Manufacturer's system by Company; (b) 22% of the Purchase Price after completion of approval drawings by Customer, and; (c) 32% of the Purchase Price upon any material requisition made by the Manufacturer for the Product. The cancellation fee will increase in excess of (c) in this Section 6, accordingly, as additional costs are incurred by Manufacturer and Company as the order progresses through engineering and into the manufacturing process.
- b. Ambulance Sales. This Section 6 for Cancellation/Termination does not apply to Ambulance Sales. An order for an ambulance cannot be cancelled or terminated once Company receives and processes Customer's Acceptance of Company's Equipment Proposal.

7. Delivery. The Product is scheduled to be delivered as specified in the Delivery Timing section of the Equipment Proposal ("Delivery Timing"), which will be F.O.B. Company's facility. The Delivery Timing is an estimate, and Company is not bound to such date unless it otherwise agrees in writing. Company is not responsible for Delivery delays caused by or as the result of actions, omissions or conduct of the Manufacturer, its employees, affiliates, suppliers, contractors, and carriers. All right, title and interest in and to the Product, and risk of loss, shall pass to Customer upon Delivery of the Product(s) to Customer.

8. Standard Warranty. The manufacturer warranties applicable to this Agreement, if any, are attached to Company's Equipment Proposal as Exhibit A and are incorporated herein as part of the Agreement.

a. Disclaimer. EXCEPT AS OTHERWISE SET FORTH IN THIS AGREEMENT, COMPANY, INCLUDING ITS PARENT COMPANY, AFFILIATES, SUBSIDIARIES, AND THEIR RESPECTIVE OFFICERS, DIRECTORS, EMPLOYEES, SHAREHOLDERS, AGENTS OR REPRESENTATIVES DO NOT MAKE ANY REPRESENTATIONS OR WARRANTIES, EXPRESS OR IMPLIED, WITH RESPECT TO THE PRODUCTS PROVIDED UNDER THIS AGREEMENT, WHETHER ORAL OR WRITTEN, EXPRESS, IMPLIED OR STATUTORY. WITHOUT LIMITING THE FOREGOING DISCLAIMER, ANY IMPLIED WARRANTY OR CONDITION OF MERCHANTABILITY, IMPLIED WARRANTY AGAINST INFRINGEMENT, AND IMPLIED WARRANTY OR CONDITION OF FITNESS FOR A PARTICULAR PURPOSE ARE EXPRESSLY EXCLUDED AND DISCLAIMED. STATEMENTS MADE BY SALES REPRESENTATIVES OR IN PROMOTIONAL MATERIALS DO NOT CONSTITUTE WARRANTIES.

9. Limitation of Liability. COMPANY WILL NOT BE LIABLE FOR ANY INCIDENTAL, CONSEQUENTIAL, INDIRECT, ECONOMIC, PUNITIVE, SPECIAL OR EXEMPLARY DAMAGES ARISING FROM OR IN ANY WAY CONNECTED WITH THIS AGREEMENT WITHOUT REGARD TO THE NATURE OF THE CLAIM OR THE UNDERLYING THEORY OR CAUSE OF ACTION (WHETHER IN CONTRACT, TORT, STRICT LIABILITY, EQUITY OR ANY OTHER THEORY OF LAW) ON WHICH SUCH DAMAGES ARE BASED. COMPANY'S LIMIT OF LIABILITY UNDER THIS AGREEMENT SHALL BE CAPPED AT THE TOTAL AMOUNT OF THE MONIES PAID BY CUSTOMER TO COMPANY UNDER THIS AGREEMENT.

10. Force Majeure. Company shall not be responsible nor deemed to be in default on account of delays in performance due to causes which are beyond Company's control or which make Company's performance impracticable, including but not limited to wars, insurrections, strikes, riots, fires, storms, floods, other acts of nature, explosions, earthquakes, accidents, transportation or delivery delays or losses outside of Company's control, any act of government, inability or delay of Company or manufacture in obtaining necessary labor or adequate or suitable manufacturing components at reasonable prices, allocation regulations or orders affecting materials, equipment, facilities or completed products, failure to obtain any required license or certificates, acts of God or the public enemy, terrorism, epidemics, quarantine restrictions, failure of vendors to perform their contracts or labor troubles of Company or a manufacturer causing cessation, slowdown, or interruption of work.

11. Customer's Obligations. Customer shall provide its timely and best efforts to cooperate with Company and Manufacturer during the manufacturing process to create the Product. Reasonable and timely cooperation includes, without limitation, Customer's providing timely information in response to a request from Manufacturer or Company and Customer's participation in traveling to Manufacturer's facility for inspections and approval of the Product.
12. Default. The occurrence of one or more of the following shall constitute a default under this Agreement: (a) Customer's failure to pay any amounts due under this Agreement or Customer's failure to perform any of its obligations under this Agreement; (b) Company's failure to perform any of its obligations under this Agreement; (c) either party becoming insolvent or becoming subject to bankruptcy or insolvency proceedings; (d) any representation made by either party to induce the other to enter into this Agreement, which is false in any material respect; (e) an action by Customer to dissolve, merge, consolidate or transfer a substantial portion of its property to another entity; or (f) a default or breach by Customer under any other contract or agreement with Company.
13. Manufacturer's Statement of Origin. Company shall retain possession of the manufacturer's statement of origin ("MSO") for the Product until the entire Purchase Price has been paid. If more than one Product is covered by this Agreement, Company shall retain the MSO for each individual Product until the Purchase Price for that Product has been paid in full.
14. Arbitration. Any controversy or claim arising out of or relating to this Agreement, or the breach thereof, shall be settled by arbitration administered by the American Arbitration Association in accordance with its Commercial Arbitration Rules, and judgment on the award rendered by the arbitrator(s) may be entered in any court having jurisdiction thereof. The Arbitration shall take place in Bradenton, Florida.
15. Miscellaneous. The relationship of the parties established under this Agreement is that of independent contractors and neither party is a partner, employee, agent, or joint venture of or with the other. Neither party may assign its rights and obligations under this Agreement without the prior written approval of the other party. This Agreement and all transactions between Ten-8 Fire & Safety, LLC will be governed by and construed in accordance with the laws of the State of Florida. The delivery of signatures to this Agreement may be via facsimile transmission or other electronic means and shall be binding as original signatures. This Agreement shall constitute the entire agreement and supersede any prior agreement between the parties concerning the subject matter of this Agreement. This Agreement may only be modified by an amendment, in writing, signed by duly authorized representatives of both parties with authority to sign such amendments to this Agreement. In the event of a conflict between the Ten-8 Proposal and these Terms and Conditions, the Ten-8 Proposal shall control except in the case of a Cooperative Purchasing Contract as set forth in Section 1(c) and (h) of these Purchasing Terms and Conditions. If any term of this Agreement is determined to be invalid or unenforceable by a competent legal authority, such term will be either reformed or deleted, as the case may be, but only to the extent necessary to comply with the applicable law, regulation, order or rule, and the remaining provisions of the Agreement will remain in full force and effect.

**Bid Award**

**Contract:** FSA23-VEF17.0, Fire & Rescue Vehicles, Boats, and Equipment

**Group:** Ambulance Type I - 4x2 Medium Duty Diesel Engine

**Item:** 603, Braun, Chevrolet CV5500 Chief XL/169" x 96" x 72HR

Zone	Rank	Vendor	Price	Build File
Nationwide	Primary Primary	Ten-8 Fire & Safety, LLC Ten-8 Fire & Safety, LLC	\$305,990.00 \$305,990.00	<a href="#">Build</a> <a href="#">Build</a>



DIMENSIONS ARE APPROXIMATE  
 OVERALL HEIGHT = 112"  
 OVERALL WIDTH WITH RUB  
 RAILS & FENDERETTES = 98"

(7) WHELEN 900 SUPER LED WARNING LIGHTS  
 RED/RED/RED/WHITE/RED/RED/RED  
 WITH CLEAR LENSES

(5) TECNIQ S330 AMBER  
 MINI-LED MARKER LIGHTS

OEM POWER  
 ADJUSTABLE  
 MIRRORS

(2) WHELEN 500 RED  
 LED LIGHTS WITH  
 CLEAR LENSES

CAST PRODUCTS  
 SAD3819/SAP3820 SIREN  
 SPEAKERS IN THE BUMPER

HIDDEN UNLOCK SWITCH  
 IN GRILLE AREA

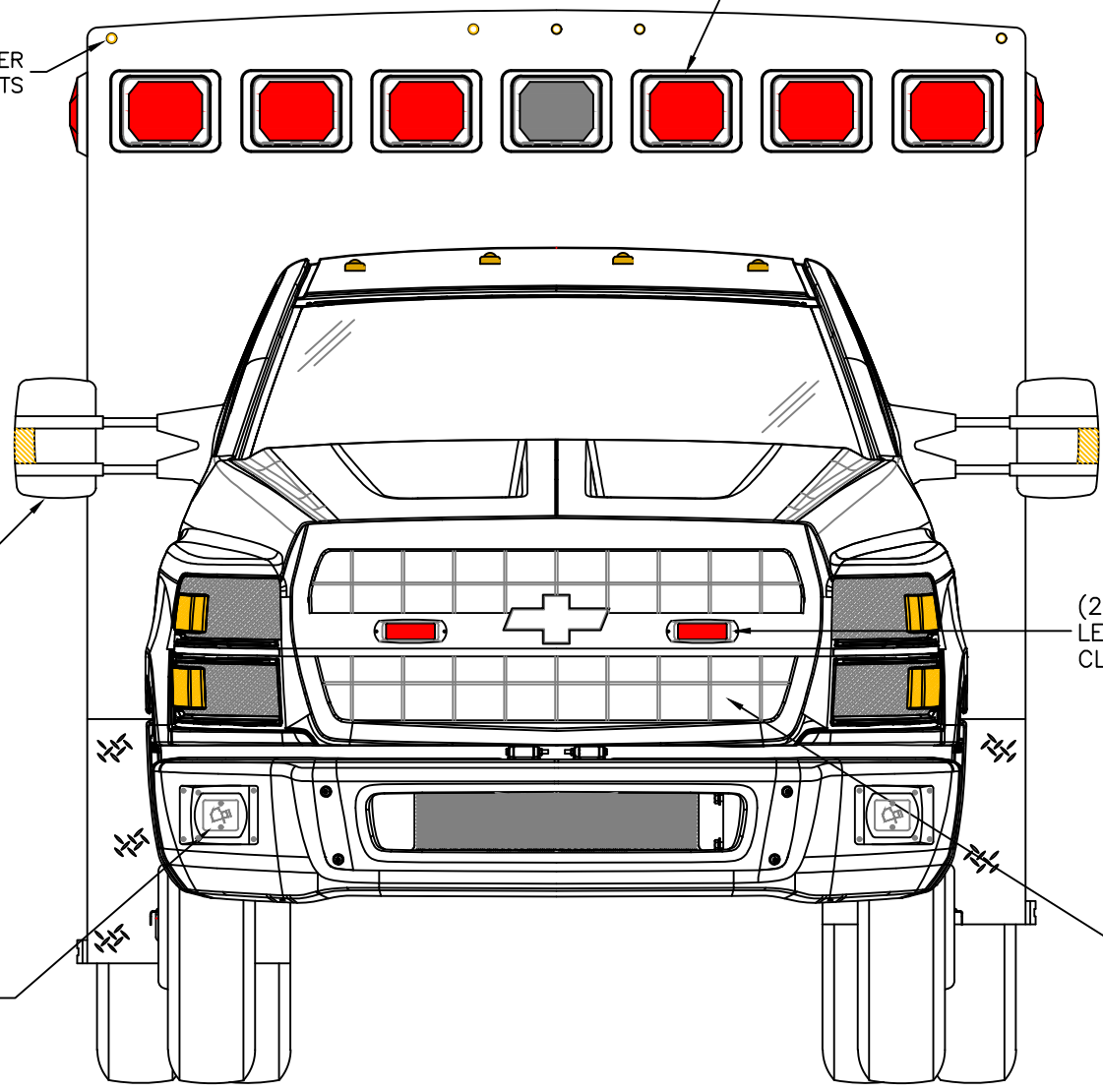

THIS DRAWING IS FOR REPRESENTATIONAL PURPOSES ONLY. DETAILS ARE CONCEPTUAL AND ARE SUBJECT TO CHANGE DURING DESIGN AND CONSTRUCTION  
 DIMENSIONS ARE APPROXIMATE UNLESS NOTED OTHERWISE TO MEET A SPECIFIC CUSTOMER NEED.

MODEL YEAR 2025



FRONT EXTERIOR VIEW  
 CHIEF XL-1/CHEVY 5500HD CHASSIS

DATE:  
 4-7-22

DRAWING NO.

DWG. TKD REV. NR

CHIEFXL-1

APPROVAL SIGNATURE:

DATE:

DIMENSIONS ARE APPROXIMATE  
 OVERALL HEIGHT = 112"  
 OVERALL WIDTH WITH RUB  
 RAILS & FENDERETTES = 98"

(5) TECNIQ S330 RED  
 MINI-LED MARKER LIGHTS

LED LICENSE  
 PLATE LIGHT

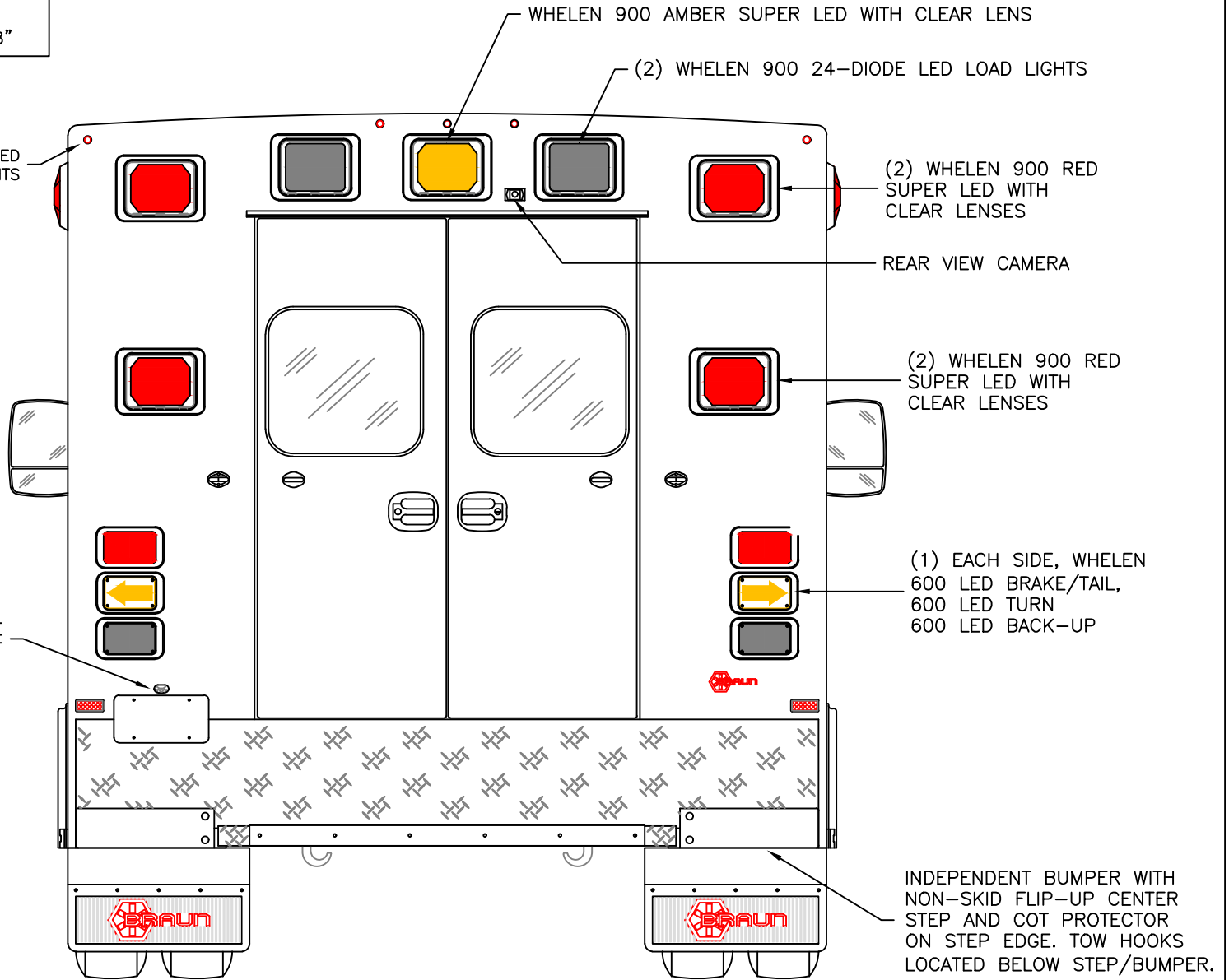

THIS DRAWING IS FOR REPRESENTATIONAL PURPOSES ONLY. DETAILS ARE CONCEPTUAL AND ARE SUBJECT TO CHANGE DURING DESIGN AND CONSTRUCTION  
 DIMENSIONS ARE APPROXIMATE UNLESS NOTED OTHERWISE TO MEET A SPECIFIC CUSTOMER NEED.

MODEL YEAR 2025



REAR EXTERIOR VIEW  
 CHIEF XL-1/CHEVY 5500HD CHASSIS

1:16

DATE:	4-7-22	DRAWING NO.	
DWG.	TKD	REV.	NR
			CHIEFXL-2

DIMENSIONS ARE APPROXIMATE  
 OVERALL HEIGHT = 112"  
 OVERALL LENGTH = 298.75"  
 MODULE LENGTH = 169"

NOTE: LOWERED SIDE FORWARD OF REAR WHEELS IS REMOVED ON THIS MODEL DUE TO THE EXHAUST.

TECNIQ S330 RED MINI-LED MARKER LIGHT TO ALSO FLASH WITH TURN SIGNAL

(2) WHELEN 900 RED SUPER LED WARNING LIGHTS WITH CLEAR LENSES

(2) WHELEN 900 24-DIODE LED SCENE LIGHTS

KUSSMAUL 20 AMP SUPER AUTO-EJECT SHORELINE INLET

WHELEN 700 RED LED LIGHT WITH CLEAR LENS IN TILT HOUSING

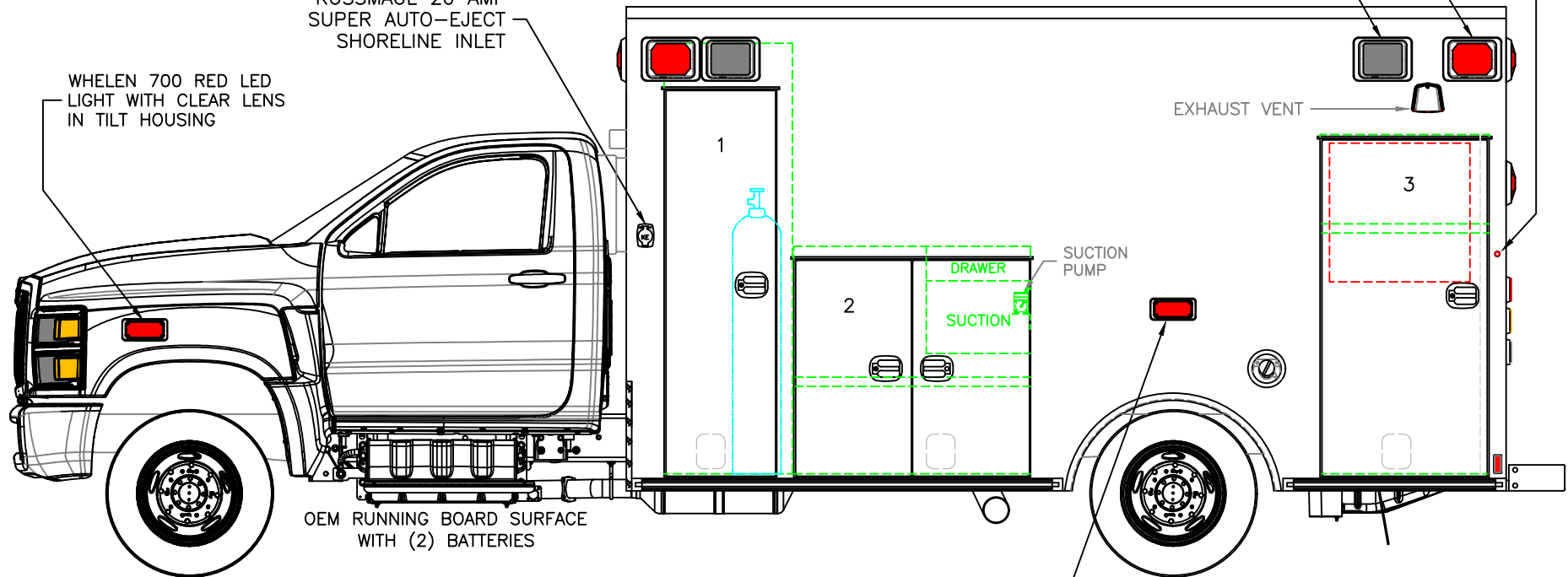

OEM RUNNING BOARD SURFACE WITH (2) BATTERIES

SUCTION PUMP

EXHAUST VENT

WHELEN 700 RED SUPER LED WITH CLEAR LENS

COMPARTMENT  
O.S.S #1

CLEAR OPENING: 73.00h x 18.25w  
 INSIDE DIM'S.: 82.75h x 24.50w x 21.75d  
 MAIN OXYGEN STORAGE

O.S.S #2

CLEAR OPENING: 40.25h x 39.50w  
 INSIDE DIM'S.: 43.75h x 45.50w x 21.75d  
 (1) ADJUSTABLE SHELF

O.S.S #3

CLEAR OPENING: 63.50h x 28.75w  
 INSIDE DIM'S.: 65.25h x 32.50w x 21.75d  
 INSIDE/OUTSIDE ACCESS  
 (1) ADJUSTABLE SHELF

THIS DRAWING IS FOR REPRESENTATIONAL PURPOSES ONLY. DETAILS ARE CONCEPTUAL AND ARE SUBJECT TO CHANGE DURING DESIGN AND CONSTRUCTION DIMENSIONS ARE APPROXIMATE UNLESS NOTED OTHERWISE TO MEET A SPECIFIC CUSTOMER NEED.

MODEL YEAR 2025



STREETSIDE EXTERIOR VIEW  
 CHIEF XL-1/CHEVY 5500HD CHASSIS

1:30

DATE:	4-7-22
DWG.:	TKD
REV.:	NR

DRAWING NO.  
CHIEFXL-3

DIMENSIONS ARE APPROXIMATE  
 OVERALL HEIGHT = 112"  
 OVERALL LENGTH = 298.75"  
 MODULE LENGTH = 169"

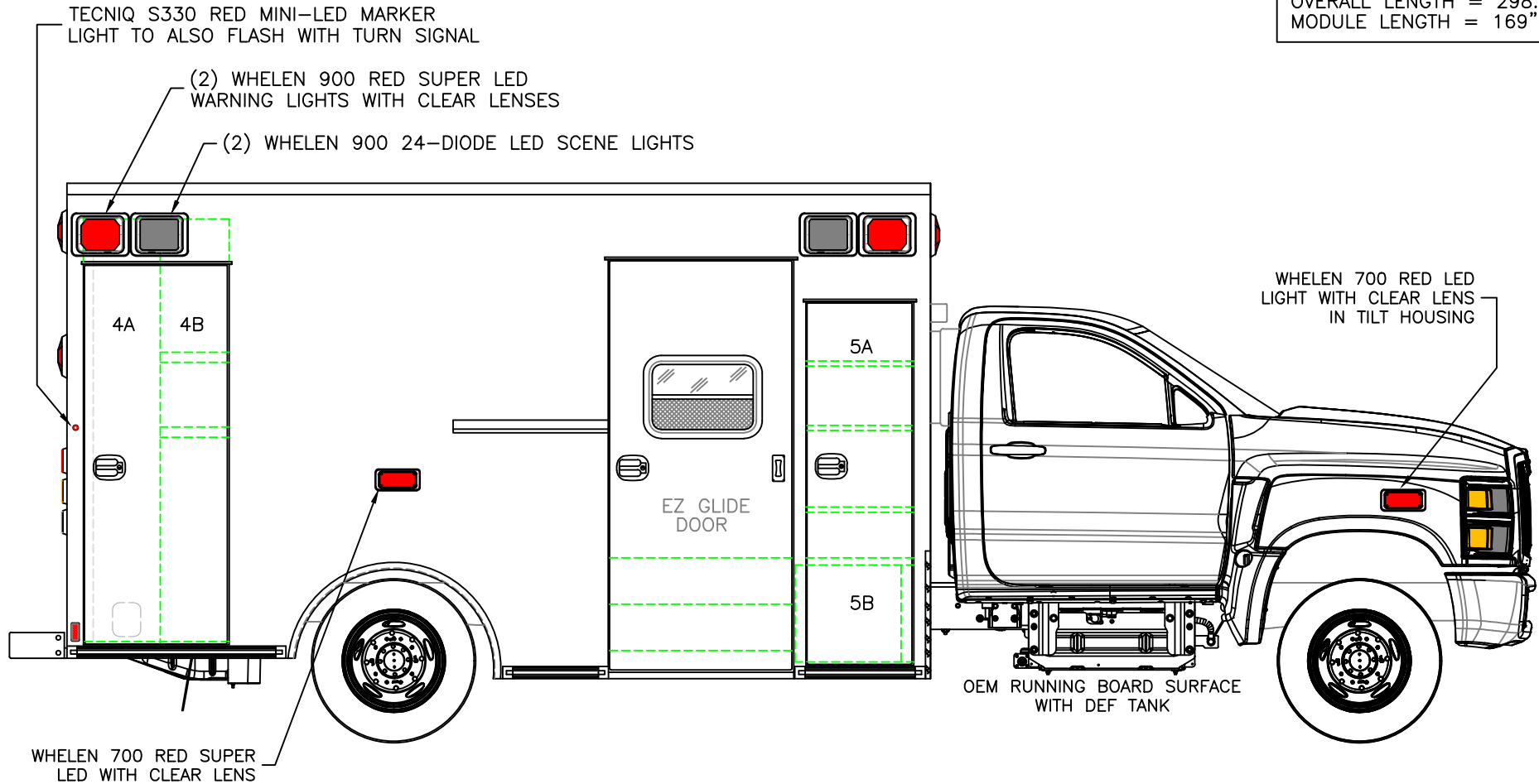

COMPARTMENT  
 O.S.S #4

CLEAR OPENING: 73.00h x 24.75w  
 INSIDE DIM'S. 4A: 82.75h x 15.00w x 21.75d  
 BACKBOARD/SCOOP STORAGE  
 INSIDE DIM'S. 4B: 82.75h x 13.50w x 21.75d  
 (2) ADJUSTABLE SHELVES WITH INSIDE/OUTSIDE ACCESS

O.S.S #5

CLEAR OPENING: 69.50h x 17.50w  
 INSIDE DIM'S. 5A: SEE PARTITION INTERIOR VIEW  
 INSIDE/OUTSIDE STORAGE WITH (3) ADJUSTABLE SHELVES  
 INSIDE DIM'S. 5B: 19.00h x 20.75w x 19.00d

THIS DRAWING IS FOR REPRESENTATIONAL PURPOSES ONLY. DETAILS ARE CONCEPTUAL AND ARE SUBJECT TO CHANGE DURING DESIGN AND CONSTRUCTION  
 DIMENSIONS ARE APPROXIMATE UNLESS NOTED OTHERWISE TO MEET A SPECIFIC CUSTOMER NEED.

MODEL YEAR 2025



CURBSIDE EXTERIOR VIEW  
 CHIEF XL-1/CHEVY 5500HD CHASSIS

1:30

DATE:	4-7-22	
DWG.	TKD	REV. NR

DRAWING NO.  
 CHIEFXL-4

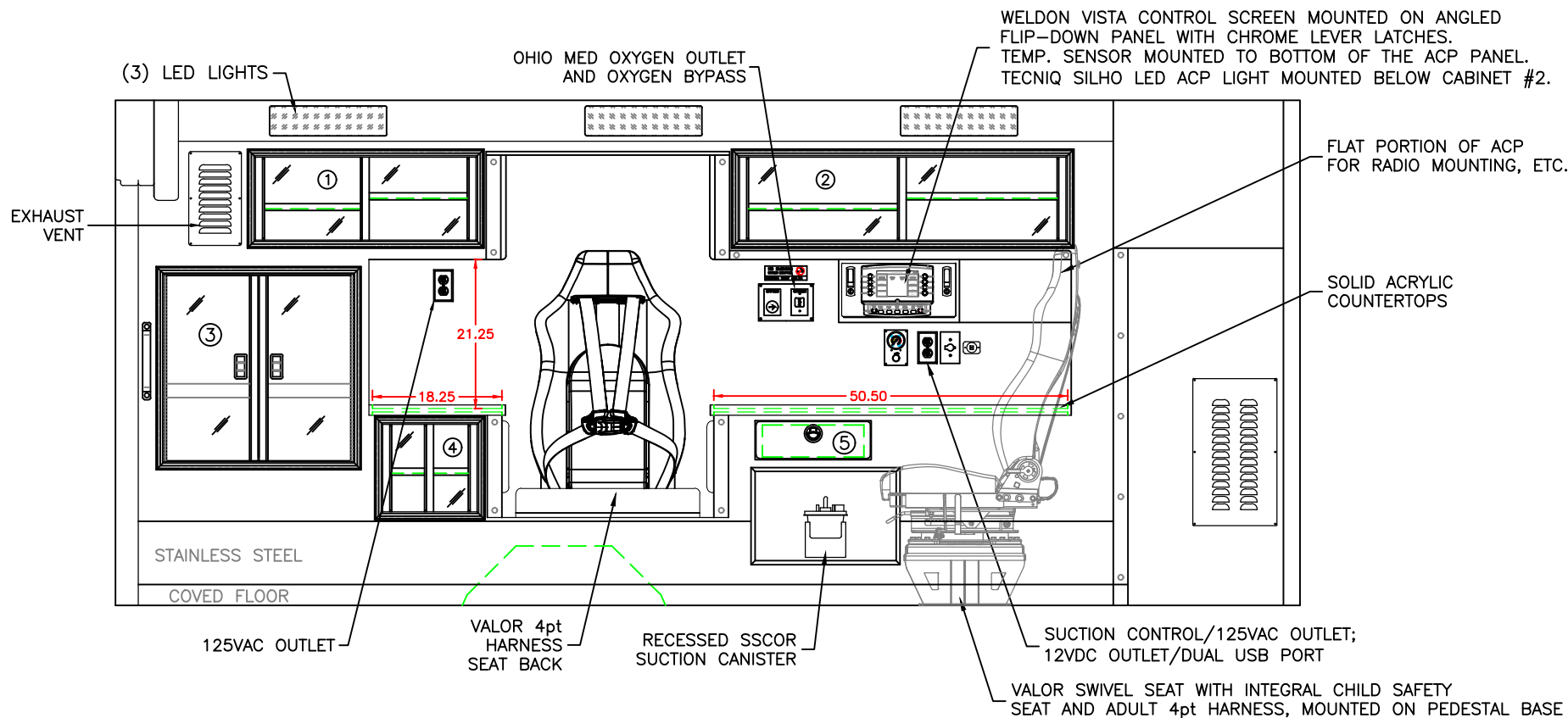

**COMPARTMENT**

#1 DOOR OPENING: 11.75h x 31.50w  
 INSIDE DIMS: 13.25h x 33.00w x 18.25d  
 (1) ADJ SHELF EACH SIDE OF CENTER DIVIDER  
 SLIDING POLYCARBONATE DOORS  
 TOTAL CABINET WEIGHT RATING = 25 lbs.

#2 DOOR OPENING: 11.75h x 46.50w  
 INSIDE DIMS: 13.25h x 48.00w x 18.25d  
 (1) ADJ SHELF EACH SIDE OF CENTER DIVIDER  
 SLIDING POLYCARBONATE DOORS  
 TOTAL CABINET WEIGHT RATING = 25 lbs.

#3 DOOR OPENING: 26.50h x 26.75w  
 INSIDE DIMS: O.S.S. #3  
 HINGED POLYCARBONATE DOORS WITH FULL LENGTH  
 HANDLES AND CENTER SQUEEZE LATCHES  
 TOTAL CABINET WEIGHT RATING = 40 lbs.

#4 DOOR OPENING: 12.50h x 13.50w  
 INSIDE DIMS: 14.00h x 15.00w x 18.25d  
 (1) ADJUSTABLE SHELF  
 SLIDING POLYCARBONATE DOORS  
 TOTAL CABINET WEIGHT RATING = 15 lbs.

#5 PULL-OUT DRAWER WITH HINGED ACRYLIC WRITING SURFACE  
 INSIDE DIMS: 4.50h x 14.50w x 13.25d  
 LOCKING STAINLESS STEEL FLUSH PULL LATCH  
 TOTAL DRAWER WEIGHT RATING = 10 lbs.

THIS DRAWING IS FOR REPRESENTATIONAL PURPOSES ONLY. DETAILS ARE CONCEPTUAL AND ARE SUBJECT TO CHANGE DURING DESIGN AND CONSTRUCTION  
 DIMENSIONS ARE APPROXIMATE UNLESS NOTED OTHERWISE TO MEET A SPECIFIC CUSTOMER NEED.

MODEL YEAR 2025



STREETSIDE INTERIOR VIEW  
 CHIEF XL-1

1:22

DATE:	4-7-22	
DWG.	TKD	REV.
		NR

DRAWING NO.

CHIEFXL-5

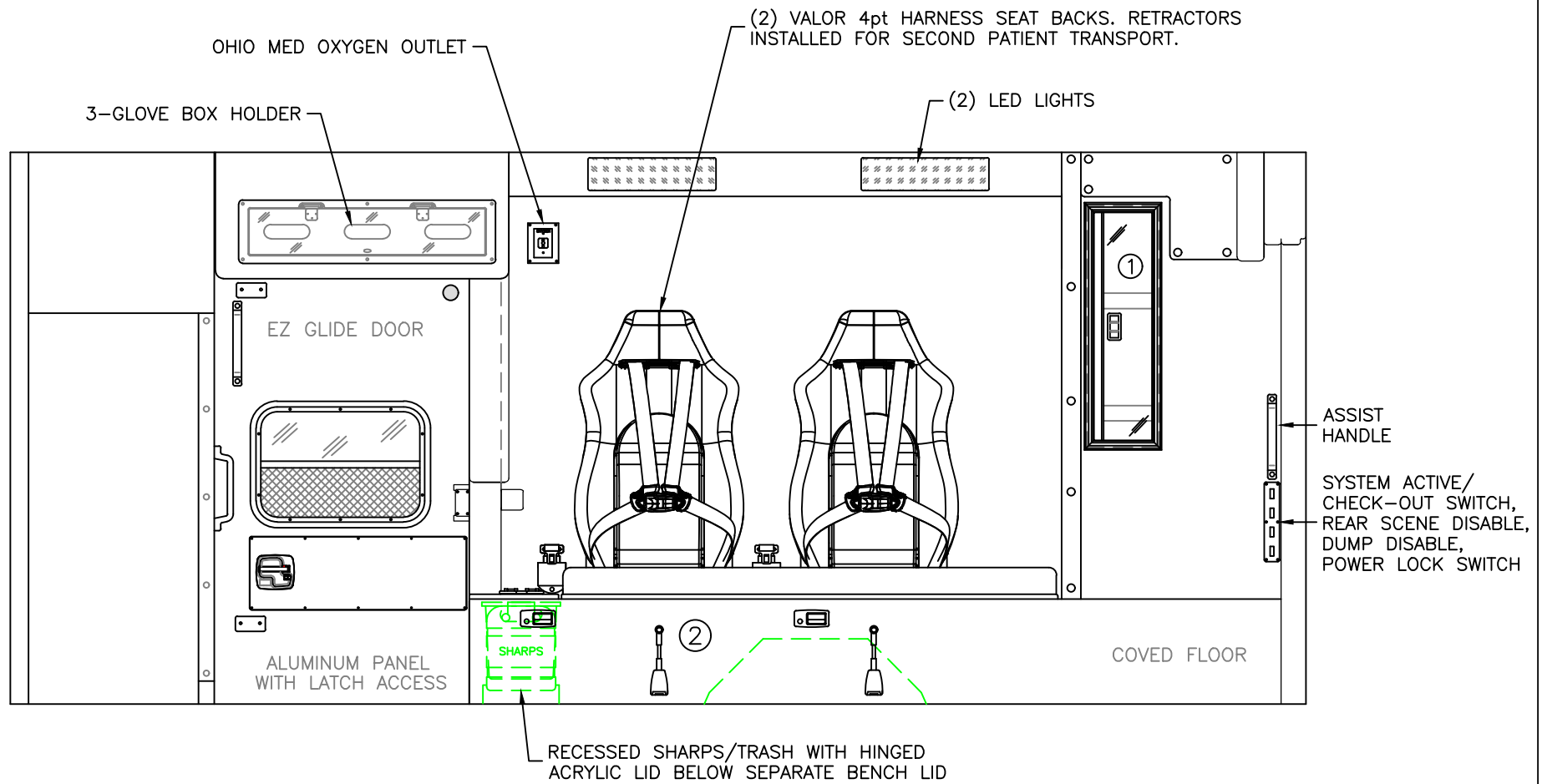

COMPARTMENT

#1 DOOR OPENING: 30.00h x 7.25w  
 INSIDE/OUTSIDE ACCESS TO OSS #4B  
 HINGED POLYCARBONATE DOOR WITH FULL LENGTH  
 HANDLE AND CENTER SQUEEZE LATCH  
 TOTAL CABINET WEIGHT RATING = 25 lbs.

#2 INSIDE DIM'S: 14.25h x 77.00w x 21.00d

THIS DRAWING IS FOR REPRESENTATIONAL PURPOSES ONLY. DETAILS ARE CONCEPTUAL AND ARE SUBJECT TO CHANGE DURING DESIGN AND CONSTRUCTION  
 DIMENSIONS ARE APPROXIMATE UNLESS NOTED OTHERWISE TO MEET A SPECIFIC CUSTOMER NEED.

MODEL YEAR 2025



CURBSIDE INTERIOR VIEW  
 CHIEF XL-1

1:20

DATE:	4-7-22	
DWG.	TKD	REV.
		NR

DRAWING NO.  
 CHIEFXL-6

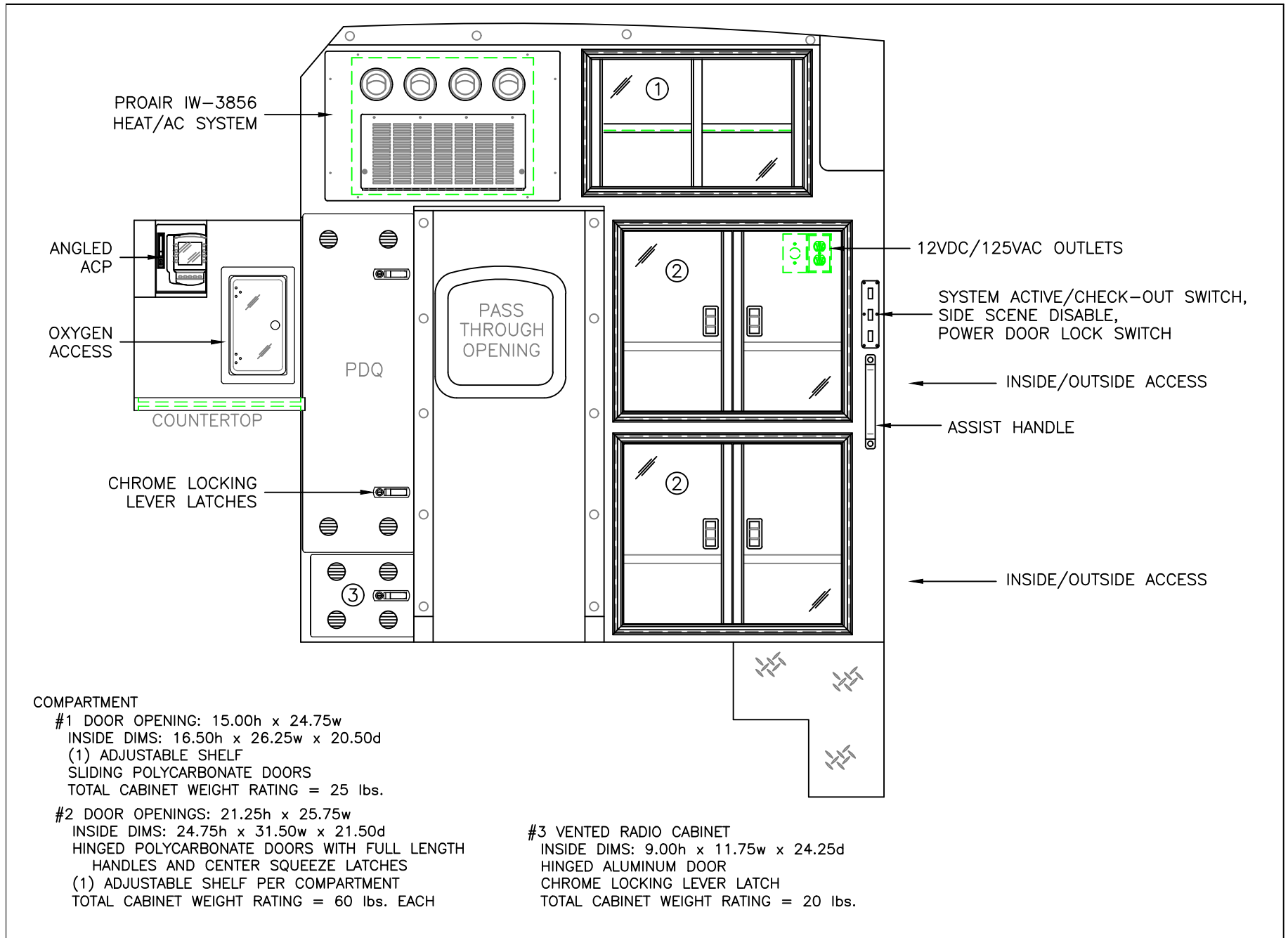

THIS DRAWING IS FOR REPRESENTATIONAL PURPOSES ONLY. DETAILS ARE CONCEPTUAL AND ARE SUBJECT TO CHANGE DURING DESIGN AND CONSTRUCTION DIMENSIONS ARE APPROXIMATE UNLESS NOTED OTHERWISE TO MEET A SPECIFIC CUSTOMER NEED.

MODEL YEAR 2025



PARTITION INTERIOR VIEW  
 CHIEF XL-1

DATE:	4-7-22
DWG.:	TKD
REV.:	NR

DRAWING NO.  
 CHIEFXL-7

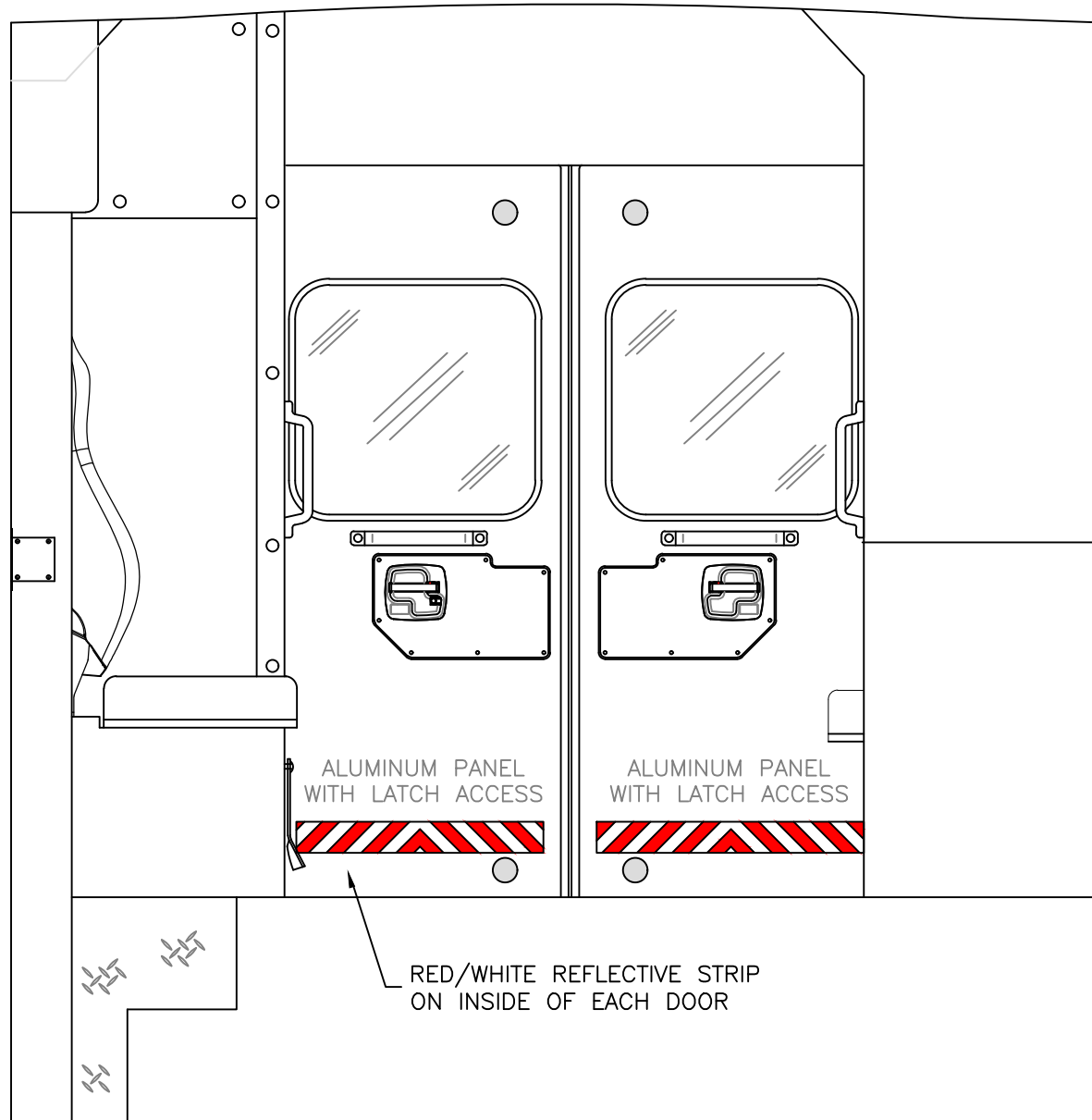

THIS DRAWING IS FOR REPRESENTATIONAL PURPOSES ONLY. DETAILS ARE CONCEPTUAL AND ARE SUBJECT TO CHANGE DURING DESIGN AND CONSTRUCTION  
 DIMENSIONS ARE APPROXIMATE UNLESS NOTED OTHERWISE TO MEET A SPECIFIC CUSTOMER NEED.

MODEL YEAR 2025



REAR INTERIOR VIEW  
 CHIEF XL-1

1:12

DATE:	4-7-22
DWG.:	TKD
REV.:	NR

DRAWING NO.:	CHIEFXL-8
--------------	-----------



RECESSED SHARPS/TRASH WITH HINGED  
ACRYLIC LID BELOW SEPARATE BENCH LID

(8) LED  
DOME  
LIGHTS

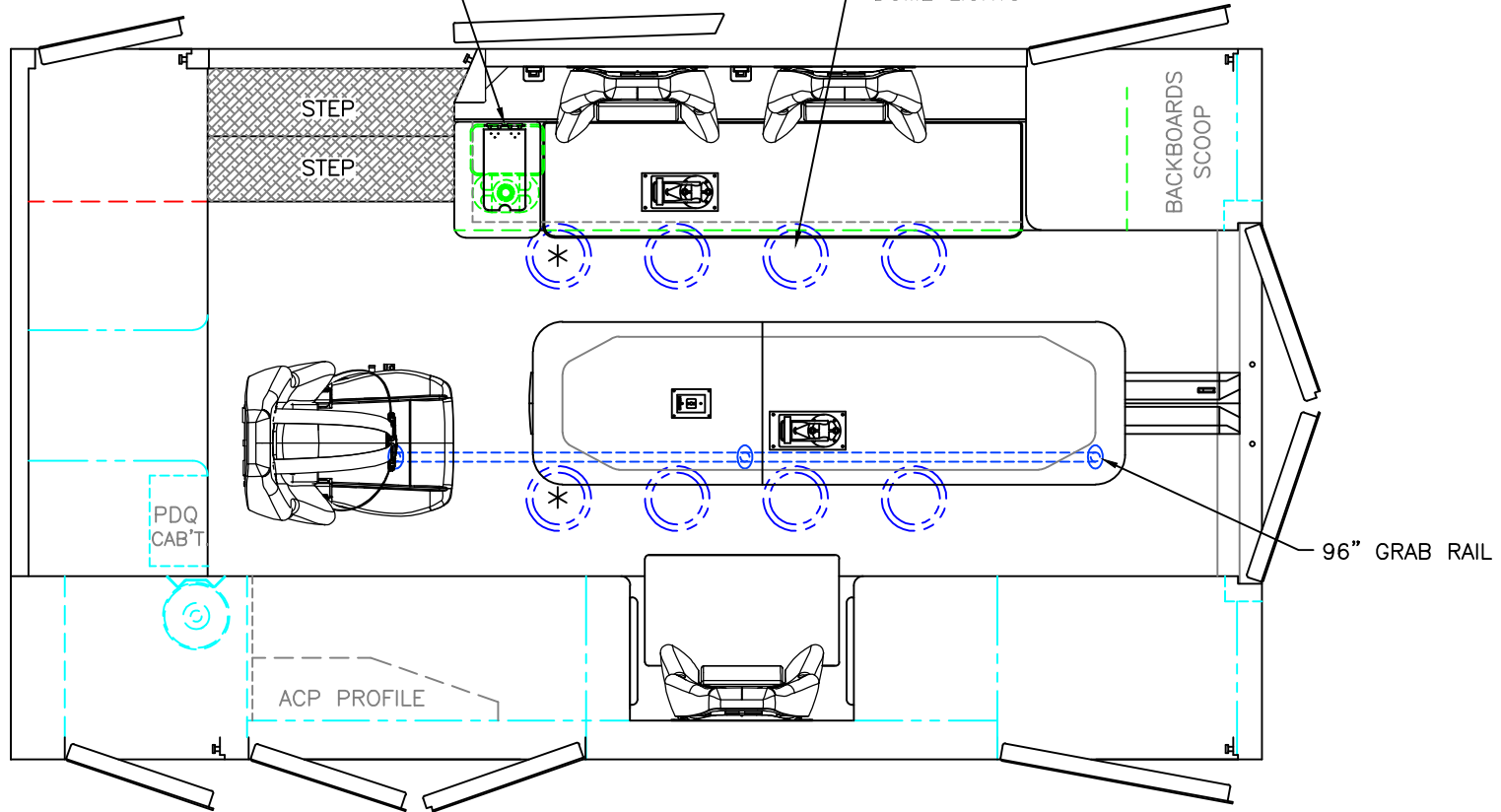

 = (2) RECESSED CEILING IV HANGER LOCATIONS

 = (1) CEILING OXYGEN OUTLET

\* (2) ANTENNA BASES LOCATED OUTBOARD OF  
DOME LIGHTS WITH COAX SERVICE LOOP

96" FERNO STAT-TRAC CENTER MOUNT COT HARDWARE

MODULE WIDTH = 96"  
MODULE LENGTH = 169"  
MODULE HEAD ROOM = 72"

THIS DRAWING IS FOR REPRESENTATIONAL PURPOSES ONLY. DETAILS ARE CONCEPTUAL AND ARE SUBJECT TO CHANGE DURING DESIGN AND CONSTRUCTION  
DIMENSIONS ARE APPROXIMATE UNLESS NOTED OTHERWISE TO MEET A SPECIFIC CUSTOMER NEED.

MODEL YEAR 2025



FLOOR INTERIOR VIEW  
CHIEF XL-1

1:22

DATE:	4-7-22
DWG:	TKD
REV:	NR

DRAWING NO.

CHIEFXL-9



# Quotation Summary

Florida Sheriff's Association Braun Proposals 2023-01-12 14-00-47

**Reference:** QUO0000007848 **Rev:** 0  
**Purchaser:** Ten-8 Fire Equipment, Inc.  
**Contact:** Cindy Morgan  
**Address:** 2904 59th Ave. Dr. East

Brandenton, FL  
 USA

**Telephone:**

**Sales Contact:** Eric Wilcox  
**Mobile:** 4196158839  
**Phone:**

**Opportunity:** Florida Sherrif's Association  
**Account:** Florida Sheriff's Association  
**Contact:** Cindy Morgan  
**Shipping Address:**

**Currency:** USD  
**Quotation Date:** 2023-01-12  
**Expiration:** 2023-02-11

**Factory Contact:** Chuck Burgess  
**Mobile:** 4196517924

Name	Specifications
Chief XL Type I 	-72" Headroom -169"L Full Seam Welded Module

## Sales Options by Category

<i>Braun - KKK Change Notice</i>		
Item Number	Description	Quantity
00-01-0001	GENERAL CONDITIONS	1.00
00-01-0006	DYNAMIC SIDE IMPACT & ROLLOVER TESTS	1.00
00-01-0017	BIDDER IS KKK-A-1822F AMENDMENT 1 COMPLIANT	1.00
80-10-0000	KKK-A-1822F COMPLIANCE PACKAGE KKK-A-1822F compliance sticker, electrical load analysis sticker, and payload sticker shall be installed in the oxygen compartment. Any deviations from KKK-A-1822F shall be listed in the vehicle delivery packet with a notation on the-compliance sticker.	1.00
00-01-0029	NO CONTRACT REQUIRED NO STS, HGAC, FSA, SOURCEWELL or GPO contract required	1.00
00-01-0053	NO BOND REQUIRED	1.00



No Bond is Required  
-----

**Braun - Chassis**

<i>Item Number</i>	<i>Description</i>	<i>Quantity</i>
00-01-0040	<b>Administration Fee</b>	1.00
00-01-0080	<b>SURCHARGE FEE</b>	1.00
25XLHD	<b>TYPE I - AMBULANCE - CHIEF XL I HD - 72 INCH INTERIOR HEADROOM</b> 2025 Chief XL Type I - 169" Module - 72" Interior Headroom. Manufactured in Van Wert, Ohio, USA.	1.00
CH_C25500L	<b>CHASSIS - CHEVROLET SILVERADO 5500HD 189" WB 4X2 (108 C.A.) DIESEL ENGINE</b> CHEVROLET SILVERADO 5500HD 189" WB 4X2 (108 C.A.) DIESEL ENGINE	1.00
15-00-0010	<b>FUEL TANK - FULL UPON FACTORY RELEASE</b> The chassis fuel tank of the completed unit shall be full at time of release from the ambulance manufacturer's facility.	1.00
20-10-0603	<b>ENGINE BLOCK HEATER - OEM PLUG</b> An engine block heater shall be included in the chassis with the 125 VAC power cord.	1.00
20-20-0277B	<b>HIGH IDLE SYSTEM - B</b> A high-idle module will be added to the chassis. The high idle will be engaged automatically by the M-Tech system when all chassis parameters are met. Chassis parameters include but not limited to vehicle in park, service brake not depressed, accelerator not depressed, parking brake set and battery voltage. High-idle may also be activated by the M-Tech heat or A/C.	1.00
20-01-0105	<b>SUSPENSION - LIQUID SPRING TYPE I</b> Install: Liquid Spring	1.00
20-10-0210	<b>BATTERY - TWO SYSTEM - HD SERIES CHASSIS</b> Two (2) batteries shall be securely installed in the OEM locations, under the driver's side step area.	1.00
20-21-0301	<b>FLOOR CONSOLE 4500/5500HD STANDARD CONSOLE - ALUMINUM</b> PLEASE NOTE: Must reference the attached console drawing for specific layout design.	1.00
30-10-0030	<b>BACKUP ALARM</b> Install: (OSHA approved) back up alarm with a disable control for silent backing, located on the MCC (master control console).	1.00
20-30-0807	<b>STEPS, ASSIST OEM ALUMINUM</b> OEM aluminum assist steps (running boards) shall be provided on the cab (Chassis option E0N). Step design includes location for OEM batteries at driver's side.	1.00
20-30-0215	<b>MIRRORS, O/S, WIDE LOAD / TRAILERING, FULL FEATURE</b>	1.00



	MIRRORS EXT OEM CHEVY HD MIRRORS, O/S, WIDE LOAD / TRAILERING, FULL FEATURE	
<b>30-10-0753</b>	<b>SIREN, WHELEN 295-HFSA7-REMOTE WITH MICROPHONE (Meets CA Title 13)</b> A Whelen 295-HFSA7 remote dual siren amplifier shall be flush-mounted in the master control console located in the cab. The siren shall be capable of hands-free operation and shall be equipped with a noise canceling microphone. (Meets CA Title 13)	1.00
<b>30-10-0816</b>	<b>SIREN SPEAKERS, CAST PRODUCTS THROUGH THE BUMPER HD</b> Install: Cast Products dual 100-watt siren speakers, shall be installed through the front bumper.	1.00
<b>15-00-0060</b>	<b>OEM CHASSIS WHEELS</b> OEM chassis wheels	1.00

**Braun - Electrical**

<i>Item Number</i>	<i>Description</i>	<i>Quantity</i>
<b>30-06-0004</b>	<b>ELECTRICAL SYSTEM - WELDON V-MUX, MICRO PROCESSOR BASED</b> Install: Weldon V-MUX 100% solid state microprocessor based multiplex system.	1.00
<b>30-10-0110</b>	<b>ELECTRICAL CIRCUITS</b> All electrical circuits: shall have wiring and circuit protection suitable to the demand and must meet the national electric code (NEC) wiring requirements, added on wiring (18 GA through 10 GA) color coded and stamped with code numbers for easy identification, SLX high temperature thermoplastic cross link wire used. SGX insulated cable used for all under hood / underbody battery and charging system cable. High temperature (375° f) thermoplastic loom used on all harnesses.	1.00
<b>30-06-0126</b>	<b>ELECTRICAL COMPARTMENT (PDQ) - MULTIPLEX ELECTRICAL SYSTEM</b> Electrical compartment / hinged door w/ (2) chrome locking lever latches/ located on the partition wall behind the attendant seat.	1.00
<b>30-06-0325</b>	<b>FLASHER - MULTIPLEX ELECTRICAL SYSTEM</b> Provide: Flasher within and programmed by the multiplex electrical system.	1.00
<b>30-06-0356</b>	<b>FLASHING HEADLIGHTS - MULTIPLEX ELECTRICAL SYSTEM - HD SERIES CHASSIS</b> Program headlights (high beams) through the multiplex system to alternate flash (wig-wag).	1.00
<b>30-10-0190</b>	<b>GROUND FAULT CIRCUIT INTERRUPTER-GFCI</b> Install: A 125 VAC, 20 AMP circuit breaker with ground fault circuit interrupter (GFCI) electronic ground leakage detection in the load center for the shoreline circuit.	1.00
<b>30-06-0285</b>	<b>MODULE DISCONNECT - MULTIPLEX ELECTRICAL SYSTEM</b> Install: In-Power disconnect to keep the system power engaged after the ignition is switched to the "off" position.	1.00
<b>30-06-0575</b>	<b>REVERSE -TRANSMISSION- FUNCTIONS - MULTIPLEX ELECTRICAL SYSTEM</b>	1.00



System programmed to provide activation for: rear outboard warning lights, rear side warning lights, rear scene lights, the rear side scene lights - when the transmission selector lever is placed into "reverse" position.

30-06-0150	<p><b>SPARE CIRCUIT - MULTIPLEX ELECTRICAL SYSTEM</b> Provide (1) spare 15-amp circuit.</p>	1.00
30-06-0175	<p><b>WIRING HARNESS CONNECTORS - MULTIPLEX ELECTRICAL SYSTEM</b> Connect all wiring harnesses via quick connect circular plug connectors.</p>	1.00
30-06-0300	<p><b>VOLTMETER - MULTIPLEX ELECTRICAL SYSTEM</b> Provide: (1) digital voltmeter on the master control console screen.</p>	1.00
30-06-0026	<p><b>WARNING DISPLAY - MULTIPLEX ELECTRICAL SYSTEM</b> Install: digital warning display integrated into the cab display console, programmed through the multiplex system to provide visual and audible indication.</p>	1.00
30-06-0225	<p><b>EMERGENCY MASTER SWITCH - MULTIPLEX ELECTRICAL SYSTEM</b> Supply: A single emergency master switch for activating all the emergency warning lights on the master control console screen, emergency master switch will activate the module power automatically, include an Emergency Master Menu button to allow access to individual warning light functions.</p>	1.00
30-06-0250	<p><b>CONTROL PANEL SWITCHES - MULTIPLEX ELECTRICAL SYSTEM</b> Switches on the master control console and attendant control panel screens shall have dimmable perimeter backlighting.</p>	1.00
30-06-0275	<p><b>MODULE POWER SWITCH - MULTIPLEX ELECTRICAL SYSTEM</b> Provide: A module power switch for the electrical system on both the Master Control Console and the Attendant Control Panel screens.</p>	1.00
30-06-0101	<p><b>ATTENDANT CONTROL PANEL (ACP) - MULTIPLEX ELECTRICAL SYSTEM</b> Attendant Control Panel (ACP) contains a color micro processor screen, controls all equipment installed in the patient compartment.</p>	1.00
30-06-0375	<p><b>PARK OVERRIDE - MULTIPLEX ELECTRICAL SYSTEM</b> Park override switch on the master control console screen, reactivates all lights disabled when the transmission is placed in the neutral/park position.</p>	1.00
30-06-0400	<p><b>LOAD MANAGER-SEQUENTIAL SWITCHING SYSTEM - MULTIPLEX ELECTRIC SYSTEM</b> Load manager-sequential switching system controlled by the microprocessor based electrical system: emergency master button shall control the sequential switching of the emergency lights and/or other warning devices, load manager shall automatically shed non-critical electrical loads during low voltage conditions.</p>	1.00
30-06-0450	<p><b>FRONT CLEAR DISABLE SWITCH - MULTIPLEX ELECTRICAL SYSTEM</b> Activation of the switch on the master control console screen to disable all forward-facing clear warning lights.</p>	1.00
30-06-0076	<p><b>MASTER CONTROL CONSOLE (MCC) - MULTIPLEX ELECTRICAL SYSTEM</b> Floor mounted Master Control Console (MCC) located in the cab, housing siren, color microprocessor display screen, controlling all the Emergency Warning functions,</p>	1.00



Patient Compartment lighting and module heat/ac functions.

30-06-0475	<p><b>CURBSIDE SCENE LIGHTS ON WITH CURBSIDE DOOR</b></p> <p>The Curbside scene lights: programmed to activate when the Curbside door is in the open position.</p>	1.00
30-06-0500	<p><b>REAR SCENE LIGHTS ON WITH REAR DOORS OPEN</b></p> <p>Rear scene lights programmed to activate when the rear doors are in the open position.</p>	1.00
30-06-0525	<p><b>DISABLE SWITCH FOR REAR SCENE LIGHTS - MULTIPLEX ELECTRICAL SYSTEM</b></p> <p>Install: disable switch at the rear door area to disable the rear scene lights.</p>	1.00
30-06-0550	<p><b>DISABLE SWITCH FOR SIDE SCENE LIGHTS - MULTIPLEX ELECTRICAL SYSTEM</b></p> <p>A disable switch shall be installed at the curbside door area to disable the curbside scene lights.</p>	1.00
30-06-0015	<p><b>VISTA IV ACP - PUSH BUTTON</b></p> <p>Install: Weldon V-MUX Vista IV interface module / display screen mounted on an angled flip - down panel with chrome lever latches, in the patient compartment ACP area.</p>	1.00
30-06-0010	<p><b>VISTA IV MCC - PUSH BUTTON</b></p> <p>Install: Weldon V-MUX Vista IV interface module / display screen in the cab, operated through the use of push buttons.</p>	1.00
30-10-0901	<p><b>SYSTEM ACTIVE AND CHECK OUT LIGHTS - 15 MINUTES</b></p> <p>Switch: located at the curb and rear entry doors for activation of the V-MUX electrical system, check out light switch located at the curb and rear doors for activation of the left LED angled lights prior to entering the module, system programmed to shut down automatically after 15 minutes unless the ignition is on.</p>	1.00
30-10-0050	<p><b>BATTERY CONVERTER - CHARGER</b></p> <p>Connect to Shoreline inlet: Progressive Dynamics #PD9245C, 45 amp, 125 VAC to 13.6 VDC converter, capable of maintaining the batteries when plugged in.</p>	1.00
30-10-0082	<p><b>OEM BACK-UP CAMERA - CHEVY HD CHASSIS</b></p>	1.00
30-10-0915	<p><b>SYSTEM AUTO ACTIVE WITH ENTRY DOOR OPEN OR UNLOCK SIGNAL</b></p> <p>The system will auto activate when a module entry door is opened or when a door unlock signal is received.</p>	1.00
30-10-0585	<p><b>USB - DUAL OUTLET, ONE (1) INTERIOR LOCATED ON CONSOLE</b></p> <p>Install: (1) dual USB port outlet, 5 volt / 2.1 amp, in the vehicle, located on the Master Control Console in the cab.</p>	1.00
USBAA101	<p><b>OUTLET, USB - ONE (1) DUAL - PRIMARY ACTION AREA</b></p> <p>One (1) dual USB port outlet, 5 volt / 2.1 amp, shall be installed in the vehicle, located on the streetside primary action area in the patient compartment.</p>	1.00
125AA101	<p><b>OUTLET, 125VAC - ONE (1) INTERIOR DUPLEX - LEFT WALL ACTION AREA</b></p>	1.00



	One (1) 2-wire +plus ground 125 VAC duplex outlet in the street side wall in the primary action area.	
<b>125AA201</b>	<b>OUTLET, 125VAC - ONE (1) INTERIOR DUPLEX - SECONDARY ACTION AREA</b> One (1) 2-wire +plus ground 125 VAC duplex outlet in the street side wall in the secondary action area.	1.00
<b>125IF201</b>	<b>OUTLET, 125VAC - ONE (1) INTERIOR DUPLEX - FRONT WALL CABINET</b> One (1) 2-wire +plus ground 125 VAC duplex outlet in the front wall cabinet.	1.00
<b>12VAA101</b>	<b>OUTLET, 12VDC - ONE (1) - LEFT WALL ACTION AREA</b> One (1) 12 VDC power point outlet shall be installed in the street side wall in the primary action area. The outlet shall be labeled, "12 VDC". A Schottky diode medical isolator shall be provided to protect the 12 VDC outlet.	1.00
<b>12VIF201</b>	<b>OUTLET, 12VDC - ONE (1) FRONT WALL - CABINET</b> One (1) 12 VDC power point outlet shall be installed in the patient compartment, in the front wall cabinet. The outlet shall be labeled, "12 VDC". A Schottky diode medical isolator shall be provided to protect the 12 VDC outlet.	1.00
<b>30-12-0001</b>	<b>RECEPTACLE SHORELINE INLET-SUPER 20 AMP, AUTO EJECT - YELLOW COVER</b> Install: Kusssmaul super auto eject shoreline inlet receptacle with yellow cover on module exterior (forward street side) near the driver's door, equipped with an integral dynamic disconnect.	1.00
<b>30-10-0657</b>	<b>RADIO ANTENNA BASES - TWO (2) The coax cable(s) shall terminate in the PDQ.</b> Two (2) antenna bases with attached coax cables shall be installed on the module roof. The coax cables shall terminate in the PDQ. Access to the antenna bases shall be through adjacent module interior dome lights.	1.00
<b>30-10-0299</b>	<b>LIGHT, ATTENDANT CONTROL PANEL AREA - TECNIQ SILHO-X LED - WARM WHITE</b> A Tecniq Silho-X 2.75" round warm white LED light with SS trim ring, shall be mounted above the left wall forward action area counter. The light shall be operated through a button on the ACP Vista screen labeled "Attendant Light". (Braun #26415)	1.00
<b>30-10-0310</b>	<b>LIGHT, LED ELECTRICAL COMPARTMENT -PDQ</b> A 12 VDC LED light shall be located in the PDQ. The light shall be wired "battery-hot" to activate when the PDQ door is in the open position. The light shall be off when the door is in the closed position.	1.00
<b>30-11-0106</b>	<b>LIGHTS, DOME LED (8) WHELEN SUPER LED</b> Eight (8) Whelen #LED (80C0EHCR) dome lights, shall be installed. See dwg #9	1.00
<b>30-11-0152</b>	<b>LIGHTS, RIDGEBACK LED PANEL (3) STREETSIDE - ANGLED</b> Install: (3) Ridgeback LED lights streetside per dwg #5.	1.00
<b>30-11-0176</b>	<b>LIGHTS, RIDGEBACK LED PANEL (2) CURBSIDE - ANGLED</b> Install: (2) Ridgeback LED lights mounted on an angled panel above curbside seating area per dwg #6.	1.00
<b>30-10-0410</b>	<b>LIGHTS, OSS COMPARTMENTS - INCANDESCENT</b> Install: Truck-Lite brand incandescent lights, activated by magnetic switches. Compartments #1, #2, #3, and #4, each contain two (2) clear 4" round lights, and	1.00



compartment #5 shall contain two (2) 2-1/2" clear round lights.

40-10-0191	<b>LOCKS POWER - PASSAGE, 5 COMPARTMENTS, KEY FOBs</b> Install: power door locks on module passage doors, and (5) OSS compartments, use OEM key fobs. Does not include battery bay door.	1.00
40-10-0151	<b>SWITCH DOOR UNLOCK, WATERPROOF - HIDDEN IN FRONT GRILLE AREA</b> Install: exterior hidden door unlock switch in grille area.	1.00
30-06-0201	<b>RADIO TIE-IN POINT - (1) 12V/40 AMP - CAB CONSOLE AREA</b> Install (1) set of 12 volt/40 amp radio tie-in studs in cab console: (1) battery hot, (1) ignition hot, (1) grounded stud.	1.00
30-06-0202	<b>RADIO TIE-IN POINT - (1) 12V/40 AMP - PATIENT COMPARTMENT</b> Install (1) set of 12 volt/40 amp radio tie-in studs in patient compartment: (1) battery hot, (1) ignition hot, (1) grounded stud.	1.00
30-06-0203	<b>RADIO TIE-IN POINT - (1) 12V/250 AMP - PDQ</b> Install (1) set of 12 volt/250 amp radio tie-in studs in the PDQ: (1) battery hot, (1) ignition hot, (1) grounded stud.	1.00

**Braun - Exterior Lighting**

Item Number	Description	Quantity
30-06-0410	<b>WARNING LIGHTS FLASH PATTERN SIGNAL ALERT 75 - MULTIPLEX ELECTRICAL SYSTEM</b> The default flash pattern for the vehicle warning lights: Signal Alert 75.	1.00
ClearLENS	<b>CLEAR LENSES ON ALL WARNING LIGHTS</b>	1.00
GWL050002	<b>LIGHTS GRILLE - 2 WHELEN 500 SUPER LED</b> Two (2) Whelen 500 series super LED warning lights, with waterproof connectors shall be installed the grille area of the chassis. The lights shall operate from a switch on the master control console labeled "Flashers".	1.00
GWLCLR1R	<b>GRILLE WARNING LIGHT LOCATION 1 - RED</b> The warning light located on the grille in location 1 shall be red.	1.00
GWLCLR2R	<b>GRILLE WARNING LIGHT LOCATION 2 - RED</b> The warning light located on the grille in location 2 shall be red.	1.00
STRPTRN	<b>STRAIGHT PATTERN WARNING LIGHTS</b> The front warning lights will be aligned in a straight pattern across the module.	1.00
30-25-0122	<b>LIGHTS, ICC / LED CLEARANCE - ON MODULE FRONT - TECNIQ</b> Install: (5) amber Tecniq LED (S33-AA00-1) clearance / ICC lights on the front of the module near the roof line per dwg #1.	1.00
FWL090007	<b>LIGHTS FRONT MODULE - 7 WHELEN 900 SUPER LED</b>	1.00





Seven (7) Whelen 900 series super LED warning lights with chrome bezels shall be installed on the module front. The lights shall operate from a switch on the master control console, labeled "Flashers".

<b>FWLCLR1R</b>	<b>FRONT WARNING LIGHT LOCATION 1 - RED</b> The warning light located on the upper front of the module in location 1 shall be red.	1.00
<b>FWLCLR2R</b>	<b>FRONT WARNING LIGHT LOCATION 2 - RED</b> The warning light located on the upper front of the module in location 2 shall be red.	1.00
<b>FWLCLR3R</b>	<b>FRONT WARNING LIGHT LOCATION 3 - RED</b> The warning light located on the upper front of the module in location 3 shall be red.	1.00
<b>FWLCLR4W</b>	<b>FRONT WARNING LIGHT LOCATION 4 - WHITE</b> The warning light located on the upper front of the module in location 4 shall be white.	1.00
<b>FWLCLR5R</b>	<b>FRONT WARNING LIGHT LOCATION 5 - RED</b> The warning light located on the upper front of the module in location 5 shall be red.	1.00
<b>FWLCLR6R</b>	<b>FRONT WARNING LIGHT LOCATION 6 - RED</b> The warning light located on the upper front of the module in location 6 shall be red.	1.00
<b>FWLCLR7R</b>	<b>FRONT WARNING LIGHT LOCATION 7 - RED</b> The warning light located on the upper front of the module in location 7 shall be red.	1.00
<b>30-25-0123</b>	<b>LIGHTS, ICC / LED CLEARANCE - ON MODULE REAR - TECNIQ</b> Install: (5) red TECNIQ LED (S33-RR00-1) clearance / ICC lights on the rear of the module near the roof line per dwg #2.	1.00
<b>ROL090002</b>	<b>LIGHTS REAR MODULE, UPPER OUTER - 2 WHELEN 900 LED</b> Two (2) Whelen 900 series super LED warning light with chrome bezels shall be installed on the upper rear of the module, in the outer location. The lights shall operate from a switch on the master control console, labeled "Flashers".	1.00
<b>ROLCLR1R</b>	<b>REAR OUTER MODULE LIGHT LOCATION 1 - RED</b> The warning light located on upper rear of the module, in outer location 1 shall be red.	1.00
<b>ROLCLR2R</b>	<b>REAR OUTER MODULE LIGHT LOCATION 2 - RED</b> The warning light located on upper rear of the module, in outer location 2 shall be red.	1.00
<b>RCL090001</b>	<b>LIGHTS REAR MODULE, UPPER CENTER - 1 WHELEN 900 LED</b> One (1) Whelen 900 series super LED warning light with a chrome bezel shall be installed on the upper rear of the module, center location. The light shall operate from a switch on the master control console, labeled "Flashers".	1.00
<b>RCLCLR1A</b>	<b>REAR CENTER MODULE LIGHT LOCATION 1-AMBER</b> The warning light located on upper rear of the module in the center location shall be amber.	1.00



<b>RS090002</b>	<b>LIGHTS REAR SCENE - 2 WHELEN 900 24 DIODE LED</b> Two (2) Whelen 900 Series super LED scene/load lights with chrome bezels shall be installed on the upper rear of the module. The lights shall operate from a switch on the master control console, labeled "Rear Scene Lights". -----	1.00
<b>WL090002</b>	<b>LIGHTS REAR WINDOW - 2 WHELEN 900 SUPER LED</b> Two (2) Whelen 900 series super LED warning lights with chrome flanges shall be installed on the rear of the module at window level, one (1) on each side. These lights shall operate from a switch on the master control console, labeled "Flashers". -----	1.00
<b>WLCLR1R</b>	<b>WINDOW LEVEL LIGHT LOCATION 1 - RED</b> The warning light located on rear of the module at window level, location 1 shall be red. -----	1.00
<b>WLCLR2R</b>	<b>WINDOW LEVEL LIGHT LOCATION 2 - RED</b> The warning light located on rear of the module at window level, location 2 shall be red. -----	1.00
<b>30-26-3009</b>	<b>LIGHTS, REAR TAIL - WHELEN 600 LED STOP, TURN, &amp; MAXIMUM INTENSITY BACK-UP</b> Install: (1) pair each of Whelen 600 series LED stop/tail lights, turn lights, and fully populated MAXIMUM intensity LED back-up lights with chrome bezels on rear of the module. -----	1.00
<b>30-26-7002</b>	<b>LIGHT, LICENSE PLATE LED - WHELEN OACOEDCR</b> Install:(1) Whelen OACOEDCR LED license plate light with 45 deg angled chrome-plated bezel on the rear of module, lower left side. -----	1.00
<b>FIL07T0002</b>	<b>LIGHTS FRONT INTERSECTION - 2 WHELEN 700 LED W/15 DEGREE TILT HOUSING</b> Two (2) Whelen 700 series super LED warning lights, with water-proof connectors, shall be mounted in 15 degree tilt housings on the front chassis fenders, one (1) on each side. The lights shall operate from a switch on the master control console labeled "Flashers". NOTE: When vehicle is placed in park, the override switch must be on for intersection light(s) to remain on. -----	1.00
<b>FILCLR1R</b>	<b>FRONT INTERSECTION LIGHT LOCATION 1 - RED</b> The warning light located on front of the chassis fender in location 1 shall be red. -----	1.00
<b>FILCLR2R</b>	<b>FRONT INTERSECTION LIGHT LOCATION 2 - RED</b> The warning light located on front of the chassis fender in location 2 shall be red. -----	1.00
<b>RIL070002</b>	<b>LIGHTS INTERSECTION REAR - 2 WHELEN 700 LED</b> Two (2) Whelen 700 series super LED warning lights with, chrome flanges and water-proof connectors, shall be installed above the rear wheel wells, one (1) on each side. These lights shall operate from a switch on the master control console screen labeled "Flashers". NOTE: When vehicle is placed in park, the override switch must be on for intersection light(s) to remain on. -----	1.00
<b>RILCLR1R</b>	<b>REAR INTERSECTION LIGHT LOCATION 1 - RED</b> The warning light located on above the rear wheel well at location 1 shall be red. -----	1.00
<b>RILCLR2R</b>	<b>REAR INTERSECTION LIGHT LOCATION 2 - RED</b>	1.00



	The warning light located on above the rear wheel well at location 2 shall be red. -----	
<b>30-27-1102</b>	<b>LIGHTS, ICC / LED CLEARANCE - ON MODULE SIDE - TECNIQ</b> Install: (2) red Tecniq LED (S33-RR00-1) clearance/ICC lights, (1) red on each side at rear of the vehicle, flash with turn signal, per Dwg #3 and #4. -----	1.00
<b>SWL090004</b>	<b>LIGHTS SIDE WARNING - 4 WHELEN 900 SUPER LED</b> Four (4) Whelen 900 series super LED warning lights with chrome flanges shall be installed, two (2) on each side of module exterior per dwg. -----	1.00
<b>SWLCLR1R</b>	<b>SIDE WARNING LIGHT LOCATION 1 - RED</b> The warning light located on side of the module, in outer location 1 shall be red. -----	1.00
<b>SWLCLR2R</b>	<b>SIDE WARNING LIGHT LOCATION 2 - RED</b> The warning light located on side of the module, in outer location 2 shall be red. -----	1.00
<b>SWLCLR3R</b>	<b>SIDE WARNING LIGHT LOCATION 3 - RED</b> The warning light located on side of the module, in outer location 3 shall be red. -----	1.00
<b>SWLCLR4R</b>	<b>SIDE WARNING LIGHT LOCATION 4 - RED</b> The warning light located on side of the module, in outer location 4 shall be red. -----	1.00
<b>SS090004</b>	<b>LIGHTS SIDE SCENE - 4 WHELEN 900 24 DIODE LED</b> Four (4) Whelen 900 series 24 Diode LED scene lights with chrome flanges shall be installed, two (2) each module side. These lights shall operate from switches on the master control console labeled "Left Scene Light" and "Right Scene Light". -----	1.00

**Braun - Module Body Construction**

<i>Item Number</i>	<i>Description</i>	<i>Quantity</i>
<b>39-00-0005</b>	<b>AWS ALUMINUM CERTIFIED WELDERS</b> -----	1.00
<b>39-10-0003</b>	<b>CONNECTIONS, MODULE</b> Bolt: to the chassis frame rail with (12) 5/8" -11 grade 8 bolts through OEM rubber insulating spacers installed on outriggers at twelve (12) separate locations (six each frame rail), providing noise insulation and easy removal for chassis replacement, mounting bolts to be properly torqued and secured with locktite, system used for fastening the module to the frame to be that approved by the chassis manufacturer.	1.00
<b>40-00-0080</b>	<b>INSULATION - POLYURETHANE SPRAY FOAM</b> The walls, ceiling, passage doors, outside storage doors, the entire underside of the module floor (except for mounting pads), the underside of the outside storage compartments, the wheel wells, and the underside of the curbside step area shall be completely foam - in - place insulated with nominal 3/4" thick sprayed on Class I, urethane foam for thermal and acoustical insulation. The insulation shall comply with FMVSS #302 flame spread requirements. The underside of the body shall be properly prepared to ensure adhesion before the spray insulation is applied. -----	1.00



39-00-0001	<b>MODULE BODY CONSTRUCTION - SEAMLESS</b> Module: fabricated entirely of parts cut and formed from .125" (minimum) thickness 5052-H32 flat aluminum sheet stock, using CNC machines capable of .010" repeatability. This is the only alloy that may be used for body parts that are welded together. Roll-cage type interior super-structure, aluminum partition and module welded together into a single unit, roof designed with a minimum 1.5" crown to facilitate water run-off. Floor, roof, sides, all exterior doors fabricated from .125" (minimum) thick flat aluminum sheet stock, exterior joints between the roof and side components continuous full seam welded the entire length of the module. All exterior body panel joints continuous full seam welded. No VHB bonding tape or other adhesives used in the construction of the ambulance module.	1.00
39-00-0002	<b>SOLE SOURCE MODULE BODY CONSTRUCTION</b>	1.00

<b>Braun - Module Features / Exterior</b>		
<b>Item Number</b>	<b>Description</b>	<b>Quantity</b>
40-00-0009	<b>ALUMINUM PARTS - MODULE EXTERIOR</b> All unpainted exterior aluminum parts to be bright dip anodized after fabrication to retain the finish and increase corrosion resistance.	1.00
40-00-0010	<b>CORROSION MINIMIZATION - MODULE</b> All module contact with dissimilar metals shall be minimized with the use of nylon screw-hole inserts to provide hinge to door isolation with the module body, polypropylene strip hinge isolation, polyethylene backed rubber tape, ceramic coated stainless steel hinge bolts, and ECK brand corrosion inhibitor spray.	1.00
40-00-0020	<b>DOOR CONSTRUCTION - GASKET PLACEMENT</b> All exterior hinged module doors shall be constructed in an inverted pan-formed design. The pan shall be constructed from .125" thick 5052-H32 flat sheet aluminum. The exterior door skin shall be constructed of .190" thick aluminum and welded to the pan. Door gaskets shall be attached to the interior side of the door skin on the top, bottom and outer edge of the door. The gasket on the hinge side of the door will be attached to the door frame.	1.00
40-00-0060	<b>EXTERIOR COMPARTMENTS - SWEEP-OUT</b> Exterior module compartments: a sweep-out design to aid in facilitation of the purchaser's routine care and cleaning of the vehicle. All exterior compartment floors, with the exception of the front ALS compartment to be constructed to be flush with the bottom door frame.	1.00
40-00-0030	<b>EXTERIOR COMPARTMENTS DESIGN</b> All exterior compartments shall be vented and include: sound absorbing slip resistant polyurethane material sprayed on the inside of all compartments and compartment shelving, slide out trays and closeouts, baffled seep holes provided to prevent water from splashing or seeping into the exterior compartments, full-length, two-way adjustable, stainless steel hinges on all exterior compartment doors with 3/16" stainless steel hinge pins, compartment doors installed, flush with the module body, when double doors are provided, each door to have exterior handle, but only the	1.00



	forward door lockable, rearward door is secured when forward door is locked), all exterior compartments and passage doors keyed alike, lockable Eberhard "free-floating" type chrome plated handles with rotary locks. Gasket installed under each handle to protect the paint; drip rails installed above all exterior compartment doors.	
40-00-0050	<b>EXTERIOR COMPARTMENTS, VENTING</b> (9) square inches (minimum) of venting inside #1, #2, #3, & #4 exterior storage compartments to provide for easier closure of the compartment doors.	1.00
40-00-0055	<b>EXTERIOR COMPARTMENTS, VENTING - OXYGEN STORAGE</b> (9) square inches (minimum) of venting provided in the exterior oxygen storage compartment, to dissipate any leaking oxygen gas.	1.00
40-00-0070	<b>HANDLES, EBERHARD - CHROME FREE FLOATING TYPE</b> Install: Eberhard #EMC-1-2110 chrome "free-floating" handles on each exterior module door, large enough to accommodate a gloved hand.	1.00
40-10-0073	<b>LOWERED MODULE CURB SIDE</b> Module curb side to be as low as possible and still comply with KKK-1822-F ramp break over angle. Lowered side will allow easier entry into the module as well as increased compartment storage.	1.00
40-10-0321	<b>STEPWELL, CURBSIDE DOORWAY - MID STEP AREA</b> Install: aluminum diamond plate step well and mid-level step in curbside doorway threshold area.	1.00
40-00-0091	<b>THRESHOLD, STAINLESS STEEL - ALL OSS STORAGE COMPARTMENTS</b> Each exterior storage compartment with a hinged door: stainless steel lower threshold at the door opening to protect the paint.	1.00
40-10-0340	<b>STONE GUARDS, MOD FRNT -ANODIZED DIAMOND PLATE</b> Install: anodized aluminum diamond plate stone guards on module front, (1) each side.	1.00
40-10-0066	<b>DOOR SLIDING - MODULE CURBSIDE PASSAGE</b> Install EZ Glide curb door.	1.00
40-10-0088	<b>DOORS - REAR PASSAGE</b> Patient compartment rear door opening: doors flush without a protruding flange or lip, right rear passage door lockable, chrome exterior handle, left rear door non-locking, chrome exterior handle, all handles installed with a gasket, hinge full length stainless steel with a 3/16" stainless steel hinge pin, two-way adjustable, each rear door two-point slam action automotive type rotary latching system to the body, right rear door lock to the body at the top and bottom, not to left rear door, doors .213" steel door latch activator rods with clevis adjusters, doors lockable from inside and outside, shut on molded, air-core, automotive type door seals to prevent water from leaking into vehicle interior.	1.00
40-10-0130	<b>EMERGENCY RELEASE LEVER, REAR PATIENT PASSAGE DOORS</b> Install emergency release lever, attached to each rear passage door latch to be free-floating from the interior door linkages.	1.00
40-10-0505	<b>WINDOWS, PASSAGE DOOR - (CURB SLIDING, REAR FIXED)</b>	1.00



	Curbside passage door (sliding) window with removable screen, rear passage doors w/ non-openable window, windows 69% dark tint, secured with black oxide coated fasteners, open doors not to block warning lights.	
<b>40-10-0103</b>	<b>FENDERETTES - POLISHED ALUMINUM</b> Install: Polished aluminum fenderettes around the rear wheel well openings.	1.00
<b>40-10-0119</b>	<b>HOLD-OPEN - REAR DOORS - GRABBERS</b> Install: door grabbers (1 pair) with hard rubber inserts on rear doors.	1.00
<b>40-10-0360</b>	<b>KICKPLATE/THRESHOLD, REAR DOORWAY - ANODIZED DIAMOND PLATE</b> Install: anodized aluminum diamond plate kick plate at the rear exterior doorway, providing a kick / scuff plate at rear of the vehicle above rear step, per dwg # 2.	1.00
<b>40-10-0204</b>	<b>MUD FLAPS, REAR - BLACK RUBBER FIBERGLASS REINFORCED - THREE COLOR</b> Install black rubber, fiberglass reinforced mud flaps with a minimum 1/4" thickness bolted to underside of module behind rear wheels, to provide adequate coverage of rear dual wheels of the chassis, mud flaps to be (3) color with the Manufacturers Logo.	1.00
<b>40-10-0266</b>	<b>REAR STEP/BUMPER -FLIP-UP CENTER SECTION - STAR PUNCHED AND ANODIZED</b> Affix: rear bumper to chassis frame, constructed with a hinged center section, (2) steel braces to secure step to chassis frame, outer 17" on each end of bumper constructed from heavy gauge stamped polished stainless steel bumper parts, to provide smooth rounded corners, step constructed of star punched .125" thick aluminum diamond plate, (2) rear LED step illumination lights provided. All diamond plate surfaces to be anodized; strip of black PVC installed on face of step.	1.00
<b>40-10-0381</b>	<b>TOW HOOKS, MODULE REAR</b> Secure: fasten (2) tow hooks in rear step area to rear step braces.	1.00
<b>40-10-0280</b>	<b>RUB RAILS, ANODIZED ALUMINUM</b> Install: anodized polished aluminum rub rails on lower sides of body, below outside compartment sill areas., rub rails to be offset 3/16" from body.	1.00
<b>40-00-0019</b>	<b>DOOR SKINS, OUTSIDE STORAGE COMPARTMENTS - DIAMOND PLATE INTERIOR SKINS</b> Interior door skins for all outside storage compartments constructed of .063" thick aluminum diamond plate.	1.00
<b>OS1XL1STD</b>	<b>OSS #1 - STREETSIDE FORWARD</b> OSS #1 streetside forward, hinged door with spring-loaded gas cylinder, locking handle installed on the exterior of the door.	1.00
<b>OS1XL1OP4</b>	<b>OSS #1 - OXYGEN STORAGE</b> OSS #1 streetside forward, for housing an O2 cylinder.	1.00
<b>OS102WELD</b>	<b>OSS #1 - OXYGEN STORAGE BRACKET WELDED IN FOR H or M CYLINDER</b> An oxygen storage bracket shall be welded in OSS #1 for retention of "H" or "M" oxygen cylinders.	1.00
<b>OS2XL1STD</b>	<b>OSS #2 - STREETSIDE CENTER</b>	1.00



	OSS #2 streetside center, hinged double doors with spring-loaded gas cylinders, handles installed on the exterior of each door, forward door with locking handle.	
<b>OS2XL1OP1</b>	<b>OSS #2 - (1) ADJUSTABLE SHELF</b> OSS #2 streetside center, with one (1) adjustable shelf.	1.00
<b>OS2SHELF1</b>	<b>OSS #2 - SHELF ONE (1) ADJUSTABLE WITH TRACK</b> Outside storage compartment #2 shall contain one (1) adjustable shelf with track.	1.00
<b>OS3XL1STD</b>	<b>OSS #3 - STREETSIDE REAR - TALL DOOR</b> OSS #3 streetside rear, hinged door with spring-loaded gas cylinder, locking handle installed on the exterior of the door.	1.00
<b>OS3XL1OP1</b>	<b>OSS #3 - (1) ADJUSTABLE SHELF WITH INSIDE/OUTSIDE ACCESS</b> OSS #3 streetside rear, for providing I/O storage access, and contain one (1) adjustable shelf.	1.00
<b>OS3SHELF1</b>	<b>OSS #3 - SHELF ONE (1) ADJUSTABLE WITH TRACK</b> Outside storage compartment #3 shall contain one (1) adjustable shelf with track.	1.00
<b>OS4XL1STD</b>	<b>OSS #4 - CURBSIDE REAR</b> OSS #4 curbside rear, hinged door with spring-loaded gas cylinder, locking handle installed on the exterior of the door.	1.00
<b>OS4XL1OP4</b>	<b>OSS #4 - BACKBOARD AND (2) ADJUSTABLE SHELVES WITH INSIDE/OUTSIDE ACCESS AND FIXED DIVIDER</b> OSS #4 curbside rear, with one (1) fixed vertical divider for backboard/scoop stretcher storage on one side and and two (2) adjustable shelves with inside/outside storage access on other.	1.00
<b>OS4BB</b>	<b>OSS #4 - BACKBOARD - SCOOP STRETCHER STORAGE</b> Compartment #4 shall provide storage for backboards / scoop stretcher, with a (1) inch adjustable strap with black plastic buckle.	1.00
<b>OS4DIV1</b>	<b>OSS #4 - FIXED DIVIDER</b> One (1), fixed divider with sprayed on polyurethane material shall be provided and installed in outside storage compartment #4 per dwg. #4.	1.00
<b>OS4SHELF2</b>	<b>OSS #4 - SHELVES TWO (2) ADJUSTABLE WITH TRACK</b> Two (2) adjustable shelves with track in outside storage compartment #4.	1.00
<b>OS5XL1STD</b>	<b>OSS #5 - CURBSIDE FORWARD</b> OSS #5 curbside forward, hinged door with spring-loaded gas cylinder, locking handle installed on the exterior of the door.	1.00
<b>OS5XL1OP1</b>	<b>OSS #5 - INSIDE/OUTSIDE ACCESS TO THE ALS CABINET - #5B OPEN STORAGE AREA</b> OSS #5 curbside forward, inside/outside access to the ALS cabinet, and #5B lower storage area.	1.00

**Braun - Module Interior / Patient Compartment**



Item Number	Description	Quantity
50-51-1001	<b>CABINET CONSTRUCTION - INTERIOR - ALUMINUM</b> All interior cabinets shall be constructed of .090" thick welded aluminum. -----	1.00
50-60-0220	<b>EMBLEMS / SIGNS - REAR PATIENT COMPARTMENT</b> (2) "No Smoking / Oxygen Equipped / Fasten Seat Belts" signs: (1) sign installed in the cab, (1) above the oxygen outlets in the patient compartment street side cabinet. -----	1.00
50-60-0300	<b>FLOOR CONSTRUCTION- PATIENT COMPARTMENT, NON-WOOD COMPOSITE</b> Sub-floor in the patient compartment: constructed of .125" thick aluminum over .125" and .190" thick reinforcing hat sections and mounting laterals, aluminum sub-floor covered with a 3/4" non-wood composite material, all corner molding, edging and trim anodized aluminum or stainless steel and sealed to prevent fluids from seeping under the cabinets. -----	1.00
50-60-0301	<b>FLOORING - COVE</b> Patient compartment floor radius: coved with pre-formed floor coving material, installed behind the vinyl floor covering, along both the street side and curbside walls. -----	1.00
50-60-0391	<b>HEADLINER - REAR PATIENT COMPARTMENT</b> Headliner in the patient compartment shall be one-piece, seamless, .090 thick aluminum finished with sprayed-on multi-use polychromatic coating.	1.00
50-51-1013	<b>HOLD OPENS FOR INTERIOR DOORS</b> All interior cabinets with doors less than 6" tall shall have friction hinges as hold opens for door(s). Doors 6" and taller shall be designed using gas shocks as hold opens for the door(s). -----	1.00
50-60-0660	<b>PADDED EDGING PROTECTION</b> Install: padded corner edging where necessary on exposed corners and edges in the patient compartment for patient and attendant protection.	1.00
50-00-0202	<b>ROUNDED INTERIOR CORNERS</b> Interior vertical edges: rounded/padded corners in the following locations: forward and aft edges of the CPR seat, the wall at the aft end of the squad bench, the partition opening cabinet edges and the upper front wall cabinet. -----	1.00
50-51-1011	<b>RECESSED ADJUSTABLE SHELF TRACK - CABINETS</b> Install recessed adjustable shelf track in cabinets. -----	1.00
50-51-5001	<b>UPHOLSTERY - PATRIOT PLUS CHARCOAL #8605</b> All cushions, head pads and seating surfaces shall be covered with Patriot Plus Charcoal #8605 -----	1.00
50-60-0661	<b>INTERIOR MODULE PADS</b> Vinyl upholstered, foam cushioned head/back pads shall be installed as follows: the lower edge of the upper front wall cabinet (above the partition doorway or window), above the rear doors, above the side door, and on the street side wall behind and on each side of the CPR seat. The pads shall be covered with a flame-retardant color	1.00





	coordinated vinyl upholstery material. -----	
50-51-6003	<b>LONPLATE II, NON-SLIP EMBOSSED SM. GRID - GUNMETAL #424</b> The floor in the patient compartment shall be covered with Lonseal brand "Lonplate II" non-slip; small grid (embossed) Gunmetal #424. -----	1.00
50-51-2002	<b>CABINET DOORS - CLEAR POLYCARBONATE</b> All cabinet doors shall be clear polycarbonate material / installed in aluminum track lined with PPL inserts / An edge mounted aluminum handle shall be installed on each sliding cabinet door. -----	1.00
50-51-3001	<b>CABINETS/ WALLS - POLYCHROMATIC COATING - MARBLE STONE</b> Headliner, walls, cabinet faces, and cabinet interiors MultiSpec color to be Marble Stone -----	1.00
IS-CNT2-ACR	<b>COUNTER TOP, SOLID ACRYLIC - SECONDARY ACTION AREA</b> Install: solid acrylic countertop with 1/2" lip on the secondary action area. -----	1.00
IS-CNT-ACR	<b>COUNTER TOP, SOLID ACRYLIC</b> Install: solid acrylic countertop with 1/2" lip on the primary action area. -----	1.00
50-51-4033	<b>COUNTERTOP - SOLID ACRYLIC - RAVEN BOULDER (GRAY/BLACK)</b> Install a solid acrylic counter top, Raven Boulder (#810).	1.00
50-01-0408	<b>LATCHES, CABINET, CN10 COMPLIANT AS APPLICABLE - INCLUDING RADIO CABINET</b> The ACP (attendant control panel) door, the PDQ (power distribution quarters) door, and the radio cabinet door shall be secured with chrome locking lever latches/ all remaining interior hinged cabinet doors with center squeeze latches/all interior drawers with locking flush pull latches.	1.00
50-10-0229	<b>LEFT WALL - ATTENDANT CONTROL PANEL - WITH FLAT AREA</b> A Weldon Vista Control Screen shall be mounted on a hinged access panel and secured with two (2) latches. The panel will be located to the immediate right of the attendant's seat. The forward portion of the panel will contain a flat area that may be used for future radio mounting, etc. -----	1.00
IS1XL1OP1	<b>CABINET - FIXED FRAME WITH SLIDING POLYCARBONATE DOORS AND (1) ADJ. SHELF EACH SIDE OF CENTER DIVIDER</b> Left wall, upper rear interior cabinet (#1): fixed frame, sliding polycarbonate doors w/full length handles, the outer most sliding door to have handles on both ends, center divider with (1) adjustable shelf each side -----	1.00
IS2XL1OP1	<b>CABINET - FIXED FRAME WITH SLIDING POLYCARBONATE DOORS AND (1) ADJ. SHELF EACH SIDE OF CENTER DIVIDER</b> Left wall, upper interior cabinet (#2): fixed frame, sliding polycarbonate doors w/full length handles, the outer most sliding door to have handles on both ends, center divider with (1) adjustable shelf, each side. -----	1.00
IS3XL1OP1	<b>CABINET - HINGED POLYCARBONATE DOORS WITH CENTER SQUEEZE LATCHES AND FULL LENGTH HANDLES, INSIDE/OUTSIDE ACCESS TO OSS #3</b> Left wall rear interior cabinet (#3): fixed frame, hinged polycarbonate doors w/ center squeeze latches and full length handles, inside/outside access to OSS #3. -----	1.00
IS4XL1OP1	<b>CABINET - SLIDING POLYCARBONATEDOORS WITH (1) ADJUSTABLE SHELF</b>	1.00



Left wall interior cabinet (#4) below secondary action area: fixed frame, sliding polycarbonate doors w/ full length handles, the outermost sliding door to have handles on both ends (1) adjustable shelf.

IS5XL1OP1	<p><b>PULL-OUT DRAWER WITH HINGED ACRYLIC WRITING SURFACE AND LOCKING STAINLESS STEEL FLUSH PULL LATCH. RECESSED SUCTION BELOW DRAWER</b>          Left lower wall: (1) drawer (#5) aisle facing, primary action area, under the attendant control panel, hinged acrylic writing surface, locking stainless steel flush pull latch. A recessed SSCOR suction canister shall be located below the drawer. An SSCOR suction system with a 12 VDC electric vacuum pump: recessed into the street side lower interior wall near the attendant seat, pump shall be mounted in the standard OSS #2, pump exhaust shall be vented to the exterior of the vehicle. (must use SSCOR pump and tubing)</p>	1.00
50-60-0018	<p><b>ASPIRATOR / SUCTION - SSCOR - WITH ELECTRIC PUMP - RECESSED</b>          An SSCOR suction system shall be recessed into the street side lower interior wall near the attendant's seat. The 12 VDC SSCOR electric vacuum pump to be installed in an exterior compartment per the location on the drawing (must use SSCOR pump and tubing).</p>	1.00
IC1XL1OP2	<p><b>INSIDE/OUTSIDE ACCESS TO OSS #4 WITH HINGED POLYCARBONATE DOOR, FULL LENGTH HANDLE, AND CENTER SQUEEZE LATCH</b>          Compartment #1 on the rearward curb side wall, inside/outside access to OSS #4, hinged polycarbonate door, full length handle, center squeeze latch.</p>	1.00
IC2XL1OP22	<p><b>SQUAD BENCH WITH RECESSED SHARPS/WASTE BELOW SEPARATE BENCH LID. SECOND PATIENT TRANSPORT ON THE SQUAD BENCH.</b>          The Curbside wall shall have a squad bench which will include storage, a split lid with gas cylinder hold opens, and a recessed sharps and trash container.</p>	1.00
IC3XL1OP1	<p><b>(2) ANGLED LED LIGHTS OVERHEAD WITH OXYGEN OUTLET MOUNTED TO THE WALL</b>          (2) LED lights on overhead angled panel on curb side upper wall.</p>	1.00
50-50-0503	<p><b>SQUAD BENCH TOP - SPLIT WITH HINGED LID FORWARD WITH SHARPS / TRASH ACCESS</b>          Squad bench top and cushion shall be split into two (2) sections with separate hinged lids/ forward most section shall have the sharps and trash container installed/ bench covered with color coordinated vinyl upholstery material/automatic latching fastener shall be installed in both sections</p>	1.00
50-50-0541	<p><b>HOLD OPENS - SQUAD BENCH LID - GAS CYLINDERS</b>          Gas cylinder hold-open(s) shall be provided and installed to hold lid in the open and closed position.</p>	1.00
50-60-0709	<p><b>SHARPS AND TRASH CONTAINERS - ACCESS THRU SQUAD BENCH LID</b>          A 6.9 qt. #BD5489 sharps container, and a 8 qt. trash container installed in the forward end of the squad bench base, containers accessed through the squad bench lid covered with a 3/8" thick clear acrylic hinged lid with a biohazard warning label.</p>	1.00
50-60-0718	<p><b>SQUAD BENCH FACE - VINYL FLOORING MATERIAL</b></p>	1.00



	The face of the squad bench shall be covered with vinyl flooring material.	
<b>SQ-BN-BASE</b>	<p><b>SQUAD BENCH BASE W/STORAGE</b></p> <p>A storage area shall be provided in the squad bench base. The squad bench base shall be constructed of .090" thick aluminum for maximum storage capacity and minimum weight. The interior of the squad bench shall be sprayed with sound absorbing polyurethane material.</p>	1.00
<b>IF3PDQ</b>	<p><b>CABINET - PDQ</b></p> <p>The Power Distribution Quarters (PDQ) shall hold electrical components, (i.e., power distribution nodes, circuit breakers, etc.), hinged door with (2) chrome locking lever latches, located on the partition wall behind the attendant seat.</p>	1.00
<b>IF1XL1C4</b>	<p><b>CABINET - FRONT WALL, UPPER #1 - HINGED ALUMINUM DOOR W/INSERT</b></p> <p>The front wall interior cabinet #1, flip up hinged aluminum door with polycarbonate insert and gas shock hold-open(s), center squeeze latch, (1) adjustable shelf.</p>	1.00
<b>IF1XL1OP4</b>	<p><b>CABINET WITH HINGED ALUMINUM DOOR WITH POLYCARBONATE INSERT AND CENTER SQUEEZE LATCH WITH (1) ADJUSTABLE SHELF</b></p> <p>Install cabinet with hinged aluminum door with polycarbonate insert and gas shock hold-open(s) in the upper front wall.</p>	1.00
<b>IF2XL1OP1</b>	<p><b>CABINET - UPPER/LOWER WITH HINGED POLYCARBONATE DOORS, CENTER SQUEEZE LATCHES, (1) ADJ. SHELF PER CABINET</b></p> <p>Front interior wall cabinet #2 fixed frame separated into (2) cabinet sections, upper and lower, each enclosed with (1) set of hinged polycarbonate doors with center squeeze latches, (1) adjustable shelf per each section and (1) adjustable shelf between the sections for a total of (3) adjustable shelves.</p>	1.00
<b>IF3XL1OP1</b>	<p><b>CABINET - VENTED RADIO CABINET PDQ ABOVE</b></p> <p>Power Distribution Quarters (PDQ) compartment and a vented radio compartment below the PDQ, lower front wall, left.</p>	1.00
<b>IF3XL1RAD</b>	<p><b>CABINET - FRONT WALL, LOWER BELOW PDQ (SINGLE VENTED DOOR)</b></p> <p>A radio cabinet with a vented, hinged aluminum door, secured by a chrome locking lever latch, located on the front lower left wall, door to open towards rear of the module.</p>	1.00
<b>IF4XL1OP1</b>	<p><b>PASS-THROUGH WINDOW OPEN TO THE CAB</b></p> <p>Window opening, pass-through from cab to module.</p>	1.00
<b>50-20-0507</b>	<p><b>PASS THROUGH - CAB TO MODULE, WINDOW OPENING</b></p> <p>A window opening: provided in the rear of the cab to accommodate pass-through communications to the patient compartment, bellows provided to connect the cab to the module.</p>	1.00
<b>50-50-0118</b>	<p><b>SEATING - ATTENDANT - USSC VALOR R - BACK INTEGRAL CHILD, SWIVEL SEAT CN8 COMPLIANT</b></p> <p>A USSC Valor rear facing, R-back attendant seat with an integrated child seat installed at the head of the patient cot: a (2) position swivel seat mounted on a pedestal base with a heavy-duty seat frame / ABTS (All Belts To Seat) application with (4) point / (4) retractors single click internal mount belt system. The seat shall be padded and</p>	1.00



	covered with sewn matching vinyl upholstery. -----	
50-50-0122	<b>SEATING - ATTENDANT - SIDE MOUNT POSITION</b> The attendant seat shall be in a side mount position. -----	1.00
CPROP1	<b>SEATING - CPR - VALOR WITH 4PT BELTING</b> A CPR seat: on the street side of the patient compartment aft of the primary action area counter: KKK-A-1822F Change Notice 8 compliant, VALOR A-VAL shelf mount back frame and internal bolsters, single click, four (4) point / four (4) retractors, internal mount belt system, VALOR A-VAL shelf mount back frame and the seat shall be padded and covered with cushioned, color coordinated, cut and sewn vinyl. -----	1.00
SQSTOP1	<b>SEATING - CN8 COMPLIANT TWO (2) VALOR A-VAL BACK</b> A Squad bench seat: (2) Valor A-Val Back individual seating positions will be installed on the curb side of the patient compartment. Seats shall have a VALOR A-VAL shelf mount back frame and internal bolsters with (4) point / (4) retractors single click internal mount belt system / padded and covered with cushioned, color coordinated, cut and sewn vinyl. -----	1.00
50-60-0424	<b>HEAT/AIR CONDITIONING, HOSELINE FT-454, BRUSHLESS BLOWER 580 cfm (36,000 BTU HEAT/32,000 BTU COOL)</b> Install Hoseline FT-454 with 4x4 AC/Heat Core w/ brushless blower motor. -----	1.00
50-61-0001	<b>ASSIST HANDLES, (6) BLACK RUBBER</b> Install: a total of (6) 10-7/8" black vulcanized rubber with steel core assist handles installed: (1) handle on each rear door, (1) on the curbside door, (1) at the curbside doorway and (2) at the rear doorway. -----	1.00
50-60-0730	<b>DOOR PANELS - MODULE PASSAGE DOORS - FULL LENGTH ALUMINUM - W/ACCESS PANELS</b> Interior rear and curbside passage door panels to be full length aluminum, Multi-Spec sprayed to match interior color and contain removable latch access panel per dwg. # 6 & # 8. (Total 3). -----	1.00
50-60-0256	<b>EXHAUST VENTILATOR, 3-SPEED - MULTIPLEX ELECTRIC SYSTEM</b> Install: three-speed, 250 CFM (minimum) exhaust fan in the street side cabinet in the patient compartment, fan pulse width modulated from a switch on the attendant control panel vista screen, exhaust system to have a louvered grille inside and a chrome vent outside, system vent through the side of the vehicle, not through the roof. -----	1.00
50-60-0322	<b>GLOVE DISPENSER - (3) BOX - ABOVE ENTRY DOOR - CURBSIDE (ABS)</b> A three (3) - box glove dispenser unit, with a clear acrylic hinged access panel with three (3) cut-outs, shall be provided above the curbside entry door. A 1/4" turn latch will be installed on the face of the glove box access panel. -----	1.00
50-60-0340	<b>GRAB RAIL, 1-1/4" DIAMETER, (96") OVER COT AREA</b> (1) 1-1/4" diameter x 96" long stainless steel grab rail installed on the ceiling for attendant/ patient balance control, attached to the ceiling with (3) mounting brackets that secure it to the super structure of the module. Installation to comply with AMD-008 requirements.	1.00



50-60-0431	<b>IV HANGERS - CEILING RECESSED - CAST PRODUCTS #IV2008-1 (2)</b> Two (2) Cast Products #IV2008-1 recessed; dual ceiling I.V. hangers shall be provided per Dwg #9 locations. -----	1.00
50-60-0640	<b>OXYGEN SYSTEM, ELECTRIC - MULTIPLEX ELECTRIC SYSTEM</b> A 12 VDC controlled electric O2 system operated through the v-mux multiplex electrical system shall be provided and installed.	1.00
50-60-1601	<b>OXYGEN OUTLET (1) LEFT WALL - OHIO MED - ACTION AREA</b> One (1) Ohio Medical flush mounted; quick release wall outlet shall be installed in the forward street side cabinet action area. Per dwg #5 -----	1.00
50-60-1640	<b>OXYGEN OUTLET (1) RIGHT WALL - OHIO MED - HEAD END OF SEATING AREA</b> One (1) Ohio Medical flush mounted; quick release wall outlet shall be installed in the right wall above the head end of the curbside seating area. Per dwg #6 -----	1.00
50-60-1680	<b>OXYGEN OUTLET (1) CEILING - OHIO MED - ABOVE HEAD OF COT</b> One (1) Ohio Medical flush mounted; quick release oxygen outlet shall be installed in the ceiling above the head of cot in the center mount position. Per dwg #9 -----	1.00
50-60-0629	<b>FLOW METER, OXYGEN - THORPE STYLE</b> One (1) Thorpe style oxygen flow meter (15LPM) shipped loose with the completed vehicle. -----	1.00
50-60-0761	<b>STAINLESS STEEL WALL PROTECTION - INTERIOR STREETSIDE</b> A brushed stainless steel panel shall be provided on the street side wall from the bottom of the CPR seat. -----	1.00
50-60-0820	<b>ANTI-SLIP MATTING - CURBSIDE STEPWELL</b> Anti-Slip charcoal gray matting shall be installed in the curbside step well. -----	1.00

**Braun - Optional Patient Compartment Items**

<i>Item Number</i>	<i>Description</i>	<i>Quantity</i>
50-62-0302	<b>COT FASTENER - STAT-TRAC SINGLE - CENTER POSITION CN8 COMPLIANT</b> Install a 96" Stat-Trac single position center mount -----	1.00

**Braun - Paint / Graphics**

<i>Item Number</i>	<i>Description</i>	<i>Quantity</i>
60-01-0001	<b>PAINT PROCEDURE</b> All non-anodized aluminum module body surfaces: completely chemically steam cleaned, filled with premium body filler as needed, sanded smooth and primed with an epoxy primer and then primed again with a high solid primer, cured primer surfacer shall be DA sanded with 320 grit and cleaned. A high solid primer shall then be applied, where needed, as a sealer. -----	1.00
60-01-0005	<b>STANDARDS AND SPECIFICATIONS FOR VEHICLE PAINT APPEARANCE</b>	1.00



Adhere to Standards and Specifications for Vehicle Paint Appearance.		
60-10-0108	<b>CAB - OEM PAINT White</b>	1.00
60-01-0004	<b>BUFFING, PAINT - MODULE</b> The paint on the module sides shall be buffed to a high shine using a recommended paint buff system.	1.00
60-01-0002	<b>PAINT MODULE - OEM PAINT PLUS CLEAR COAT White</b> Paint module OEM to match the chassis. The entire module shall be clear-coated, using an Axalta Process, sprayed over the final paint coat.	1.00
60-30-0200	<b>REFLECTIVE - DOOR REFLECTIVITY</b> Install reflective material (25" x 2.5" red/silver chevron style), on the lower interior stainless steel panel of each rear door and hinged side door. NOTE: If a sliding side door is provided, install a 1.50" x 40.00" white reflective stripe on the rear facing edge.	1.00
60-25-0101	<b>REFLECTIVE - BLACK MATERIAL IN RUB RAILS</b> Install black reflective material in rub rails.	1.00

**Braun - Vehicle Manuals**

<i>Item Number</i>	<i>Description</i>	<i>Quantity</i>
80-20-0001	<b>VEHICLE MANUALS (1) PACKAGE SET</b> One (1) Delivery Manual Package shall be supplied with the vehicle, and shall include the following items: Ambulance manufacturer parts, service, and operation manuals, OEM chassis owner's guide, complete 12 VDC and 125 VAC wiring schematics for all included standard and optional systems, Multiplex Electrical system programming - electronic media	1.00
90-10-0007	<b>STATEMENT OF LIMITED WARRANTY NEW AMBULANCES</b>	1.00

CHEVROLET SILVERADO 5500HD REGULAR CAB,  
189"WB 4x2 (108" C.A.)

#### MECHANICAL

Engine: L5D - Engine, Duramax 6.6L Turbo-Diesel V8

Transmission: Allison A1750 EVS (MHV) Transmission Shift Control Calibration, transmission cooler

Performance Rear Axle, 4.30 Ratio Axle-Limited Slip Equipment Emission, Dual Rear wheels

Diesel DPF, Manual Regeneration, 50 State

Alternator, Dual, 150 Amp & 220 Amp

Batteries, Dual, Heavy-Duty 1300 CCA

Engine Block Heater

Engine cooling

Rear Wheels, Dual Tires, Highway, Continental, Hybrid HS3

Tires Front 225/70R19.5G HWY, Continental, Hybrid HS3 Tires, BSW

Rear 225/70R19.5G HQY, Continental, Hybrid HS3 Tires,

Spare 225/70R19.5G Highway, Continental Wheels, 19.5" x 6.75",

Steel, Black Painted Wheel, 19.5" x 6.75",

Spare, Steel, Black

#### FUNCTIONAL

Front Stabilizer Bar

Rear Suspension, 13,500 lb, Multi-Leaf

Engine Brake-Exhaust Electrical Provisions, Rear of Frame

Front Suspension, 7000 lbs.

Axle to End of Frame, 63"

Axle Lubricant, Rear, Synthetic

Fuel Tank, Rear, 40 Gallon

Power steering

Anti-lock brakes

HD front, rear shocks

Horn, Dual

Auxiliary Wiring

Recovery Hooks

Engine Control-Power Take Off (PTO) Controls PTO,

GVWR 19.5K Max,

GCWR 30K

#### EXTERIOR

Primary Color: GAZ - Summit White Paint,

Solid Glass, Solar Absorbing, Tinted

Assist Steps, Aluminum Front Fender Extension,

Black Mirrors, O/S, Wide Load / Trailering,

Full Feature Handles, Outside Door,

Chrome Exhaust System, Left Side Exit Located Inside of Frame

Grille Guard Screen, Insect Protection

Rear Back Up Alarm

Lamps, Rear, Stop

Grille-Radiator,

Chrome Bumper, Front,

Chrome License Plate Front Mounting Hardware

Ambulance Package

#### INTERIOR/COMFORT/CONVENIENCE

Power Windows

Power Seat Adjuster (Driver's Side)

LT Preferred Equipment Group

Cloth, Jet Black,

Interior Trim Interior Trim,

Jet Black Floor Covering, Rubberized Vinyl, Black

Power Door Locks,

Power Keyless Remote Entry

ISRV Mirror,

Cab Dome Light

Electrochromatic Seat Belt, Front, Orange Seats:

Front 40/20/40 Split-Bench

Air Conditioning,



Manual Radio, 8" Color Screen, Bluetooth, w/USB Port Driver Information Center, 4.2" Display  
Onstar 4G LTE Wi-Fi Hotspot SiriusXM Satellite Radio OnStar Communication System Speaker  
System, 6 Compact Disc & MP3 Player AM/FM

Cruise Control-Automatic,

Tilt steering wheel

Wipers, multi-speed intermittent

Electronic 110 Volt Electrical Receptacle,

In Cab Accessory Electrical Switches

#### SAFETY/SECURITY

Tail Lamp Provisions,

Air Bags, Front, Driver and Right Front Passenger Air Bag Deactivation Switch, Front, Passenger-  
side

Tool Kit, Rim Wrench and Handle Only, Jack

WEIGHT RATINGS GVW Rating, 19,500 lbs

Front Axle, 7,000 lbs

Rear Axle, 13,500 lbs

GCWR 30,000 lbs